

PERKINS + WILL

225 Franklin Street, Suite 1100
Boston, MA 02110
617.439.0300
617.478.0321
www.perkinswill.com

CLIENT



Maine Medical Center
22 Bramhall Street
Portland, ME 04102

CONSULTANTS

- CIVIL/LANDSCAPE ARCHITECT**
Sebago Technics Inc.
75 John Roberts Road, Suite 1A,
South Portland, ME 04106
- STRUCTURAL/ENGR BUILDING ENVELOPE CONSULTANT**
Simpson Gumpertz & Heger Inc.
41 Seyon Street, Building 1, Suite 050,
Waltham, MA 02453
- MEFP ENGINEER/LOW VOLTAGE**
AKF Group LLC
99 Bedford Street, 2nd Floor, Boston, MA 02111
- CONSTRUCTION MANAGER**
TURNER CONSTRUCTION
2 Seaport Lane, Suite 200, Boston, MA 02210
- ELEVATOR CONSULTANT**
VDA (Van Deusen & Associates)
101 Summer Street, 4th Floor, Boston, MA 02110
- COST ESTIMATOR**
D.G. Jones International
3 Baldwin Green Common, Suite 202, Woburn, MA 01801
- MEDICAL EQUIPMENT PLANNING**
Mitchell Planning
630 Dundee Road, Suite 340, Northbrook IL 60062

PROJECT TITLE

Congress Street Building
22 Bramhall Street
Portland ME 04102

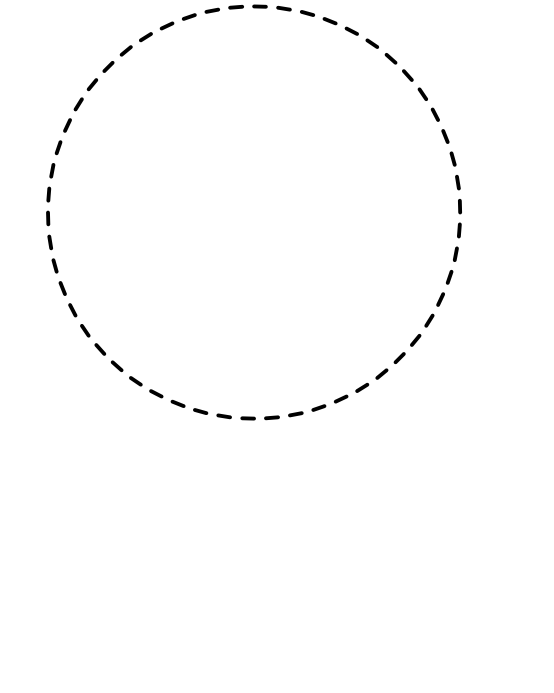

KEY PLANS

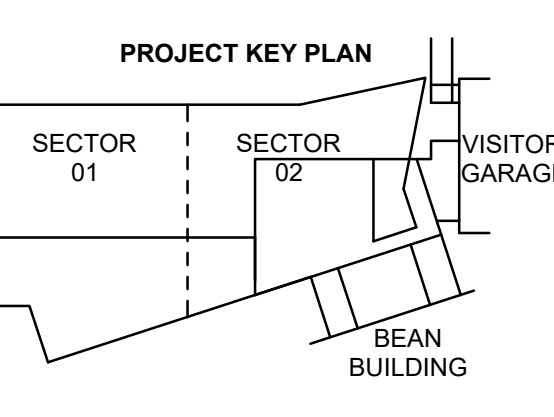

OVERALL KEY PLAN

- 1 - NOT USED
- 2 - CONGRESS STREET
- 3 - VISITOR GARAGE
- 4 - EAST TOWER
- 5 - CENTRAL UTILITY PLANT
- 6 - BEAN BUILDING
- 7 - RICHARDS BUILDING
- 8 - MAINE GENERAL BUILDING

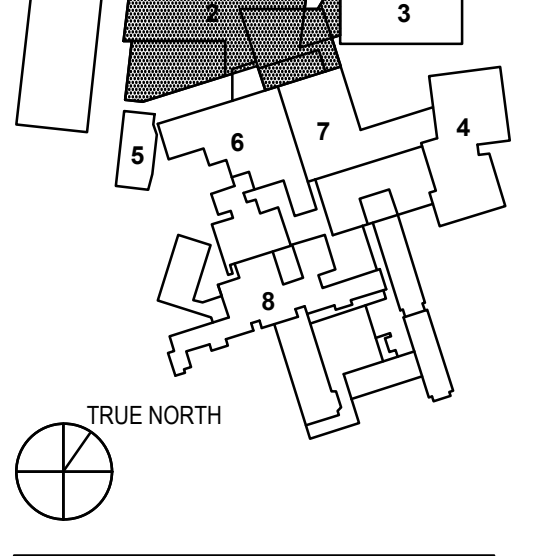

KEY NOTES

- 1 PAVEMENT SAW CUT
- 2 ASPHALT STREET PAVING
- 3 4" CONCRETE PAVING
- 4 8" CONCRETE PAVING
- 5 BRICK PAVING
- 6 TACTILE WARNING PLATES 2 FT. X 6 FT.
- 7 RESET SALVAGED GRANITE CURB
- 8 NEW SLOPED GRANITE CURB
- 9 TIP DOWN GRANITE CURB
- 10 24" SOLID WHITE PAINT BARS, 5 FT. WIDE, SPACED 24" APART
- 11 (2) 4" SOLID YELLOW PAINT LINES
- 12 NEW STREET LIGHT - SEE SITE ELECTRICAL PLAN
- 13 5 FT. X 13 FT. TREE WELL - GRANITE CURB SET 6" ABOVE SIDEWALK
- 14 METRO BUS STOP LOCATION
- 15 EXISTING TELEPHONE VAULT TO REMAIN
- 16 MMC DIRECTIONAL SIGN - SEE SIGNAGE PLAN
- 17 MMC PRIMARY SIGN ON BATTER WALL - SEE SIGNAGE PLAN
- 18 BATTER RETAINING WALL
- 19 18" SEAT WALL
- 20 GRANITE STAIR - 5 RISERS PER FLIGHT
- 21 STAINLESS STEEL BOLLARD
- 22 STAINLESS STEEL HANDRAIL
- 23 MECHANICAL AREAWAY - SEE ARCHITECTURAL PLANS
- 24 STOP SIGN
- 25 BUILDING CANOPY
- 26 EGRESS STAIR - SEE PERKINS + WILL PLANS
- 27 BRIDGE CONNECTOR - SEE PERKINS + WILL PLANS

RESUBMIT TO CITY

NOVEMBER 27, 2016

NO	ISSUE	DATE
Job Number	152189.000	
Drawn	MAL	
Checked	WTC	
Approved	DLR	

TITLE

**SITE PLAN
MAIN ENTRANCE
CONGRESS STREET
EXPANSION**

SHEET NUMBER

C05-01