

- 1 - NOT USED
- 2 - CONGRESS STREET
- 3 - VISITOR GARAGE
- 4 - EAST TOWER
- 5 - CENTRAL UTILITY PLANT
- 6 - BEAN BUILDING
- 7 - RICHARDS BUILDING
- 8 - MAINE GENERAL BUILDING

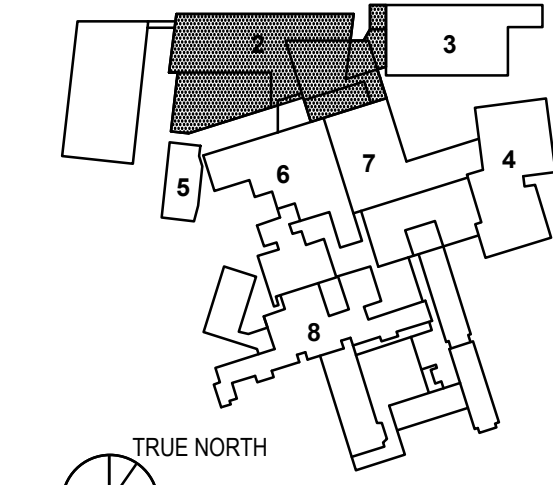

NO.	ISSUE	DATE
Job Number	152189.000	
Drawn	MALAMAM	
Checked	DLR	
Approved	DLR	

**LEGEND**

EXISTING	DESCRIPTION	PROPOSED
---	PROPERTY LINE (R.O.W.)	---
---	ABUTTER LINE (R.O.W.)	---
---	BUILDING	---
---	EDGE PAVEMENT	---
---	PAVEMENT SAWCUT	---
---	EDGE CONCRETE	---
---	CURB LINE	---
---	CONTOURS	---
---	SPOT GRADE	---
---	RETAINING WALL	---
---	DECIDUOUS TREE	---
---	CONIFEROUS TREE	---
---	SIEN	---
---	GAS	---
---	GAS GATE VALVE	---
---	GAS METER	---
---	GAS MANHOLE	---
---	WATER	---
---	WATER GATE VALVE	---
---	WATER SHUT OFF	---
---	HYDRANT	---
---	WATER MANHOLE	---
---	SANITARY SEWER	---
---	SANITARY MANHOLE	---
---	STORM DRAIN	---
---	UNDER DRAIN	---
---	DRAINAGE MANHOLE	---
---	CATCH BASIN	---
---	OVERHEAD UTILITY	---
---	UNDERGROUND UTILITY	---
---	TRANSFORMER PAD	---
---	ELECTRICAL MANHOLE	---
---	TELEPHONE MANHOLE	---
---	LIGHT POLE	---
---	UTILITY POLE	---
---	GUY WIRE	---
---	REPAIR	---
---	INLET PROTECTION	---

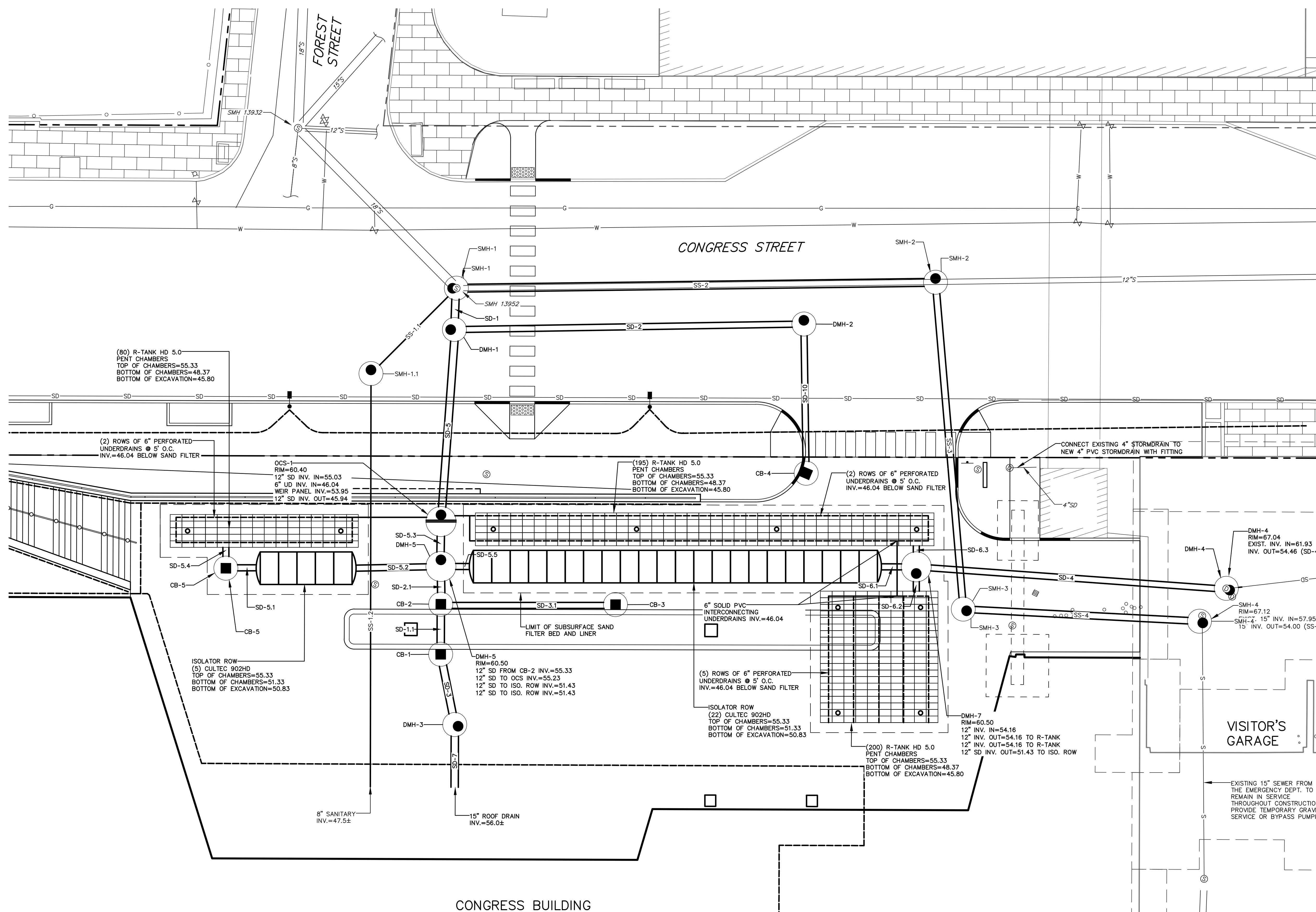

**SANITARY SEWER STRUCTURE DATA**

STRUCTURE	RIM	INV. IN	INV. OUT	DIAM.
SMH 13932	52.64	43.42 (15" ROP) 44.64 (12" PVC) 45.64 (8" ROP)	40.64 (18" ROP)	48"
SMH 13952	55.09	45.89 (12" PVC)	44.61 (18" ROP)	48"

**SANITARY SEWER STRUCTURE DATA**

STRUCTURE	RIM	INV. IN	INV. OUT	DIAM.
SMH-1	55.09	44.71 (SS-2) 46.87 (SS-1) 45.83 (SD-1)	48.99 (SS-1)	48"
SMH-1.1	53.96	47.09 (SS-1.2)	46.99 (SS-1.1)	48"
SMH-2	60.19	51.21 (SS-3) 51.41 (SS-16008)	50.77 (SS-2)	48"
SMH-3	60.27	52.24 (SS-4)	52.14 (SS-3)	48"
SMH-4	67.12	57.95 (SS-11065)	54.00 (SS-4)	48"

**SANITARY SEWER PIPE DATA**

NAME	SIZE	LENGTH	SLOPE
SS-1.1	8"	20'	0.60%
SS-1.2	8"	81'	0.51%
SS-2	18"	92'	6.60%
SS-3	15"	62'	1.51%
SS-4	15"	43'	4.07%

**STORM DRAIN STRUCTURE DATA**

STRUCTURE	RIM	INV. IN	INV. OUT	DIAM.
CB-1	60.00	55.60 (SD-3)	55.50 (SD-1.1)	48"
CB-2	59.89	55.47 (SD-1.1) 55.47 (SD-3.1)	55.37 (SD-2.1)	48"
CB-3	59.89		56.48 (SD-3.1)	48"
CB-4	59.00		52.50 (SD-10)	48"
CB-5	60.25		53.83 (SD-5.4) 51.33 (SD-5.1)	48"
DMH-1	54.96	49.35 (SD-2) 45.76 (SD-5)	45.66 (SD-1)	48"
DMH-2	58.74	50.14 (SD-10)	50.04 (SD-2)	48"
DMH-3	60.47	55.77 (SD-7)	55.67 (SD-3)	48"
DMH-4	67.04	61.93 (EXIST.)	54.46 (SD-4)	48"
DMH-5	60.12	55.33 (SD-2.1)	51.43 (SD-5.2) 51.43 (SD-5.5) 52.20 (SD-5.3)	60"
DMH-7	59.88	54.16 (SD-4)	51.43 (SD-6.1) 54.16 (SD-6.3) 54.16 (SD-6.2)	60"

**STORM DRAIN PIPE DATA**

NAME	SIZE	LENGTH	SLOPE
EXIST.	6"	1'	1.41%
SD-1	15"	4'	0.73%
SD-1.1	15"	6'	0.50%
SD-2	12"	66'	1.05%
SD-2.1	18"	3'	1.32%
SD-3	15"	10'	0.68%
SD-3.1	12"	31'	3.27%
SD-4	12"	58'	0.52%
SD-5	15"	34'	0.53%
SD-5.1	12"	4'	0.00%
SD-5.2	12"	14'	0.69%
SD-5.3	15"	4'	25.11%
SD-5.4	12"	2'	0.00%
SD-5.5	12"	3'	3.12%
SD-6.1	12"	4'	2.23%
SD-6.2	12"	2'	51.13%
SD-6.3	12"	2'	70.79%
SD-7	15"	11'	2.18%
SD-8	6"	2'	0.84%
SD-9	6"	65'	0.53%
SD-10	12"	28'	9.14%
SD-11	6"	28'	0.57%

