

- 1 - NOT USED
- 2 - CONGRESS STREET
- 3 - VISITOR GARAGE
- 4 - EAST TOWER
- 5 - CENTRAL UTILITY PLANT
- 6 - BEAN BUILDING
- 7 - RICHARDS BUILDING
- 8 - MAINE GENERAL BUILDING

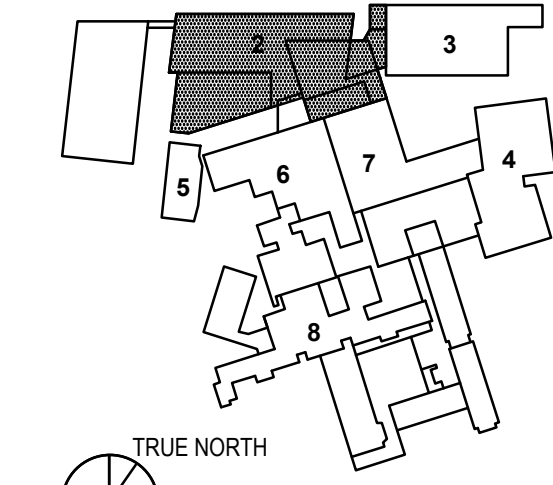

NO.	CITY SUBMISSION	DATE
1	CITY SUBMISSION	9/25/2018
NO.	ISSUE	DATE

Job Number 152189.000  
Drawn MAL/AMM  
Checked DLR  
Approved

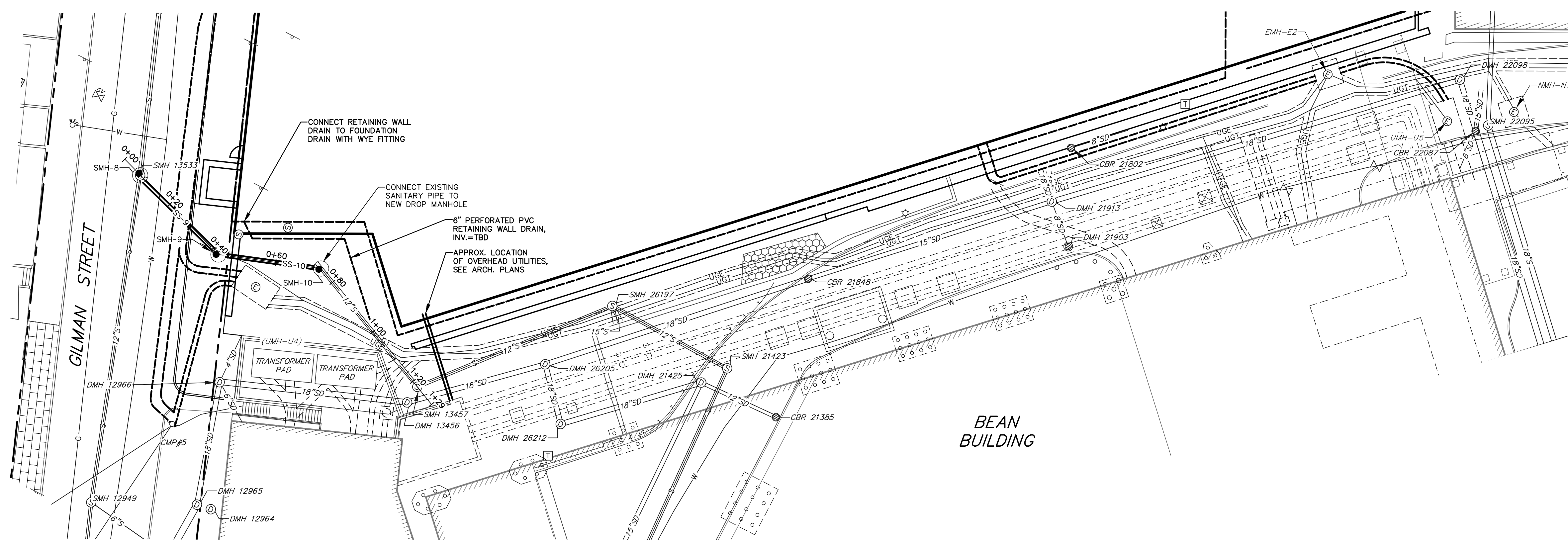

**PLAN: UTILITY CORRIDOR**  
STA. 0+00 TO STA. 2+68  
SCALE: 1"=20'

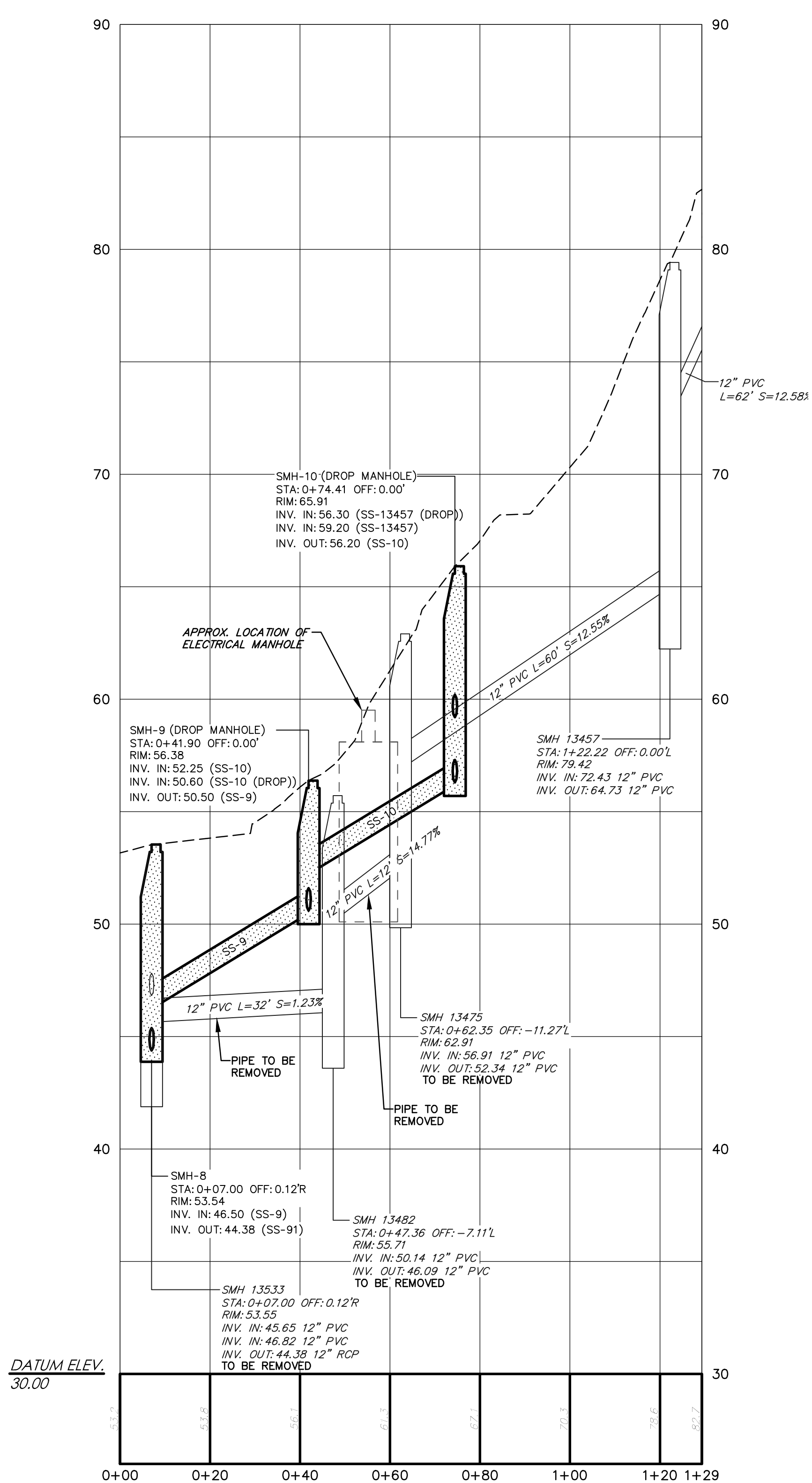

**PROFILE: UTILITY CORRIDOR**  
STA. 0+00 TO STA. 2+68  
SCALE: 1"=4' VERT.

**SANITARY SEWER PIPE DATA**

NAME	SIZE	LENGTH	SLOPE
SS-9	12"	31'	12.924%
SS-10	12"	29'	13.857%

**LEGEND**

EXISTING	DESCRIPTION	PROPOSED
---	PROPERTY LINE/R.O.W.	---
---	ADJUTER LINE/R.O.W.	---
---	BUILDING	---
---	EDGE PAVEMENT	---
---	PAVEMENT SAWCUT	---
---	EDGE CONCRETE	---
---	CURB LINE	---
---	CONTOURS	---
---	SPOT GRADE	---
---	RETAINING WALL	---
---	DECIDUOUS TREE	---
---	CONIFEROUS TREE	---
---	SIGN	---
---	GAS	---
---	GAS GATE VALVE	---
---	GAS METER	---
---	GAS MANHOLE	---
---	WATER	---
---	WATER GATE VALVE	---
---	WATER SHUT OFF	---
---	HYDRANT	---
---	WATER MANHOLE	---
---	SANITARY SEWER	---
---	SANITARY MANHOLE	---
---	STORM DRAIN	---
---	UNDER DRAIN	---
---	DRAINAGE MANHOLE	---
---	CATCH BASIN	---
---	OVERHEAD UTILITY	---
---	UNDERGROUND UTILITY	---
---	TRANSFORMER PAD	---
---	ELECTRICAL MANHOLE	---
---	TELEPHONE MANHOLE	---
---	LIGHT POLE	---
---	UTILITY POLE	---
---	GUY WIRE	---
---	BURIAL	---
---	INLET PROTECTION	---
---	PAVEMENT RECONSTRUCTION	---