

RAILROAD TRACKS

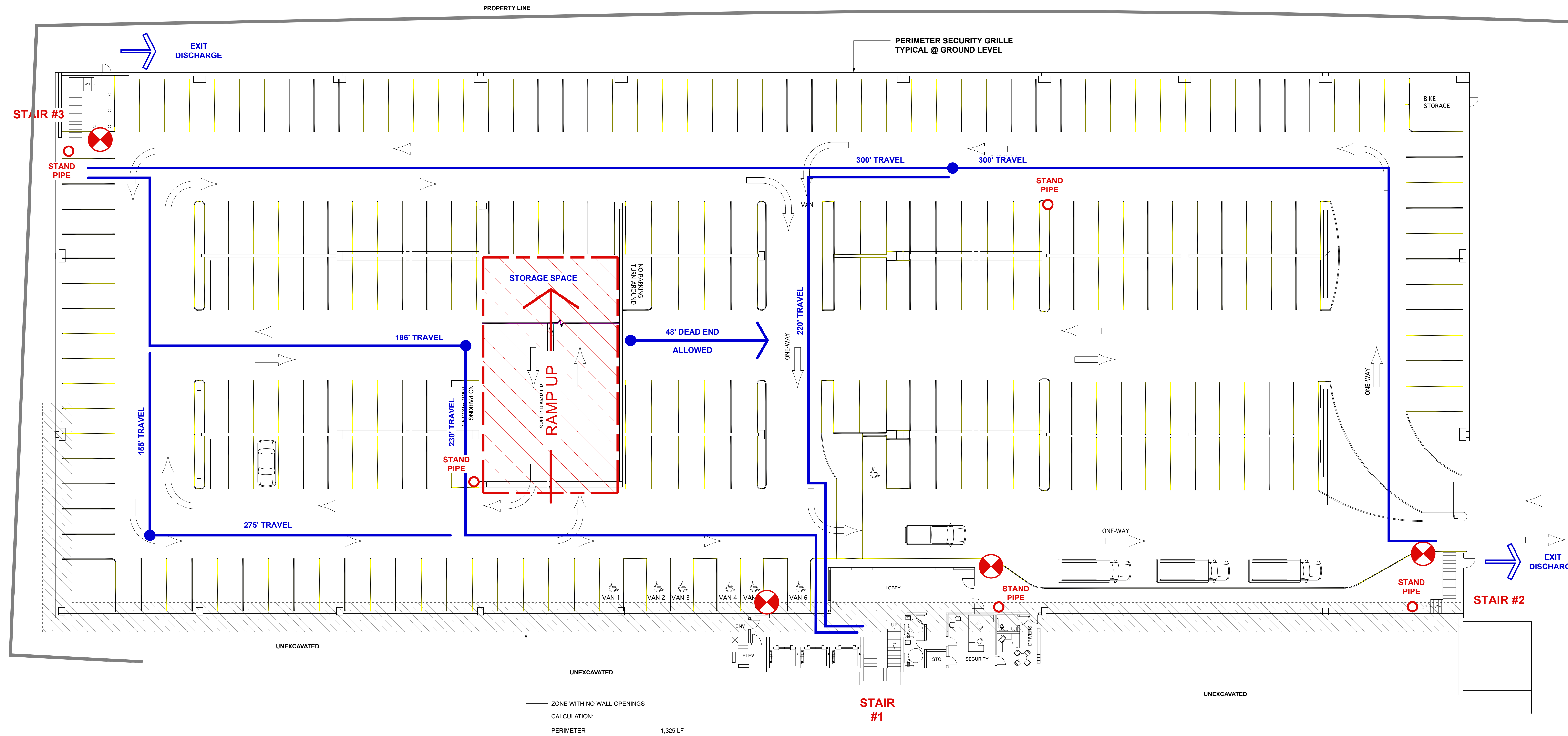

ZONE WITH NO WALL OPENINGS
CALCULATION:
PERIMETER: 1,325 LF
NO OPENINGS ZONE: 577 LF
NO OPENINGS ZONE PERCENTAGE: 43.6%
OPENINGS DISTRIBUTED OVER: 56.4%

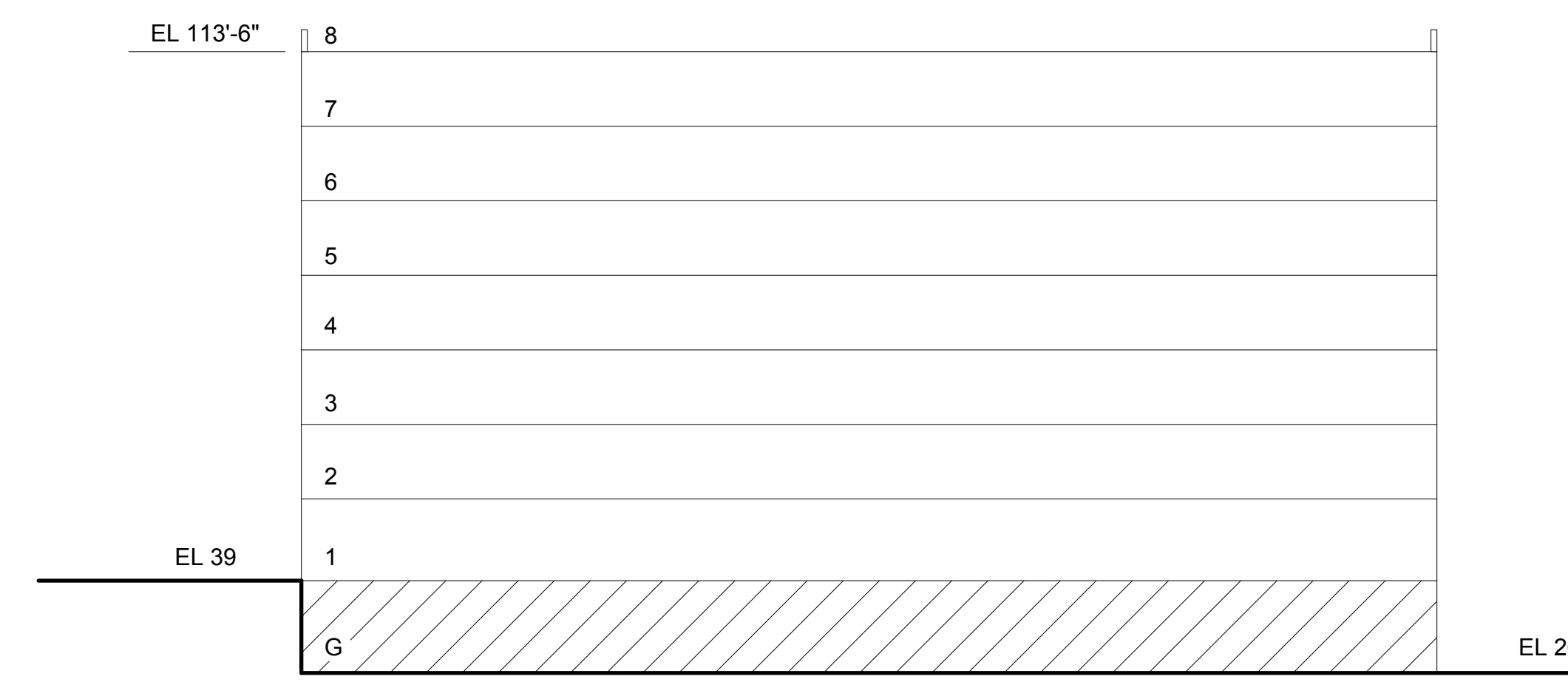

GROUND FLOOR CODE INFORMATION PLAN

1" = 20' - 0"

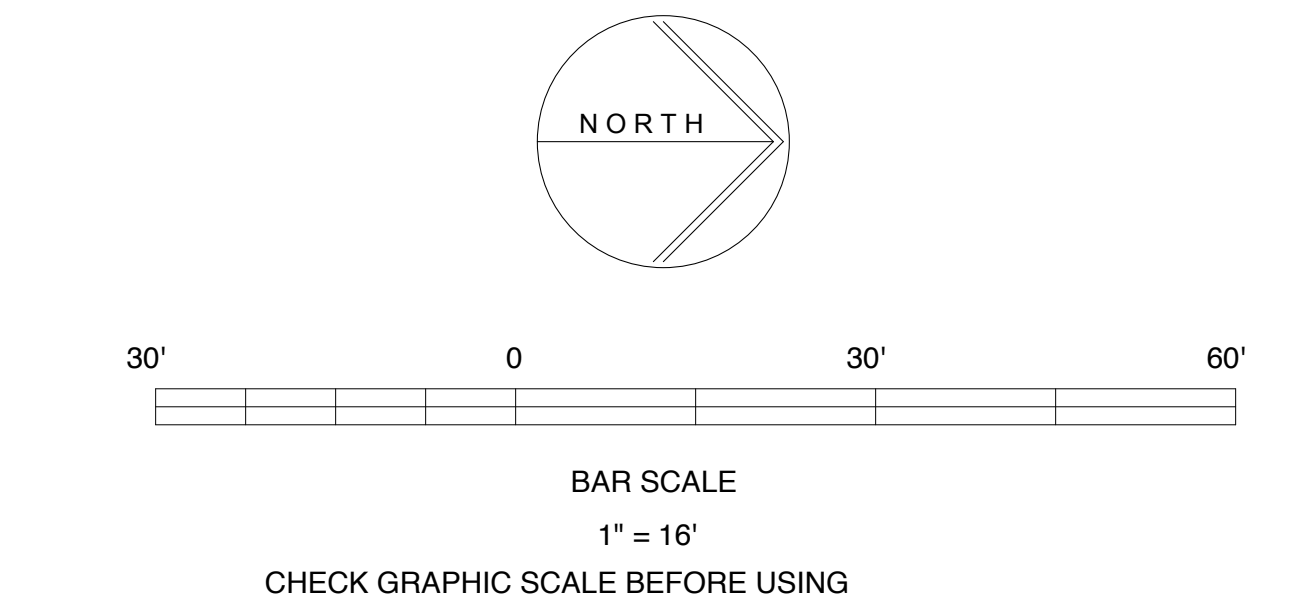

BUILDING CODE SUMMARY
St. John Street Parking Garage
Building Address: Portland, ME

APPLICABLE CODES (Per MUBEC: Maine Uniform Building and Energy Code)
Building: IBC 2015 (International Building Code)
IEBC 2009 (International Existing Building Code)
Electrical: National Electrical Code 2009
Fire Protection: NFPA Life Safety Code 2009 and NFPA 1 Uniform Fire Code 2003
Mechanical: International Mechanical Code 2009 (ISH/MAE 02.1 2007 and 90.1 2007)
Plumbing: Maine State Internal Plumbing Code (LUPC 2009)
Energy: IECC 2009 (International Energy Conservation Code)
Accessibility: ADA 2010 (Americans With Disabilities Act)

PROJECT DESCRIPTION:
New Construction - Open Parking Garage Meets IBC 406.5 and NFPA 101: 3.3.254.6
Proposed Construction Type: Type I B / NFPA II (222)
Gross Area Per Tier: 90,800 +/-
Height: 8 Tiers / 96'-3" (Top of Speed Ramp Roof Double Tees)
Use Group IBC: Open Parking Garage Section 406
Use Group NFPA: Open Parking Garage Chapter 42.8
High Rise Requirements: Exemptions for Parking Garages IBC 403.1
NFPA 101 42.8.4
Automatic Suppression System: No
Dry Standpipe System: Yes

BUILDING CODE REQUIREMENTS (IBC 2015)
Height and Area Summary (Table 406.5.4)
Allowable Height: 12 Tiers
Allowable Area: Unlimited

REQUIRED FIRE RESISTANCE RATINGS
ELEMENT (IBC Table 601/NFPA 101 Table A8.2.1.2) RATING (In Hours)

Primary Structural Frame	2
Bearing Walls:	
Exterior	2
Interior	2
Non-Bearing Walls & Partitions	
Exterior	0
Interior	0
Floor Construction & Secondary Members	2
Floor Construction & Secondary Members	2

SPECIFIC ROOM RATINGS
RATING (In Hours)

Stairs and Floor Openings	0
Parking Open Ramps	0
Offices + Break Room	0
Electrical	0
Mechanical Room	1
Elevator Shaftway	2

EXTERIOR WALL PROTECTION
Wall Fire Resistance Rating (Table 602) 0
(No rating for 10' or greater per Note c.)
Openings Rating (Table 705.8) 0
(No rating for 10' or greater per Note g.)

OCCUPANCY LOADS
NFPA Per Chapter 42.8.1.7: None
IBC Per Table 1004.1.2: 1 Per 200 GSF / 454 Per Tier
Egress Width Required: Stairs @ 0.3" Per Person 137"
Egress Width Provided: 144" (3) 48" Wide Stairs / 152 Persons Each
Stair Exit Door Width Required: 30.4"
Stair Exit Door Width Provided: 32" Clear Door @ Each Stair

OPENNESS CALCULATIONS:
GROUND FLOOR SUMMARY IBC
IBC 2015 SECTION 406.5
GROUND FLOOR WALL AREA: 13,538 SF
GROUND FLOOR NET OPEN AREA: 5,010 SF
OPENNESS RATIO [20% REQD]: 37%
OPENINGS DISTRIBUTED AROUND 56% OF THE PERIMETER [40% REQD]

GROUND FLOOR SUMMARY NFPA
NFPA 101 3.3.254.6
GROUND FLOOR PERIMETER: 1,312 LF
GROUND FLOOR NET OPEN AREA: 5,010 SF
OPEN AREA PER LF [1.4 SF REQD]: 3.7 SF/LF
OPENINGS DISTRIBUTED AROUND 56% OF THE PERIMETER [40% REQD]



Winton Scott Architects
5 Main Street
Portland, Maine 04101
207.774.4811
www.winton-scott.com

Appr	
Issued For	RESPONSE TO COMMENTS SUBMISSION
Date	7/24/18
Rev No	A

MMC ST. JOHN ST PG
PORTLAND, ME
CODE INFORMATION PLANS

Designed	MMW	Date	AS NOTED
Checked	MMW	Date	6/22/18
Checked	MMW	Reker Job Number	4070.1

G 101

THIS DRAWING IS AN INSTRUMENT OF SERVICE AND SHALL REMAIN THE PROPERTY OF BECKER STRUCTURAL ENGINEERS INC. IT SHALL NOT BE REPRODUCED, COPIED, LENT OR LOANED OR IN ANY MANNER USED FOR ANY PURPOSE OTHER THAN THAT FOR WHICH IT IS SPECIFICALLY PREPARED AND MUST BE RETURNED TO BECKER STRUCTURAL ENGINEERS INC. ON COMPLETION OF WORK, IF REQUESTED.