

RAILROAD TRACKS

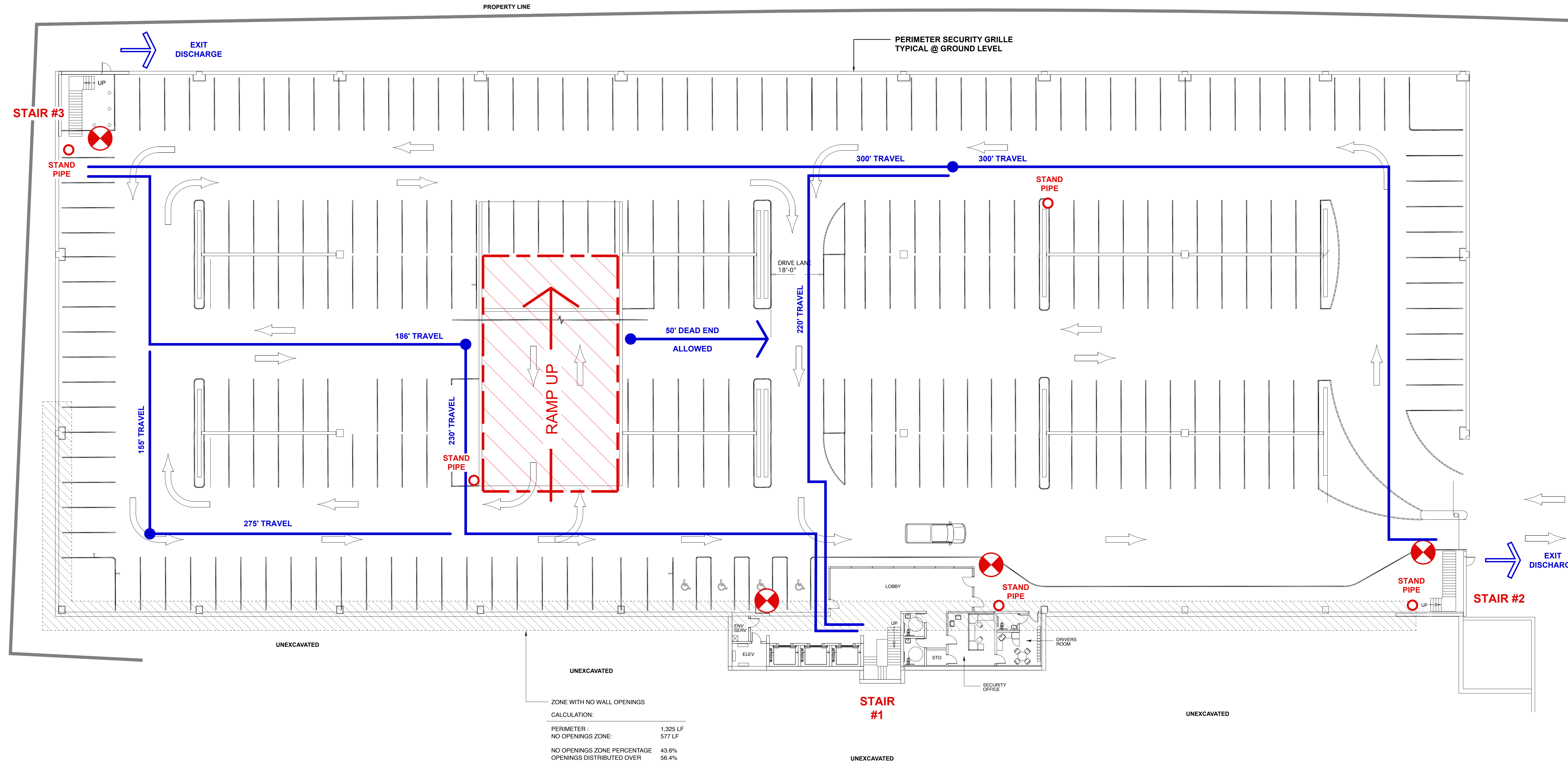

PARKING GARAGE SECTION DIAGRAM

GROUND FLOOR CODE INFORMATION PLAN

1" = 20'-0"

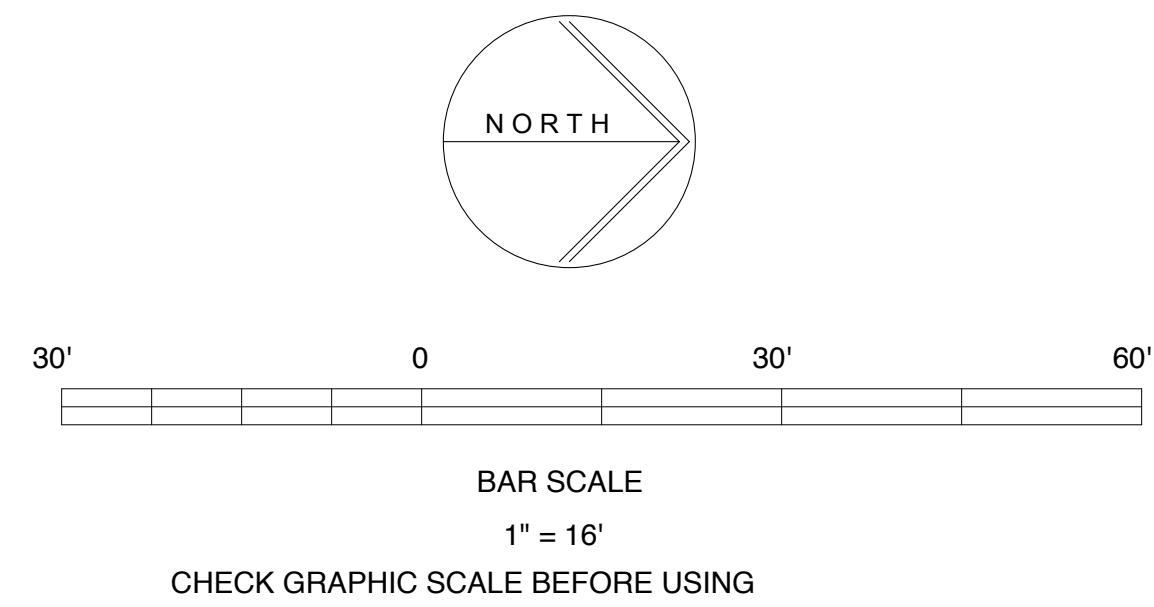

**BUILDING CODE SUMMARY**  
 St. John Street Parking Garage  
 Building Address: Portland, ME

**APPLICABLE CODES (Per MUBEC: Maine Uniform Building and Energy Code)**  
 Building IBC 2015 (International Building Code)  
 IEBC 2009 (International Existing Building Code)  
 Electrical National Electrical Code 2009  
 Fire Protection NFPA Life Safety Code 2009 and NFPA 1 Uniform Fire Code 2003  
 Mechanical International Mechanical Code 2009 (ASHRAE 62.1 2007 and 90.1 2007)  
 Plumbing Maine State Internal Plumbing Code (LUPC 2003)  
 Energy IECC 2009 (International Energy Conservation Code)  
 Accessibility ADA 2010 (Americans With Disabilities Act)

**PROJECT DESCRIPTION:**  
 New Construction - Open Parking Garage Meets IBC 406.5 and NFPA 101: 3.3.254.6  
 Proposed Construction Type: Type I B / NFPA II (222)  
 Gross Area Per Tier: 90,800 +/-  
 Height: 8 Tiers / 96'-3" (Top of Speed Ramp Roof Double Tees)  
 Use Group IBC: Open Parking Garage Section 406  
 Use Group NFPA: Open Parking Garage Chapter 42.8  
 High Rise Requirements: Exemptions for Parking Garages IBC 403.1  
 NFPA 101 42.8.4  
 Automatic Suppression System: No  
 Dry Standpipe System: Yes

**BUILDING CODE REQUIREMENTS (IBC 2015)**  
**Height and Area Summary (Table 406.5.4)**  
 Allowable Height: 12 Tiers  
 Allowable Area: Unlimited

**REQUIRED FIRE RESISTANCE RATINGS**  
 ELEMENT (IBC Table 601/NFPA 101 Table A8.2.1.2) RATING (In Hours)

Primary Structural Frame	2
Bearing Walls:	
Exterior	2
Interior	2
Non-Bearing Walls & Partitions	
Exterior	0
Interior	0
Floor Construction & Secondary Members	2
Floor Construction & Secondary Members	2

**SPECIFIC ROOM RATINGS**  
 RATING (In Hours)

Stairs and Floor Openings	0
Parking Open Ramps	0
Offices + Break Room	0
Electrical	0
Mechanical Room	1
Elevator Shaftway	2

**EXTERIOR WALL PROTECTION**  
 Wall Fire Resistance Rating (Table 602) 0  
 (No rating for 10' or greater per Note c.)  
 Openings Rating (Table 705.8) 0  
 (No rating for 10' or greater per Note g.)

**OCCUPANCY LOADS**  
 NFPA Per Chapter 42.8.1.7: None  
 IBC Per Table 1004.1.2: 1 Per 200 GSF / 454 Per Tier  
 Egress Width Required: Stairs @ 0.3" Per Person 137"  
 Egress Width Provided: 144" (3) 48" Wide Stairs / 152 Persons Each  
 Stair Exit Door Width Required: 30.4"  
 Stair Exit Door Width Provided: 32" Clear Door @ Each Stair

**OPENNESS CALCULATIONS:**

**GROUND FLOOR SUMMARY IBC**  
 IBC 2015 SECTION 406.5  
 GROUND FLOOR WALL AREA: 13,538 SF  
 GROUND FLOOR NET OPEN AREA: 5,010 SF  
 OPENNESS RATIO [20% REQD]: 37%  
 OPENINGS DISTRIBUTED AROUND 56% OF THE PERIMETER [40% REQD]

**GROUND FLOOR SUMMARY NFPA**  
 NFPA 101 3.3.254.6  
 GROUND FLOOR PERIMETER: 1,332 LF  
 GROUND FLOOR NET OPEN AREA: 5,010 SF  
 OPEN AREA PER LF [1.4 SF REQD]: 3.7 SF/LF  
 OPENINGS DISTRIBUTED AROUND 56% OF THE PERIMETER [40% REQD]



Winton Scott Architects  
 5 Main Street  
 Portland, Maine 04101  
 207.774.4811  
 www.winton-scott.com

Appr	
Issued For	
Date	
Rev No	

MMC ST. JOHN ST PG  
 PORTLAND, ME  
 CODE INFORMATION PLANS

Design	Date
MMW	AS NOTED
MMW	6/22/18
Checked	Revised Job Number
MMW	4070.1

G 101

THIS DRAWING IS AN INSTRUMENT OF SERVICE AND SHALL REMAIN THE PROPERTY OF BECKER STRUCTURAL ENGINEERS INC. IT SHALL NOT BE REPRODUCED, COPIED, LENT OR LOANED OR DIRECTLY OR INDIRECTLY USED FOR ANY PURPOSE OTHER THAN FOR WHICH IT IS SPECIFICALLY PROVIDED AND MUST BE RETURNED TO BECKER STRUCTURAL ENGINEERS INC. ON COMPLETION OF WORK, IF REQUESTED.