

GENERAL NOTES:

- 1. EXISTING CONDITIONS, TOPOGRAPHIC INFORMATION, UTILITY LOCATIONS & PROPERTY LINE... 2. ELEVATIONS REFERENCED TO VERTICAL DATUM: NGVD29 / CITY DATUM. 3. REFERENCES REFERENCED TO HORIZONTAL DATUM: WEST, U.S. FOOT STATE PLANE NAD83. 4. THE ENTIRE SITE SHALL BE DEVELOPED AND/OR MAINTAINED AS DEPICTED ON THE SITE PLAN... 5. THE CONTRACTOR SHALL CALL "DIG SAFE" AT 811 AT LEAST 72 HOURS PRIOR TO EXCAVATION... 6. PROPERLY PROTECT AND DO NOT DISTURB PROPERTY IRONS AND MONUMENTS... 7. DO NOT PARK, IMPEDE ACCESS TO, OR STORE EQUIPMENT ON ADJACENT CITY OR PRIVATELY OWNED LOTS... 8. FINAL SETS OF AS-BUILT PLANS SHALL BE SUBMITTED DIGITALLY TO THE PLANNING AND URBAN DEVELOPMENT DEPARTMENT... 9. IF CONTRACTOR PROPOSES TO TEMPORARILY STOCKPILE ANY SURPLUS SOIL AND ROCK IN THE CITY OF PORTLAND... 10. PRIOR TO CONSTRUCTION, A PRECONSTRUCTION MEETING SHALL BE HELD AT THE PROJECT SITE WITH THE CONTRACTOR, ENGINEER, CITY OF PORTLAND DEVELOPMENT REVIEW COORDINATOR... 11. CONTRACTOR IS RESPONSIBLE FOR ALL SNOW REMOVAL AND WINTER MAINTENANCE OF ACCESS PATHS WITHIN THE LIMIT OF WORK. 12. CONTRACTOR SHALL BE RESPONSIBLE FOR ALL RELOCATIONS THAT CONFLICT WITH THE PROPOSED IMPROVEMENTS SHOWN ON THE SITE DRAWINGS... 13. LAND OUTSIDE THE PROPOSED LIMIT OF WORK SHALL NOT BE DISTURBED BY THE CONTRACTOR. 14. THE CONTRACTOR SHALL BE RESPONSIBLE FOR ESTABLISHING AND MAINTAINING ALL CONTROL POINTS AND BENCH MARKS NECESSARY FOR THE WORK. 15. THE CONTRACTOR SHALL COMPLY WITH ALL APPLICABLE LOCAL, STATE AND FEDERAL SAFETY CODES, REGULATIONS, LEGAL REQUIREMENTS, PERMIT CONDITIONS, ETC. 16. THE CONTRACTOR SHALL TAKE ADEQUATE PRECAUTIONS TO PROTECT ALL WALKWAYS, STREETS, PAVEMENTS, CURBING, TREES, PLANTINGS, LAWN, FENCING TO REMAIN ON OR OFF THE PREMISES, AND SHALL REPAIR AND REPLACE AT HIS/HER OWN EXPENSE, AS DIRECTED BY THE ENGINEER, ANY ITEMS DAMAGED AS A RESULT OF THE CONTRACTOR'S WORK. 17. THE CONTRACTOR SHALL PROVIDE ADEQUATE BRACING AND SHORING OF ALL EXCAVATIONS IN ACCORDANCE WITH THE REQUIREMENTS OF ALL GOVERNING CODES AND REGULATIONS. 18. SAWCUTS IN EXISTING PAVEMENT SHALL BE SMOOTH AND STRAIGHT. EXISTING PAVEMENT SHALL BE SAWCUT AND BUTTED TO THE NEW PAVEMENT. NO FEATHERING OF PAVEMENT WILL BE PERMITTED.

- 19. WORK WITHIN PUBLIC RIGHT-OF-WAY SHALL COMPLY WITH APPLICABLE CITY OF PORTLAND AND STATE REQUIREMENTS. 20. IF IMPORTED FILL MATERIAL IS REQUIRED, IT SHALL BE CERTIFIED IN WRITING BY LICENSED GEOLOGIST OR ENGINEER AS NON-CONTAMINATED, CLEAN FILL SUITABLE FOR THE INTENDED USE... 21. RESTORE ALL AREAS DISTURBED BY CONTRACTOR'S OPERATIONS TO ORIGINAL FINISH (GRAVEL, PAVEMENT, RIPRAP, GRASS, ETC.) UNLESS OTHERWISE NOTED ON PLANS. RESTORATION OF ALL AREAS DAMAGED BY CONTRACTOR SHALL BE INCIDENTAL TO THE PROJECT. 22. ALL CURB DAMAGED DURING CONSTRUCTION SHALL BE REPLACED IN KIND AND SHALL CONFORM TO CITY OF PORTLAND SPECIFICATIONS. COST IS INCIDENTAL TO CONTRACT. 23. ALL MATERIAL SHALL BE FURNISHED BY CONTRACTOR UNLESS OTHERWISE NOTED. 24. CONTRACTOR IS RESPONSIBLE FOR FIELD VERIFICATION OF ALL DIMENSIONS PRIOR TO START OF CONSTRUCTION. 25. ALL FULL DEPTH PAVEMENT REPLACEMENT SHALL BE CONSTRUCTED IN ACCORDANCE WITH THE CITY OF PORTLAND TECHNICAL STANDARDS. 26. ALL WORK WITHIN THE RIGHT OF WAY OF CITY STREETS SHALL BE PERFORMED IN ACCORDANCE WITH THE REQUIREMENTS OF THE CITY TRAFFIC ENGINEER. THE CONTRACTOR SHALL SUBMIT A PROPOSED TRAFFIC CONTROL PLAN TO THE TRAFFIC ENGINEER AT LEAST 7 DAYS BEFORE BEGINNING CONSTRUCTION IN ANY STREET... 27. RESTRICT ACCESS TO SITE THROUGH THE USE OF APPROPRIATE SIGNAGE, BARRIERS, FENCES, ETC. SITE SHALL BE LEFT WITH APPROPRIATE SAFETY MEASURES IN PLACE DURING NON-WORKING HOURS. NO TRENCH SHALL BE LEFT OPEN DURING NON-WORKING HOURS. SITE WORK IS THE RESPONSIBILITY OF CONTRACTOR, DURING BOTH WORKING AND NON-WORKING HOURS. 28. CONTRACTOR IS RESPONSIBLE FOR OBTAINING ALL NECESSARY CONSTRUCTION PERMITS. PERMIT APPLICATIONS SHALL BE SUBMITTED WITH ADEQUATE TIME SO AS NOT TO DELAY CONSTRUCTION. 29. THE CONTRACTOR SHALL OBTAIN A CITY STREET OPENING PERMIT BEFORE BEGINNING CONSTRUCTION. THE CONTRACTOR WILL ALSO BE REQUIRED TO HAVE A CURRENT EXCAVATOR'S LICENSE IN THE CITY. 30. ALL WORK IN THE PUBLIC R.O.W. SHALL BE COMPLETED IN ACCORDANCE WITH ARTICLES VI, VII, AND IX OF CHAPTER 24-SEWERS OF THE CITY OF PORTLAND CODE OF ORDINANCES. 31. ALL SEWER CONSTRUCTION IN THE PUBLIC WAY SHALL BE COMPLETED IN ACCORDANCE WITH ARTICLE II OF CHAPTER 24-SEWERS OF THE CITY OF PORTLAND CODE OF ORDINANCES. 32. CONTACT CITY OF PORTLAND ARBORIST AND ENGINEER PRIOR TO CUTTING ROOTS, TRIMMING BRANCHES, OR DISTURBING TREES WITHIN THE R.O.W. THAT NOT HAVE BEEN NOTED FOR REMOVAL ON THE PLANS. 33. ST. JOHN STREET IS A MORATORIUM STREET. EXCAVATION WITHIN STREET WILL NOT BE ALLOWED UNTIL 6-2-2022, EXCEPT IN ACCORDANCE WITH THE CITY OF PORTLAND FIVE-YEAR MORATORIUM STREET RESTORATION REQUIREMENTS AS OUTLINED WITHIN THE RULES AND REGULATIONS FOR EXCAVATION ACTIVITY WITHIN THE PUBLIC RIGHT-OF-WAY... 34. CONTRACTOR SHALL PROVIDE AND MAINTAIN EROSION AND SEDIMENTATION CONTROL MEASURES IN ACCORDANCE WITH THESE PLANS AND THE LATEST EDITION OF THE MAINE DEPARTMENT OF ENVIRONMENTAL PROTECTION'S BEST MANAGEMENT PRACTICES MANUAL... 35. CONTRACTOR IS REQUIRED TO PERFORM ALL WORK IN ACCORDANCE WITH REQUIREMENTS OUTLINED WITHIN THE MAINE CONSTRUCTION GENERAL PERMIT. CONTRACTOR SHALL FILE A NOTICE OF TERMINATION WITH PHOTOGRAPHS AND REQUIRED ATTACHMENTS TO THE MAINE DEPARTMENT OF ENVIRONMENTAL PROTECTION UPON COMPLETION OF THE PROJECT. A DRAFT OF THE NOTICE WILL BE PROVIDED TO THE OWNER AND THE OWNER'S REPRESENTATIVE FOR REVIEW PRIOR TO SUBMISSION. A COPY OF THE NOTICE CAN BE OBTAINED AT: WWW.MAINE.GOV/DEP/LAND/STORMWATER/CONSTRUCTION.HTML

- 36. CONTRACTOR SHALL MAINTAIN EROSION CONTROL AND STORMWATER POLLUTION PREVENTION SYSTEMS IN COMPLIANCE WITH THE REQUIREMENTS OF THE MAINE CONSTRUCTION GENERAL PERMIT (MCGP). CONTRACTOR SHALL CONDUCT AND MAINTAIN RECORDS OF EROSION CONTROL INSPECTIONS PER THE NOTICE OF INTENT TO COMPLY WITH THE MAINE CONSTRUCTION GENERAL PERMIT. CONTRACTOR SHALL PREPARE AND SUBMIT A NOTICE OF TERMINATION TO THE MAINE DEPARTMENT OF ENVIRONMENTAL PROTECTION, UPON COMPLETION OF THE CONSTRUCTION PROJECT. SUBMIT A COPY OF THE INSPECTION RECORDS AND THE NOTICE OF TERMINATION TO THE OWNER AND ARCHITECT. PROVIDE CRANE PADS PER DIRECTION OF CONSULTANT. DEMOLITION NOTES: 1. PRIOR TO THE START OF DEMOLITION, THE CONTRACTOR SHALL OBTAIN ALL NECESSARY PERMITS AND/OR APPROVALS FROM THE CITY OF PORTLAND, AND ALL OTHER AUTHORITIES HAVING JURISDICTION. 2. THE WORD 'DEMOLISH' SHALL IMPLY THE FULL REMOVAL AND PROPER DISPOSAL OF THE ITEM AND ANY APPURTENANCE ITEMS, AS NOTED, OR AS DIRECTED BY THE OWNER OR THEIR REPRESENTATIVE. THE OWNER RETAINS THE RIGHT TO KEEP ANY ITEM NOTED FOR REMOVAL OR DEMOLITION AT THE REQUEST OF THE OWNER OR THEIR REPRESENTATIVE. 3. CONSTRUCTION/DEMOLITION DEBRIS NOT APPROVED FOR REUSE ON-SITE, SHALL BE REMOVED AND DISPOSED OFF SITE IN ACCORDANCE WITH THE REQUIREMENTS OF ALL AUTHORITIES HAVING JURISDICTION. WASTE MANIFEST FORMS DOCUMENTING PROPER OFF-SITE DISPOSAL SHALL BE PROVIDED TO THE SITE/CIVIL ENGINEER AND THE CITY OF PORTLAND. 4. PRIOR TO THE START OF DEMOLITION, THE CONTRACTOR SHALL VERIFY THE LOCATION OF EXISTING UTILITIES TO BE DEMOLISHED OR TO REMAIN PROTECTED DURING CONSTRUCTION. IF ANY DISCREPANCIES ARE FOUND, THE CONTRACTOR SHALL NOTIFY THE OWNER IN WRITING OF THE CONFLICT. 5. THE CONTRACTOR SHALL PROTECT ALL EXISTING UTILITIES TO REMAIN. ANY TEMPORARY SHUT DOWNS REQUIRED TO FACILITATE THE PROPOSED CONSTRUCTION, WHICH MAY AFFECT USES ON ADJACENT PROPERTIES SHALL BE COORDINATED BY THE CONTRACTOR, THE CITY OF PORTLAND AND APPLICABLE UTILITY. 6. CONTRACTOR SHALL REPAIR OR REPLACE ANY STRUCTURES OR UTILITIES DAMAGED DURING CONSTRUCTION. THE CONTRACTOR SHALL PROCEED WITH CAUTION WITHIN THE PROPOSED WORK AREA TO PREVENT ANY INTERRUPTION TO EXISTING UTILITY SERVICE. 7. PRIOR TO CONSTRUCTION, THE CONTRACTOR SHALL PROVIDE A MAINTENANCE AND PROTECTION OF TRAFFIC (MPT) PLAN IN ACCORDANCE WITH ALL LOCAL, STATE AND FEDERAL REQUIREMENTS. 8. CONTRACTOR SHALL COVER CONSTRUCTION DUMPSTERS AND ROLL-OFF CONTAINERS, AND STORE ALL CONSTRUCTION CHEMICALS INSIDE THE CONSTRUCTION TRAILER OR UNDER A COVERED AREA DURING PERIODS WHEN CONSTRUCTION CEASES. LAYOUT AND MATERIALS NOTES: 1. ALL DIMENSIONS AND RADII ARE TO THE FACE OF CURB UNLESS OTHERWISE NOTED.

- GRADING AND DRAINAGE NOTES: 1. CASTINGS FOR EXISTING STRUCTURES TO REMAIN AND PROPOSED STRUCTURES SHALL BE SET TO THE PROPOSED ELEVATIONS SHOWN ON THE DRAWINGS. 2. UNSUITABLE FILL AND BACKFILL MATERIALS ARE MATERIALS CONTAINING EXCESSIVE AMOUNT OF WATER, PLASTIC, CLAY, VEGETATION, ORGANIC MATTER, DEBRIS, PAVEMENT, STONES OR BouldERS OVER 12 INCHES IN GREATEST DIMENSION, FROZEN MATERIAL, AND MATERIAL WHICH, IN THE OPINION OF THE ENGINEER, WILL NOT PROVIDE A SUITABLE FOUNDATION OR SUBGRADE. 3. SUITABLE SOIL SHALL BE PLACED IN LAYERS TO THE REQUIRED ELEVATIONS AS SHOWN ON THE DRAWINGS. FILL, BACKFILL AND COMPACT TO PRODUCE MINIMUM SUBSEQUENT SETTLEMENT OF THE MATERIAL AND PROVIDE ADEQUATE SUPPORT FOR THE SURFACE TREATMENT OR STRUCTURE TO BE PLACED ON THE MATERIAL. PLACE MATERIAL IN APPROXIMATELY HORIZONTAL LAYERS OF BEGINNING AT LOWEST AREA TO BE FILLED. DO NOT IMPAIR DRAINAGE. DO NOT USE ON-SITE TOPSOIL AS FILL MATERIAL. 4. FOR GROUND SURFACE PREPARATION, CONTRACTOR SHALL REMOVE VEGETATION, DEBRIS, UNSUITABLE SOIL MATERIALS, OBSTRUCTIONS, AND DELETERIOUS MATERIALS FROM GROUND SURFACE PRIOR TO PLACEMENT OF FILL. REMOVE MATERIAL TO THE FULL EXTENT OF ROOT PENETRATION. PROOF-ROLL EXISTING GROUND SURFACE PRIOR TO PLACEMENT OF FILL TO PROVIDE A DENSE, STABLE BASE FOR THE FIRST LIFTS OF THE STRUCTURAL FILL. UTILITIES NOTES: 1. ALL PROPOSED UTILITIES (WATER, ELECTRIC, SANITARY, STORM SEWER, ETC.) AND THEIR CONNECTIONS, DISCONNECTION AND RELOCATION OF EXISTING UTILITIES SHALL BE COMPLETED IN ACCORDANCE WITH THE REQUIREMENTS OF THE UTILITY COMPANY HAVING JURISDICTION. ANY COORDINATION WITH THE MUNICIPALITY AND/OR UTILITY COMPANY, PERMITS OR APPROVALS REQUIRED SHALL BE THE RESPONSIBILITY OF THE CONTRACTOR. 2. CONDUIT FOR ELECTRIC LINES SHALL BE WATER-TIGHT IN ADDITION TO CONFORMING TO UTILITY COMPANY REQUIREMENTS. 3. REFER TO ELECTRICAL DRAWINGS PREPARED BY BARILETT DESIGN FOR ELECTRICAL WIRING DIAGRAMS, SCHEDULES, CONDUIT MATERIAL, POWER CONNECTIONS AND ENERGIZATION AND ALL OTHER APPURTENANCES RELATED TO ELECTRICAL WORK FOR THIS PROJECT. 4. ALL PROPOSED ELECTRICAL AND LIGHTING WORK SHOWN ON THESE CIVIL DRAWINGS SHALL BE COORDINATED WITH THE ELECTRICAL PLANS AND SPECIFICATIONS PREPARED BY COMPANY. IN THE EVENT THERE IS A DISCREPANCY BETWEEN THE CIVIL AND ELECTRICAL DRAWINGS, THE ENGINEER SHALL BE NOTIFIED IN WRITING. CLEAN AND/OR FLUSH ALL MANHOLES, CATCH BASINS, AND ASSOCIATED PIPING AFTER THE WORK HAS BEEN COMPLETED. 5. COORDINATE CONSTRUCTION ACTIVITY WITH UTILITY COMPANIES, EMERGENCY SERVICES AND CITY. NOTIFY UTILITY COMPANIES WITHIN 48 HOURS OF WORK ACTIVITY ADJACENT TO THOSE UTILITIES. 6. COORDINATE DISRUPTION OF PRIVATE UTILITY SERVICES WITH LANDOWNERS AT LEAST TWO DAYS (48 HOURS) PRIOR TO DISRUPTION. ALL UTILITY COORDINATION IS RESPONSIBILITY OF CONTRACTOR. CONTRACTOR SHALL BE RESPONSIBLE FOR ALL UTILITY CONNECTION, RETIREMENT, AND COORDINATION FEES. 7. CONTRACTOR SHALL ARRANGE AND PREPARE FOR ALL NECESSARY TEMPORARY UTILITIES AS REQUIRED TO COMPLETE WORK, INCLUDING ANY NECESSARY SUB-METERING OR TEMPORARY CONNECTIONS. 8. ALL WATER LINE (MAINS, SERVICES, HYDRANTS, ETC.) CONSTRUCTION SHALL BE COMPLETED IN ACCORDANCE WITH THE PORTLAND WATER DISTRICT TECHNICAL SPECIFICATIONS. LATEST EDITION. PORTLAND WATER DISTRICT TECHNICAL SPECIFICATIONS SHALL GOVERN IN THE CASE OF ANY AND ALL CONFLICTS IN THE PROJECT CONSTRUCTION DOCUMENTS AT NO ADDITIONAL COST TO OWNER. 9. ALL GAS LINE (MAINS, SERVICES, GATE VALVES, METERS, ETC.) CONSTRUCTION SHALL BE COMPLETED IN ACCORDANCE WITH THE PORTLAND WATER DISTRICT TECHNICAL SPECIFICATIONS. LATEST EDITION. PORTLAND WATER DISTRICT TECHNICAL SPECIFICATIONS SHALL GOVERN IN THE CASE OF ANY AND ALL CONFLICTS IN THE PROJECT CONSTRUCTION DOCUMENTS AT NO ADDITIONAL COST TO OWNER. 10. EXISTING UTILITIES SHOWN ON THESE PLANS WERE COMPILED FROM A FIELD SURVEY PREPARED BY OWEN HASKELL, INC. THESE PLANS DO NOT NECESSARILY DEPICT THE EXACT LOCATIONS OF ALL UTILITIES, WHICH MAY EXIST AT THIS TIME WITHIN THE SURVEY LIMITS. THERE MAY BE EXISTING LINES OTHER THAN THOSE INDICATED, THE LOCATIONS AND ELEVATIONS OF ALL EXISTING UTILITIES SHALL BE CONSIDERED APPROXIMATE AND MUST BE VERIFIED BY THE CONTRACTOR PRIOR TO ANY UTILITY CONNECTIONS OR CROSSINGS OF PROPOSED OR EXISTING UTILITIES. THE CONTRACTOR SHALL REPORT ANY DISCREPANCIES TO THE ENGINEER IN WRITING. THE CONTRACTOR SHALL CONTACT THE RESPECTIVE UTILITY COMPANIES RELATIVE TO THE LOCATIONS AND ELEVATIONS OF THESE LINES. NO SEPARATE OR ADDITIONAL COMPENSATION WILL BE ALLOWED TO THE CONTRACTOR DUE TO ANY VARIANCE BETWEEN THE DATA SHOWN ON THE PLANS AND ACTUAL FIELD CONDITIONS ENCOUNTERED. THE CONTRACTOR IS RESPONSIBLE FOR HIS/HER OWN DETERMINATION AS TO THE TYPE AND LOCATION OF THE EXISTING UTILITIES AS MAY BE NECESSARY TO AVOID DAMAGE AND TO FACILITATE THE PROPOSED CONNECTION(S).

- 11. WHEREVER POSSIBLE, PROVIDE 10 FOOT HORIZONTAL SEPARATION BETWEEN WATER AND SEWER LINES. WHEN THIS HORIZONTAL SEPARATION IS NOT POSSIBLE, INSTALL SEWER LINE AT LEAST 18 INCHES BETWEEN BOTTOM OF WATER LINE AND TOP OF SEWER. 12. FOR SEWER LINE CROSSING WATER LINE TRENCHES, PROVIDE AT LEAST 18 INCHES BETWEEN BOTTOM OF WATER LINE AND TOP OF SEWER. 13. INSULATE ALL SEWER, FORCEMAINS AND WATER MAINS WHICH HAVE LESS THAN 4 FEET OF COVER OR WHERE DIRECTED BY THE ENGINEER. RIGID INSULATION REQUIRED: 2" THICK, BY 4" WIDE, UNLESS OTHERWISE NOTED. COSTS ASSOCIATED WITH INSULATION ARE INCIDENTAL TO CONTRACT. 14. INSTALL THRUST BLOCKS AT ALL BENDS IN FORCEMAIN AND WATER MAIN. SEE CIVIL DETAIL ON SHEET C-202. 15. PROVIDE END CAPS ON ALL UNDERDRAIN PIPING EXCEPT WHERE DAYLIGHTED, UNLESS OTHERWISE NOTED. 16. PRIOR TO THE START OF CONSTRUCTION, CONTRACTOR SHALL DIG TEST PITS TO VERIFY THE LOCATION OF POTENTIAL EXISTING UNDERGROUND UTILITY CONFLICTS. CONTRACTOR SHALL VERIFY LOCATION AND ELEVATION OF ALL EXISTING UTILITIES AT PROPOSED UTILITY CROSSINGS, AND ADVISE THE ENGINEER IN WRITING OF ANY DISCREPANCIES. 17. ALL PROPOSED UTILITIES AND THEIR CONNECTIONS, DISCONNECTION AND RELOCATION OF EXISTING UTILITIES SHALL BE COMPLETED IN ACCORDANCE WITH THE REQUIREMENTS OF THE UTILITY COMPANY HAVING JURISDICTION. ANY COORDINATION WITH THE MUNICIPALITY AND/OR UTILITY COMPANY, PERMITS OR APPROVALS REQUIRED SHALL BE THE RESPONSIBILITY OF THE CONTRACTOR. 18. UNLESS OTHERWISE SPECIFIED, PIPE FOR STORM DRAINS SHALL BE MATERIAL OR APPROVED EQUAL, WITH WATER TIGHT JOINTS, PIPE JOINTS, FITTINGS AND OTHER APPURTENANCES SHALL BE IN ACCORDANCE WITH SECTION X.

DRAWING INDEX

Table with columns: Sheet Number, Sheet Title, Sheet Description. Includes sections for CIVIL, LANDSCAPING, ARCHITECTURAL, STRUCTURAL, and ELECTRICAL.

ABBREVIATIONS

Table mapping abbreviations to full names. Includes symbols for ground, curb, wall, catch basin, pipe, etc.

LEGEND

Table mapping symbols to existing and proposed features like contour, sewer, manhole, gate, etc.

LEGEND

Table mapping symbols to existing and proposed features like sanitary sewer manhole, clean out, drainage manhole, etc.

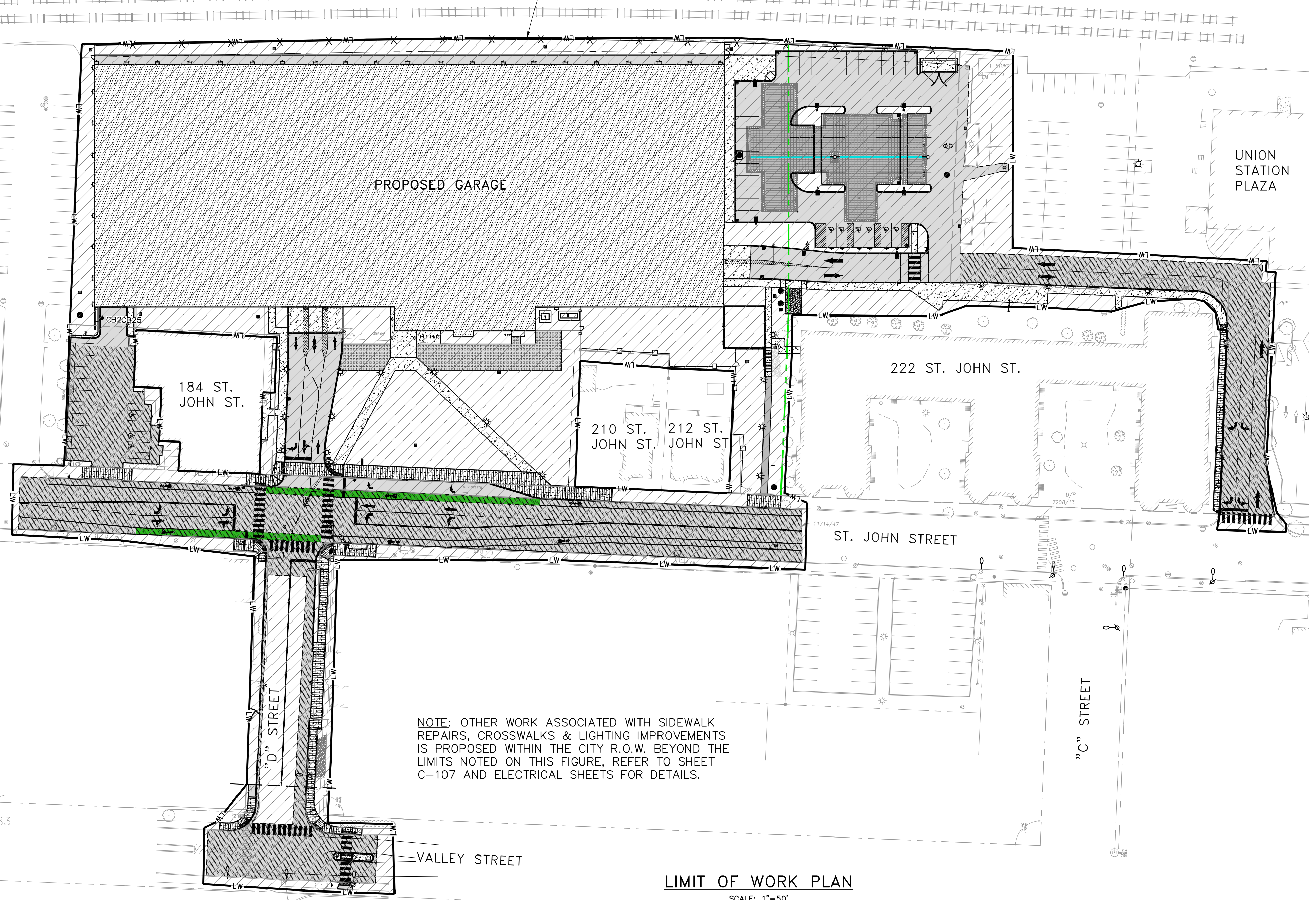

LEVEL III SITE PLAN APPLICATION - NOT FOR CONSTRUCTION. SCALE: 1"=50'

Vertical sidebar containing project information: 41 HUBBINS DRIVE, PORTLAND, MAINE 04102. COMMITMENT & INTEGRITY DRIVE RESULTS. MAINE MEDICAL CENTER, 22 BRAMHALL STREET, PORTLAND, ME 04102. MWC ST. JOHN STREET EMPLOYEE PARKING GARAGE. JOB NO: 0231158-00, DATE: JUNE 22, 2018, SCALE: N.T.S., SHEET: 1 OF 17. G-001