



GRADE LEVEL PARKING GARAGE LIGHTING STATISTICS:

AS DESIGNED	RECOMMENDED BY THE IESNA*
AVERAGE: 3.9 FC	
MAXIMUM: 8.6 FC	
MINIMUM: 1.1 FC	1.0 FC (or greater)
AVERAGE-TO-MINIMUM UNIFORMITY RATIO: 3.5-TO-1	
MAXIMUM-TO-MINIMUM UNIFORMITY RATIO: 7.8-TO-1	10.0 -TO-1 (or lesser)

NORTH PARKING LIGHTING STATISTICS:

AS DESIGNED	RECOMMENDED BY THE IESNA*
AVERAGE: 1.9 FC	
MAXIMUM: 2.6 FC	
MINIMUM: 0.6 FC	0.5 FC (or greater)
AVERAGE-TO-MINIMUM UNIFORMITY RATIO: 3.1-TO-1	
MAXIMUM-TO-MINIMUM UNIFORMITY RATIO: 4.3-TO-1	4.0-TO-1 (or lesser)
	15.0 -TO-1 (or lesser)

GRADE LEVEL GARAGE PLAN SHOWN

* RECOMMENDED ILLUMINANCE LEVELS ARE PUBLISHED BY THE ILLUMINATING ENGINEERING SOCIETY OF NORTH AMERICA IN RP-20-14 LIGHTING FOR PARKING FACILITIES.

1 GRADE LEVEL LIGHTING CALCULATION PLAN
SCALE: 1" = 20'-0"

CALCULATED ILLUMINANCE LEVELS ARE INDICATED AS INITIAL FOOTCANDLES AT GRADE.

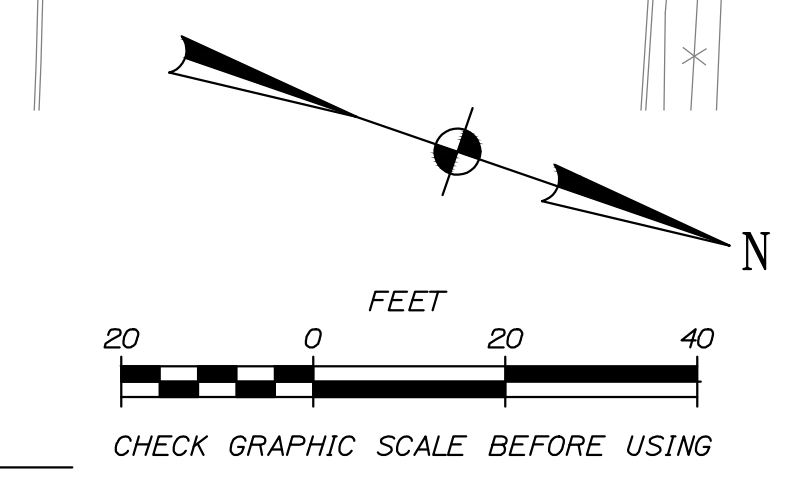

NOT FOR CONSTRUCTION
LEVEL III SITE PLAN APPLICATION
6/22/18

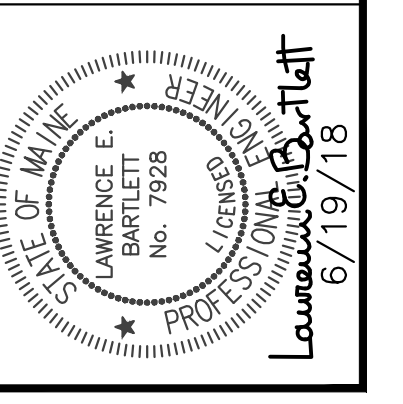

Appoint	
Date	
Rev. No.	

Designed LEB	Scale 1" = 20'-0"
Drawn LEB	Date 06/22/18
Checked LEB	Project Job Number 4070