



centered around you

Updated Signage Plan

Site Plan Application #1

East Tower Expansion, Visitor Garage Expansion, Central Utility Plant Upgrade

January 5, 2018

Attached is the updated signage plan for Maine Medical Center's Bramhall Campus. This plan reflects existing conditions. No changes are planned as part of MMC's Site Plan #1 for the East Tower Expansion, Visitor Garage Expansion, and Central Utility Plan upgrade.



Maine Medical Center

PORTLAND CAMPUS

Environmental Graphics & Wayfinding

Exterior Sign System

City of Portland Submittal

05 January 2018



ENVIRONMENTAL GRAPHICS

Gamble Design LLC

154 Maplewood Avenue
Portsmouth NH 03801

603.427.1300

ARCHITECTURE/INTERIOR DESIGN

TROJung Brannen

22 Boston Wharf Road
Boston MA 02210

617.502.3400

SITE/LANDSCAPE

Sebago Technics

1 Chabot Street
Westbrook ME 04092

207.856.0277

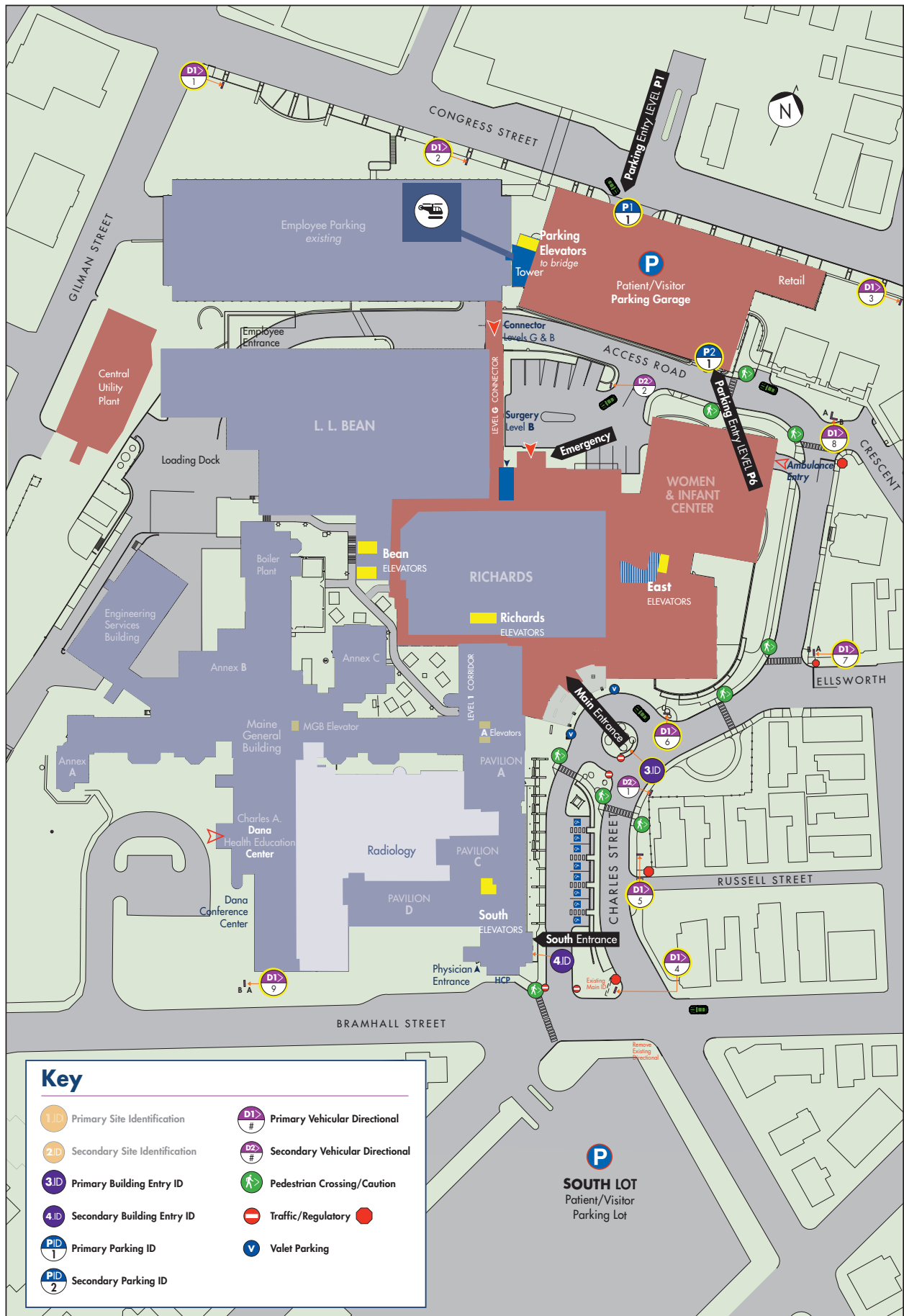

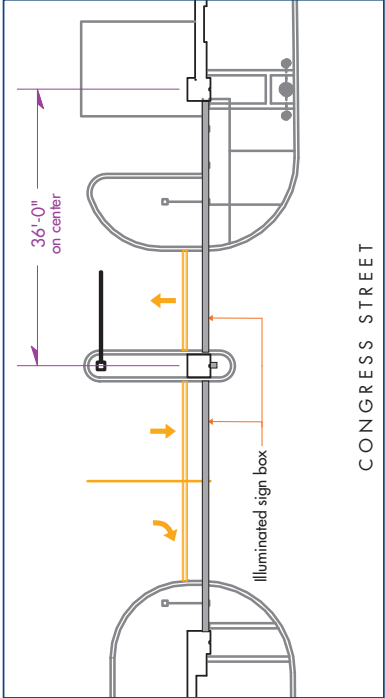
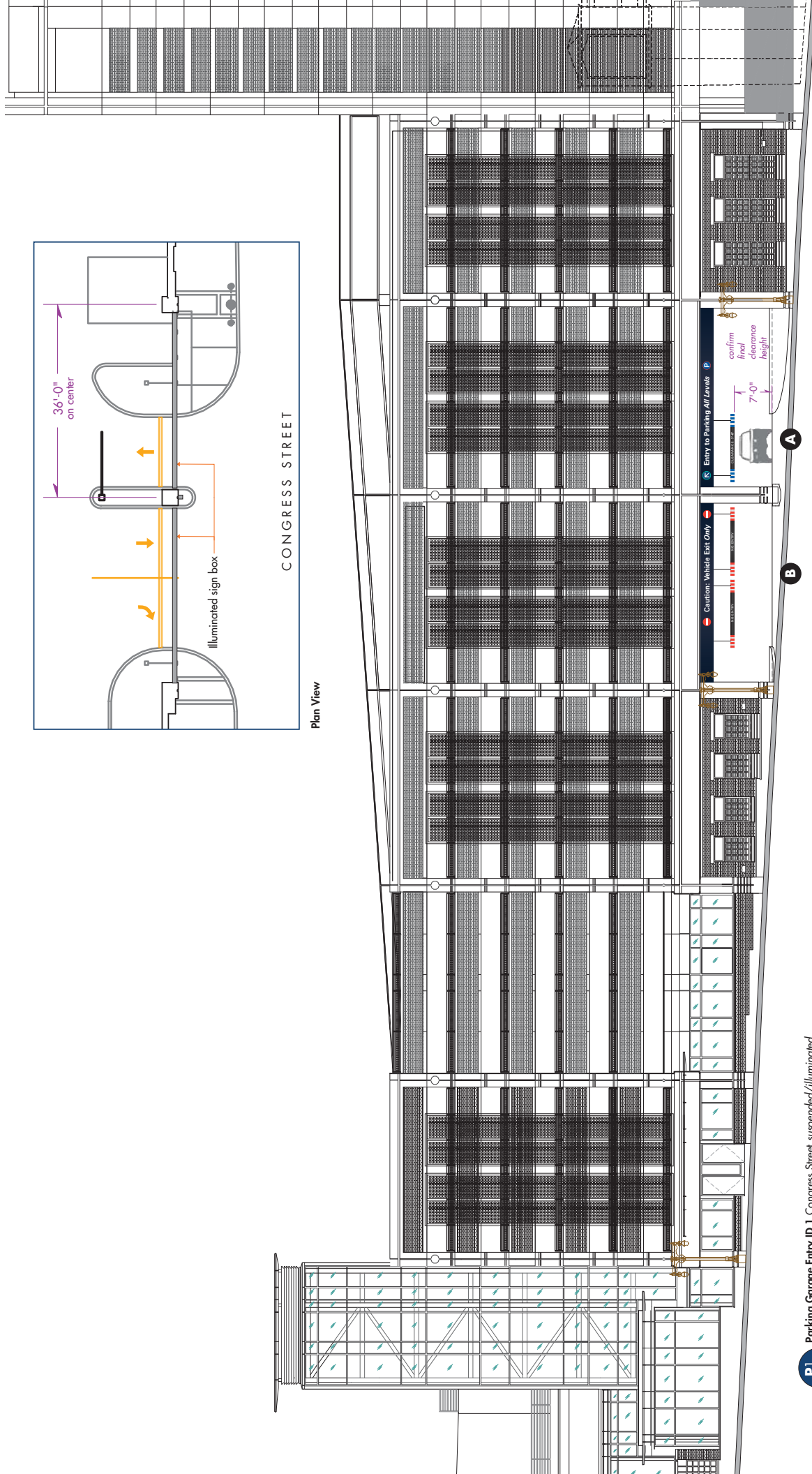

Plan View

CONGRESS STREET

PL Parking Garage Entry ID 1 Congress Street suspended/illuminated
 Scale: 1/16" = 1'-0"

ME Maine Medical Center
 MaineHealth
SIGN STANDARDS

ENVIRONMENTAL GRAPHICS
Gamble Design LLC
 154 Maplewood Avenue
 Portsmouth NH 03801
 603.427.1300

DRAWING N°
PL.1
DRAWING TITLE
Parking Garage Entry ID Congress Street
 Sign boxes/internally illuminated
 Scale: as shown
 29 October 2009



1 Parking Garage Entry ID view eastward up Congress Street
Scale: relative to image



Marquee Sign projecting/double sided
Grid armature fabricated from 4" square aluminum extrusion with horizontal 3" sq. steel structural supports; MPC paint color: "Satin Aluminum" to match new exterior signs; "PARK" letterforms are 1/4" clear "push-thru" graphics in colors shown captured by 5" deep satin aluminum disks; Disks internally illuminated by LED and mounted flush to grid structure. Price static sign box or changeable LED message boards as options.

PI Parking Garage Entry ID view across Congress Street
B Scale: relative to image

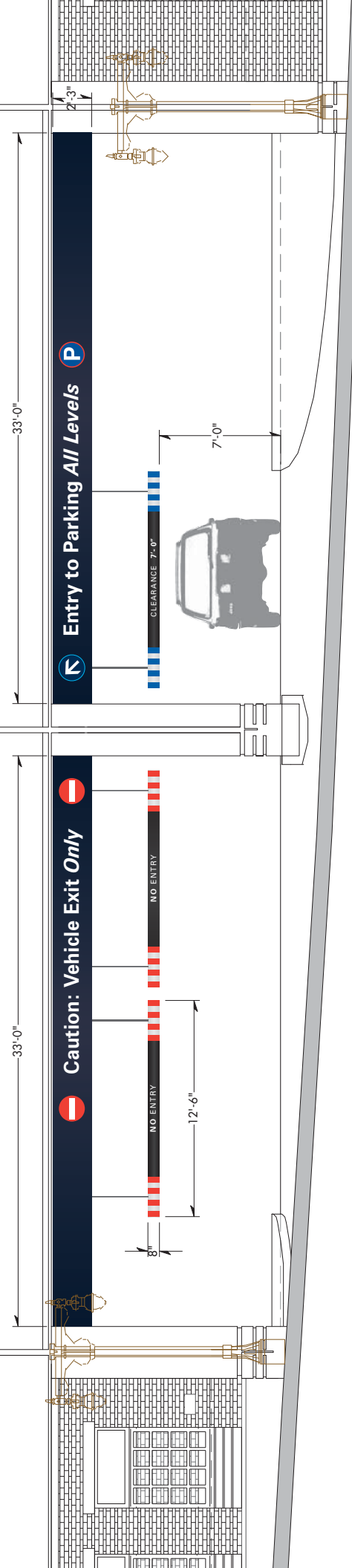
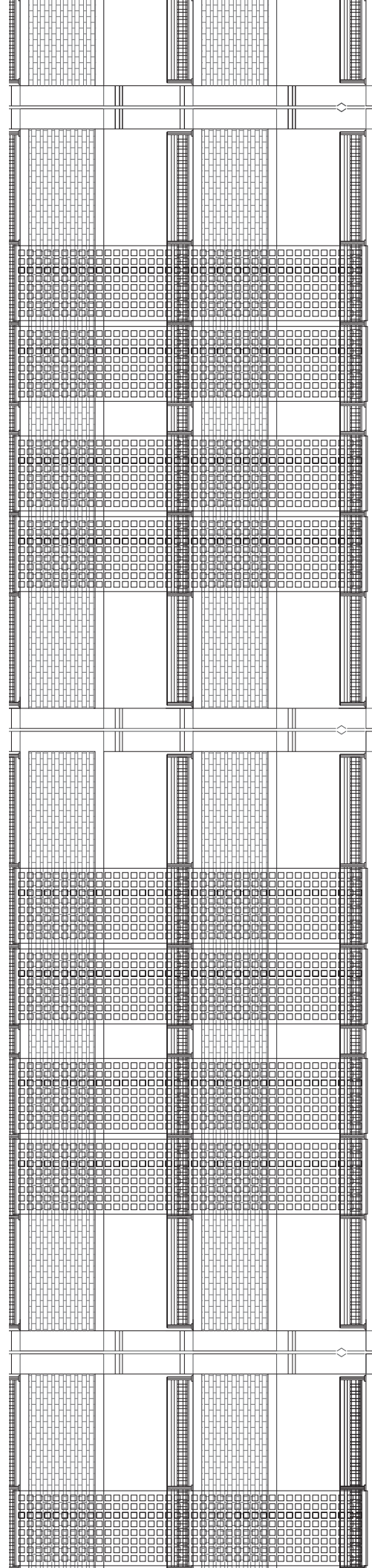

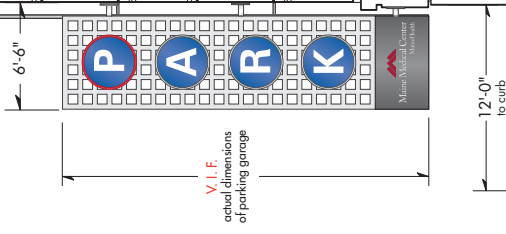
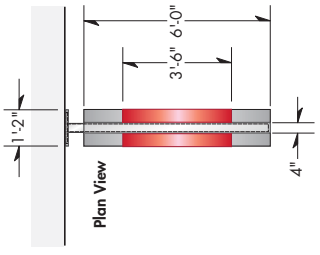
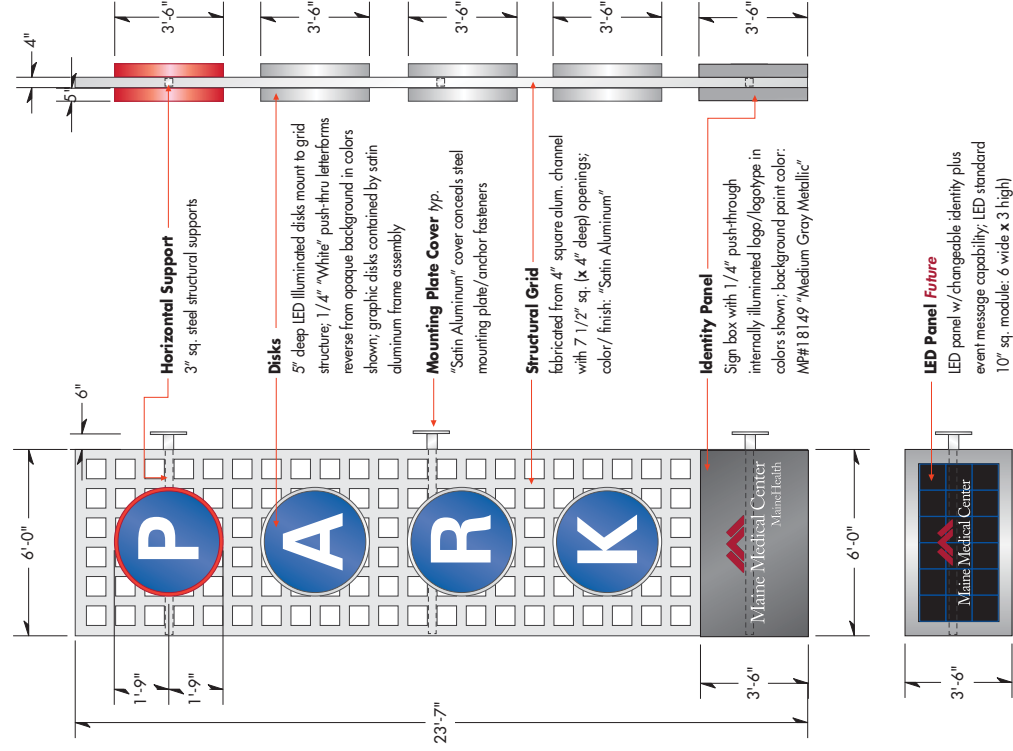

A Projecting Parking Entry ID Side/Front Elevation Revised
Scale: 1/4" = 1'-0"

PID 1A Projecting Parking Entry ID view up Congress Street illuminated/dimensional
Scale: 1/8" = 1'-0"

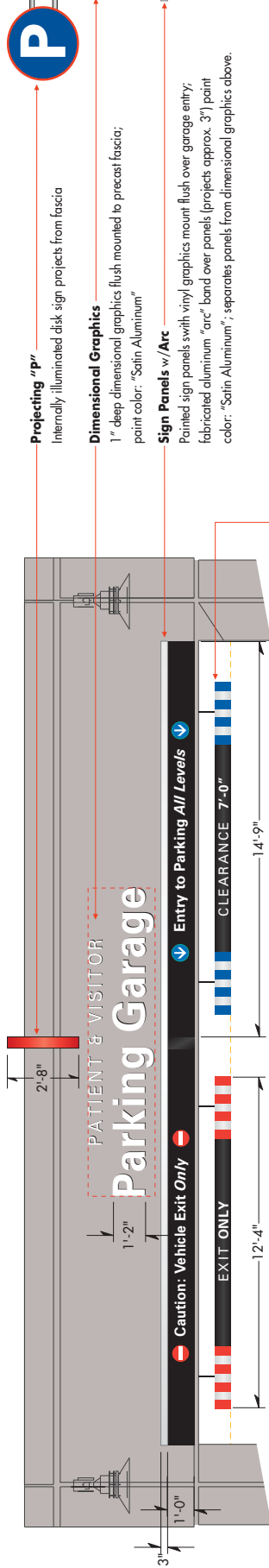

Design Layout no MMC identity
Scale: 1/4" = 1'-0"

- Projecting "P"**
Internally illuminated disk sign projects from fascia
- Dimensional Graphics**
1" deep dimensional graphics flush mounted to precast fascia; paint color: "Satin Aluminum"
- Sign Panels w/Arc**
Painted sign panels with vinyl graphics mount flush over garage entry; fabricated aluminum "arc" band over panels (projects approx. 3") paint color: "Satin Aluminum"; separates panels from dimensional graphics above.

Clearance Bar typical
7" diameter painted acrylic tubing or equal suspends from precast structure above; Verify drop height

P2 Parking Garage Secondary Entry ID South Elevation dimensional graphics w/illuminated disk
Scale: 1/16" = 1'-0"

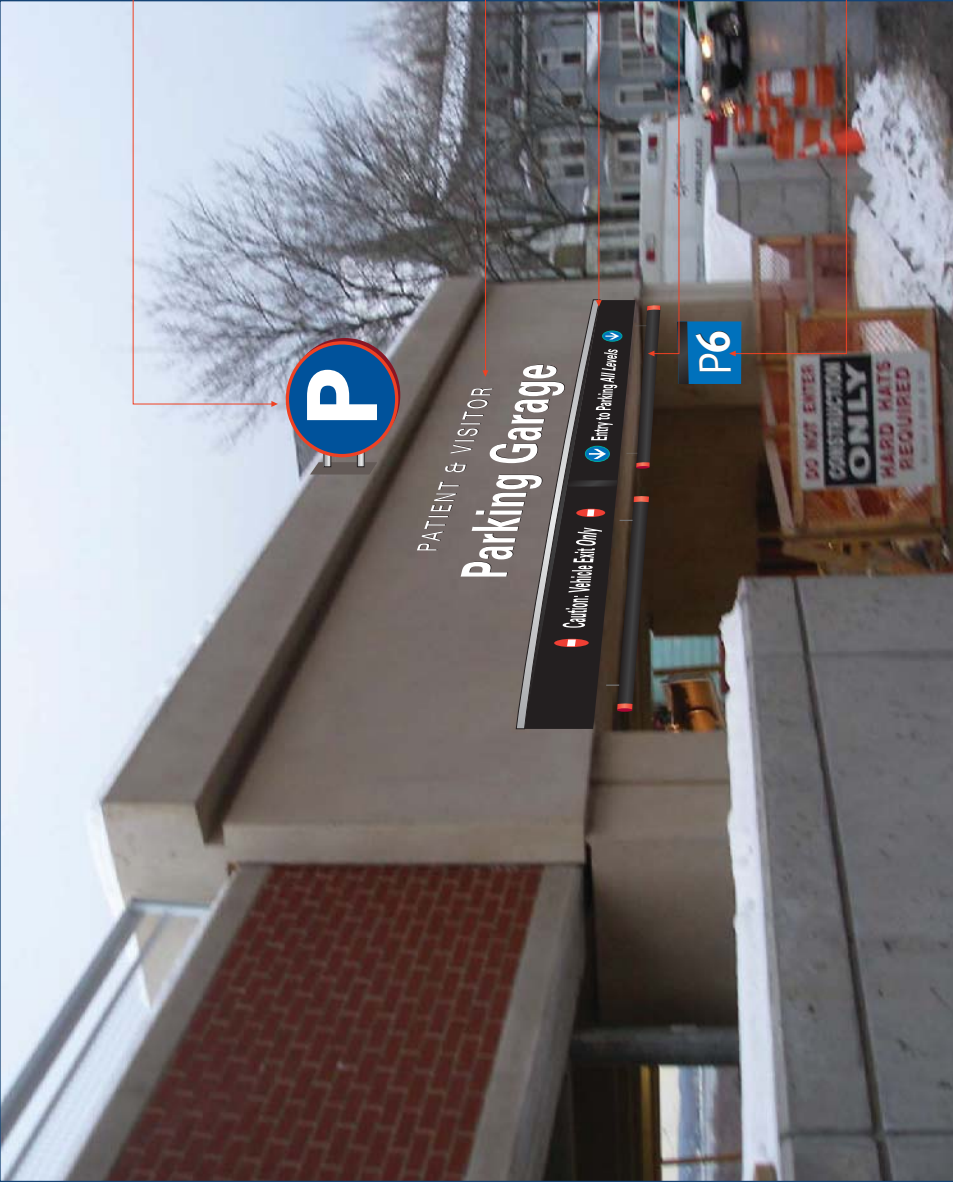

Projecting Sign

Parking symbol disk projects from concrete column; internally-illuminated/double-sided

Dimensional Graphics

Non-illuminated dimensional graphics/panels flush mounted to concrete fascia.

Sign Panel

Sign panels with vinyl graphics mount flush over parking garage entry; 3" arc band above panels; color: "Satin Aluminum"

Clearance Bar typical

Painted plastic tube with vinyl graphics suspended from ceiling; graphic layout shown on dwg. #P2.1; clearance height TBD

Level ID

Painted sign panel with vinyl graphics

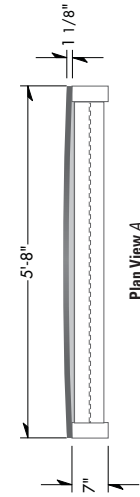

Plan View A

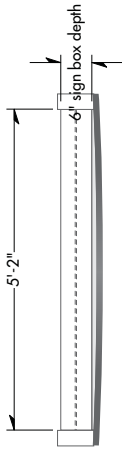

Plan View B

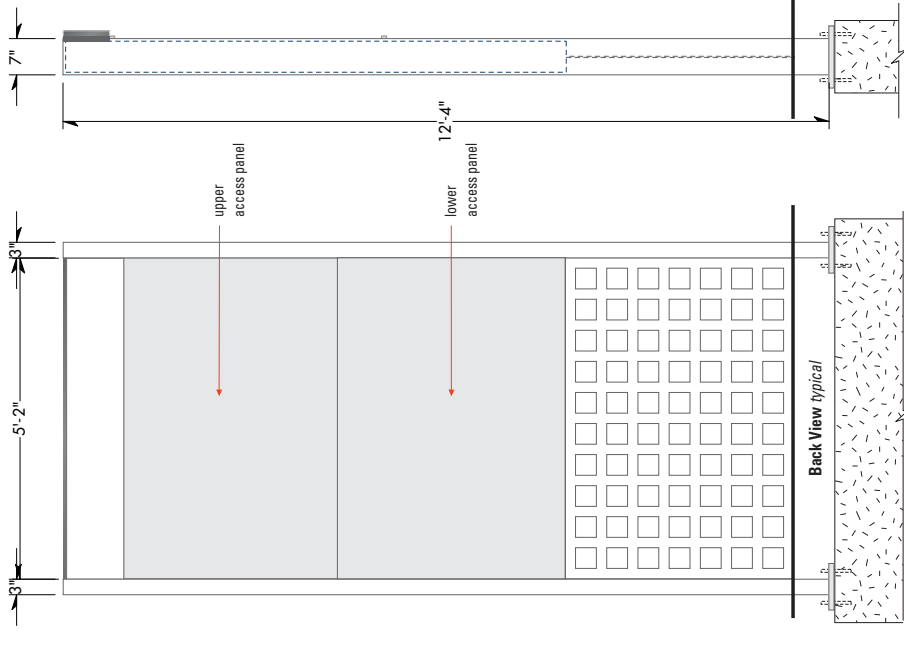

Side View

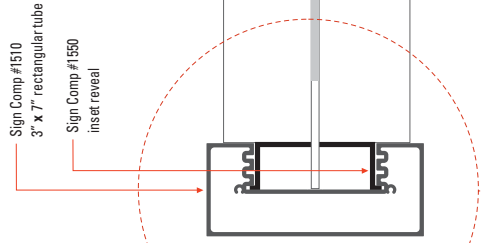
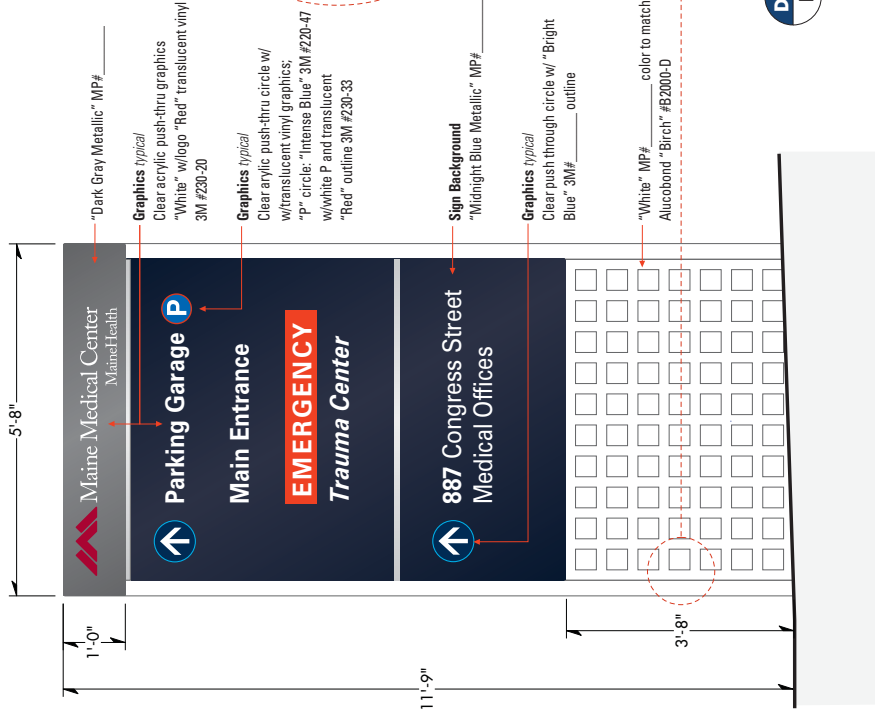

D1 Sign Post/Grid Detail
B Scale: 3" = 1'-0"

D1 Primary Directional Sign 1
 Scale: 1/2" = 1'-0"

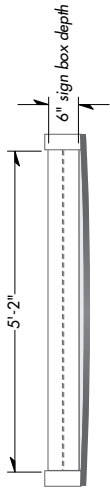

Top View typical

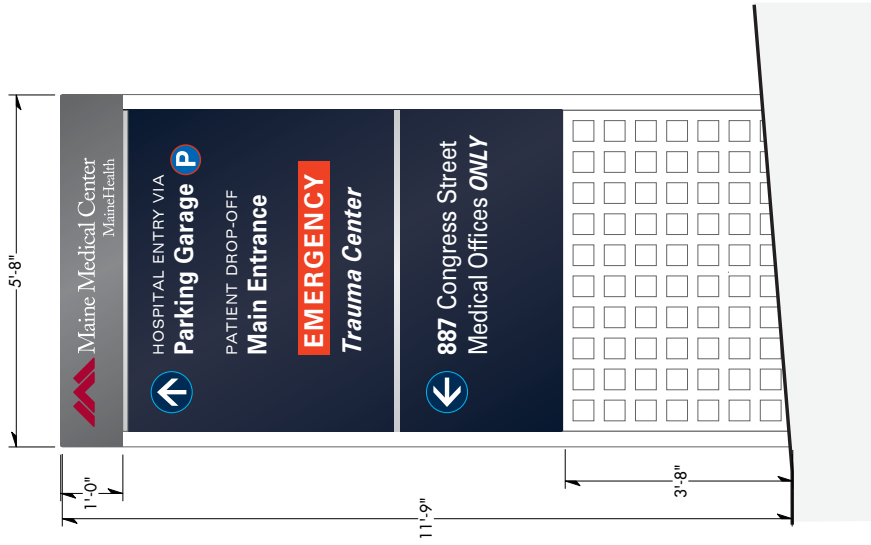

D1 Primary Directional Sign D1-2
Scale: 1/2" = 1'-0"

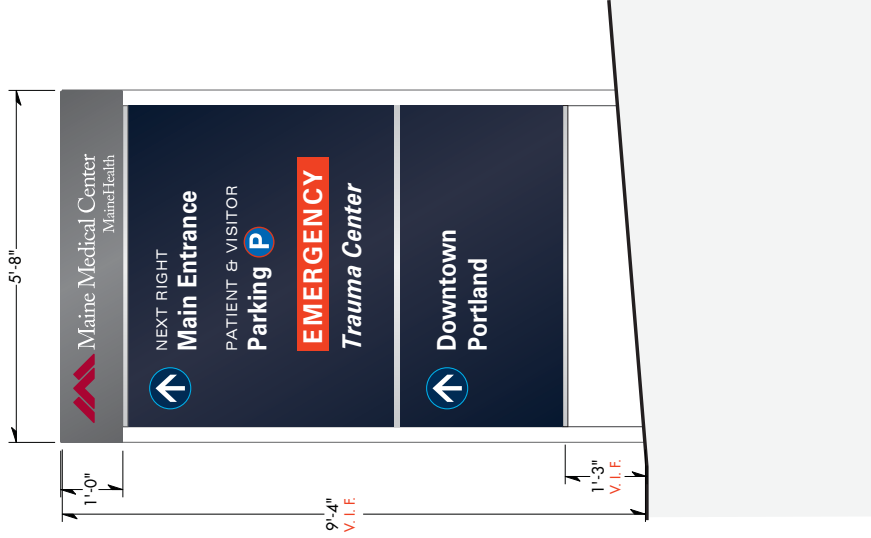

D1 Primary Directional Sign D1-3
Scale: 1/2" = 1'-0"

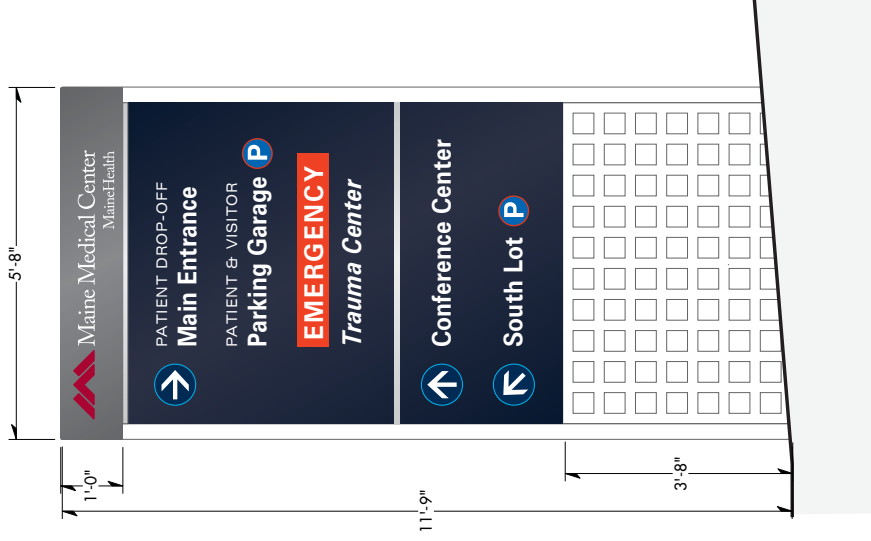

D1 Primary Directional Sign D1-4
Scale: 1/2" = 1'-0"



ENVIRONMENTAL GRAPHICS
Gamble Design LLC
154 Maplewood Avenue
Portsmouth, NH 03801
603.427.1300

ARCHITECTURE
TRO Jung Brannen
22 Boston Wharf Road
Boston, MA 02210
617.502.3400

DRAWING TITLE
Primary Directional Sign + Trauma Center
Freestanding/Illuminated
Scale: as shown
22 April 2008

DRAWING N°

Maine Medical Center
PORTLAND CAMPUS

D1.2-4

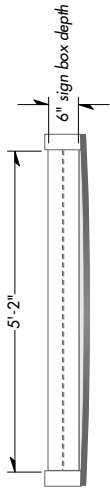

Top View typical



D1-5 Primary Directional Sign D1-5
Scale: 1/2" = 1'-0"

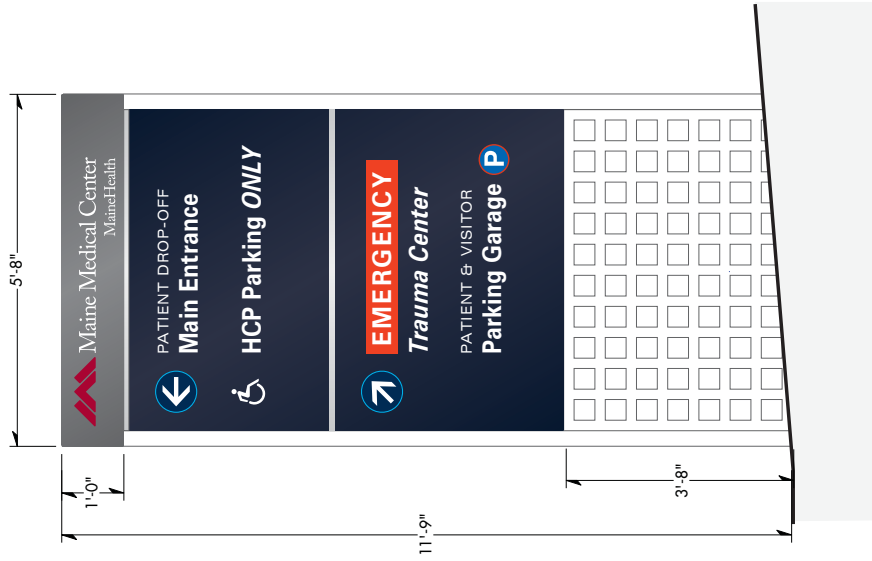

D1-6 Primary Directional Sign D1-6
Scale: 1/2" = 1'-0"

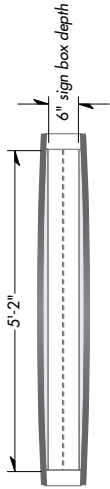

Top View D1.7 double-sided

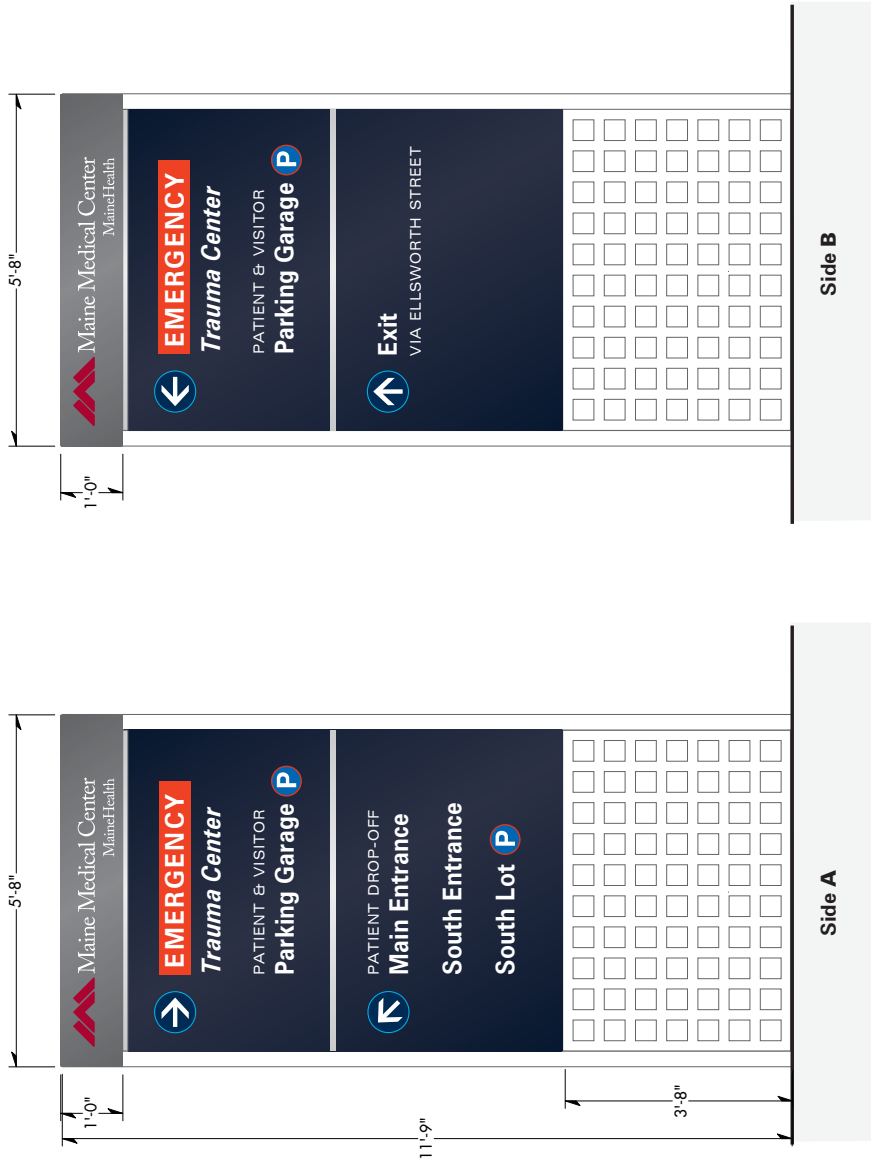

D1.7
Primary Directional Sign Double-sided D1.7 side A
Scale: 1/2" = 1'-0"

Primary Directional Sign Double-sided D1.7 side B
Scale: 1/2" = 1'-0"

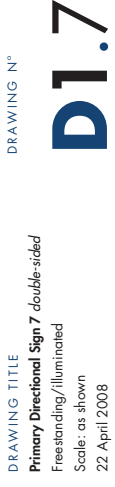
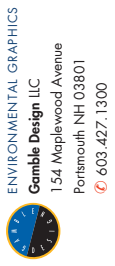

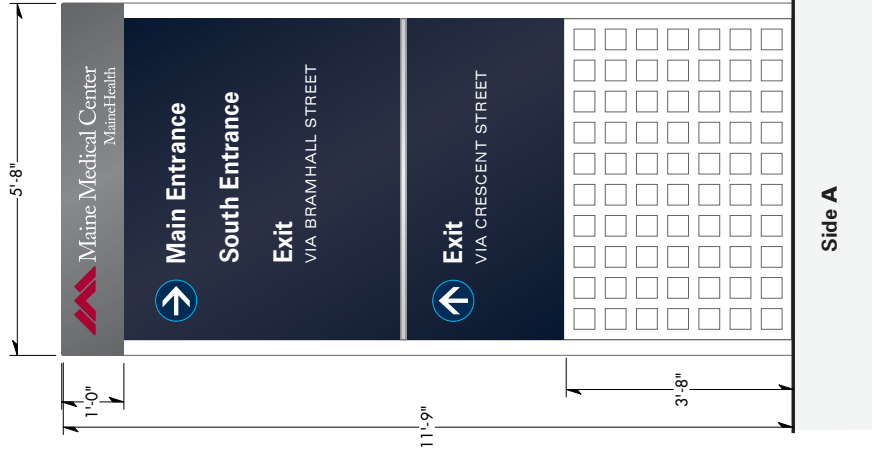

D1 Primary Directional Sign D1-8A
8A Scale: 1/2" = 1'-0"

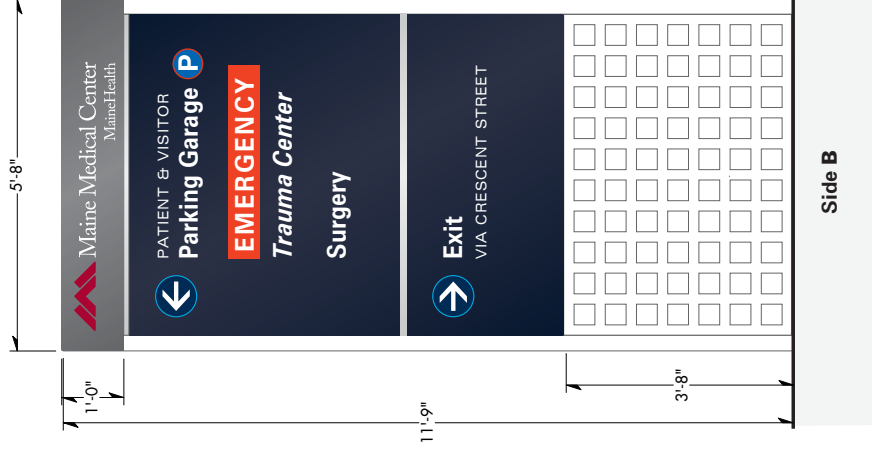

D1 Primary Directional Sign D1-8B
8B Scale: 1/2" = 1'-0"

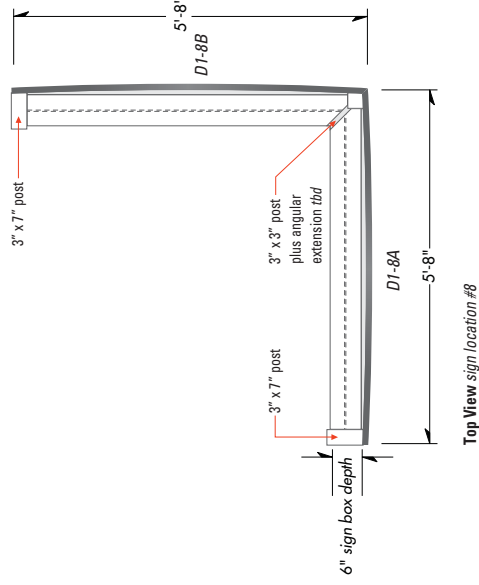

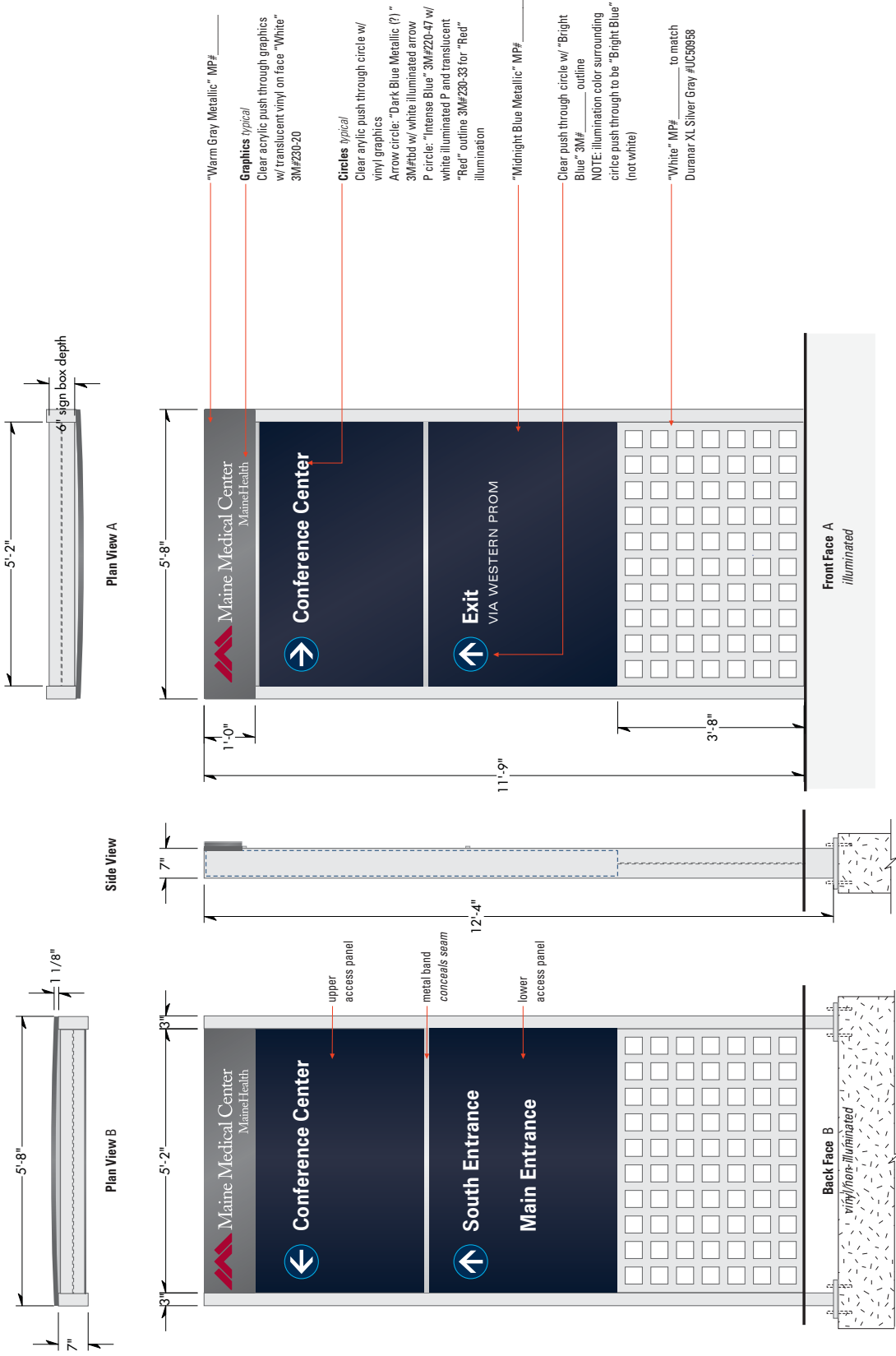

D19
 Primary Directional Sign Revised
 Scale: 1/2" = 1'-0"



ENVIRONMENTAL GRAPHICS
Gamble Design LLC
 154 Maplewood Avenue
 Portsmouth, NH 03801
 ☎ 603.427.1300

ARCHITECTURE
TRO Jung Brannen
 22 Boston Wharf Road
 Boston, MA 02210
 ☎ 617.502.3400

DRAWING TITLE
Primary Directional Sign 9
 Freestanding/Illuminated
 Scale: as shown
 22 April 2008

DRAWING N°
D1.9

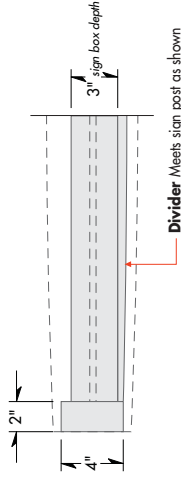

Detail 1 1 1/2" = 1'-0"

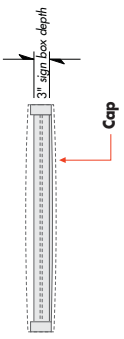

Top View typical

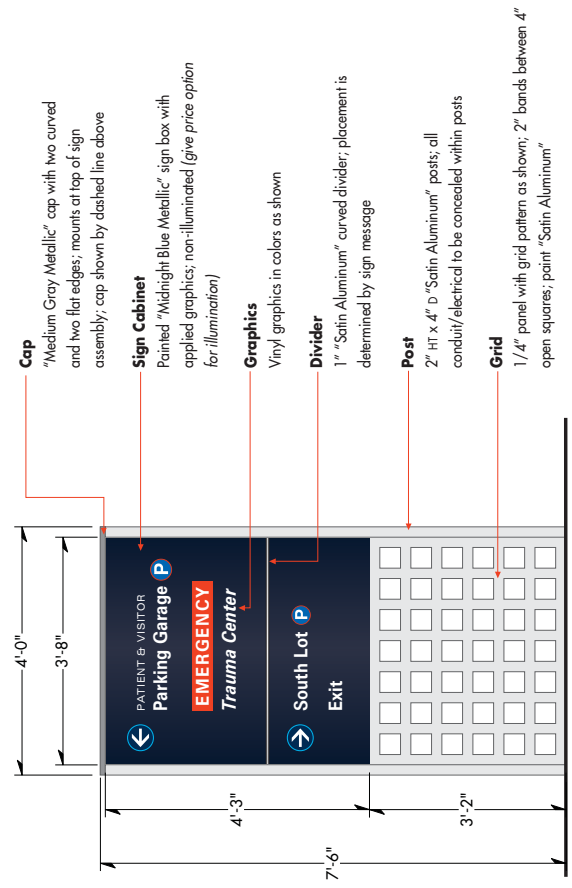

Cap

"Medium Gray Metallic" cap with two curved and two flat edges; mounts at top of sign assembly; cap shown by dashed line above

Sign Cabinet

Painted "Midnight Blue Metallic" sign box with applied graphics; non-illuminated (give price option for illumination)

Graphics

Vinyl graphics in colors as shown

Divider

1" "Satin Aluminum" curved divider; placement is determined by sign message

Post

2" HT x 4" D "Satin Aluminum" posts; all conduit/electrical to be concealed within posts

Grid

1/4" panel with grid pattern as shown; 2" bands between 4" open squares; paint "Satin Aluminum"

D2 Secondary Directional Sign
1 Scale: 1/2" = 1'-0"

D2 Secondary Directional Sign
2 Scale: 1/2" = 1'-0"