

H1 KEY PLAN

1/16"=1'-0"

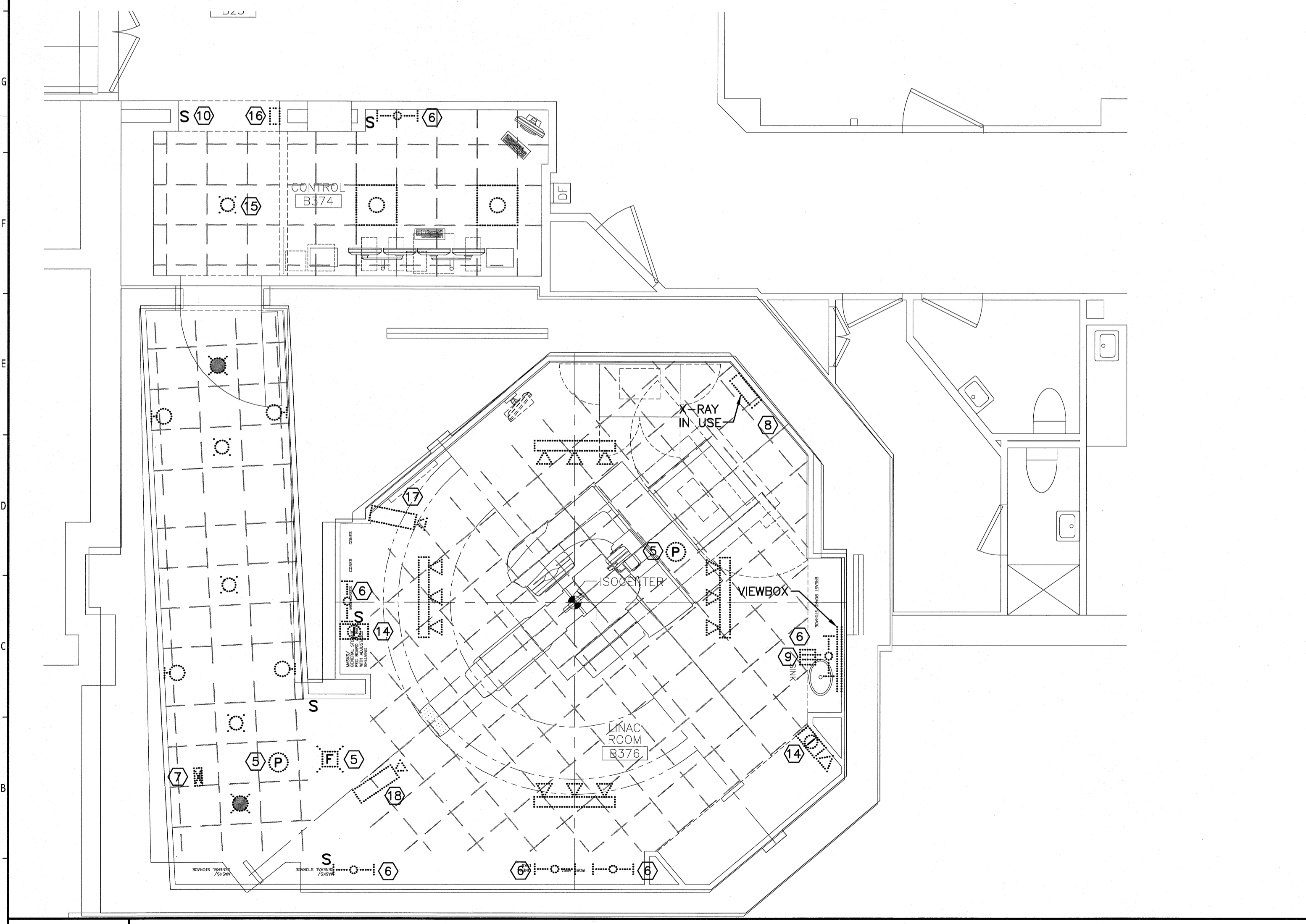

A1 DEMOLITION PLAN

1/4"=1'-0"

**NOTE:**

- 1. SEE SHEET E-001 FOR LEGEND AND GENERAL NOTES.

**KEYED NOTE:**

- ① FURNISH AND INSTALL NEW 150A,3P CIRCUIT BREAKER IN NORMAL SWITCHBOARD "BB1" BLANK SPACE #2 FOR NEW 480V,3# LINAC POWER CONDITIONER FEED. BREAKER TO MATCH EXISTING MANUFACTURER, STYLE AND AIC RATINGS.
- ② EXISTING 208V,3# FEEDER TO LINAC POWER CONDITIONER TO BE REMOVED FROM NORMAL 208V SWITCHBOARD "BA" AND EXTENDED TO NORMAL 480V SWITCHBOARD "BB1". FEEDERS FROM "BA" 150A,3P CIRCUIT BREAKER #14 SHALL BE DISCONNECTED, BREAKER LABELED SPARE, AND EXISTING FEEDER PULLED BACK, SPLICED, AND EXTENDED TO SWITCHBOARD "BB1" NEW 150A,3P BREAKER. INTERCEPT FEEDER, PROVIDE SPLICE BOX, SPLICES, AND EXTEND NEW CONDUCTORS AS REQUIRED FOR CONNECTION. SEE KEYED NOTE 1.
- ③ EQUIPMENT ROOM B519 - EXISTING 50KVA POWER CONDITIONER WIRING TO BE DISCONNECTED AND EQUIPMENT REPLACED BY VARIAN. EXTEND AND RECONNECT INCOMING FEEDER AND OUTGOING LINAC CIRCUIT BREAKER SUB-FEED TO NEW 110KVA POWER CONDITIONER UNIT. PROVIDE WIRING FROM OUTPUT CONNECTIONS FOR NEW FEEDERS TO 60A 480V,3# OBI BREAKER AND 30A, 120V LOAD CENTER "LA1A" AS INDICATED ON INTERCONNECTION DIAGRAM. COORDINATE WITH INSTALLER AND ACTUAL EQUIPMENT SUPPLIED.
- ④ NEW FLUSH MOUNT LOAD CENTER "LA1A" TO BE INSTALLED AS INDICATED ON POWER PLANS.
- ⑤ EXISTING FIRE ALARM DEVICE TO BE REMOVED AND REINSTALLED AS INDICATED ON SYSTEMS PLAN.
- ⑥ EXISTING 2' LIGHT FIXTURE TO BE REMOVED AND REINSTALLED AS INDICATED ON LIGHTING PLANS OR RETURNED TO OWNER.
- ⑦ EXISTING EXIT SIGN TO BE REMOVED AND REINSTALLED AS INDICATED ON LIGHTING PLANS.
- ⑧ EXISTING "X-RAY IN USE" SIGN TO BE REMOVED AND REINSTALLED AS INDICATED ON LIGHTING PLANS.
- ⑨ EXISTING RECEPTACLE DEVICE TO BE REMOVED AND REINSTALLED AS INDICATED ON POWER PLANS.
- ⑩ EXISTING LIGHT SWITCH TO BE REMOVED AND REPLACED AS INDICATED ON LIGHTING PLANS.
- ⑪ EXISTING 208V,3#,4W 100A LOAD CENTER "LA1" TO BE MAINTAINED.
- ⑫ EXISTING LINAC 150A,3P MAIN CIRCUIT BREAKER TO BE MAINTAINED.
- ⑬ NEW 60A,3P OBI MAIN CIRCUIT BREAKER TO BE INSTALLED AS INDICATED ON POWER PLANS
- ⑭ EXISTING INTERCOM STATION TO BE REMOVED AND REINSTALLED AS INDICATED ON SYSTEMS PLANS.
- ⑮ EXISTING 8" COMPACT FLUORESCENT DOWNLIGHT TO BE REMOVED AND REINSTALLED AS INDICATED ON LIGHTING PLANS.
- ⑯ EXISTING EMERGENCY LIGHTING CONTROL RELAY TO BE REMOVED AND LIFE SAFETY BRANCH CIRCUIT BE EXTENDED TO NEW RELAY IN TYPE B2 FIXTURES AS INDICATED ON LIGHTING PLANS.
- ⑰ EXISTING CCTV CAMERA TO BE REMOVED AND REPLACED W/ NEW EQUIPMENT AT THE SAME LOCATION AS INDICATED ON SYSTEMS PLANS.
- ⑱ EXISTING CCTV CAMERA TO BE REMOVED AND REPLACED W/ NEW EQUIPMENT AT A NEW LOCATION AS INDICATED ON SYSTEMS PLANS.

144 Fore Street P.O. Box 618  
Portland, Maine 04104  
tel. (207) 772-3846  
fax. (207) 772-1070  
www.smartinc.com

ARCHITECTURE  
ENGINEERING  
PLANNING  
INTERIOR DESIGN  
COMMISSIONING

**SMART**

STATE OF MAINE  
DANIEL J. BETTS  
NO. 8838  
LICENSED PROFESSIONAL ENGINEER  
9/19/08

MAINE MEDICAL CENTER  
LINAC REPLACEMENT PROJECT  
22 BROWN HALL ST PORTLAND, MAINE

ISSUED FOR CONSTRUCTION  
9-19-08

REV	DATE	DESCRIPTION
0	9-19-08	ISSUED FOR CONSTRUCTION

GRAPHIC SCALE:  
0" 1"

SCALE: 1/4"=1'-0"

PROJECT MANAGER: CDP  
IC/DRAWN BY: CDS  
A/E OF RECORD: DJT  
CAD FILE: E-101-08134  
PROJECT NO.: 08134  
DATE: 9-19-08  
SHEET TITLE:

KEY PLAN AND DEMOLITION PLAN

SHEET No. E-101  
© COPYRIGHT 2008 SMART INC.