

**PLUMBING WORK NOTE:**

1 PROVIDE RECESSED HOT & COLD WATER VALVES IN VALVE CABINET FOR PATIENT BATHROOMS. ONE VALVE BOX PER TWO ADJACENT BATHROOMS. KEY ACCESS SECURITY VALVE CABINET AND VALVES SHALL BE LOCATED IN CORRIDOR AS INDICATED.

**MorrisSwitzer**  
Environments for Health

Williston, Vermont  
Boston, Massachusetts  
Portland, Maine

One Dana Street  
Portland, ME 04101  
t 207.773.8841  
f 207.773.8840

© 2009 MorrisSwitzer morriswitzer.com

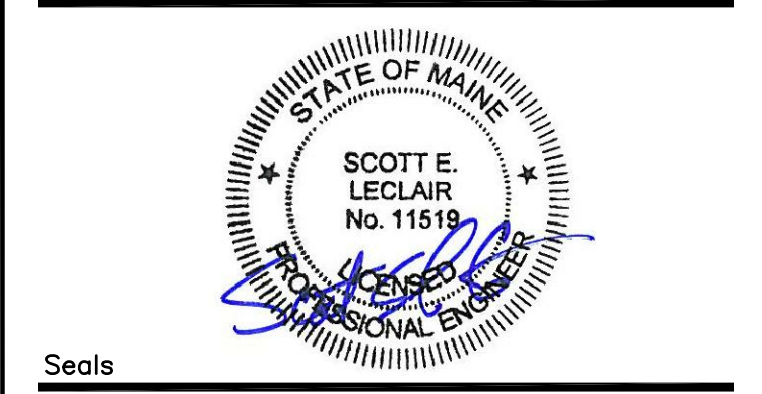

**BECKER**  
structural engineers, inc.

75 York Street  
Portland, ME 04101-4701  
info@beckerstructural.com

Tel 207-879-1838  
Fax 207-879-1822  
www.beckerstructural.com

Consultant

**MECHANICAL / ELECTRICAL ENGINEERS**

92 Montvale Ave, Suite 4100  
Saco, ME 04158  
Tel: 781-481-0210  
Fax: 781-481-0203  
email: info@f-t.com  
www.f-t.com

**FITZMEYER & TOCCI**  
ASSOCIATES, INC.

Project No.: 09018.00

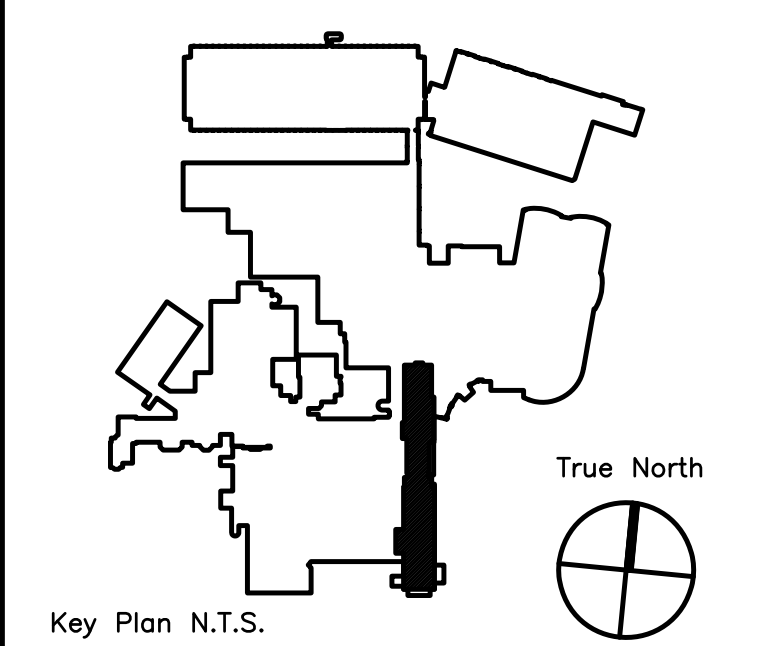

ADDENDUM#	Date	No
1	12/4/09	1

**Maine Medical Center**  
Portland, Maine

**MAINE MEDICAL CENTER**  
PAVILION 6 RENOVATIONS

MorrisSwitzer Project Number 28034  
Date 11/19/09  
Scale 1/8" = 1'-0"  
Sheet Title and Number

**SIXTH FLOOR PAVILIONS  
"A" & "C" PLUMBING NEW  
WORK PLAN  
3P2.1**

