

LIGHTING FIXTURE SCHEDULE

FIXT. TYPE	DESCRIPTIONS	BASIS OF DESIGN		LAMPS			MOUNTING	VOLTAGE	INPUT WATTS	NOTES
		MANUFACTURER	CAT. NUMBER	NO.	WATTS	TYPE				
CR1	8" RECESSED FLUORESCENT LENSED INSTITUTIONAL DOWNLIGHT	KIRLIN	VRR-08002-94 (FINISH BY ARCH)-45-46-79-LE (42W)	1	42	CFQ42W	RECESSED	120	48	LF1, LF2, LF4, LF7
CR1D	8" RECESSED FLUORESCENT LENSED INSTITUTIONAL DIMMABLE DOWNLIGHT	KIRLIN	VRR-08002-39 (DIMMING BALLAST)-94 (FINISH BY ARCH)-45-46-79-LE (42W)	1	42	CFQ42W	RECESSED	120	48	LF1, LF2, LF4, LF7, LF18
CR2	8" RECESSED FLUORESCENT LENSED INSTITUTIONAL FIXTURE	KIRLIN	VRR-08013-94 (FINISH)-LE (42W)	2	32	CFQ32W	RECESSED	120	69	LF1, LF2, LF4, LF7
CR3	8" RECESSED FLUORESCENT DIMMABLE DOWNLIGHT	PORTFOLIO	CR042-1D42-8400-LI-WF-HB26	1	42	CFQ42W	RECESSED	120	48	LF1, LF2, LF4, LF7
FC1	INDIRECT FLUORESCENT COVE LIGHT FIXTURE, WITH 90 CORNERS. REFER TO FLOOR PLAN FOR EXACT LENGTHS. PROVIDE WITH DUST COVER LAMP SHIELD, MOUNT 12" ABOVE EDGE OF CEILING/SOFFIT TO THE BOTTOM OF THE FIXTURE	LITECONTROL	4 FOOT: WAH-96N-2-4-TB-(COLOR)-ELB10-TW-1CWQ-HPR-(90° CORNER)	2	28	F028SS/835/XPS/ECO	SURFACE	120	45	LF1, LF2, LF4, LF6, LF7 WITH LAMPS INCLUDED
			BALLAST: (1) QTP2x32T8/UNV/PSX/TC	2	25	F025/835/XPS/ECO			3 FOOT: WAH-96N-2-3-TB-(COLOR)-ELB10-TW-1CWQ-HPR-(90° CORNER)	
			BALLAST: (1) QTP2x32T8/UNV/PSX/TC						5 FOOT: WAH-96N-2-3-TB-(COLOR)-ELB10-TW-1CWQ-HPR-(90° CORNER)	
			BALLAST: (2) QTP2x32T8/UNV/PSX/TC						5 FOOT: WAH-96N-2-2-TB-(COLOR)-ELB10-TW-1CWQ-HPR-(90° CORNER)	
FR1	2'X2' DIRECT/INDIRECT FLUORESCENT FIXTURE	METALUX	2RDI-3-17-FLS-UNV-L8835-EB81-RIFI-U	3	17	F017/835/XPS/ECO	RECESSED	120	46	LF1, LF2, LF4, LF7 WITH LAMPS INCLUDED "EQ" DENOTES EARTHQUAKE CLIPS
FR2	2'X2' LENSED INSTITUTIONAL TROFFER, IN ACT CEILING. 3-LAMP (CORRIDORS AND WAITING AREAS PROVIDE BOONE TYPE EMERGENCY BALLAST WHERE INDICATED)	FAIL-SAFE	BALLAST: (1) QTP2x32T8/UNV/PSX/TC	3	17	F017/835/XPS/ECO	RECESSED	120	46	LF1, LF2, LF4, LF7, LF18 WITH LAMPS INCLUDED "EQ" DENOTES EARTHQUAKE CLIPS
			BALLAST: (1) QTP2x32T8U/UNV/PSX/TC							
FR2A	2'X2' LENSED INSTITUTIONAL TROFFER, IN ACT CEILING, 2-U LAMP	FAIL-SAFE	FSR-TG-X-24-317-UNV-LAMPS-80-86-EBP-EB81-PAF-EQ-CLIP-U	2	28	F028SSU/835/XPS/ECO	RECESSED	120	45	LF1, LF2, LF4, LF7, LF18 WITH LAMPS INCLUDED "EQ" DENOTES EARTHQUAKE CLIPS
FR3	2'X4' LENSED INSTITUTIONAL TROFFER (PATIENT ROOMS)	FAIL-SAFE	BALLAST: (1) QTP2x32T8U/UNV/PSX/TC	3	28	F028SS/835/XPS/ECO	RECESSED	120	67	LF1, LF2, LF4, LF7 WITH LAMPS INCLUDED
			BALLAST: (1) QTP2x32T8U/UNV/PSX/TC							
FR4	2'X4' LENSED INSTITUTIONAL TROFFER WITH 2 BALLASTS FOR MULTI LEVEL SWITCHING IN ACT CEILING	FAIL-SAFE	BALLAST: (1) QTP2x32T8/UNV/PSX/TC & (1) QTP1x32T8/UNV/PSX/TC	3	28	F028SS/835/XPS/ECO	RECESSED	120	67	LF1, LF2, LF4, LF7 WITH LAMPS INCLUDED "EQ" DENOTES EARTHQUAKE CLIPS
			BALLAST: (1) QTP2x32T8/UNV/PSX/TC & (1) QTP1x32T8/UNV/PSX/TC							
FR5	2'X2' LENSED RECESSED FLUORESCENT FIXTURE, 2-U LAMP (BACK OF HOUSE AREAS) PROVIDE BOONE TYPE EMERGENCY BALLAST WHERE INDICATED	METALUX	2GC-2U6T8-A125-UNV-LAMPS-EB81-PAF-EQ-CLIP-U	2	28	F028SSU/835/XPS/ECO	RECESSED	120	45	LF1, LF2, LF4, LF7 WITH LAMPS INCLUDED "EQ" DENOTES EARTHQUAKE CLIPS
			BALLAST: (1) QTP2x32T8U/UNV/PSX/TC							
FS1	4' SURFACE MOUNTED FLUORESCENT INSTITUTIONAL FIXTURE	FAIL-SAFE	FMB-X-1/232 (28SS LAMPS)-120-80-84-LEOC8-EB82-SSN-TCS-VRSO	3	28	F028SS/835/XPS/ECO	SURFACE	120	67	LF1, LF2, LF4, LF6, LF7 WITH LAMPS INCLUDED
			BALLAST: (1) QTP1x32T8/UNV/PSX/TC (1) QTP2x32T8/UNV/PSX/TC							
FS2	4' SURFACE MOUNTED (CORNER) FLUORESCENT INSTITUTIONAL FIXTURE	FAIL-SAFE	FMC-X-228SS-120-80-84-(BALLAST)-EBP-TCS-VRSO	2	28	F028SS/835/XPS/ECO	SURFACE	120	45	LF1, LF2, LF4, LF6, LF7 WITH LAMPS INCLUDED
			BALLAST: (1) QTP2x32T8/UNV/PSX/TC							
FS3	4' FLUORESCENT FIXTURE, WITH CHAIN MOUNTING KIT IN UNFINISHED AREAS	METALUX	SA-A-228SS-UNV-EB81-U	2	28	F028SS/835/XPS/ECO	WALL	120	45	LF2, LF4, LF7, LF16 LAMPS INCLUDED
			BALLAST: (1) QTP2x32T8/UNV/PSX/TC							
FS4	4' FLUORESCENT FIXTURE, IN CLOSETS MOUNTED ABOVE DOOR MULLION	METALUX	BC-228SS-UNV-EB81-U	2	28	F028SS/835/XPS/ECO	WALL	120	45	LF2, LF4, LF7, LF16 LAMPS INCLUDED
			BALLAST: (1) QTP2x32T8/UNV/PSX/TC							
NL1	TAMPERPROOF NIGHT LIGHT	KIRLIN	LVN-05107-94 (BRUSHED 12 GAUGE STAINLESS STEEL COVER)	-	-	LED	SURFACE	120	-	
UC1	18" UNDERCABINET FIXTURE WITH INTEGRAL ROCKER SWITCH	METALUX	CL-1-15-UNV-EB81-SW-U	1	15	F015/835/XPS/ECO	SURFACE	120	19	LF1, LF2, LF4, LF6, LF7 WITH LAMPS INCLUDED
VP1	VAPORTIGHT COMPACT FLUORESCENT FIXTURE ON ROOF TOP UNITS WITH COLD WEATHER BALLAST	LUMARK	PL-VS-W-GC-42-UNV-GREY-LL-(COLD WEATHER BALLAST)	1	42	CFQ42W	SURFACE	120	48	PROVIDE WITH LAMP INCLUDED AND WIRE LENS GUARD
⊙	INSTITUTIONAL WALL MOUNTED, LED EXIT SIGN SINGLE FACE WITH ARROWS AS INDICATED ON LIGHTING FLOOR PLANS	FAIL-SAFE	EXL-1-RW-DUAL-EBP-(ARROWS)-WHT-VRSO	-	5	LED	REFER TO DRAWINGS	120	5	LF5
⊙	UNIVERSAL MOUNT, LED EXIT SIGN SINGLE FACE WITH ARROWS AS INDICATED ON LIGHTING FLOOR PLANS	SURE-LITES	LPX-6-0-R-WH	-	5	LED	REFER TO DRAWINGS	120	5	LF5
⊙	UNIVERSAL MOUNT, LED EXIT SIGN DUAL FACE WITH ARROWS AS INDICATED ON LIGHTING FLOOR PLANS	SURE-LITES	LPX-6-0-R-WH	-	5	LED	REFER TO DRAWINGS	120	5	LF5
⊙	EMERGENCY BATTERY UNIT	SURE-LITES	CC2-MRT-V-1BRWH	2	5	MR16	REFER TO DRAWINGS	120	15	LF5

LIGHTING FIXTURE SCHEDULE NOTES:

- LF1. MOUNTING HEIGHT AS DIRECTED BY ARCHITECT.
- LF2. COORDINATE LIGHTING FIXTURE INSTALLATION AND TRIM KIT WITH CEILING TYPE INDICATED ON ARCHITECTURAL DRAWINGS.
- LF3. COORDINATE TASK LIGHT FIXTURE INSTALLATION WITH CASEWORK AS DETAILED ON ARCHITECTURAL DRAWINGS.
- LF4. FLUORESCENT LIGHT FIXTURES TO BE EQUIPPED WITH ELECTRONIC BALLASTS. REFER TO SPECIFICATION.
- LF5. NUMBER OF FACES, DIRECTIONAL ARROWS AND MOUNTING AS SHOWN ON THE PLAN.
- LF6. ALL T-8 LAMPS SHALL BE "SUPER-SAVER" TYPE, 80+CRI 35K LAMPS. PROVIDE WITH THE QUANTITY OF ASSOCIATED "SUPER-SAVER" T-8 BALLASTS AS INDICATED ON FLOOR PLANS AND SCHEDULE ABOVE.
- LF7. PROVIDE REQUIRED NUMBER OF BALLASTS TO ACCOMMODATE LIGHTING FIXTURES WITH MULTI-LEVEL SWITCHING AS INDICATED ON FLOOR PLANS.
- LF8. CATALOG NUMBERS INDICATED ARE FOR REFERENCE ONLY. CONTRACTOR IS RESPONSIBLE FOR FINAL FIXTURE COORDINATION AND INSTALLATION, REFER TO SPECIFICATIONS.
- LF9. PROVIDE ACRYLIC OVERLAY ABOVE PERFORATED BODY. PROVIDE LUTRON IR RECEIVER AND LUTRON HI LUMEN BALLAST FDB.

- LF10. FLUORESCENT LAMPS SHALL BE LOW MERCURY LEVEL TYPE.
- LF11. RECESSED FIXTURES LOCATED WITHIN INSULATED CEILING OR WALL SHALL BE "IC" RATED.
- LF12. COORDINATE FIXTURE DEPTH WITH WALL THICKNESS.
- LF13. PROVIDE DUST COVER.
- LF14. PROVIDE ELECTRONIC DIMMER BALLAST EQUAL TO LUTRON HI-LUME FOR 10% DIMMING RATING, COORDINATE WITH FLUORESCENT DIMMING CONTROL AND/OR SYSTEM FOR A COMPLETE AND OPERABLE SYSTEM, AS INDICATED ON DRAWINGS.
- LF15. FINAL FINISH/ COLOR OF FIXTURE TO BE APPROVED IN WRITING BY ARCHITECT AND LIGHTING DESIGNER.
- LF16. PROVIDE RADIO FREQUENCY INTERFERENCE (RFI) FILTERS IN ALL FLUORESCENT FIXTURES SERVING PATIENT AREAS. (TYPICAL)
- LF17. COORDINATE EXACT FIXTURE MOUNTING REQUIREMENTS, LAMPING AND ADDITIONAL INFORMATION WITH ARCHITECT PRIOR TO INSTALLATION AND ORDERING.
- LF18. THE ELECTRICAL CONTRACTOR SHALL SECURE LUMINAIRE TO BUILDING STRUCTURE ABOVE WITH (4) 1/4"x20 N.C. THREADED RODS PER LUMINAIRE. PROVIDE ALL NECESSARY APPURTENANCES FOR A COMPLETE INSTALLATION.



Williston, Vermont
Boston, Massachusetts
Portland, Maine

One Dana Street
Portland, ME 04101
t 207.773.8841
f 207.773.8840

© 2009 MorrisSwitzer morriswitzer.com

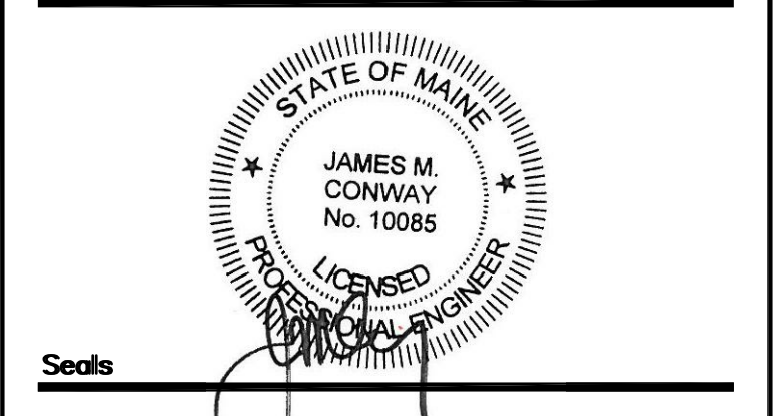

BECKER
structural engineers, inc.

75 York Street
Portland, ME 04101-4701
info@beckerstructural.com

Tel 207-879-1838
Fax 207-879-1822
www.beckerstructural.com

Consultant

MECHANICAL / ELECTRICAL ENGINEERS

92 Montvale Ave, Suite 4100
Saco, ME 04158
Tel: 781-481-0210
Fax: 781-481-0203
email: info@f-t.com
www.f-t.com
Project No.: 09018.00

FITZMEYER & TOCCI
ASSOCIATES, INC.

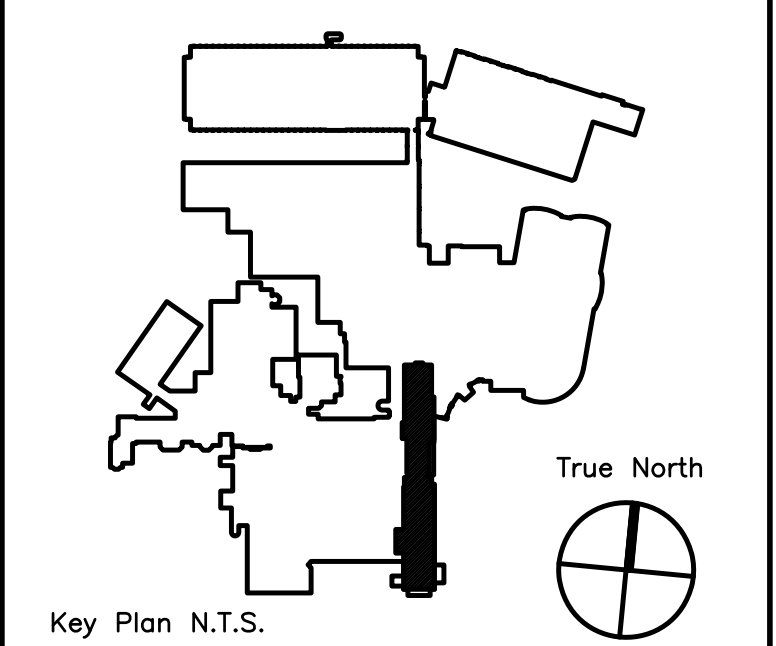

ADDENDUM# 1	12/4/09	1
Revision	Date	No



MAINE MEDICAL CENTER
PAVILION 6 RENOVATIONS

MorrisSwitzer Project Number 28034
Date 11/19/09
Scale NOT TO SCALE
Sheet Title and Number

SIXTH FLOOR PAVILIONS
"A" & "C" ELECTRICAL
SCHEDULES
3E4.0

