

LOW VOLTAGE RELAY CONTROL PANEL "LRC1"				
RELAY NUMBER	LOW VOLTAGE SWITCH LEG	LOAD	PANEL	BREAKER
1	a	PATIENT ROOM 670 NORMAL RECEPTACLES	PP261	26
2	b	PATIENT ROOM 670 EMERGENCY RECEPTACLES	CP261	34
3	c	PATIENT ROOM 671 NORMAL RECEPTACLES	PP261	24
4	d	PATIENT ROOM 671 EMERGENCY RECEPTACLES	CP261	32
5	e	PATIENT ROOM 672 NORMAL RECEPTACLES	PP261	22
6	f	PATIENT ROOM 672 EMERGENCY RECEPTACLES	CP261	30
7	g	PATIENT ROOM 673 NORMAL RECEPTACLES	PP261	20
8	h	PATIENT ROOM 673 EMERGENCY RECEPTACLES	CP261	28
9	i	PATIENT ROOM 674 NORMAL RECEPTACLES	PP261	18
10	k	PATIENT ROOM 674 EMERGENCY RECEPTACLES	CP261	33
11	l	PATIENT ROOM 675 NORMAL RECEPTACLES	PP261	16
12	m	PATIENT ROOM 675 EMERGENCY RECEPTACLES	CP261	31
13	n	PATIENT ROOM 676 NORMAL RECEPTACLES	PP261	14
14	p	PATIENT ROOM 676 EMERGENCY RECEPTACLES	CP261	29
15	q	PATIENT ROOM 677 NORMAL RECEPTACLES	PP261	12
16	r	PATIENT ROOM 677 EMERGENCY RECEPTACLES	CP261	27
17	t	PATIENT ROOM 681 NORMAL RECEPTACLES	PP261	8
18	u	PATIENT ROOM 681 EMERGENCY RECEPTACLES	CP261	7
19	v	PATIENT ROOM 682 NORMAL RECEPTACLES	PP261	10
20	w	PATIENT ROOM 682 EMERGENCY RECEPTACLES	CP261	9
21	x	PATIENT ROOM 683 NORMAL RECEPTACLES	PP261	4
22	y	PATIENT ROOM 683 EMERGENCY RECEPTACLES	CP261	3
23	z	PATIENT ROOM 684 NORMAL RECEPTACLES	PP261	6
24	aa	PATIENT ROOM 684 EMERGENCY RECEPTACLES	CP261	5
25	bb	PATIENT ROOM 686 NORMAL RECEPTACLES	PP261	2
26	cc	PATIENT ROOM 686 EMERGENCY RECEPTACLES	CP261	1
27	dd	1996 CORRIDOR LIGHTING	PP261	17
28	ee	1996 CORRIDOR LIGHTING	PP261	17
29	ff	1999 CORRIDOR LIGHTING	PP262	44
30	gg	1999 CORRIDOR LIGHTING	PP262	44
31	hh	SPARE		
32	ii	SPARE		
33	kk	SPARE		
34	ll	SPARE		
35	mm	SPARE		
36	nn	SPARE		
37	oo	SPARE		
38	pp	SPARE		
39	qq	SPARE		
40	rr	SPARE		
41	uu	SPARE		
42	ww	SPARE		

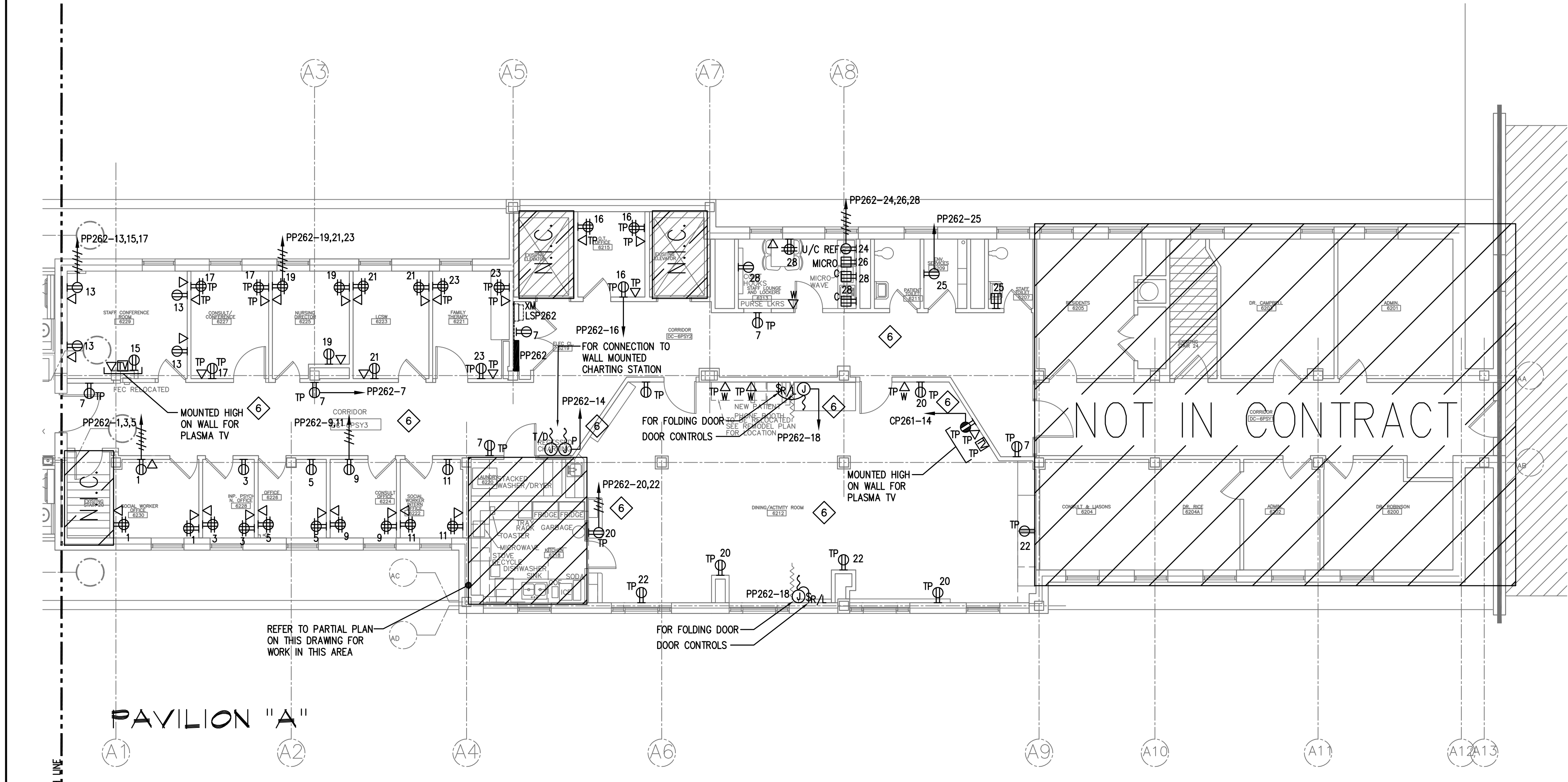

- NOTES:**
- 1 CIRCUIT NUMBERS ARE FOR INFORMATION ONLY. CONNECT TO EXISTING SPARE BREAKER IN PANEL INDICATED.
  - 2 REFER ARCHITECTURAL FLOOR PLAN AND ELEVATIONS FOR EXACT LOCATION, QUANTITIES AND MOUNTING HEIGHTS.
  - 3 LOCATED ABOVE THE CEILING FOR CONNECTION TO MONITORING SYSTEM. COORDINATE EXACT REQUIREMENTS WITH THE SECURITY VENDOR PRIOR TO INSTALLATION.
  - 4 2-GANG BACKBOX FOR SPEAKER/MICROPHONE WIRING WITH 3/4" (EMPTY) RUN CONCEALED WITHIN WALL INTO CEILING ABOVE TO MICROPHONE LOCATION. TERMINATE IN SECOND 2-GANG BACKBOX. COORDINATE AND LOCATE ALL EQUIPMENT AS DIRECTED BY SECURITY VENDOR.
  - 5 PROVIDE NEW 4" CONDUIT TO BE INSTALLED FROM P6 DOWN TO THE TELECOM ROOM ON P4CD (ROOM 4317). LOCATE NEXT TO THE EXISTING PATHWAY DOWN. FIRESTOPPING AND ANY SOFFIT WORK WILL BE PROVIDED BY THE GC.
  - 6 ALL PATIENT ROOMS, CORRIDORS AND DINING AND ACTIVITY AREAS SHALL BE PROTECTED VIA GFCI BREAKER IN PANEL INDICATED. REFER TO 3E4.1 FOR ADDITIONAL INFORMATION.

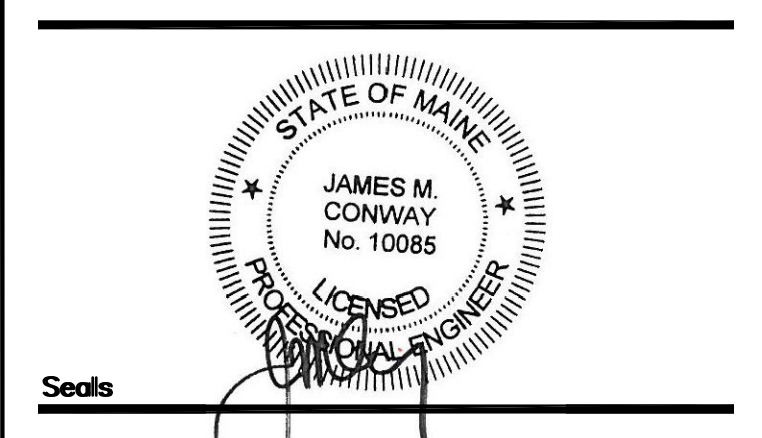
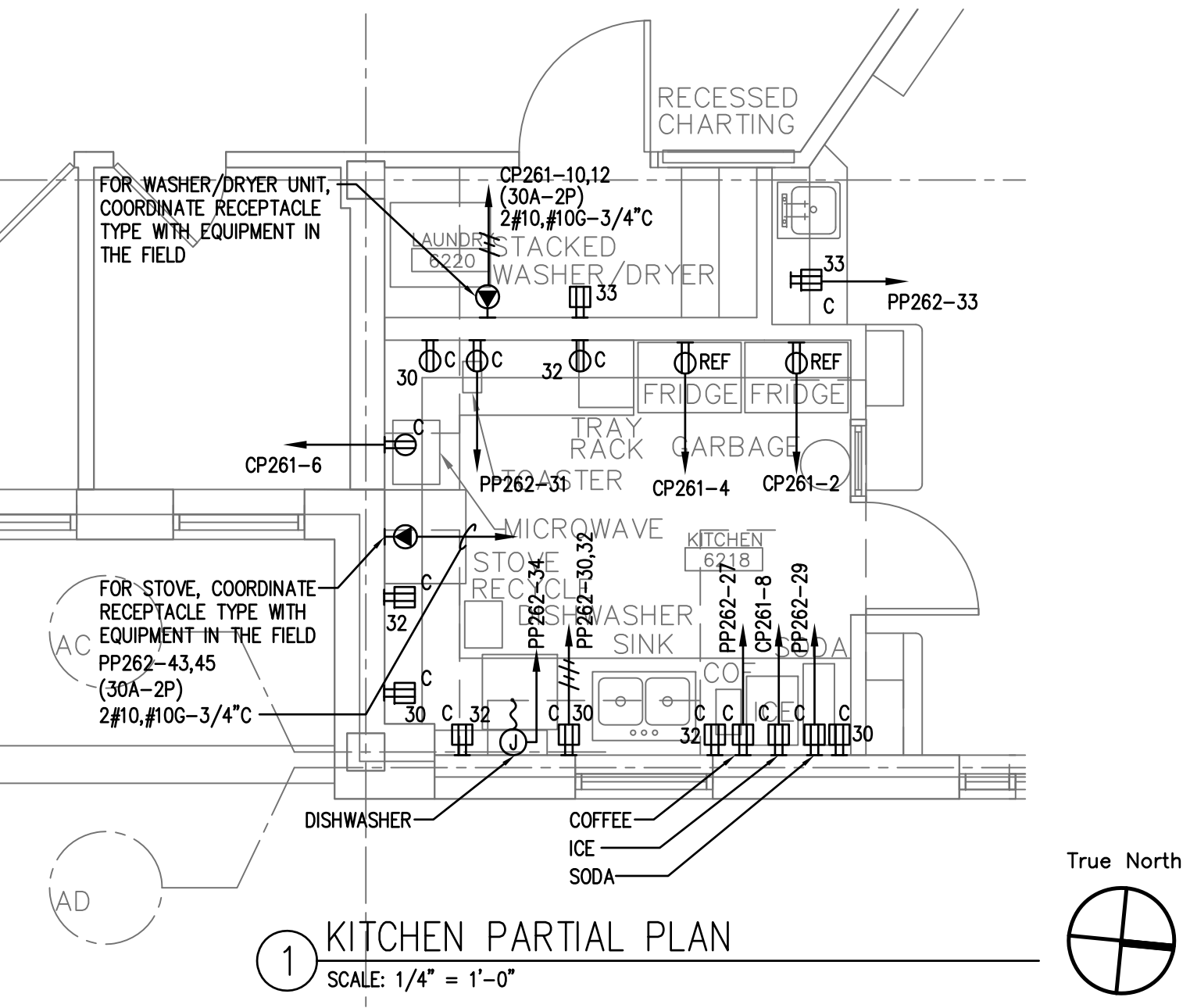

**BECKER**  
structural engineers, inc.

75 York Street  
Portland, ME 04101-4701  
info@beckerstructural.com

Tel 207-879-1838  
Fax 207-879-1822  
www.beckerstructural.com

**Consultant**

Mechanical / Electrical Engineers

92 Montvale Ave, Suite 4100  
Saco, Maine, ME 04158  
Tel: 781-481-0210  
Fax: 781-481-0203  
email: info@f-t.com  
www.f-t.com

Project No: 09018.00

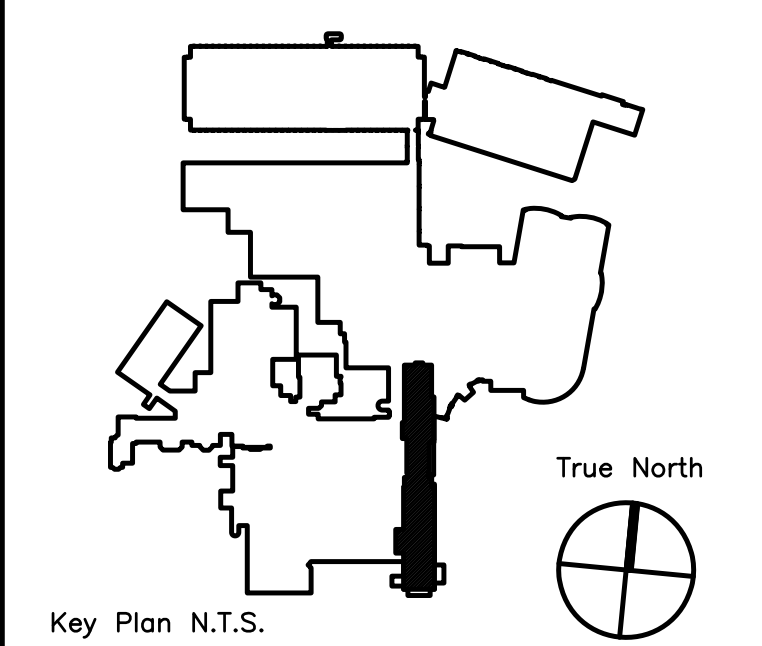

ADDENDUM#1	12/4/09	1
Revision	Date	No

**Maine Medical Center**  
Portland, Maine

**MAINE MEDICAL CENTER**  
PAVILION 6 RENOVATIONS

MorrisSwitzer Project Number 28034  
Date 11/19/09  
Scale 1/8" = 1'-0"  
Sheet Title and Number

**SIXTH FLOOR PAVILIONS**  
**"A" & "C" ELECTRICAL**  
**POWER PLAN**  
**3E2.1**