

Seals

BECKER
structural engineers, inc.

75 York Street Portland, ME 04101-4701
Tel 207-879-1838 Fax 207-879-1822
info@beckerstructural.com www.beckerstructural.com

Consultant

MECHANICAL / ELECTRICAL ENGINEERS
92 Montvale Ave, Suite 4100
Saco, ME 04158
Tel: 781-481-0210 Fax: 781-481-0203
email: info@f-t.com www.f-t.com
Project No: 19018.00

Consultant

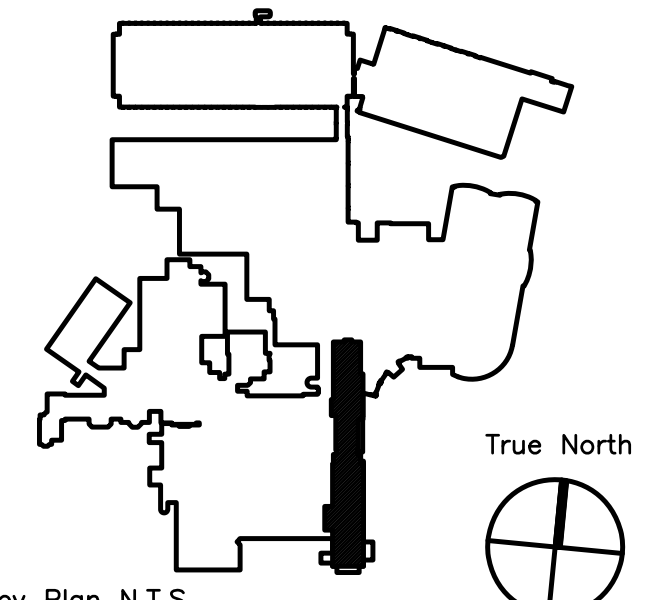

Key Plan N.T.S.

ADDENDUM#1	12/4/09	1
Revision	Date	No



Maine Medical Center
Portland, Maine

MAINE MEDICAL CENTER
PAVILION 6 RENOVATIONS

MorrisSwitzer Project Number 28034
Date 11/19/09
Scale NOT TO SCALE
Sheet Title and Number

SIXTH FLOOR PAVILIONS
"A" & "C" ELECTRICAL
LEGEND AND NOTES

3E0.0

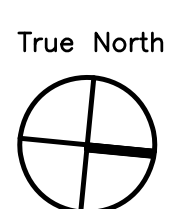

POWER PLAN LEGEND	
	FLUSH MOUNTED PANELBOARD
	SURFACE MOUNTED PANELBOARD
	DISCONNECT SWITCH - NEMA 1 ENCLOSURE - FUSED 30A-3 POLE UNLESS OTHERWISE NOTED
	60AS - DENOTES SWITCH AMPERAGE RATING *40AF* - DENOTES FUSE AMPERAGE RATING *3P* - DENOTES 3-POLE *3R* - DENOTES NEMA 3R ENCLOSURE
	DISCONNECT SWITCH - NEMA 1 ENCLOSURE - UNFUSED
	MAGNETIC MOTOR STARTER
	MANUAL MOTOR STARTER WITH INTEGRAL THERMAL PROTECTION
	VARIABLE FREQUENCY DRIVE - REFER TO "MECHANICAL/ELECTRICAL/PLUMBING" COORDINATION SCHEDULE.
	ENCLOSED CIRCUIT BREAKER - NEMA 1 ENCLOSURE - AMPERAGE AND NO. OF POLES AS INDICATED. 100AF - DENOTES CIRCUIT BREAKER FRAME 60AT - DENOTES CIRCUIT BREAKER TRIP
	MOTOR
	JUNCTION BOX "ATC" INDICATES CONNECTION FOR AUTOMATIC TEMPERATURE CONTROLS "B" INDICATES JUNCTION BOX WITH BLANK COVER "EWC" INDICATES CONNECTION TO ELECTRIC WATER COOLER "MGAP" - DENOTES MEDICAL GAS ALARM PANEL (LOCAL) "MGAP" - DENOTES MASTER MEDICAL GAS ALARM PANEL "PS" INDICATES CONNECTION TO MOTORIZED PROJECTION SCREEN "TD" INDICATES CONNECTION TO MOTORIZED DAMPER
	DRY TYPE TRANSFORMER
	PULL BOX
	EMERGENCY TRANSFER DEVICE

WIRING DEVICE LEGEND	
	DUPLEX RECEPTACLE NEMA 5-20R NORMAL BRANCH CIRCUIT
	DOUBLE DUPLEX RECEPTACLE NEMA 5-20R NORMAL BRANCH CIRCUIT
	DUPLEX RECEPTACLE NEMA 5-20R EMERGENCY BRANCH CIRCUIT
	DOUBLE DUPLEX RECEPTACLE NEMA 5-20R EMERGENCY CRITICAL BRANCH CIRCUIT
	DUPLEX RECEPTACLE GFI TYPE NEMA 5-20R NORMAL BRANCH CIRCUIT
	DUPLEX RECEPTACLE GFI TYPE NEMA 5-20R EMERGENCY BRANCH CIRCUIT
	SPECIAL PURPOSE RECEPTACLE NEMA TYPE AS INDICATED ON THE PLANS

WIRING METHODS	
REFER TO SPECIFICATIONS FOR ADDITIONAL INFORMATION	
NORMAL SYSTEM FEEDERS	THHN/THWN/XHHW CONDUCTORS IN EMT
NORMAL BRANCH CIRCUITS	THHN/THWN/XHHW CONDUCTORS IN EMT OR HOSPITAL GRADE AC CABLE
EMERGENCY SYSTEM (LIFE SAFETY AND CRITICAL) BRANCH CIRCUITS	THHN/THWN/XHHW CONDUCTORS IN EMT
NURSE CALL SYSTEM WIRING	CONDUCTORS IN EMT
FIRE ALARM SYSTEM WIRING	CONDUCTORS IN EMT

LIGHTING PLAN LEGEND	
	LIGHTING FIXTURE AS DESIGNATED ON LIGHTING FIXTURE SCHEDULE
	"1" - DENOTES PANELBOARD BRANCH CIRCUIT NUMBER
	"o" - DENOTES FIXTURE CONTROLLED BY LOCAL SWITCH "o"
	"FR" - DENOTES FIXTURE TYPE AS NOTED ON FIXTURE SCHEDULE.
	DENOTES LIGHT FIXTURE ON LIFE SAFETY BRANCH CIRCUIT, CONSTANT ON UN-SWITCHED (NIGHT LIGHT)
	DENOTES LIGHT FIXTURE WITH BODINE EMERGENCY BALLAST
	DENOTES LIGHT FIXTURE ON CRITICAL BRANCH CIRCUIT
	EXIT SIGN - SHADED AREA INDICATES LOCATION AND QUANTITY OF FACES; DIRECTIONAL ARROWS AS INDICATED

SWITCHES LEGEND	
	LOCAL SWITCH, SINGLE POLE
	"o" - DENOTES LIGHT FIXTURE CONTROL
	LOCAL SWITCH, 3-WAY, SINGLE POLE DOUBLE THROW
	LOCAL SWITCH, 4-WAY, DOUBLE POLE, DOUBLE THROW
	DIMMER SWITCH, SINGLE POLE (FLUORESCENT OR INCANDESCENT DIMMER AS REQUIRED REFER TO FLOOR PLANS FOR EXACT APPLICATION)
	OCCUPANCY SENSOR - WALL MOUNTED INTEGRAL, DUAL TECHNOLOGY, SINGLE POLE SWITCH, MOUNT 48" AFF UNLESS NOTED OTHERWISE. AS MANUFACTURED BY SENSOR SWITCH CATALOG # WSD-PDT OR WAITSTOPPER CATALOG # DW-100
	OCCUPANCY SENSOR - WALL MOUNTED INTEGRAL, DUAL TECHNOLOGY, DUAL RELAY SWITCH, MOUNT 48" AFF UNLESS NOTED OTHERWISE. AS MANUFACTURED BY SENSOR SWITCH CATALOG # WSD-PDT-2P
	OCCUPANCY SENSOR - WALL MOUNTED INTEGRAL, DUAL TECHNOLOGY, DUAL RELAY SWITCH, WITH INTEGRAL PHOTOCELL, MOUNT 48" AFF UNLESS NOTED OTHERWISE. AS MANUFACTURED BY SENSOR SWITCH CATALOG # WSD-PDT-2P-P
	OCCUPANCY SENSOR, CEILING MOUNTED, DUAL TECHNOLOGY, DUAL RELAY SWITCH, AS MANUFACTURED BY SENSOR SWITCH CATALOG # CMR-PDT(-2P 2-POLE AS REQUIRED)
	OCCUPANCY SENSOR, CEILING MOUNTED, DUAL TECHNOLOGY, DUAL RELAY SWITCH WITH INTEGRAL PHOTOCELL, AS MANUFACTURED BY SENSOR SWITCH CATALOG # CMR-10-PDT-2P-P
	BRACKET INDICATES GANGED SWITCHES AT LOCATION INDICATED
	TOGGLE SWITCH TYPE LOW VOLTAGE MOMENTARY CONTACT CONTROL SWITCH

FIRE ALARM SYSTEM LEGEND	
	FIRE ALARM CONTROL PANEL
	FIRE ALARM TERMINAL BOX
	FIRE ALARM ADA COMPATIBLE MANUAL PULL STATION
	TAMPERPROOF FIRE ALARM ADA COMPATIBLE, WALL MOUNTED SPEAKER/STROBE COMBINATION UNIT 900B OUTPUT, ADJUSTABLE CANDELA RATING, FACTORY SET AT 75cd, UNLESS NOTED OTHERWISE, AS MANUFACTURED BY COOPER-WHEELOCK
	"C" - DENOTES CEILING MOUNTED DEVICE WITH 360° LENS
	TAMPERPROOF FIRE ALARM ADA COMPATIBLE, WALL MOUNTED STROBE UNIT ADJUSTABLE CANDELA RATING, FACTORY SET AT 15cd, AS MANUFACTURED BY COOPER-WHEELOCK
	FIRE ALARM SMOKE DETECTOR, CEILING MOUNTED UNLESS NOTED OTHERWISE.
	"D" - DENOTES DUCT SMOKE DETECTOR
	"HT" - DENOTES SMOKE/ HEAT DETECTOR COMBINATION UNIT
	"S" - DENOTES SINGLE STATION SMOKE DETECTOR WITH INTEGRAL AUDIBLE SIGNALS
	FIRE ALARM REMOTE LED INDICATOR
	FIRE ALARM REMOTE TEST STATION
	FIRE ALARM HEAT DETECTOR; CEILING MOUNTED, 135° FIXED TEMPERATURE UNLESS NOTED OTHERWISE.
	FIRE ALARM CONTROL MODULE
	FIRE ALARM MONITORING MODULE
	FIRE ALARM ELECTRO-MAGNETIC DOOR HOLDER
	"TP" - DENOTES TAMPERPROOF DEVICE, SCREWS

ONE-LINE DIAGRAM LEGEND	
	PANELBOARD "CR43A1"
	DRY-TYPE TRANSFORMER "45KVA" - DENOTES TRANSFORMER RATING "K-13" - DENOTES K RATING OF TRANSFORMER
	GROUND CONNECTION

PROJECT GENERAL NOTES	
1. THIS IS A STANDARD SYMBOL LIST. ALL DEVICE SYMBOLS AND ABBREVIATIONS MAY NOT NECESSARILY APPEAR ON THE FLOOR PLANS OR DETAIL SHEET. ONLY THOSE SYMBOLS INDICATED ON THE FLOOR PLANS ARE USED AND OTHERS SHOULD BE DISREGARDED.	
2. THE CONTRACTOR SHALL FURNISH LABOR, MATERIALS, TOOLS AND OTHER EQUIPMENT REQUIRED TO INSTALL THE WORK SHOWN AND SPECIFIED. THE CONTRACTOR SHALL FURNISH AND INSTALL ITEMS NECESSARY FOR A COMPLETE ELECTRICAL SYSTEM. MATERIALS SHALL BE NEW AND SHALL BEAR THE REGISTERED UL MARK. WORK SHALL CONFORM WITH THE NATIONAL FIRE PROTECTION ASSOCIATION STANDARD 70 (NEC), THE NATIONAL ELECTRICAL CODE (NEC), AND APPLICABLE FEDERAL, STATE AND LOCAL CODES. CONTRACTOR SHALL SECURE PERMITS AND PAY THE FEES REQUIRED TO CARRY OUT HIS WORK. THE CONTRACTOR SHALL FURNISH COPIES OF CERTIFICATES AND PERMITS TO THE ARCHITECT.	
3. THE DRAWINGS AND SPECIFICATIONS INDICATE THE INTENT OF THE DESIGN AND SHALL BE CONSIDERED AS DIAGRAMMATIC ONLY. EXACT LOCATIONS FOR OUTLETS AND EQUIPMENT SHALL BE DETERMINED AT THE SITE AS WORK PROGRESSES. DIMENSIONS AND CONDITIONS SHALL BE CHECKED AND VERIFIED BY THE CONTRACTOR AT THE SITE. FINAL WORK SHALL BE DOCUMENTED ON AS BUILT RECORD DRAWINGS.	
4. PIPING, CONDUITS AND EQUIPMENT OF ALL TRADES SHALL BE PROPERLY COORDINATED AND SET TO MAINTAIN THE CLEARANCES REQUIRED BY APPLICABLE FEDERAL, STATE AND LOCAL CODES.	
5. CONDUIT RUNS CROSSING EXPANSION JOINTS SHALL HAVE EXPANSION OR EXPANSION DEFLECTION TYPE FITTINGS AS REQUIRED. VERIFY EXISTING JOINTS BY FIELD MEASUREMENTS.	
6. OUTDOOR ELECTRICAL EQUIPMENT SHALL BE NEMA 3R TYPE, UNLESS OTHERWISE NOTED. EXTERIOR RECEPTACLES SHALL BE MOUNTED AT 24" A.F.G. (MINIMUM) UNLESS OTHERWISE NOTED.	
7. RACEWAYS AND CABLE SHALL BE RUN CONCEALED IN FINISHED SPACES UNLESS OTHERWISE NOTED.	
8. PANELBOARDS AND SWITCHBOARDS SHALL BE PROVIDED WITH DEDICATED SPACE EXTENDING FROM FLOOR TO THE STRUCTURAL CEILING WITH A WIDTH AND DEPTH THAT OF THE EQUIPMENT, INCLUDING ANY ADDITIONAL SPACE DESCRIBED IN OF THE NEC. NO PIPING, DUCTS OR EQUIPMENT FORM TO THE ELECTRICAL EQUIPMENT OR ARCHITECTURAL APPURTENANCES SHALL BE PERMITTED TO BE INSTALLED IN, ENTER OR PASS THROUGH SUCH SPACE.	
9. WIRING DEVICES SHALL BE MOUNTED IN ACCORDANCE WITH THE LATEST REQUIREMENTS OF THE ARCHITECTURAL BARRIERS BOARD.	
10. PANELBOARD SHALL BE MOUNTED SO THAT THE DISTANCE FROM THE TOP CIRCUIT BREAKER OPERATING HANDLE TO THE FLOOR SHALL NOT EXCEED 6'-6".	
11. ALL RECEPTACLES INSTALLED IN UNFINISHED AREAS SHALL BE GFI TYPE, MOUNTED 4'-0" ABOVE FINISHED FLOOR.	
12. EXIT SIGNS AND EMERGENCY LIGHTING UNITS SHALL BE UNSWITCHED.	
13. ALL BRANCH CIRCUITS (LIGHTING AND POWER) SHALL HAVE A DEDICATED NEUTRAL CONDUCTOR. COMMON NEUTRALS WILL NOT BE ALLOWED.	
14. RECEPTACLES, SWITCHES, LIGHTING FIXTURES, SMOKE DETECTORS, ETC. INDICATE QUANTITY, EXACT LOCATIONS OF DEVICES SHALL BE DETERMINED IN THE FIELD AND COORDINATE WITH ARCHITECTURAL DRAWINGS.	
15. MOUNTING HEIGHTS SHALL BE AS INDICATED ON MOUNTING HEIGHT DETAIL.	
16. CONTRACTOR SHALL VERIFY ALL DOORS SWINGS BEFORE INSTALLING SWITCH BOXES.	
17. FOR EXACT LOCATION OF LIGHTING FIXTURES SEE REFLECTED CEILING PLAN DRAWINGS. FOR MOUNTING HEIGHT OF UNDER-COUNTER LIGHTING FIXTURES AND OTHER TASK LIGHTING, REFER TO ARCHITECTURAL ELEVATION DRAWINGS.	
18. ELECTRICAL CONTRACTOR IS TO COORDINATE THE EXACT LOCATION OF LIGHTING FIXTURES IN MECHANICAL AND STORAGE AREAS WITH OTHER TRADES.	
19. FOR EXACT LOCATION OF MECHANICAL EQUIPMENT (AC UNITS, FANS, PUMPS, ETC.) REFER TO RESPECTIVE TRADES DRAWINGS. FOR ELECTRICAL INFORMATION, REFER TO EMT COORDINATION SCHEDULE.	
20. CURRENT CARRYING MATERIAL USED SHALL BE COPPER, INCLUDING PANELBOARD BUS MATERIALS AND TRANSFORMER WINDINGS.	
21. FURNISH GROUNDING/ BONDING BUSHINGS ONTO ALL CONDUIT ENTERING/ LEAVING BOXES.	
22. ALL GROUND CONDUCTORS SHALL BE GREEN, ISOLATED GROUND CONDUCTORS SHALL BE GREEN/ YELLOW STRIPPED, AND NEUTRAL CONDUCTORS SHALL BE WHITE.	
23. UNLESS NOTED OTHERWISE, ALL DATA AND TELEPHONE CABLING IS BY THIS CONTRACTOR. ELECTRICAL DRAWINGS INDICATE TEL/DATA OUTLET DEVICES AND WIRING. COORDINATE DEVICE COLOR AND LABELING WITH OWNER/HOSPITAL PRIOR TO INSTALLATION.	
24. UNLESS NOTED OTHERWISE, ALL SECURITY DEVICES AND CABLING IS BY OTHERS. ELECTRICAL DRAWINGS PROVIDE RACEWAY SYSTEMS ONLY AND INDICATE SECURITY OUTLET CONFIGURATIONS FOR REFERENCE ONLY. TERMINATE SECURITY RACEWAYS WITHIN 6" OF CABLE TRAY.	
25. NO HORIZONTAL RUNS OF CABLING ALLOWED IN WALLS.	

COMMUNICATIONS LEGEND	
	INFORMATION TECHNOLOGY (IT) OUTLET DEVICE WITH 4 PORT MODULAR FACE PLATE AND 4 CAT 5 CABLES - MOUNTED 18" AFF, UNLESS NOTED OTHERWISE.
	"C" - DENOTES MOUNTED 6" ABOVE WORK SURFACE
	"H" - DENOTES MOUNTED HIGH ON WALL COORDINATE HEIGHT WITH ARCHITECT
	"W" - DENOTES MOUNTED 5'-0" AFF
	CEILING MOUNTED INFORMATION TECHNOLOGY OUTLET DEVICE WITH 4 PORT MODULAR FACE PLATE AND 4 CAT6 CABLES
	FLOOR BOX - INFORMATION TECHNOLOGY (IT) OUTLET DEVICE WITH 4 PORT MODULAR FACE PLATE AND 4 CAT6 CABLES
	FLOOR MOUNTED TWO GANG DEVICE WITH NEMA 5-20R DUPLEX RECEPTACLE WITH 4 PORT MODULAR FACE PLATE. BASE WORK FOR FLOOR BOXES ENTAILS A POKE-THRU WITH A CONDUIT AND WIRING EACH FOR POWER AND TELEDATA FROM THE POKE-THRU LOCATION ALONG THE UNDERSIDE OF SLAB ON THE FLOOR BELOW OVER TO THE CLOSEST WALL IN THIS SCOPE OF WORK CORE BACK UP THROUGH THE SLAB UP INTO THE WALL CAVITY AND TERMINATING WITH 90 DEGREE BEND POINTING TOWARDS THE TELEDATA RACK AND A BELL END BUSHING FOR THE TELEDATA WIRING AND THE CONDUIT FOR THE POWER SHALL CONTINUE ON TO THE ASSOCIATED PANEL'S LOCATION.
	"P1" - DENOTES 2 HOUR FIRE RATED POKE-THROUGH
	TYPICAL WIRING DESIGNATIONS: 1/3 - DENOTES 1 COAX CABLE AND 3 CAT6 CABLES
	3/4" THICK X 8'-0" HIGH X LENGTH AS INDICATED ON THE DRAWINGS PLYWOOD. PLYWOOD SHALL BE PAINTED GRAY AND MOUNTED TO WALL
	TELEVISION OUTLET - MOUNTED 18" AFF, UNLESS NOTED OTHERWISE REFER TO SPECIFICATION FOR ADDITIONAL WIRING INFORMATION.

DEMOLITION GENERAL NOTES	
1. REFER TO THE ARCHITECTURAL DRAWINGS FOR THE FULL EXTENT OF THE SCOPE OF DEMOLITION. DISCONNECT AND MAKE SAFE ALL ELECTRICAL EQUIPMENT IDENTIFIED FOR REMOVAL ON THE ARCHITECTURAL, HVAC, PLUMBING AND FIRE PROTECTION PLANS. THE ELECTRICAL SCOPE MAY EXTEND BEYOND THE AREA DEFINED BY THE ARCHITECTURAL DEMOLITION LIMITS TO FULLY COMPLY WITH THE VARIOUS REQUIREMENTS DEFINED BY THESE NOTES.	
2. THE ELECTRICAL DEMOLITION PLANS INDICATE THE GENERAL INTENT AND ARE NOT INTENDED TO SHOW ALL COMPONENTS AND ITEMS TO BE REMOVED OR RETAINED. THE ELECTRICAL CONTRACTOR SHALL VISIT THE SITE PRIOR TO SUBMISSION OF THEIR BID TO BECOME FAMILIAR WITH THE ACTUAL WORKING CONDITIONS AND EXTENT OF WORK. DEVICES AND EQUIPMENT LOCATED ON WALLS AND/OR CEILINGS DESIGNATED TO BE REMOVED SHALL BE DISCONNECTED AND MADE SAFE. THE ELECTRICAL CONTRACTOR SHALL IMMEDIATELY NOTIFY THE OWNER'S REPRESENTATIVE OF ANY UNANTICIPATED OR HIDDEN CONDITIONS ENCOUNTERED DURING DEMOLITION.	
3. THE ELECTRICAL CONTRACTOR SHALL BE RESPONSIBLE FOR THE REPAIR OF ALL SYSTEMS OR BUILDING COMPONENTS DAMAGED DURING THE EXECUTION OF THE WORK. DAMAGE SHALL INCLUDE, BUT NOT BE LIMITED TO, THE DESTRUCTION OR DISPOSAL OF ITEMS INTENDED TO REMAIN OR BE SALVAGED.	
4. THE ELECTRICAL CONTRACTOR SHALL CIRCUIT TRACE AND LABEL ALL EXISTING BRANCH CIRCUITS AND FEEDERS WITHIN OR ASSOCIATED WITH THE AREA OF DEMOLITION SCOPE PRIOR TO DE-ENERGIZING AND DISCONNECTION. ALL CIRCUITS WITHIN PANELBOARDS IDENTIFIED FOR REMOVAL SHALL BE TRACED AND LABELLED TO ENSURE THAT NO AREA OUTSIDE THE DEMOLITION SCOPE LIMIT IS AFFECTED.	
5. THE ELECTRICAL CONTRACTOR SHALL IDENTIFY ALL BRANCH CIRCUITS, FEEDERS AND SYSTEM COMPONENTS WHICH ARE TO REMAIN WITHIN THE AREA OF DEMOLITION SCOPE. THERE SHALL BE NO INTERRUPTION OF SERVICE TO ANY AREA OUTSIDE THE SCOPE LIMITS WITHOUT APPROVAL FROM THE OWNER'S REPRESENTATIVE. EXISTING EQUIPMENT TO REMAIN SHALL BE LEFT IN A CODE COMPLIANT CONDITION.	
6. THE ELECTRICAL CONTRACTOR SHALL DE-ENERGIZE AND REMOVE ALL CONDUCTORS AND RACEWAYS TO THEIR POINTS OF ORIGIN WITHIN THE AREA OF DEMOLITION SCOPE. ITEMS IDENTIFIED FOR DEMOLITION SHALL NOT BE ABANDONED IN PLACE. RACEWAYS THAT ENTER MASONRY WALLS AND FLOORS SHALL BE CUT FLUSH AT THE SURFACE FOR PATCHING BY OTHERS. ALL CIRCUIT BREAKERS ASSOCIATED WITH THE DEMOLITION SHALL BE DE-ENERGIZED AND LABELED SARE.	
7. THE ELECTRICAL CONTRACTOR SHALL TEMPORARILY SUPPORT ALL ITEMS TO REMAIN THAT ARE AFFECTED BY THE DEMOLITION OF BUILDING STRUCTURAL COMPONENTS (WALLS, CEILINGS, ETC.). TEMPORARILY SUPPORTED ITEMS SHALL BE PERMANENTLY SUPPORTED AND INSTALLED WHEN FINALIZED STRUCTURES ARE IN PLACE.	
8. ALL REMOVED ITEMS SHALL BE LEGALLY DISPOSED OF UNLESS IDENTIFIED FOR REUSE. THE OWNER'S REPRESENTATIVE SHALL INSPECT ALL RETAINED ITEMS PRIOR TO PLACEMENT IN THE IDENTIFIED STORAGE LOCATION BY THE ELECTRICAL CONTRACTOR.	
9. THE EXISTING FIRE ALARM SYSTEM SHALL REMAIN FULLY FUNCTIONAL DURING THE ENTIRE DEMOLITION AND CONSTRUCTION PERIOD. REUSE OF EXISTING FIRE ALARM RACEWAYS SHALL NOT BE ALLOWED. ALL REQUIRED SYSTEM SHUTDOWNS SHALL BE COORDINATED WITH AND APPROVED BY THE OWNER'S REPRESENTATIVE AND THE AUTHORITY HAVING JURISDICTION. DEMOLITION OF THE EXISTING SYSTEM SHALL NOT COMMENCE UNTIL THE NEW SYSTEM HAS BEEN COMPLETELY INSTALLED, TESTED AND APPROVED BY THE AUTHORITY HAVING JURISDICTION.	
10. ALL DEMOLITION SCOPE ASSOCIATED WITH LOW VOLTAGE SYSTEMS INCLUDING BUT NOT LIMITED TO TELEPHONE, DATA, SECURITY, PAGING, CCTV, ETC. SHALL BE INCLUDED IN THIS CONTRACT.	
11. REMOVED FLUORESCENT AND HID LAMPS AND BATTERIES SHALL BE RECYCLED BY A FACILITY APPROVED BY THE OWNER'S REPRESENTATIVE. A UNIFORM HAZARDOUS WASTE MANIFEST SHALL BE PREPARED FOR ALL DISPOSALS AND RETURNED WITH ALL APPLICABLE SIGNOFFS PRIOR TO APPLICATION FOR FINAL PAYMENT.	
12. ALL BALLASTS IN LIGHTING FIXTURES TO BE DISPOSED SHALL BE VERIFIED TO BE PCB FREE. ALL BALLASTS MANUFACTURED PRIOR TO 1979 AND NOT LABELED AS PCB FREE SHALL BE CONSIDERED TO CONTAIN PCBs. PROVIDE WRITTEN REPRESENTATION TO THE OWNER'S REPRESENTATIVE THAT CONFIRMS PCB FREE WASTE. WHERE PCB FREE WASTE CANNOT BE VERIFIED, BALLASTS SHALL BE RECYCLED BY A FACILITY APPROVED BY THE OWNER'S REPRESENTATIVE. WITH PCB COMPONENTS ELIMINATED BY A HIGH TEMPERATURE INCINERATION. A UNIFORM HAZARDOUS WASTE MANIFEST SHALL BE PREPARED FOR ALL DISPOSALS AND RETURNED WITH ALL APPLICABLE SIGNOFFS PRIOR TO APPLICATION FOR FINAL PAYMENT. ALL HANDLING SHALL CONFORM TO EPA REQUIREMENTS. PROVIDE BREAKOUT COST FOR THIS SCOPE.	

NURSE CALL SYSTEM LEGEND	
	NURSE CALL
	"T" - DENOTES TOILET/ DRESSING ROOM STATION LOCATION, WALL MOUNTED DEVICE WITH PULLCORD.
	"S" - DENOTES SHOWER STATION LOCATION, WALL MOUNTED DEVICE WITH PULLCORD.
	"PB" - DENOTES PATIENT BED STATION LOCATION
	"DS" - DENOTES DUTY STATION LOCATION
	"SA" - DENOTES NURSE CALL STAFF ASSIST STATION LOCATION
	"CB" - DENOTES CODE BLUE STATION LOCATION
	"EC" - DENOTES NURSE CALL EQUIPMENT CABINET
	"MSM" - DENOTES NURSE CALL MASTER STATION MASTER HEAD END LOCATION WITH HAND-SET FOR PAGING CAPABILITY
	"MSS" - DENOTES NURSE CALL MASTER STATION SLAVE LOCATION WITH
	"A" - DENOTES NURSE CALL ANNUNCIATOR STATION LOCATION
	"CBA" - DENOTES CODE BLUE ANNUNCIATOR LOCATION
	DOME LIGHT LOCATION - CEILING OR WALL AS DIRECTED BY ARCHITECT OR HOSPITAL PERSONNEL
	"CB" - DENOTES CODE BLUE DOME LIGHT
	"Z" - DENOTES ZONE DOME LIGHT
	"TP" - DENOTES TAMPERPROOF DEVICE, SCREWS

PROVIDE 3-GANG BOX WITH PLASTER RING AND AN EMPTY 3/4" CONDUIT WITH PULLSTRING TO ABOVE FINISHED CEILING. TERMINATE WITH END OF CONDUIT BUSHING. NURSECALL DEVICES AND WIRING BY ELECTRICAL CONTRACTOR, COORDINATE EXACT REQUIREMENTS WITH HOSPITAL PERSONNEL.

DRAWING NOTES & DESIGNATIONS	
	KEYED DRAWING NOTE MARKER
	FEEDER AND/ OR BRANCH CIRCUIT NUMBER
	DETAIL MARKER
	"1" - DENOTES DETAIL NUMBER
	"E-1" - DENOTES DRAWING NUMBER
	HVAC EQUIPMENT MARKER
	"AC" - DENOTES EQUIPMENT TYPE
	"1" - DENOTES EQUIPMENT NUMBER
	PARTIAL PLAN TITLE MARKER
	DRAWING REVISION MARKER
	SECTION MARKER "A" - DENOTES SECTION REFERENCE

ABBREVIATIONS			
A	AMPERES	JB	JUNCTION BOX
ACT	ACOUSTICAL CEILING TILE	KAIC	THOUSAND AMPERES
AF	AMPERE FRAME	KMIL	INTERRUPTING CAPACITY
AFCI	ARC-FAULT CIRCUIT INTERRUPTER	KEC	THOUSAND CIRCUIT MILS
AFF	ABOVE FINISHED FLOOR	KV	KILOVOLT
AFG	ABOVE FINISHED GRADE	KVAR	KILOVOLT AMPERES REACTIVE
AIC	AMPERE INTERRUPTING CAPACITY	KW	KILOWATT
AL	ALUMINUM	KWH	KILOWATT HOURS
ANN	ANNUNCIATOR	LTG	LIGHTING
ANSI	AMERICAN NATIONAL STANDARDS INSTITUTE	MAX	MAXIMUM
ARCH	ARCHITECT	MC	METAL CLAD CABLE
AT	AMPERE TRIP	MCB	MAIN CIRCUIT BREAKER
ATC	AUTOMATIC TEMPERATURE CONTROL	MCC	MOTOR CONTROL CENTER
ATS	AUTOMATIC TRANSFER SWITCH	MCP	MOTOR CIRCUIT PROTECTOR
AWG	AMERICAN WIRE GAUGE	MCSW	MOLDED CASE SWITCH
BLDG	BUILDING	MDP	MAIN DISTRIBUTION PANEL
BOND	BONDING JUMPER	MEC	MASSACHUSETTS ELECTRICAL CODE
BR	BRANCH	MECH	MECHANICAL
C	CONDUIT - RACEWAY	MIN	MINIMUM
CAT	CATALOG	MISC	MISCELLANEOUS
CB	CIRCUIT BREAKER	MOUNT	MOUNTED
cd	CANDELA	MV	MEDIUM VOLTAGE
CE	CIRCUIT	MLO	MAIN LUGS ONLY
CMS	CABLE MANAGEMENT SYSTEM	N	NEUTRAL (GROUNDED CONDUCTOR)
CLG	CEILING	NA	NOT APPLICABLE
COL	COLUMN	NC	NORMALLY CLOSED
CMU	CONCRETE MASONRY UNIT	NEC	NATIONAL ELECTRICAL CODE
CT	CURRENT TRANSFORMER OR CABLE TRAY	NEMA	NATIONAL ELECTRICAL MANUFACTURERS ASSOCIATION
CJ	COPPER	NFPA	NATIONAL FIRE PROTECTION ASSOCIATION
CWS	CONDUIT WALL SEAL	NIC	NOT IN CONTRACT
DETD	DUAL ELEMENT TIME DELAY	NL	NIGHT LIGHT
DIA	DIAMETER	NO	NORMALLY OPEN
DP	DISTRIBUTION PANEL	NTS	NOT TO SCALE
DWG	DRAWING	OCPO	OVER CURRENT PROTECTION DEVICE
EA	EACH	PH	PHASE
EC	ELECTRICAL CONTRACTOR EQUIPMENT GROUND CONDUCTOR	PNL	PANEL BOARD
ECC	ELECTRICAL CONTRACTOR EQUIPMENT GROUND CONDUCTOR	PNLBD	PANEL BOARD PROVIDED UNDER OTHER SECTIONS
ELEC	ELECTRICAL	PT	POTENTIAL TRANSFORMER
ELEV	ELEVATOR	PVC	POLYVINYL CHLORIDE, SCHED 40 RNC RACEWAY UNO
EM	EMERGENCY	PWR	POWER
EMS	ENERGY MANAGEMENT SYSTEM	RSP	GALVANIZED RIGID STEEL CONDUIT
EMT	ELECTRICAL METALLIC TUBING	RMC	RIGID METAL CONDUIT
EO	ELECTRICALLY OPERATED EQUIPMENT	RNC	RIGID NON-METAL CONDUIT
EQUIP	EQUIPMENT	RSC	RIGID STEEL CONDUIT
EW	ELECTRIC WATER COOLER	SATS	STANDBY AUTOMATIC TRANSFER SWITCH