

Seals

BECKER
structural engineers, inc.

75 York Street
Portland, ME 04101-4701
info@beckerstructural.com

Tel 207-879-1838
Fax 207-879-1822
www.beckerstructural.com

Consultant

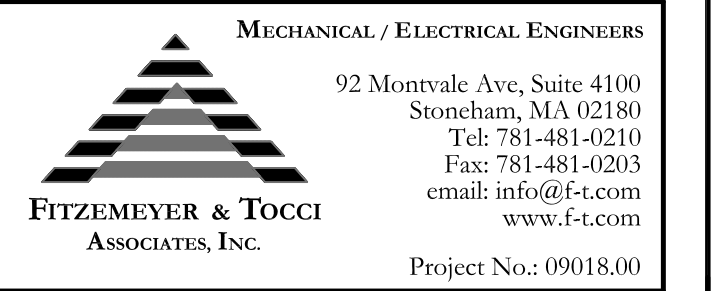

Consultant

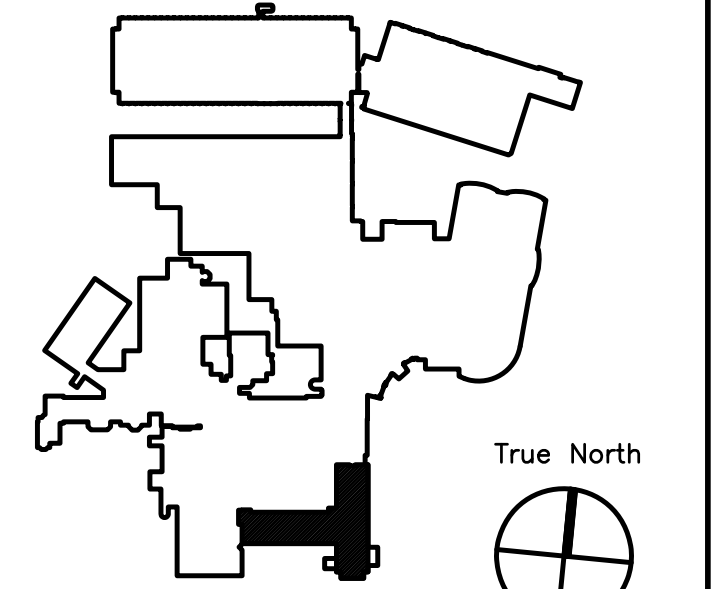

Key Plan N.T.S.

ADDENDUM#	Date	No
1	12/4/09	1

Revision Date No



Maine Medical Center
Portland, Maine

MAINE MEDICAL CENTER
PAVILION 6 RENOVATIONS

MorrisSwitzer Project Number 28034
Date 11/19/09
Scale 1/8" = 1'-0"

Sheet Title and Number
SECOND FLOOR
PAVILION "C" & "D"
INTERIM OCCUPANCY
PLUMBING PLAN
2P1.0

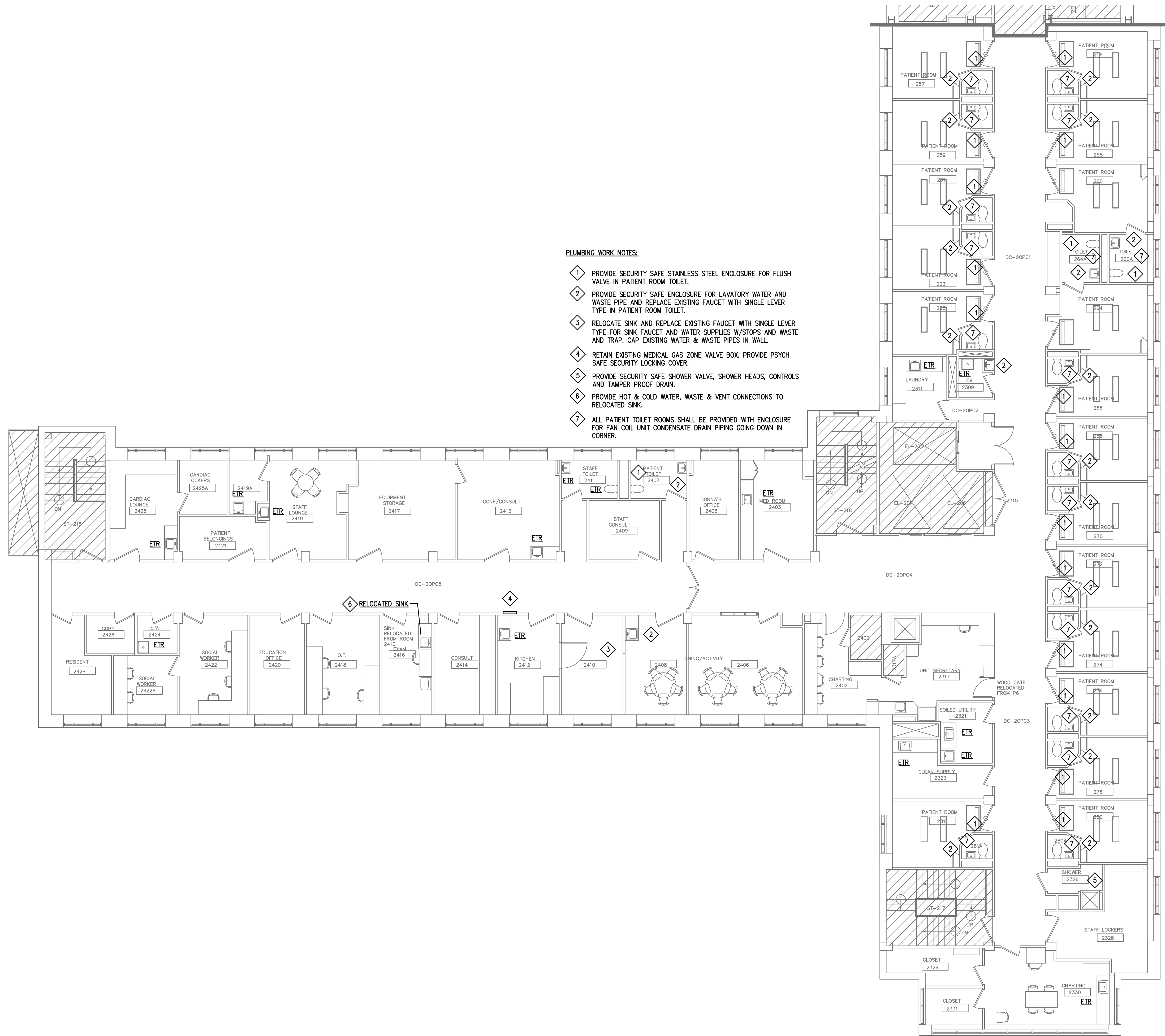
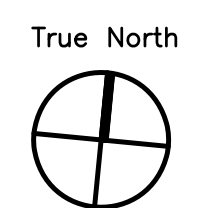

- PLUMBING WORK NOTES:**
- 1 PROVIDE SECURITY SAFE STAINLESS STEEL ENCLOSURE FOR FLUSH VALVE IN PATIENT ROOM TOILET.
 - 2 PROVIDE SECURITY SAFE ENCLOSURE FOR LAVATORY WATER AND WASTE PIPE AND REPLACE EXISTING FAUCET WITH SINGLE LEVER TYPE IN PATIENT ROOM TOILET.
 - 3 RELOCATE SINK AND REPLACE EXISTING FAUCET WITH SINGLE LEVER TYPE FOR SINK FAUCET AND WATER SUPPLIES W/STOPS AND WASTE AND TRAP. CAP EXISTING WATER & WASTE PIPES IN WALL.
 - 4 RETAIN EXISTING MEDICAL GAS ZONE VALVE BOX. PROVIDE PSYCH SAFE SECURITY LOCKING COVER.
 - 5 PROVIDE SECURITY SAFE SHOWER VALVE, SHOWER HEADS, CONTROLS AND TAMPER PROOF DRAIN.
 - 6 PROVIDE HOT & COLD WATER, WASTE & VENT CONNECTIONS TO RELOCATED SINK.
 - 7 ALL PATIENT TOILET ROOMS SHALL BE PROVIDED WITH ENCLOSURE FOR FAN COIL UNIT CONDENSATE DRAIN PIPING GOING DOWN IN CORNER.

PAVILION "C" AND "D"