

Seals

BECKER
structural engineers, inc.

75 York Street
Portland, ME 04101-4701
info@beckerstructural.com

Tel 207-879-1838
Fax 207-879-1822
www.beckerstructural.com

Consultant

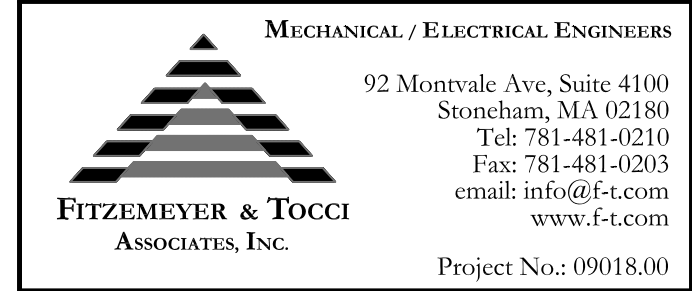

Consultant

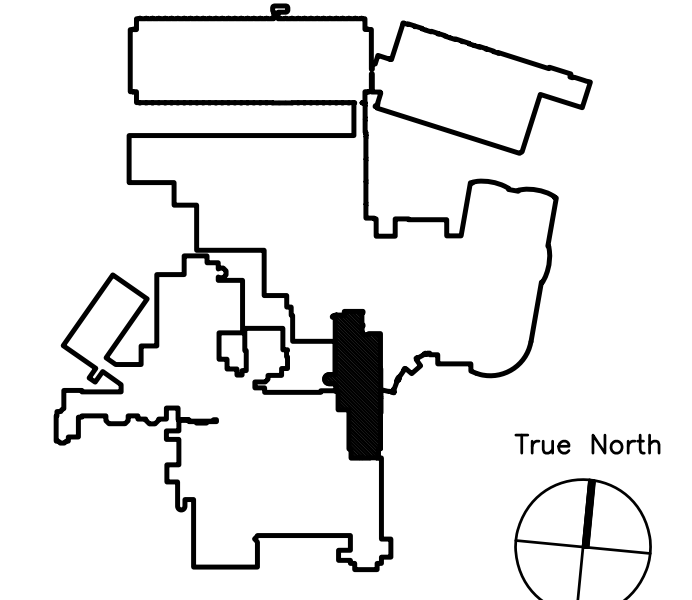

Key Plan N.T.S.

REVISION #	DATE	NO
1	01/12/10	2
ADDENDUM #	12/4/09	1
Revision	Date	No



MAINE MEDICAL CENTER
PAVILION 6 RENOVATIONS

MorrisSwitzer Project Number: 28034
Date: 11/19/09
Scale: 1/8" = 1'-0"

SECOND FLOOR
PAVILION "A" INTERIM OCCUPANCY
ELECTRICAL PLAN
1E1.0

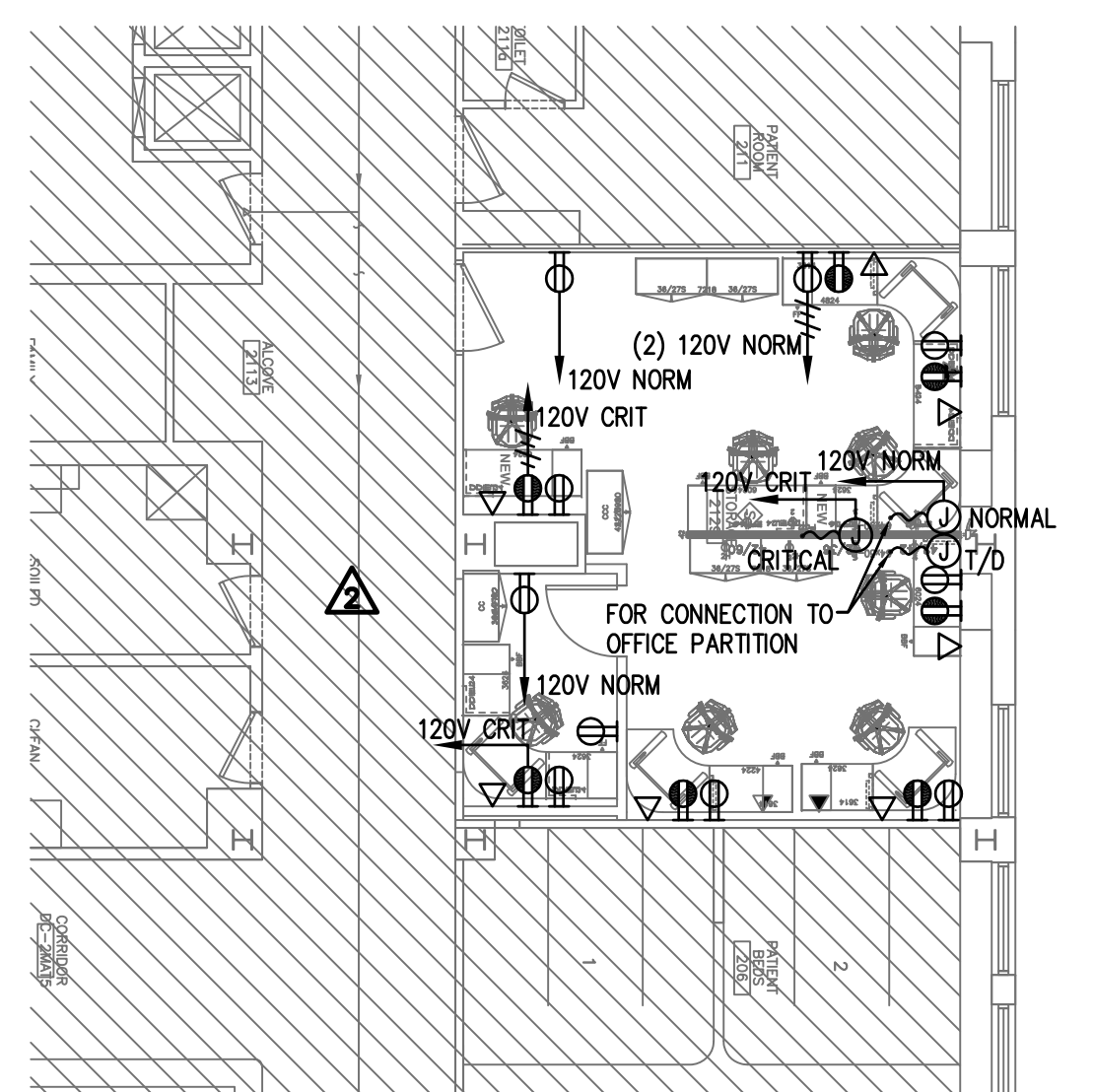
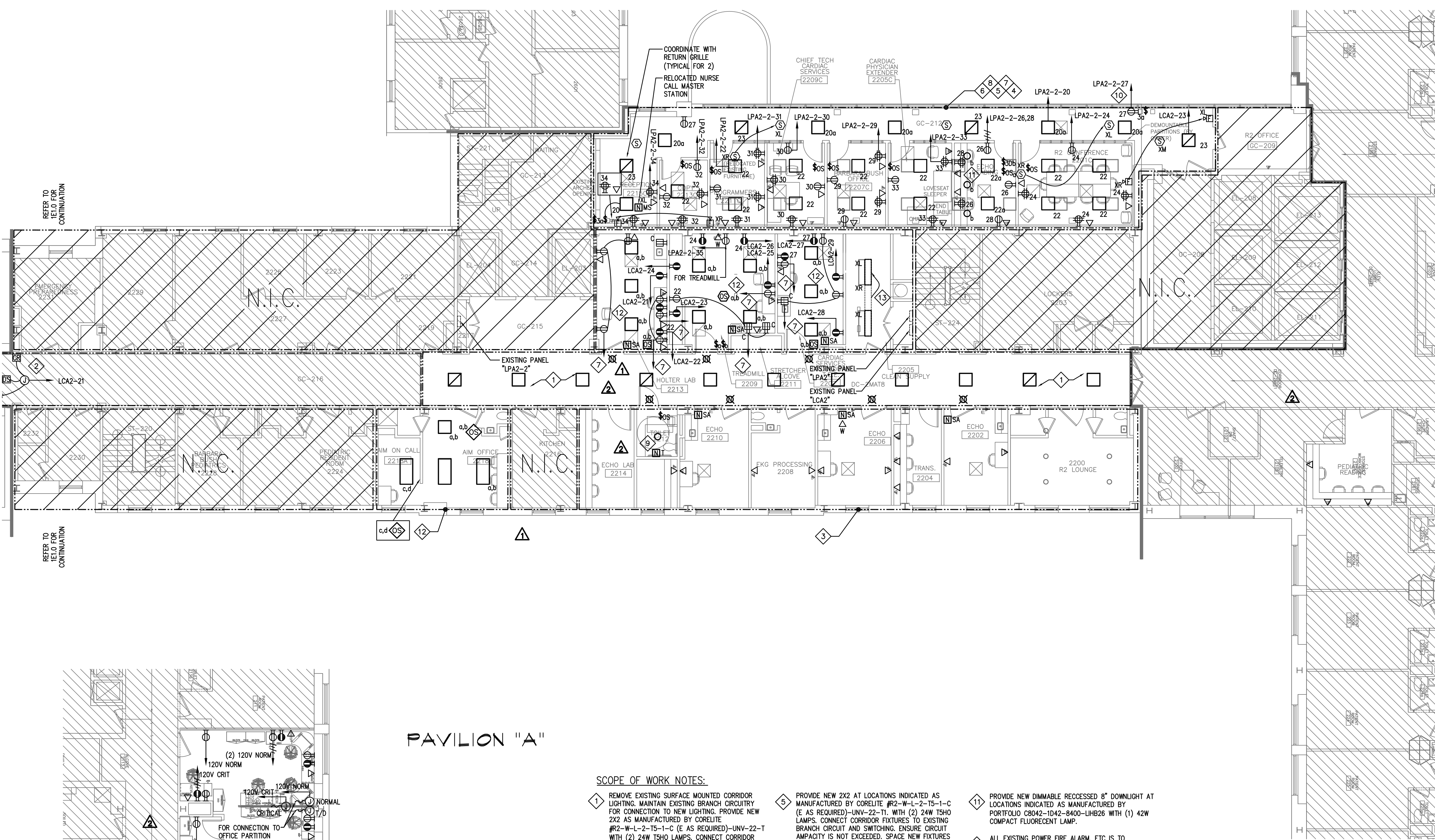
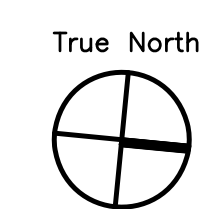

1 FIRST CALL PARTIAL PLAN
SCALE: 1/8" = 1'-0"

PAVILION "A"

SCOPE OF WORK NOTES:

- 1 REMOVE EXISTING SURFACE MOUNTED CORRIDOR LIGHTING. MAINTAIN EXISTING BRANCH CIRCUITRY FOR CONNECTION TO NEW LIGHTING. PROVIDE NEW 2X2 AS MANUFACTURED BY CORELITE #R2-W-L-2-T5-1-C (E AS REQUIRED)-UNV-22-T1. WITH (2) 24W TSHO LAMPS. CONNECT CORRIDOR FIXTURES TO EXISTING BRANCH CIRCUITRY AND SWITCHING. ENSURE CIRCUIT AMPACITY IS NOT EXCEEDED. SPACE NEW FIXTURES 10'-0" O.C.
- 2 PROVIDE NEW CARD READER, DOOR STRIKE AND JUNCTION BOX ABOVE CEILING FOR 120V WIRING. PROVIDE BRANCH CIRCUIT WIRING TO THE NEAREST 120/208, 3Ø, 4W EQUIPMENT PANEL SERVING THE AREA. CONNECT TO EXISTING 120V SPARE BREAKER OR PROVIDE NEW, MATCH EXISTING MANUFACTURER, MODEL AND A.I.C. RATING
- 3 ALL EXISTING LIGHTING, POWER, SWITCHING, FIRE ALARM, ETC IS TO REMAIN, EXCEPT AS INDICATED OTHERWISE.
- 4 REMOVE EXISTING LIGHTING, POWER AND TELEDATA DEVICES IN THIS AREA. MAINTAIN EXISTING BRANCH CIRCUITRY FOR CONNECTION TO NEW DEVICES. LIGHTING AND SWITCHING AS INDICATED
- 5 PROVIDE NEW 2X2 AT LOCATIONS INDICATED AS MANUFACTURED BY CORELITE #R2-W-L-2-T5-1-C (E AS REQUIRED)-UNV-22-T1. WITH (2) 24W TSHO LAMPS. CONNECT CORRIDOR FIXTURES TO EXISTING BRANCH CIRCUIT AND SWITCHING. ENSURE CIRCUIT AMPACITY IS NOT EXCEEDED. SPACE NEW FIXTURES 10'-0" O.C.
- 6 CONNECT NEW FIRE ALARM DEVICES TO EXISTING LOOP SERVING THE AREA. PROVIDE ALL NECESSARY WIRING AND APPURTENANCES FOR A COMPLETE INSTALLATION
- 7 CONNECT NEW POWER DEVICES TO EXISTING MAINTAINED BRANCH CIRCUITRY OR PROVIDE NEW WIRING CONNECTED TO EXISTING SPARE 20A-1P BREAKER IN EXISTING NORMAL PANEL SERVING THE AREA.
- 8 CONNECT NEW TELEDATA DEVICES TO EXISTING MAINTAINED BRANCH CIRCUITRY
- 9 REPLACE EXISTING PATIENT SHOWER LIGHTING FIXTURE WITH NEW 8" RECESSED FLUORESCENT LENSED SHOWER LIGHT AS MANUFACTURED BY KIRLIN #VRR-08013-94 (FINISH)-LE (42W) WITH (1) 42 WATT CFO42W LAMPS (48 INPUT WATTS)
- 10 CONNECT TO EXISTING 120V SPARE BREAKER OR PROVIDE NEW, MATCH EXISTING MANUFACTURER, MODEL AND A.I.C. RATING
- 11 PROVIDE NEW DIMMABLE RECESSED 8" DOWNLIGHT AT LOCATIONS INDICATED AS MANUFACTURED BY PORTFOLIO CB042-1042-8400-LHB26 WITH (1) 42W COMPACT FLUORESCENT LAMP.
- 12 ALL EXISTING POWER FIRE ALARM, ETC IS TO REMAIN, EXCEPT AS INDICATED OTHERWISE. REMOVE EXISTING LIGHTING AND STORE FOR RE-USE ELSEWHERE IN THIS SCOPE OF WORK. PROVIDE (1) NEW 2X2 AT LOCATION INDICATED AS MANUFACTURED BY CORELITE #R2-W-L-3-T5-1-C (E AS REQUIRED)-UNV-22-T1. WITH (3) 24W TSHO LAMPS AND (1) 1-LAMP AND (1) 2-LAMP BALLAST FOR DUAL LEVEL SWITCHING AND (3) NEW 2X4 AT LOCATION INDICATED AS MANUFACTURED BY CORELITE #R2-W-L-3-T5-1-C (E AS REQUIRED)-UNV-24-T1. WITH (3) 54W TSHO LAMPS AND (1) 1-LAMP AND (1) 2-LAMP BALLAST FOR DUAL LEVEL SWITCHING. CONNECT NEW FIXTURES TO EXISTING BRANCH CIRCUIT SERVING THE AREA AND NEW SWITCHING AS INDICATED. ENSURE CIRCUIT AMPACITY IS NOT EXCEEDED.
- 13 ALL EXISTING POWER FIRE ALARM, ETC IS TO REMAIN, EXCEPT AS INDICATED OTHERWISE. RELOCATE EXISTING LIGHTING AND PROVIDE A RELOCATED FIXTURE MAINTAINED FROM DEMOLITION PHASES. CLEAN, RE-LAMP AND RE-BALLAST AND MOUNT AS INDICATED CONNECT TO EXISTING CIRCUIT AND SWITCHING SERVING THE AREA. ENSURE CIRCUIT AMPACITY IS NOT EXCEEDED.