

O.R. FURNITURE & EQUIPMENT SCHEDULE

ITEM NUMBER	FIXED AND WALL MOUNTED FURNITURE AND EQUIPMENT	QUANTITY	SIZE & WEIGHT	OVERALL CLEARANCE IF APPLICABLE	OTHER	UTILITIES REQUIRED BY EQUIPMENT		REMARKS
						ELECTRICAL	MECHANICAL	
01	PORTABLE MED/SUPPLY CART FOR ANESTHESIA	1	EXISTING					
02	ANESTHESIA MACHINE	1	EXISTING					
03	NOT USED							
04	BASIN STAND	2	14" x 34" x 14"					
05	CAMERA CONTROL UNIT	1	9" x 4" x 15" x 13"					
06	CART	2						
07	ELECTROCONDUCTIVE RESTRAINT	1						
08	ELECTROSURGICAL UNIT	1						
09	EQUIPMENT BOARD	1						
10	EQUIPMENT ROOM	1						
11	NOT USED							
12	GLOVE BOX HOLDER	3						
13	HAMPER	2	18" x 32"					
14	HEADLIGHT	1	15" x 5" x 16" x 24"					
15	HEADLIGHT LIGHT SOURCE	1	15" x 5" x 16" x 24"					
16	ILLUMINATOR	1	24" x 24" x 48"					
17	INSTRUMENT TABLE	2	24" x 42" x 48"					
18	INSTRUMENT TABLES	1	24" x 42" x 48"					
19	INSUFFLATOR 40L HIGH FLOW	1	10" x 5" x 15" x 16"					
20	IV STAND	1	20" x 108" x 20"					
21	KICK BUCKET	2	13" x 14" x 16"					
22	MAVO STAND	2	21" x 62" x 16"					
23	MONITOR	1	17" x 14" x 3"					
24	MONITOR DISPLAY	2	17" x 14" x 3"					
25	PATIENT TRANSFER ROLLER	1						
26	O.R. COMPUTER	1						
27	PRINTER	1	15" x 5" x 16" x 14"					
28	SOC PRO 2 DIGITAL CAPTURE	1	12" x 30"					
29	STEP STOOL	4	12" x 30"					
30	STOOLS	3	15"					

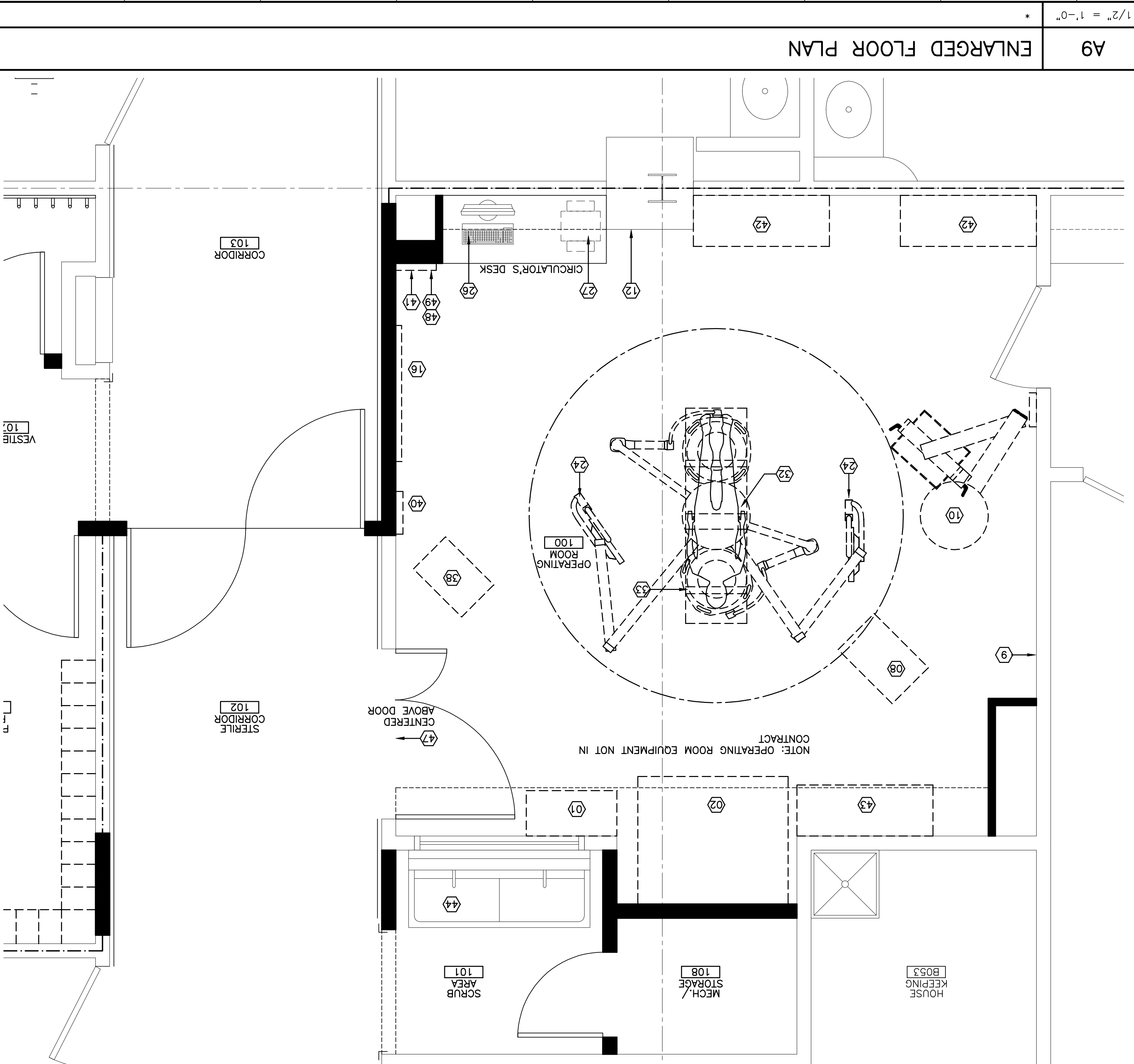

O.R. FURNITURE & EQUIPMENT SCHEDULE

ITEM NUMBER	FIXED AND WALL MOUNTED FURNITURE AND EQUIPMENT	QUANTITY	SIZE & WEIGHT	OVERALL CLEARANCE IF APPLICABLE	OTHER	UTILITIES REQUIRED BY EQUIPMENT		REMARKS
						ELECTRICAL	MECHANICAL	
31	SUCTION CANNISTERS	1	EXISTING					
32	SURGICAL LIGHT	1						
33	SURGICAL TABLE	1						
34	NOT USED							
35	SURGICAL TABLE X-RAY TOP	1	10" x 4" x 13" x 11"					
36	SURGICAL TABLE, HERMES BOX	1						
37	VACUUM HOSE	2						
38	WARMER	1						
39	WASTE CONTAINER	2						
40	X-RAY BASKET	1						
41	SURGICAL LIGHT SYSTEM	1						
42	O.R. STORAGE CONSOLE, MISC.	2						
43	O.R. STORAGE CONSOLE, TABLE	1						
44	SCRUB STATION	1						
45	NOT USED							
46	NOT USED							
47	SYSTEM WALL CLOCK	1						
48	FIRE EXTINGUISHER	1						
49	FIRE BLANKET	1						

ENLARGED FLOOR PLAN, REFLECTED CEILING PLAN AND EQUIPMENT SCHEDULE

PROJECT: MAINE MEDICAL CENTER O.R. RENOVATION
 144 Fore Street, P.O. Box 618 Portland, Maine 04104
 Tel. (207) 773-3846 Fax. (207) 773-1070

ARCHITECTURE ENGINEERING PLANNING

PROJECT NORTH

ISSUED FOR CONSTRUCTION 7-29-04

GENERAL NOTES:

0/0 - OWNER FURNISHED/OWNER INSTALLED
 C/C - CONTRACTOR FURNISHED/CONTRACTOR INSTALLED
 O/C - CONTRACTOR FURNISHED/CONTRACTOR INSTALLED

REVISIONS:

REV.	DESCRIPTION	DATE
0	ISSUED FOR CONSTRUCTION	7-29-04

CURRENT ISSUE STATUS: 7-29-04

PROJECT NO.: AE102

SMART CAD FILE: AE102-03122

PROJECT MANAGER: C.F.G.

DATE: 7-29-04

SCALE: AS NOTED

GRAPHIC SCALE: 1" = 1'-0"

SMART SHEET No.: AE102

PROJECT No.: 03122

ENLARGED REFLECTED CEILING PLAN

1/2" = 1'-0"