

Bramhall Radiology
ANGIO RENOVATIONS
 PORTLAND, ME

ISSUED FOR CONSTRUCTION
 8.24.10

REV	DATE	DESCRIPTION
0		ISSUED FOR CONSTRUCTION

GRAPHIC SCALE:
 0' 1'

SCALE:
 PROJECT MANAGER: DIV
 JCDRAWN BY:
 A/E OF RECORD: DIV
 PROJECT NO.: 09022-01
 DATE: 8.24.10
 SHEET TITLE:
**VENDOR EQUIPMENT
 DRAWINGS SHEET 9**

SHEET No.
Q-009

REFERENCE DOCUMENT - NOT FOR CONSTRUCTION

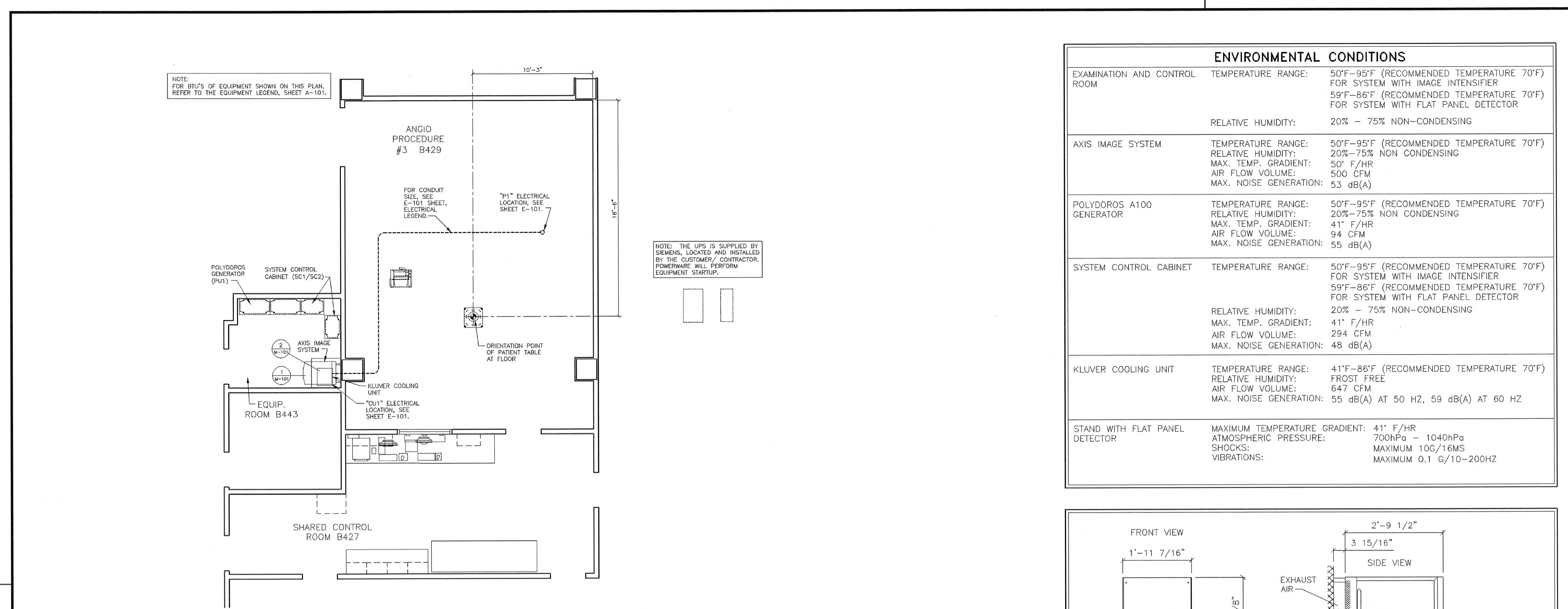

MECHANICAL PLAN SCALE: 1/4" = 1'-0"

ENVIRONMENTAL CONDITIONS	
EXAMINATION AND CONTROL ROOM	TEMPERATURE RANGE: 50°F-95°F (RECOMMENDED TEMPERATURE 70°F) FOR SYSTEM WITH IMAGE INTENSIFIER 59°F-86°F (RECOMMENDED TEMPERATURE 70°F) FOR SYSTEM WITH FLAT PANEL DETECTOR RELATIVE HUMIDITY: 20% - 75% NON-CONDENSING
AXIS IMAGE SYSTEM	TEMPERATURE RANGE: 50°F-95°F (RECOMMENDED TEMPERATURE 70°F) RELATIVE HUMIDITY: 20%-75% NON CONDENSING MAX. TEMP. GRADIENT: 50° F/HR AIR FLOW VOLUME: 500 CFM MAX. NOISE GENERATION: 53 dB(A)
POLYDOROS A100 GENERATOR	TEMPERATURE RANGE: 50°F-95°F (RECOMMENDED TEMPERATURE 70°F) RELATIVE HUMIDITY: 20%-75% NON CONDENSING MAX. TEMP. GRADIENT: 41° F/HR AIR FLOW VOLUME: 94 CFM MAX. NOISE GENERATION: 55 dB(A)
SYSTEM CONTROL CABINET	TEMPERATURE RANGE: 50°F-95°F (RECOMMENDED TEMPERATURE 70°F) FOR SYSTEM WITH IMAGE INTENSIFIER 59°F-86°F (RECOMMENDED TEMPERATURE 70°F) FOR SYSTEM WITH FLAT PANEL DETECTOR RELATIVE HUMIDITY: 20% - 75% NON-CONDENSING MAX. TEMP. GRADIENT: 41° F/HR AIR FLOW VOLUME: 294 CFM MAX. NOISE GENERATION: 48 dB(A)
KLUVER COOLING UNIT	TEMPERATURE RANGE: 41°F-86°F (RECOMMENDED TEMPERATURE 70°F) RELATIVE HUMIDITY: FROST FREE AIR FLOW VOLUME: 647 CFM MAX. NOISE GENERATION: 55 dB(A) AT 50 HZ, 59 dB(A) AT 60 HZ
STAND WITH FLAT PANEL DETECTOR	MAXIMUM TEMPERATURE GRADIENT: 41° F/HR ATMOSPHERIC PRESSURE: 700hPa - 1040hPa SHOCKS: MAXIMUM 10G/16MS VIBRATIONS: MAXIMUM 0.1 G/10-200HZ

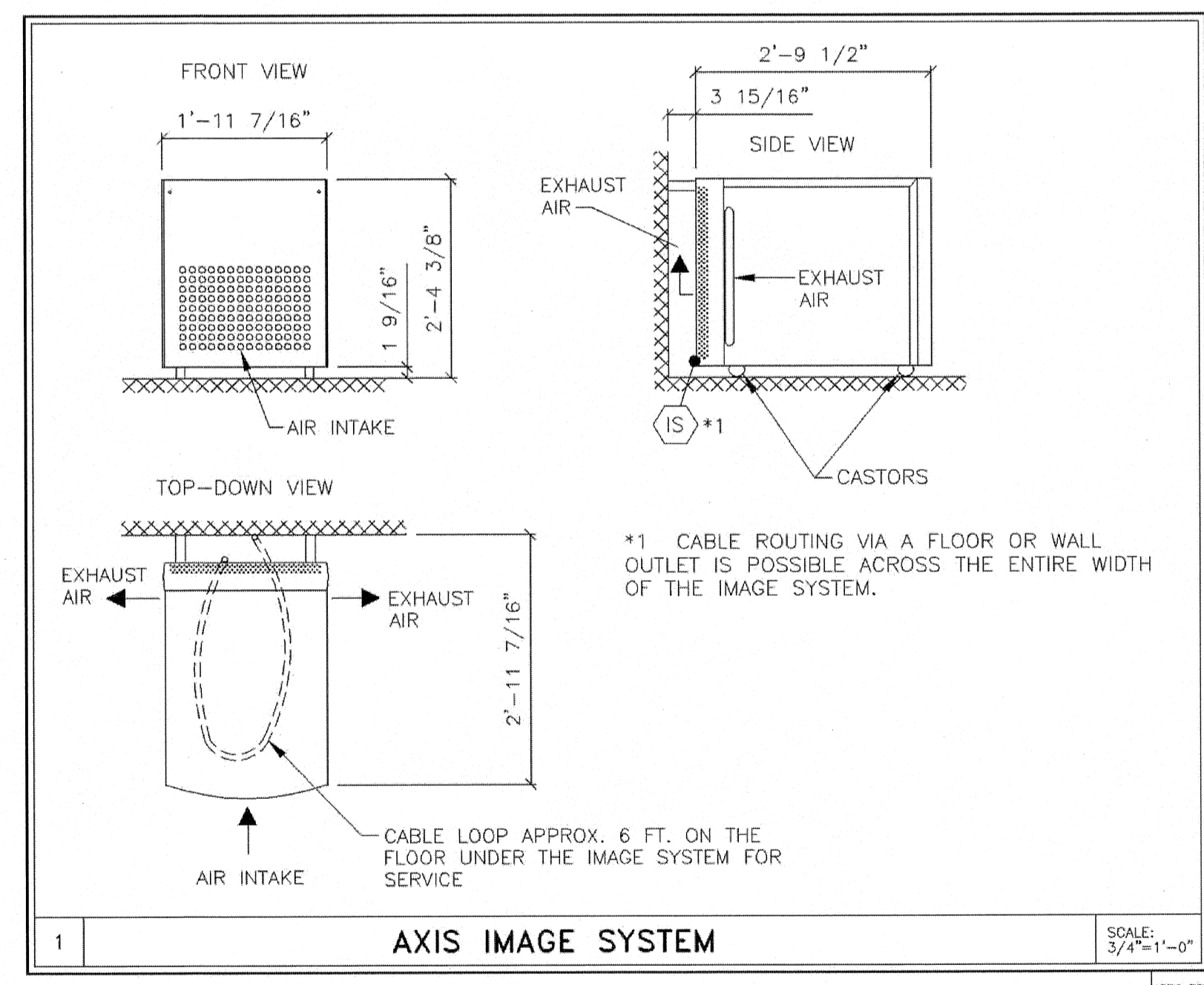

PROJECT MANAGER: RICH DEISTER
 TEL: (207) 929-3556 EXT:
 FAX: (207) 929-3776
 EMAIL: rich.deister@siemens.com

SIEMENS
MAINE MEDICAL CENTER
 22 BRAMHALL STREET, PORTLAND, ME 04102
 ANGIO EXAM ROOM #3, B 429- ARTIS ZEE CEILING

PROJECT #: **1001341** SHEET: **M-101**

SHEET OF 8 DRAWN BY: S. DOUGLAS
 DATE: 08/19/10 CHECKED:

SCALE: AS NOTED REF: #0141773

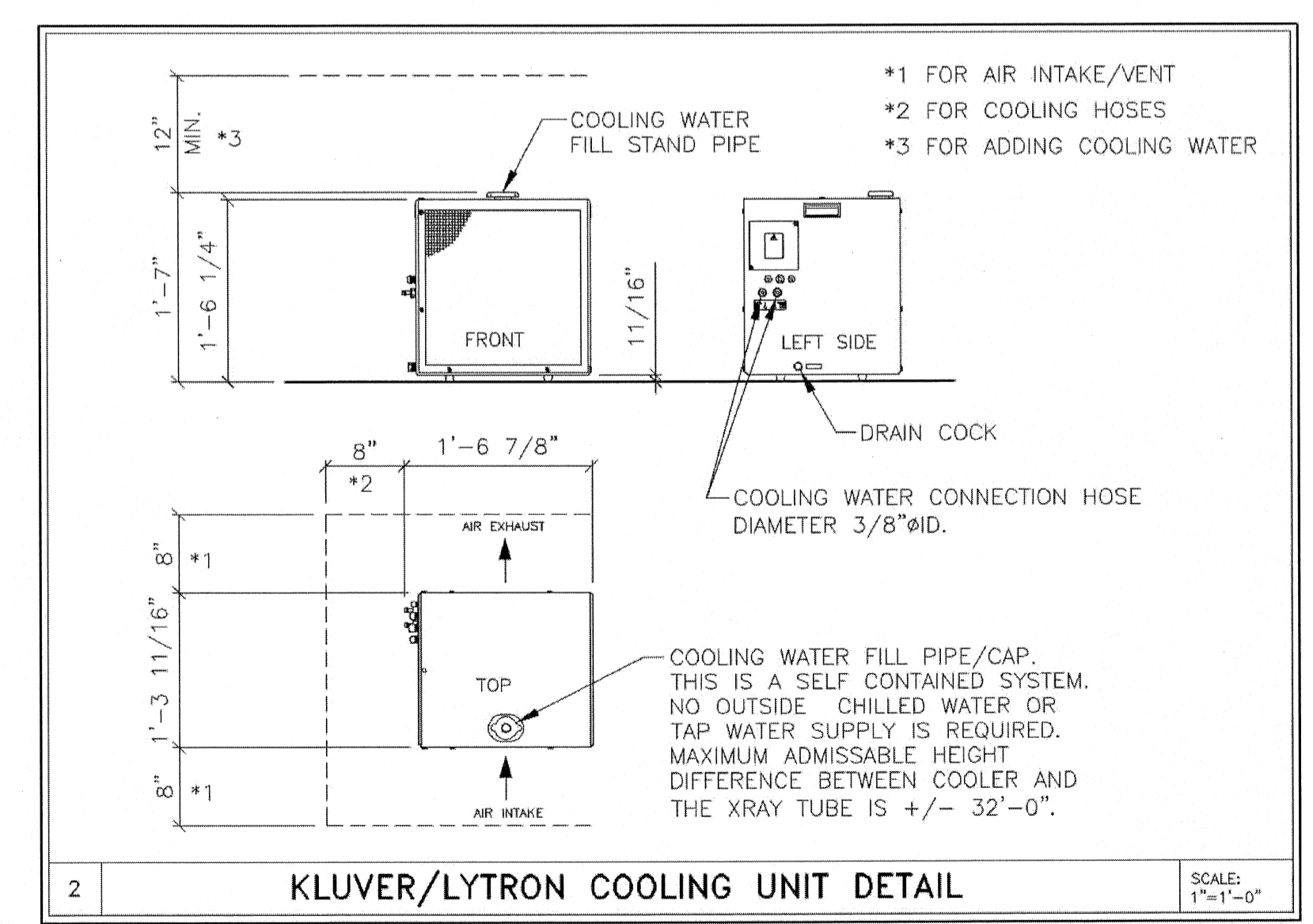

ATTENTION:

-THIS DRAWING IS DESIGNED TO CONFORM TO FEATURES AND EQUIPMENT REQUIREMENTS PRESENTED AT THE TIME OF THEIR PREPARATION. SINCE BOTH THESE FACTORS ARE SUBJECT TO DESIGN MODIFICATION, THEY ARE NOT TO BE USED FOR CONSTRUCTION PURPOSES.
 -THIS SET OF PLANS REPRESENTS A COMPLETE SET OF DETAILS AND SHOULD NOT BE SEPARATED.

-IT IS RECOMMENDED THAT THE SIEMENS DRAWINGS BE INCORPORATED WITH THE CONSTRUCTION DOCUMENTS FOR REFERENCE.

-ALL DIMENSIONS SHOWN ON THIS DRAWING ARE FROM FINISHED SURFACES.
 -THE DRAWING DOES NOT PROVIDE RADIATION SHIELDING REQUIREMENTS FOR X-RAY AND ASSOCIATED EQUIPMENT. THE CUSTOMER IS RESPONSIBLE FOR CONSULTING WITH A REGISTERED RADIATION PHYSICIST TO SPECIFY RADIATION PROTECTION.

CEILING HEIGHT REQUIREMENT
 8 FT. - 11 IN.

NOTE: THIS DRAWING WAS NOT PREPARED BY SMRT. IT IS PROVIDED FOR COORDINATION AND REFERENCE PURPOSES ONLY.