

Bramhall Radiology
ANGIO RENOVATIONS
 PORTLAND, ME

ISSUED FOR CONSTRUCTION
08.24.10

CURRENT ISSUE STATUS:

NO.	DATE	DESCRIPTION
0	8.24.10	ISSUED FOR CONSTRUCTION
1		REV

GRAPHIC SCALE:
 0" 1"

SCALE: As indicated
 PROJECT MANAGER: DJV
 ICDRAWN BY: CBS
 A/E OF RECORD: JPP
 PROJECT NO: 09022-01
 DATE: 8.24.10

SHEET TITLE:
ENLARGED POWER PLAN SHEET 1

SHEET No.
EP401

NOTES:

- SEE SHEET E-001 FOR LEGEND AND GENERAL NOTES.
- REFER TO SIEMENS INSTALLATION DRAWINGS, PROJECT # 1001341, FOR ADDITIONAL INFORMATION.

ITEM #	DEVICE REQUIREMENTS FOR ANGIO ROOM THE ELECTRICAL CONTRACTOR IS TO PROVIDE (UNLESS NOTED OTHERWISE)
B10	4" DIAMETER BUSHED OPENING IN FLOOR DUCT "FD1" COVER.
CC	18" x 8" BUSHED OPENING IN VERTICAL DUCT "VD1" COVER AT THE FLOOR LINE.
CR1	3" DIAMETER BUSHED OPENING IN TOP OF HORIZONTAL DUCT "HD1".
CRB	4" DIAMETER BUSHED OPENING IN FLOOR DUCT "FD1" COVER.
CJ1	18"W x 18"L x 4"D PULLBOX MOUNTED FLUSH IN FINISHED WALL ABOVE SHELF. PROVIDE REMOVABLE FRONT COVER WITH 4" DIAMETER BUSHED OPENING IN THE CENTER.
D1	6" DIAMETER OPENING IN THE BOTTOM OF CEILING DUCT "CD1" AND 4" DIAMETER SLEEVE FROM DUCT TO FLUSH WITH CEILING. PROVIDE BUSHING AT CEILING LINE.
DS	DOOR LIMIT SWITCH, 120V, 5A RATED SWITCH CONTACTS TO OPEN WHEN DOOR IS OPEN. MOUNT IN UPPER CORNER ON STRIKE SIDE OF MAIN ENTRY DOOR.
EPO	EMERGENCY OFF PUSHBUTTONS WITH 2 NORMALLY CLOSED CONTACTS AND GUARD. ALLEN-BRADLEY PART # 800T-FX6A5 WITH 800T-N129 GUARD OR EQUAL.
IC	PULLBOX, SIZE AS REQUIRED, MOUNTED ABOVE CEILING IN LOCATION COORDINATED WITH INTERCOM INSTALLATION. PROVIDE REMOVABLE BOTTOM COVER WITH 2" DIAMETER BUSHING OPENING.
IS	3" DIAMETER BUSHED OPENING IN VERTICAL DUCT "VD3" AT THE FLOOR LINE.
IVU	3" DIAMETER BUSHED OPENING IN TOP OF HORIZONTAL DUCT "HD1".
ME1	2 POLE, 20AMP, 208VOLT CIRCUIT BREAKER WITH SHUNT TRIP ACCESSORY IN A NEMA 1 SURFACE MOUNTED ENCLOSURE.
MH	2 POLE, 20AMP, 208VOLT 22,000 AIC SINGLE THROW SWITCH MOUNTED IN A RECESSED BOX.
MP	480VOLT, 125AMP, 3 PHASE MAIN BREAKER PANEL WITH UNDERVOLTAGE TRIP COIL POWERED BY A 277-120VOLT TRANSFORMER MOUNTED INSIDE OR ADJACENT TO THE PANEL. PROVIDE 2 GROUND BARS, ONE SAFETY GROUND AND ONE ISOLATED. PROVIDE 2 BRANCH BREAKERS, ONE 100AMP, 3 POLE AND ONE 50AMP, 3 POLE. TRIP COIL SHALL BE WIRED IN SERIES WITH THE EPO SWITCHES.
MV	NEMA 14-20R RECEPTACLE INSTALLED 18" AFF. ALSO FURNISH AND INSTALL A NEMA L14-20P FOR A SIEMENS PROVIDED POWER CORD.
MV1	3" DIAMETER BUSHED OPENING IN TOP OF HORIZONTAL DUCT "HD1".
OV1	2" DIAMETER BUSHED OPENING IN TOP OF HORIZONTAL DUCT "HD1".
P1	PULLBOX, SIZE AS REQUIRED, MOUNTED ABOVE CEILING WITH REMOVABLE BOTTOM COVER AND 8" DIAMETER BUSHING OPENING. FOR C-ARM.
PU1	PULLBOX, SIZE AS REQUIRED, MOUNTED FLUSH IN WALL AT FLOOR LINE WITH REMOVABLE FRONT COVER AND 4" DIAMETER BUSHED OPENING AT BOTTOM OF COVER.
RMP	PULLBOX, SIZE AS REQUIRED, MOUNTED FLUSH IN WALL AT HEIGHT COORDINATED WITH UPS REMOTE MONITOR PANEL.
SC1	PULLBOX, SIZE AS REQUIRED, MOUNTED FLUSH IN WALL AT FLOOR LINE WITH REMOVABLE FRONT COVER AND 4" DIAMETER BUSHED OPENING AT BOTTOM OF COVER.
SC2	6" DIAMETER BUSHED OPENING IN FLOOR DUCT "FD1" COVER.
T1	4" DIAMETER BUSHED OPENING IN FLOOR DUCT "FD1" COVER.
WL	WARNING LIGHT. PROVIDE SURFACE MOUNTED X-RAY ON FIXTURE ABOVE DOOR. X-RAY OR LIGHT SHALL BE SURE-LITES LPX6-G8 OR EQUAL.
CD1	18"W x 3 1/2"D CEILING DUCT MOUNTED ABOVE FINISHED CEILING. PROVIDE REMOVABLE TOP COVER WITH OPENINGS AS SHOWN. PROVIDE DIVIDERS TO SEPARATE POWER AND SIGNAL CABLING. BEGIN DUCT AT FLOOR LINE AND EXTEND UP WALL TO ABOVE FINISHED CEILING AND CONNECT TO CEILING DUCT "CD1" WHERE SHOWN.
CD2	10"W x 3 1/2"D CEILING DUCT MOUNTED ABOVE FINISHED CEILING. PROVIDE REMOVABLE TOP COVER WITH OPENINGS AS SHOWN. PROVIDE DIVIDERS TO SEPARATE POWER AND SIGNAL CABLING. CONNECT TO VERTICAL DUCT "VD2" AND "VD3" WHERE SHOWN.
FD1	6"W x 3 1/2"D FLOOR DUCT MOUNTED FLUSH WITH FLOOR. PROVIDE WATER TIGHT REMOVABLE TOP COVER WITH OPENINGS AS SHOWN. PROVIDE DIVIDERS TO SEPARATE POWER AND SIGNAL CABLING.
HD1	10"W x 3 1/2"D HORIZONTAL WALL DUCT SURFACE MOUNTED AT FLOOR LINE. PROVIDE REMOVABLE FRONT COVER WITH OPENINGS AS SHOWN. PROVIDE DIVIDERS TO SEPARATE POWER AND SIGNAL CABLING. CONNECT TO VERTICAL DUCT "VD2" WHERE SHOWN.
VD1	18"W x 3 1/2"D VERTICAL DUCT MOUNTED FLUSH IN WALL. PROVIDE REMOVABLE FRONT COVER WITH OPENINGS AS SHOWN. PROVIDE DIVIDERS TO SEPARATE POWER AND SIGNAL CABLING. BEGIN DUCT AT FLOOR LINE AND EXTEND UP WALL TO ABOVE FINISHED CEILING AND CONNECT TO CEILING DUCT "CD1" WHERE SHOWN.
VD2	10"W x 3 1/2"D VERTICAL DUCT MOUNTED FLUSH IN WALL. PROVIDE REMOVABLE FRONT COVER WITH OPENINGS AS SHOWN. PROVIDE DIVIDERS TO SEPARATE POWER AND SIGNAL CABLING. BEGIN DUCT AT FLOOR LINE AND EXTEND UP WALL TO ABOVE FINISHED CEILING AND CONNECT TO CEILING DUCT "CD2" WHERE SHOWN.
VD3	10"W x 3 1/2"D VERTICAL DUCT MOUNTED FLUSH IN WALL. PROVIDE REMOVABLE FRONT COVER WITH OPENINGS AS SHOWN. PROVIDE DIVIDERS TO SEPARATE POWER AND SIGNAL CABLING. BEGIN DUCT AT FLOOR LINE AND EXTEND UP WALL TO ABOVE FINISHED CEILING AND CONNECT TO CEILING DUCT "CD2" WHERE SHOWN.

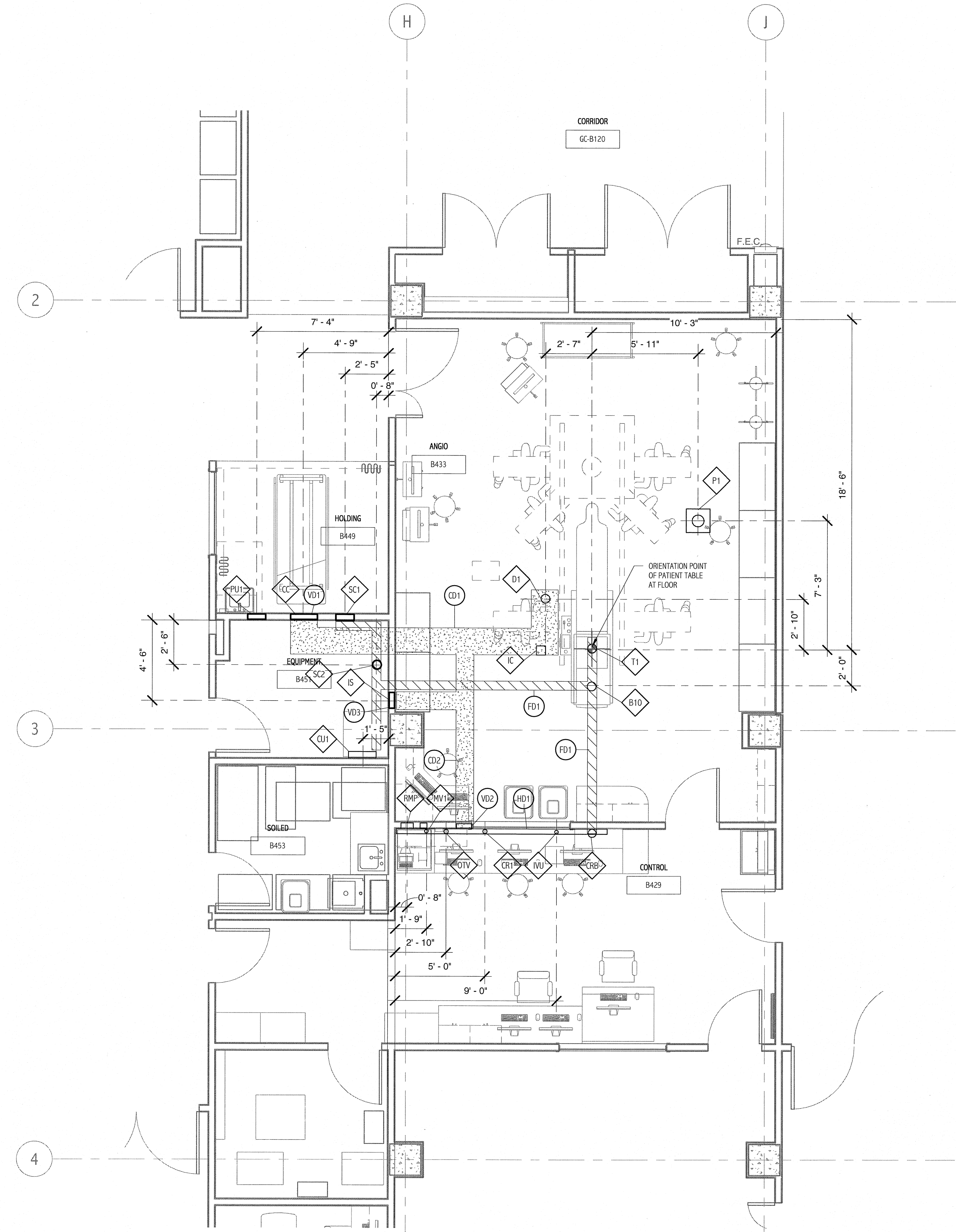

1 ANGIO ELECTRICAL DEVICE & DIMENSION PLAN - BASEMENT FLOOR
 1/4" = 1'-0"