

LOWER FLOOR PLAN
 1/4" = 1'-0" REF: NA **B1**

PLUMBING NOTES:

- CONTRACTOR SHALL FIELD VERIFY EXISTING CONDITIONS BEFORE PERFORMING THE WORK SHOWN ON THIS PLAN.
- CONTRACTOR SHALL FIELD VERIFY EXISTING COMPOSITION AND MANUFACTURER OF EXISTING ACID WASTE AND VENT PIPING, AND PROVIDE NEW PIPING THE SAME AS EXISTING.
- CONTRACTOR SHALL COORDINATE THE DEMOLITION AND NEW WORK SHOWN ON SHOWN ON THIS PLAN WITH THE HOSPITAL TO MINIMIZE INTERRUPTION OF WORK PERFORMED BY THE HOSPITAL IN THE SPACES WHERE PLUMBING WORK IS TO BE PERFORMED.
- CONTRACTOR SHALL PERFORM AS MUCH WORK IN LOWER LEVEL AS POSSIBLE AT ONE TIME TO MINIMIZE INTERRUPTION OF HOSPITAL SERVICES PERFORMED IN THOSE SPACES WHERE PLUMBING WORK IS TO BE PERFORMED. FINAL CONNECTIONS SHALL BE MADE AT THE TIME THE EXISTING EQUIPMENT IT'S SERVING IS TAKEN OFF-LINE AND/OR NEW EQUIPMENT IS INSTALLED.
- CONTRACTOR SHALL COORDINATE FINAL CONNECTIONS INDICATED ON PLANS WITH HOSPITAL REGARDING SCHEDULE OF EQUIPMENT REMOVALS, AND INSTALLATION OF NEW EQUIPMENT.
- CONTRACTOR SHALL TAKE CARE TO LEAVE EXISTING SYSTEMS IN PLACE AND FUNCTIONAL UNTIL EQUIPMENT BEING SERVED IS TAKEN OUT OF SERVICE.

FLOOR DRAIN SPECIFICATIONS:

FLOOR DRAIN SHALL BE WATTS MODEL FD-1102-AS-60 OR EQUAL. PVC BODY WITH 5" STAINLESS STEEL STRAINER. PROVIDE WITH ADDITIONAL SOLID NICKEL-BRONZE GASKETED COVER PLATE INSTALLED FLUSH WITH FLOOR. RETAIN STRAINER FOR FUTURE INSTALLATION.

LEGEND

- AV ACID RESISTANT VENT PIPE
- AW ACID RESISTANT WASTE PIPE
- EXAV EXISTING ACID RESISTANT PIPE
- EXAW EXISTING ACID RESISTANT WASTE PIPE
- EXG EXISTING
- EXSD EXISTING STORM DRAIN
- POINT OF CONNECTION TO EXISTING
- ✕ EXISTING TO BE REMOVED

HARRIMAN
 Architects + Engineers
 One Auburn Business Park
 Auburn, Maine 04210
 207.784.5100 tel
 207.782.3017 fax

66 Pearl St., Suite 301
 Portland, Maine 04101
 207.775.0053 tel
 207.775.0460 fax
 www.harriman.com
 © 2008

Project Title
MAINE MEDICAL CENTER HVAC LAB RENOVATIONS
 PORTLAND, MAINE

HA Project No. **08101**

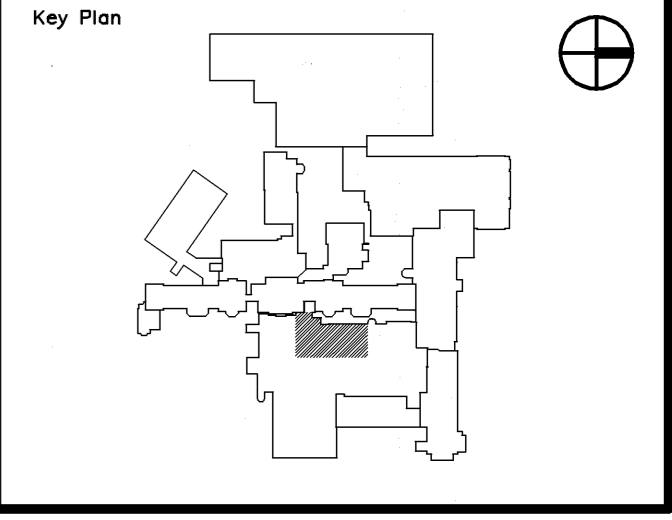

PHASING NOTES

- ① WORK TO BE PERFORMED AS PART OF PHASE 1
- ② WORK TO BE PERFORMED AS PART OF PHASE 2
- ③ WORK TO BE PERFORMED AS PART OF PHASE 3
- ④ WORK TO BE PERFORMED AS PART OF PHASE 4
- ⑤ WORK TO BE PERFORMED AS PART OF PHASE 5
- ⑥ WORK TO BE PERFORMED AS PART OF PHASE 6

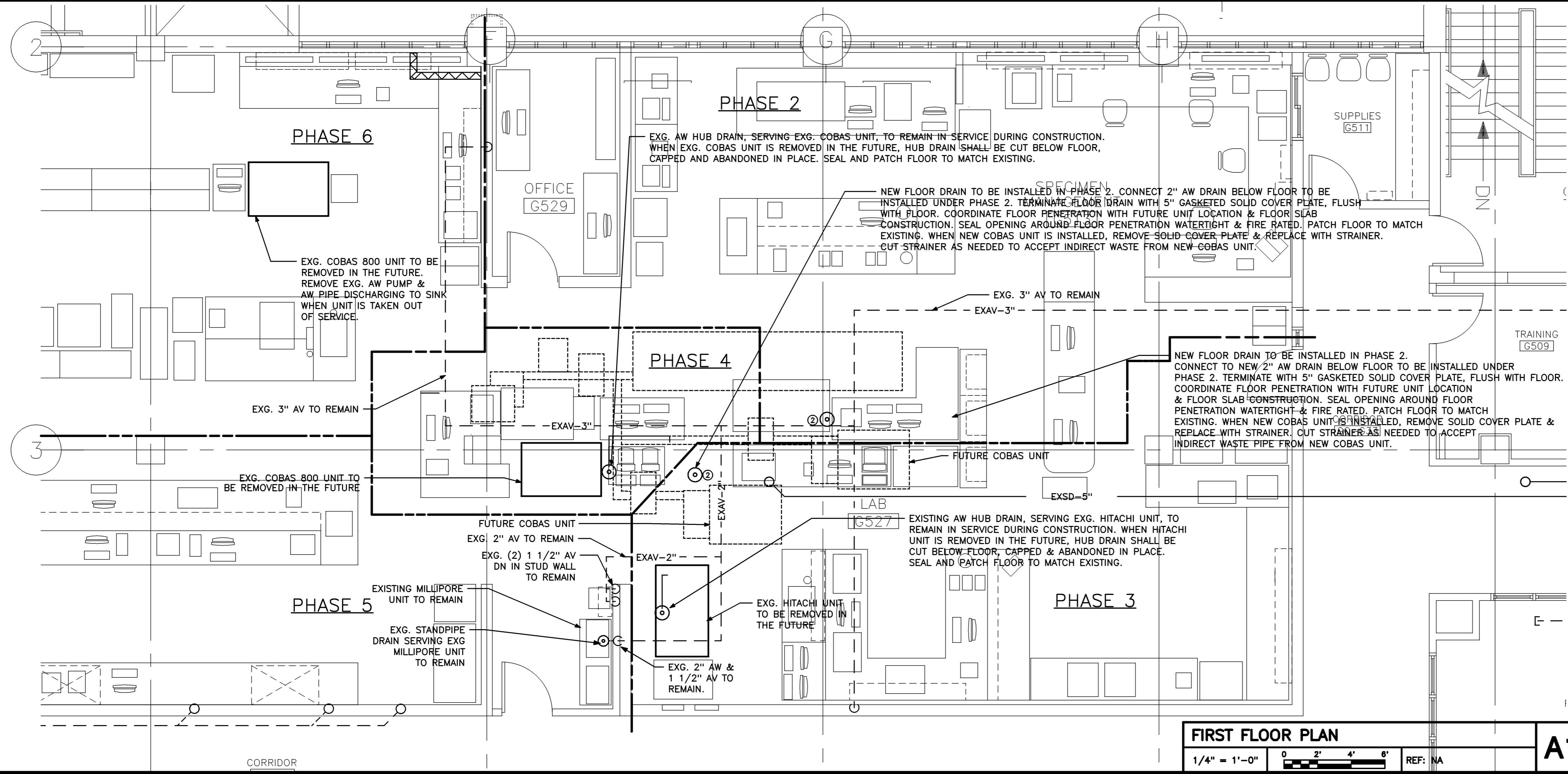

FIRST FLOOR PLAN
 1/4" = 1'-0" REF: NA **A1**

10-31-08	ISSUED FOR BID
Mark	Date Description
Issue Dates	

Drawing Status	
----------------	--

Drawing Title
PLUMBING LOWER & FIRST FLOOR PLANS-NEW & DEMO

PA / PE: **CG** Drawn By: **MED**

Drawing Number

P10.1