

General Notes:  
 1. ALL SNOW MELT SYSTEM WORK SHOWN, NOTED, AND REQUIRED SHALL BE BID UNDER ADD ALTERNATE NO. 10.

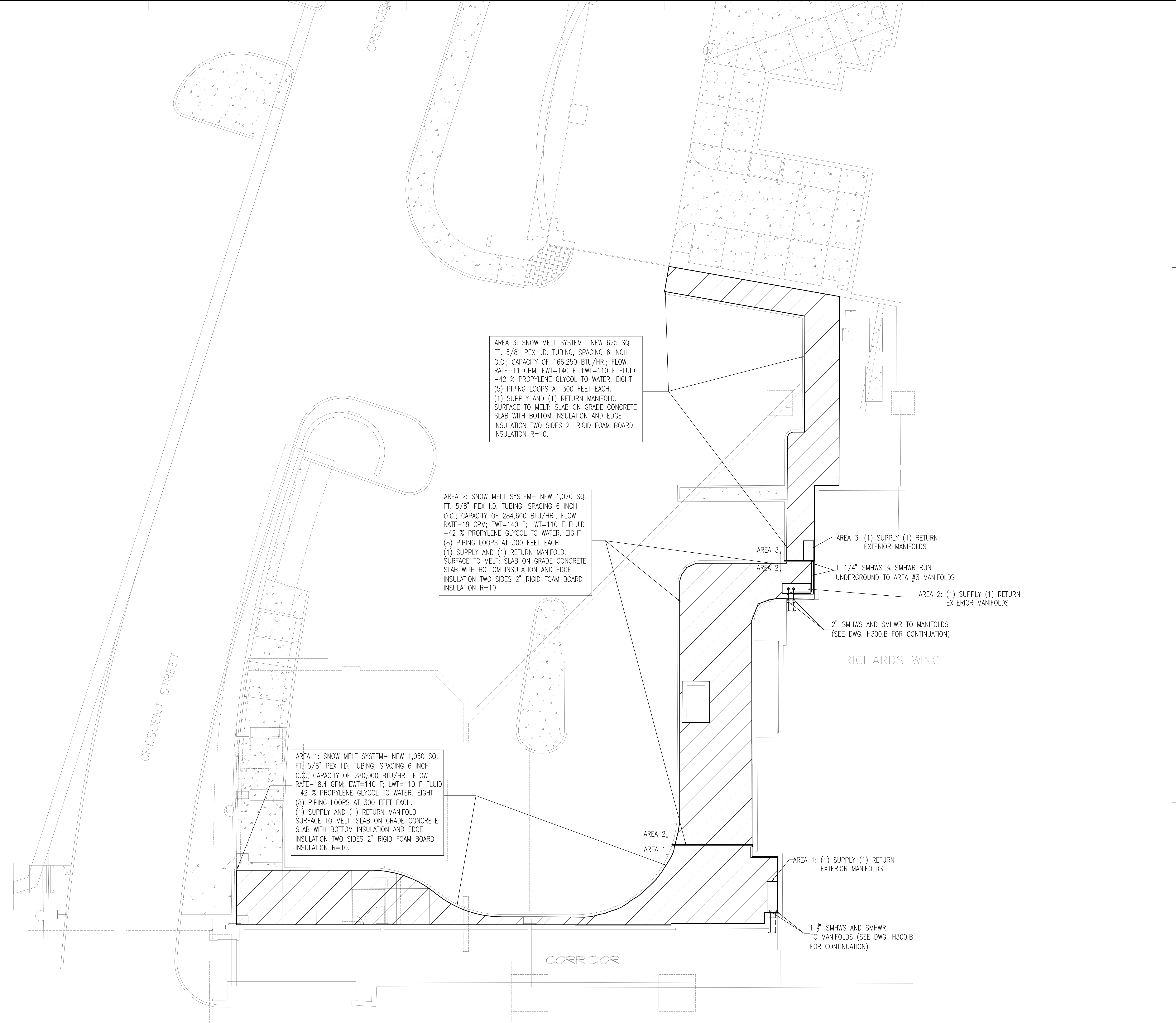

AREA 3: SNOW MELT SYSTEM- NEW 625 SQ. FT. 5/8" PEX I.D. TUBING, SPACING 6 INCH O.C.; CAPACITY OF 166,250 BTU/HR.; FLOW RATE-11 GPM; EWT=140 F; LWT=110 F FLUID -42 % PROPYLENE GLYCOL TO WATER. EIGHT (5) PIPING LOOPS AT 300 FEET EACH. (1) SUPPLY AND (1) RETURN MANIFOLD. SURFACE TO MELT: SLAB ON GRADE CONCRETE SLAB WITH BOTTOM INSULATION AND EDGE INSULATION TWO SIDES 2" RIGID FOAM BOARD INSULATION R=10.

AREA 2: SNOW MELT SYSTEM- NEW 1,070 SQ. FT. 5/8" PEX I.D. TUBING, SPACING 6 INCH O.C.; CAPACITY OF 284,600 BTU/HR.; FLOW RATE-19 GPM; EWT=140 F; LWT=110 F FLUID -42 % PROPYLENE GLYCOL TO WATER. EIGHT (8) PIPING LOOPS AT 300 FEET EACH. (1) SUPPLY AND (1) RETURN MANIFOLD. SURFACE TO MELT: SLAB ON GRADE CONCRETE SLAB WITH BOTTOM INSULATION AND EDGE INSULATION TWO SIDES 2" RIGID FOAM BOARD INSULATION R=10.

AREA 1: SNOW MELT SYSTEM- NEW 1,050 SQ. FT. 5/8" PEX I.D. TUBING, SPACING 6 INCH O.C.; CAPACITY OF 280,000 BTU/HR.; FLOW RATE-18.4 GPM; EWT=140 F; LWT=110 F FLUID -42 % PROPYLENE GLYCOL TO WATER. EIGHT (8) PIPING LOOPS AT 300 FEET EACH. (1) SUPPLY AND (1) RETURN MANIFOLD. SURFACE TO MELT: SLAB ON GRADE CONCRETE SLAB WITH BOTTOM INSULATION AND EDGE INSULATION TWO SIDES 2" RIGID FOAM BOARD INSULATION R=10.

AREA 3: (1) SUPPLY (1) RETURN EXTERIOR MANIFOLDS

1-1/4" SMHWS & SMHWR RUN UNDERGROUND TO AREA #3 MANIFOLDS

AREA 2: (1) SUPPLY (1) RETURN EXTERIOR MANIFOLDS

2" SMHWS AND SMHWR TO MANIFOLDS (SEE DWG. H300.B FOR CONTINUATION)

RICHARDS WING

AREA 1: (1) SUPPLY (1) RETURN EXTERIOR MANIFOLDS

1 3/8" SMHWS AND SMHWR TO MANIFOLDS (SEE DWG. H300.B FOR CONTINUATION)

MARK	ISSUE DATE	DESCRIPTION
A1	01/10/08	ADDENDUM NO. 1

Issue Log

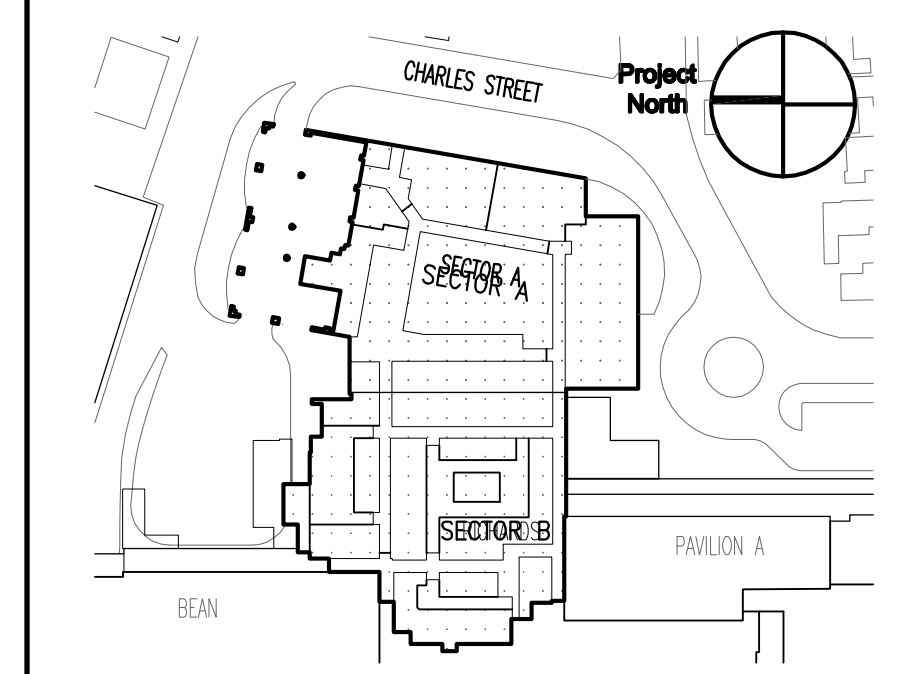

Key Plan

**TRO Jung|Brannen**  
 ARCHITECTURE INTERIOR DESIGN ENGINEERING MASTER PLANNING  
 22 Boston Wharf Road, Boston, Massachusetts 02210  
 Tel 617.502.8400 Fax 617.502.3402 www.trojungbrannen.com

**Maine Medical Center**  
 ED Expansion and Renovation  
 Portland, Maine MMC Project No. 21843

Drawing Title  
**HVAC  
 SNOW MELT SYSTEM  
 AREA PLAN**

Drawn By	M.J.C.	Commission No.	4696
Approved By	J.N.	Date Issued	12/14/07

Phase / Package Number	Sheet Number
------------------------	--------------

**H201**

SCALE: 1/8" = 1'-0"