

- General Notes:**
- DEMOLITION NOTES:**
- REMOVE EXISTING TERMINAL BOXES ENTIRELY AND ASSOCIATED DUCTWORK, DIFFUSERS, REGISTERS, CONTROLS AND APPURTENANCES.
  - REMOVE EXISTING HOT WATER HEATING COILS ENTIRELY AND ASSOCIATED DUCTWORK, DIFFUSERS, REGISTERS, CONTROLS AND APPURTENANCES.
  - REMOVE EXISTING CABINET UNIT HEATERS ENTIRELY AND ASSOCIATED DUCTWORK, DIFFUSERS, REGISTERS, CONTROLS AND APPURTENANCES.
  - REMOVE EXISTING SUPPLY, RETURN, AND EXHAUST DUCTWORK ENTIRELY AND ASSOCIATED DIFFUSERS, REGISTERS, GRILLES, LINEAR DIFFUSERS, DAMPERS AND ALL APPURTENANCES AS SHOWN, NOTED, AND REQUIRED.
  - REMOVE EXISTING COMPUTER ROOM A/C UNIT ENTIRELY AND ASSOCIATED DUCTWORK, DIFFUSERS, REGISTERS, CONTROLS AND APPURTENANCES.
  - REMOVE EXISTING DECONTAMINATION ROOM EXHAUST SYSTEM ENTIRELY INCLUDING ALL ASSOCIATED DUCTWORK, REGISTERS, CONTROLS, EXHAUST FAN ON ROOF ABOVE AND ALL APPURTENANCES.
  - REMOVE EXISTING AMBULANCE ENTRY EXHAUST SYSTEM ENTIRELY INCLUDING ALL ASSOCIATED DUCTWORK, REGISTERS, CONTROLS, EXHAUST FAN ON ROOF ABOVE AND ALL APPURTENANCES.
  - REMOVE EXISTING TOILET EXHAUST SYSTEM ENTIRELY INCLUDING ALL ASSOCIATED DUCTWORK, REGISTERS, CONTROLS, EXHAUST FAN ON ROOF ABOVE AND ALL APPURTENANCES.
  - REMOVE SECTIONS OF EXISTING SUPPLY, RETURN, AND EXHAUST DUCTWORK AS REQUIRED FOR INSTALLATION OF NEW FIRE/SMOKE DAMPERS; SEE NEW WORK DUCTWORK DRAWINGS FOR EXACT LOCATIONS OF NEW FD/SD DAMPERS.
- DRAWINGS NOTES:**
- EXISTING SUPPLY, RETURN, EXHAUST, AND RELIEF DUCTWORK & RISERS ; WHICH TRAVEL THROUGH THE EXISTING RICHARD'S BUILDING ED BASEMENT CEILING SHALL REMAIN UNLESS OTHERWISE NOTED OR REQUIRED TO BE MODIFIED.

MARK	ISSUE DATE	DESCRIPTION
A1	01/10/08	ADDENDUM NO. 1
B10	12/14/07	BID SET

Issue Log

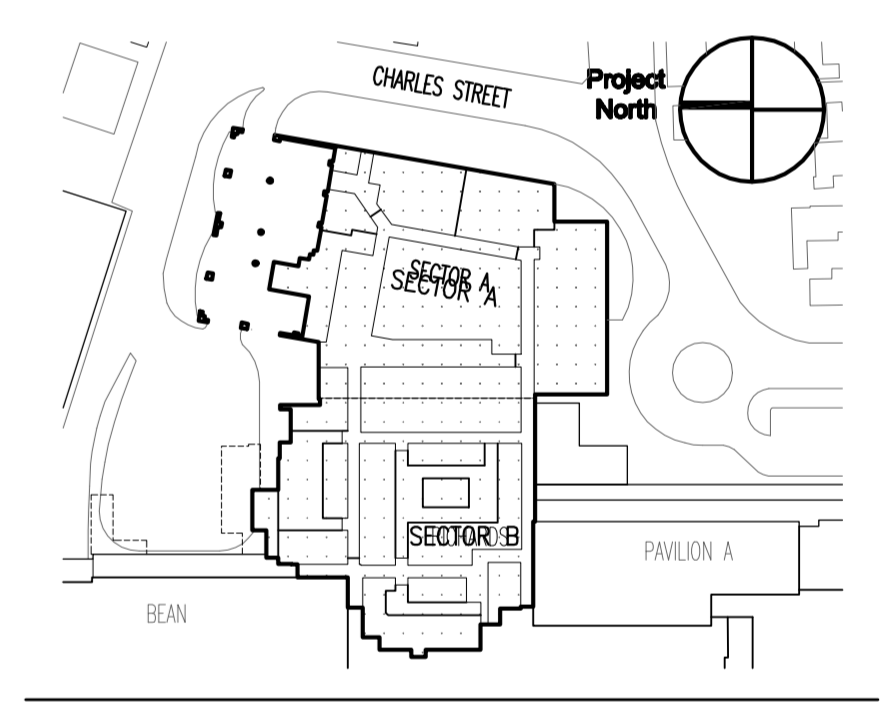

**GENERAL NOTES:**

- PRIOR TO DEMOLITION, THE CONSTRUCTION MANAGER (CM) SHALL COORDINATE A PRE-DEMOLITION TESTING, ADJUSTING, AND BALANCING WORK WITHIN THE EXISTING RICHARD'S BUILDING EMERGENCY DEPT. THE TESTING, ADJUSTING, AND BALANCING CONTRACTOR (TAB) SHALL PROVIDE ALL WORK AND CARRY ALL COST TO PROVIDE A PRE-DEMOLITION AIR FLOW READINGS AND WATER FLOW READINGS FOR ALL HVAC SYSTEMS. THE PRE-DEMO. TAB REPORT SHALL INCLUDE THE EXISTING AIR FLOW CFM RADINGS FOR ALL SUPPLY DIFFUSERS, RETURN/EXHAUST REGISTERS, EXISTING TERMINAL BOX CFM AND WATER FLOW GPM, EXISTING REHEAT COIL GPM, EXISTING HWS & HWR PIPING MAINS WATER FLOW GPM. PROVIDE DUCT TRAVERSE READINGS ACROSS THE MAIN SUPPLY AND RETURN DUCTS FROM EXISTING BEAN 4 AHU UNIT SERVING THIS SPACE. DUCT TRAVERSE READINGS ACROSS THE EXISTING ROOFTOP UNIT ON CAFE ROOF SERVING THIS SPACE. DUCT TRAVERSE ACROSS THE EXISTING ISOLATION EXHAUST DUCT AND FAN IN BEAN 4 MECH. RM. PROVIDE A TYPED AND ORGANIZED TAB REPORT AND SUBMIT THRU CM WITH COPIES FOR PROJECT ARCHITECT AND OWNER.
- THIS CONTRACTOR SHALL REFER TO THE CONSTRUCTION MANAGER'S (CM) PHASING PLAN/SCHEDULE AND BASEMENT DEMOLITION PLAN A108 FOR PHASED REMOVAL OF HVAC SYSTEMS AS REQUIRED. THIS CONTRACTOR CARRY ALL COSTS FOR PHASING OF WORK AND COORDINATE WITH CONSTRUCTION MANAGER'S (CM) PHASING SCHEDULE.

**TRO Jung|Brannen**  
 ARCHITECTURE INTERIOR DESIGN ENGINEERING MASTER PLANNING  
 22 Boston Wharf Road, Boston, Massachusetts 02210  
 Tel: 617.352.3400 Fax: 617.352.3402 www.trojungbrannen.com

**Maine Medical Center**  
 ED Expansion and Renovation  
 Portland, Maine MMC Project No. 21843

**Drawing Title**  
**HVAC BASEMENT DEMOLITION DUCTWORK-SECTOR "B"**

Drawn By: MJC Commission No. 4696  
 Approved By: MJC Date Issued: 12/14/07

Phase / Package Number: Sheet Number  
**H100**

**BASEMENT DEMOLITION PLAN**  
**SECTOR "B"**  
 SCALE: 1/8"=1'-0"

