

DEMOLITION NOTES:

- REFER TO THE ARCHITECTURAL FLOOR PLANS FOR THE SCOPE OF THE DEMOLITION.
- ELECTRICAL CONTRACTOR SHALL DISCONNECT AND REMOVE ALL EXISTING ELECTRICAL EQUIPMENT WITHIN THE AREAS OF DEMOLITION, UNLESS NOTED OTHERWISE.
- GENERALLY, IN ALL INDICATED AREAS SCHEDULED FOR DEMOLITION AND REMODELING, REMOVE ALL ELECTRICAL DEVICES SUCH AS LIGHTING FIXTURES, WIRING DEVICES, TELEPHONE BOXES, SPEAKERS, FIRE ALARM DEVICES, TELEVISION OUTLETS, DISCONNECTS, MOTORS, ETC. THAT ARE LOCATED ON EXISTING WALLS OR PARTITIONS WHICH ARE TO BE DEMOLISHED. REMOVE ALL EXPOSED PORTIONS OF THE BRANCH AND SIGNAL CIRCUIT WIRING AND CONDUITS AND BE RESPONSIBLE FOR MAINTAINING THE CONTINUITY OF EXISTING CIRCUITS FEEDING DEVICES THAT ARE TO REMAIN.
- IN SUCH CASES WHERE EXISTING WALLS ARE TO REMAIN, ALL EXPOSED RACEWAYS, SURFACE AND RECESSED OUTLET BOXES, WHICH ARE NOT TO BE REUSED SHALL BE COMPLETELY REMOVED. IN SUCH CASES WHERE NEW CONDUITS AND OUTLETS ARE TO BE INSTALLED IN EXISTING WALLS, IN FINISHED ROOMS, THEY SHALL BE CONCEALED BY CUTTING AND PATCHING THE WALLS FOR THE CONDUITS AND OUTLET BOXES UNLESS NOTED OTHERWISE.
- UTILIZE, WHEREVER POSSIBLE, PRACTICAL AND APPROVED BY THE ARCHITECT, EXISTING OUTLET BOXES AND ETC., COMPATIBLE WITH THE MATERIAL SPECIFIED FOR INSTALLATION IN THE NEW CONSTRUCTION AREAS. WHEREVER EXISTING RACEWAY SYSTEMS ARE UTILIZED, REMOVE ALL EXISTING WIRING. IN SUCH CASES, ALL ASSOCIATED CONDUITS AND WIRING SHALL BE ARRANGED TO ACCOMMODATE THE NEW CIRCUITING AS SHOWN ON THE DRAWINGS.
- ALL ELECTRICAL EQUIPMENT REMOVED SHALL BE STOCKPILED FOR FUTURE RE-USE. IN THE EVENT EXISTING DEVICES ARE NOT RE-USED THEY SHALL BE RETURNED TO OWNER OR DISCARDED PER OWNER DIRECTIVE.
- IN ALL EXISTING OR NEW AREAS SPECIFIED OR SHOWN TO BE PAINTED, THE ELECTRICAL CONTRACTOR SHALL REMOVE ALL ELECTRICAL ITEMS AS REQUIRED, INCLUDING BUT NOT LIMITED TO, LIGHTING FIXTURES, DEVICE PLATES, DEVICES, ETC. THE CONTRACTOR SHALL BE RESPONSIBLE FOR STORING THE REMOVED DEVICES IN A SAFE AND SECURE PLACE. THE ELECTRICAL CONTRACTOR SHALL REINSTALL THE SAME DEVICES AFTER COMPLETION OF PAINTING. ANY ITEM NOT REMOVED AND PAINTED OVER SHALL BE SUITABLY CLEANED OR REPLACED WITH A NEW ITEM BY THE ELECTRICAL CONTRACTOR.
- THE ELECTRICAL CONTRACTOR SHALL DE-ENERGIZE AND REMOVE ALL CONDUCTORS AND RACEWAYS WITHIN THE AREA OF DEMOLITION SCOPE TO THEIR POINT OF ORIGIN. ITEMS IDENTIFIED FOR DEMOLITION SHALL NOT BE ABANDONED IN PLACE. RACEWAYS THAT ENTER MASONRY WALLS AND FLOORS SHALL BE CUT FLUSH AT THE SURFACE FOR PATCHING BY OTHERS. ALL CIRCUIT BREAKERS ASSOCIATED WITH THE DEMOLITION SHALL BE DE-ENERGIZED AND RE-LABELLED AS "SPARE". NEW UPDATED CIRCUIT DIRECTORIES SHALL ALSO BE PROVIDED.
- THE ELECTRICAL DEMOLITION PLANS INDICATE GENERAL INTENT AND ARE NOT INTENDED TO SHOW ALL COMPONENTS AND ITEMS TO BE REMOVED OR RETAINED. THE ELECTRICAL CONTRACTOR SHALL VISIT THE SITE PRIOR TO SUBMISSION OF THEIR BID TO BECOME FAMILIAR WITH THE ACTUAL WORKING CONDITIONS AND EXTENT OF WORK. DEVICES AND EQUIPMENT LOCATED ON WALLS AND/OR CEILING DESIGNATED TO BE REMOVED SHALL BE DISCONNECTED AND MADE SAFE. THE ELECTRICAL CONTRACTOR SHALL IMMEDIATELY NOTIFY THE OWNER'S REPRESENTATIVE AND ARCHITECT OF ANY UNANTICIPATED OR HIDDEN CONDITIONS ENCOUNTERED DURING DEMOLITION.
- THE ELECTRICAL CONTRACTOR SHALL CIRCUIT TRACE AND LABEL ALL EXISTING BRANCH CIRCUITS AND FEEDERS WITHIN OR ASSOCIATED WITH THE DEMOLITION SCOPE PRIOR TO DE-ENERGIZING AND DISCONNECTION. ALL CIRCUITS WITHIN PANELBOARDS, LOADCENTERS, MOTOR CONTROL CENTERS, AND SWITCHBOARDS IDENTIFIED FOR REMOVAL SHALL BE TRACED AND FIELD LABELLED TO ENSURE THAT NO AREA OUTSIDE THE DEMOLITION SCOPE LIMIT IS AFFECTED.
- IN ANY AREA REQUIRING THE PERFORMANCE OF ANY TRADE'S WORK, THE ELECTRICAL CONTRACTOR SHALL CAREFULLY REMOVE AND STORE ANY OR ALL ELECTRICAL ITEMS IN PATH OF WORK, REINSTALLING AND RECONNECTING SAME AS REQUIRED, IN ACCORDANCE WITH THE PLANS AND/OR AS DIRECTED AFTER COMPLETION OF OTHER TRADES WORK IN THAT AREA.

DRAWING NOTES:

- EXISTING ELECTRICAL EQUIPMENT TO REMAIN WITHIN THIS ROOM, UNLESS INDICATED OTHERWISE. PANEL AND CIRCUIT NUMBERS NOTED IN PARENTHESES ARE BASED ON AS BUILT DRAWINGS AND INDICATES CIRCUIT SERVING THIS AREA.
- ELECTRICAL CONTRACTOR SHALL TERMINATE AND MAKE SAFE EXISTING WIRING SERVING THE AREA FOR FUTURE USE WITHIN NEW CASEWORK. LABEL EACH WIRING WITH DESIGNATED PANEL AND CIRCUIT NUMBER. PANEL AND CIRCUIT NUMBERS NOTED IN PARENTHESES ARE BASED ON AS BUILT DRAWINGS AND ARE USED FOR REFERENCE ONLY. ANY CIRCUITS NOT UTILIZED FOR NEW WORK SHALL BE TAKEN BACK TO PANEL AND CIRCUIT BREAKER SHALL BE MARKED SPARE.
- ELECTRICAL CONTRACTOR SHALL TERMINATE AND MAKE SAFE EXISTING WIRING SERVING THE AREA ABOVE THE CEILING FOR FUTURE USE. LABEL EACH WIRING WITH DESIGNATED PANEL AND CIRCUIT NUMBER. PANEL AND CIRCUIT NUMBERS NOTED IN PARENTHESES ARE BASED ON AS BUILT DRAWINGS AND ARE USED FOR REFERENCE ONLY. ANY CIRCUITS NOT UTILIZED FOR NEW WORK SHALL BE TAKEN BACK TO PANEL AND CIRCUIT BREAKER SHALL BE MARKED SPARE.
- ELECTRICAL CONTRACTOR SHALL DETERMINE THE NUMBER OF CIRCUITS THAT WILL REMAIN ACTIVE AFTER THE DEMOLITION. THESE CIRCUITS WILL NEED TO BE EXTENDED TO THE NEW PANEL LOCATION INDICATED ON DWG E10B.B.
- EXISTING RADIOLOGY EQUIPMENT IS BEING RELOCATED FROM THIS ROOM TO NEW RADIOLOGY ROOM #2 LOCATED IN CHARLES STREET BUILDING. NEW RADIOLOGY ROOM LAYOUT SHALL MATCH EXISTING.
- REMOVE EXISTING FEEDER BACK TO PANEL INDICATED ON HOMERUN.
- REMOVE EXISTING PHYSIOLOGIC PHILIPS MEDICAL STRIP CHART RECORDER CABLE FROM THE SINGLE GANGED BACK BOX.
- REMOVE EXISTING PHYSIOLOGIC MONITOR RECORDER CABLE FROM THE SINGLE GANGED BACK BOX.

EQUIPMENT NOTES:

- UTILIZE AND MAINTAIN EXISTING CIRCUIT FOR HVAC TERMINAL BOXES. REMOVE AND MAKE SAFE ALL WIRING TO HVAC F.P. UNITS BEING REMOVED.
- UTILIZE AND MAINTAIN EXISTING CIRCUIT FOR RECONNECTION TO NEW AUTO DOOR CIRCUIT FOR RECONNECTION TO NEW AUTO DOOR. UTILIZE AND MAINTAIN EXISTING FIRE ALARM INTERFACE WIRING FOR RECONNECTION AT NEW LOCATION.
- UTILIZE EXISTING CIRCUIT FOR RELOCATED MEDICAL GAS ALARM PANEL.

MARK	ISSUE DATE	DESCRIPTION
BID	12/14/07	BID SET

Issue Log

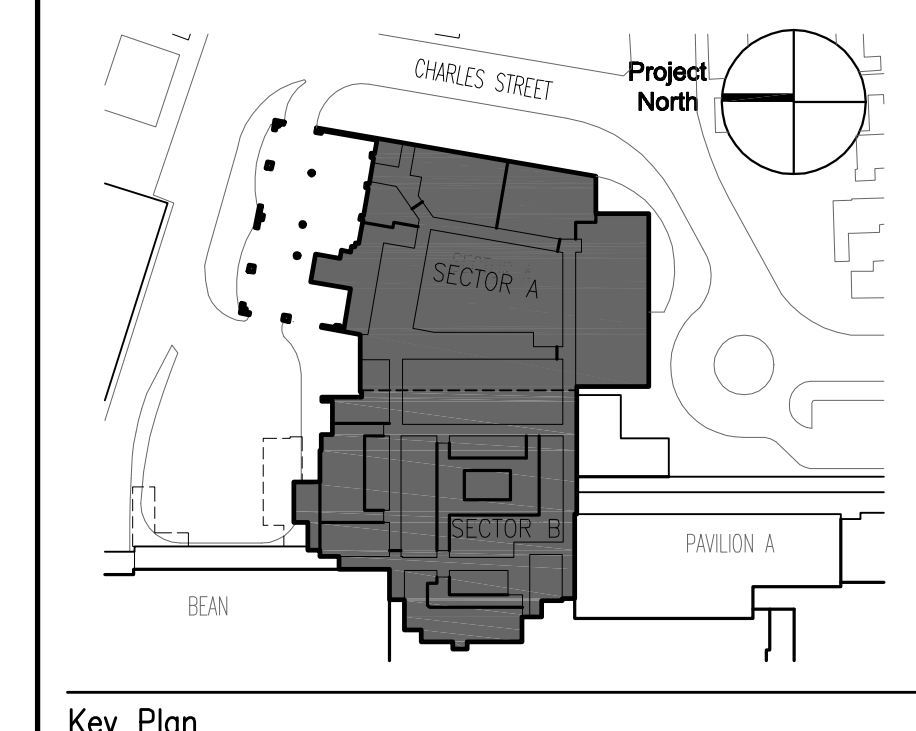

TRO Jung|Brannen
 ARCHITECTURE INTERIOR DESIGN ENGINEERING MASTER PLANNING
 22 Boston Wharf Road, Boston, Massachusetts 02210
 Tel 617.502.9400 Fax 617.502.3402 www.trojungbrannen.com

Maine Medical Center
 ED Expansion and Renovation
 Portland, Maine MMC Project No. 21843

Drawing Title
ELECTRICAL BASEMENT FLOOR POWER AND SIGNAL DEMO PLAN

Drawn By	A.B.	Commission No.	4696
Approved By	D.S.	Date Issued	12/14/07
Phase / Package Number	Sheet Number	E10B.B	

