

- General Notes:
- PROVIDE END PANELS WHERE CASEWORK DOES NOT ABUT WALL. -SEE DETAIL AX/AXXX
 - PROVIDE 1-1/2" (MIN.) FILLER PIECE ON WALL & BASE CABINETS AND 1-1/2" (MIN.) EXTENSION TO COUNTERTOP WHERE ENDS OF CASEWORK ABUT WALL.
 - FIELD VERIFY ALL DIMENSIONS PRIOR TO FABRICATION AND INSTALLATION.
 - PROVIDE 2-1/2" LIGHT VALANCE WHERE TASK LIGHTING IS INDICATED UNDER WALL CABINETS
 - WHERE VALANCES ARE PROVIDED, EXTEND SIDE PANELS OF WALL CABINET TO MATCH LIGHT VALANCE DIMENSION IF CABINET DOES NOT TERMINATE AT A WALL.
 - FILLER PIECE SCRIBED TO SOFFIT AND WALL (TYP) -SEE DETAIL AX/AXXX
 - CUSTOM CABINETS SHALL BE DESIGNATED AS FOLLOWS:
 - SEE ELECTRICAL DRAWINGS FOR ADDITIONAL LIGHT

SYMBOL LEGEND

□	HOOK	COMPONENTS ON EACH BOOM (4 TYP)
□	TV CONNECTION	1 - SURGICAL LIGHT
□	MONITOR CONNECTION	4 - VACUUM
□	LIGHT SWITCH	4 - OXYGEN
□	SURGICAL LIGHT SWITCH	4 - SLIDES
□	VACUUM	2 - MEDICAL AIR
□	OXYGEN	4 - RECEPTACLES (NORMAL)
□	MEDICAL AIR	6 - RECEPTACLES (EMER)
□	STAFF ASSIST/CODE	2 - TEL/DATA
□	BLUE DUPLEX - EMER	
□	DUPLEX - NORM	MONITOR ON BRACKET WITH POWER AND MONITOR CONNECTION
□	PATIENT STATION	
□	STAFF REG	
□	FIRE AUX MOD	
□	WALL PHONE	GLOVE BOX (S)
□	OTO/OPHTHALMOSCOPE	SHARPS CONTAINER

MARK	ISSUE DATE	DESCRIPTION

BID: 12/14/07 BID SET: Issue Log

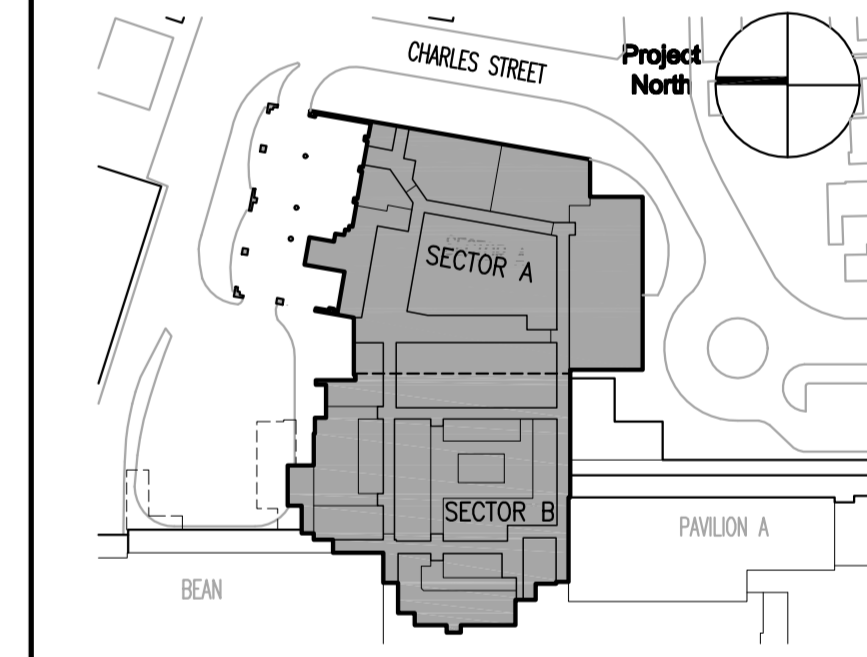

Key Plan

ARCHITECTURE INTERIOR DESIGN ENGINEERING MASTER PLANNING

22 Boston Wharf Road, Boston, Massachusetts 02210
Tel: 617.502.9400 Fax: 617.502.3402 www.trojngbrannen.com

Maine Medical Center

ED Expansion and Renovation

Portland, Maine MMC Project No. 21843

Drawing Title
INTERIOR ELEVATIONS
NO. 7

Drawn By: KFC	Commission No.: 4696
Approved By: AF	Date Issued: 12/14/07

Phase / Package Number	Sheet Number
	A707