

- NOTES:**
1. DETAILS SHOW DESIRED CONFIGURATION AND CONNECTION MATERIAL DETAILS TO BE INCORPORATED IN FABRICATOR'S DESIGN. FABRICATOR'S DESIGN AND DETAILING TO FOLLOW APPLICABLE STANDARDS, PROJECT PLANS AND SPECIFICATIONS, AND DESIGN FORCES INDICATED ON THE DRAWINGS.
  2. PROVIDE DECK SUPPORT ANGLES, SHIM PLATES, AND FILLER PLATES AS REQUIRED. THESE ITEMS ARE NOT SHOWN FOR CLARITY. ADD FITTED STIFFENERS OF 1/2" THICK SHIM BOTH SIDES OF COLUMN WHERE THERE ARE BRACES ON BOTH SIDES OF COLUMN AND THERE IS A TRANSFER FORCE BETWEEN THEM INDICATED ON THE DRAWINGS.
  3. BOLTS AT CONNECTION TO COLUMN: A325, MINIMUM DIAMETER = 1", SLIP CRITICAL ON OVERSIZE HOLES, UNCL.
  4. ADD STIFFENERS ON EACH SIDE OF GUSSET IF AND AS REQUIRED BY WHITMORE SECTION CALCULATIONS.
  5. RECONFIGURE CONNECTIONS TO COLUMN AS REQUIRED BY STIFFENERS.
  6. DO NOT ENCRATCH ON HINGE LINE WITH ANY CONNECTION MATERIAL.
  7. CONNECTIONS TO COLUMN WEBS HAVE SIMILAR CONFIGURATIONS. REINFORCE COLUMN WEB AS REQUIRED BY THE CONNECTION FORCES.
  8. GUSSET PLATES SHOWN WITH VERTICAL AND HORIZONTAL EDGES, ANGLED CUTS AT FABRICATOR'S DISCRETION.

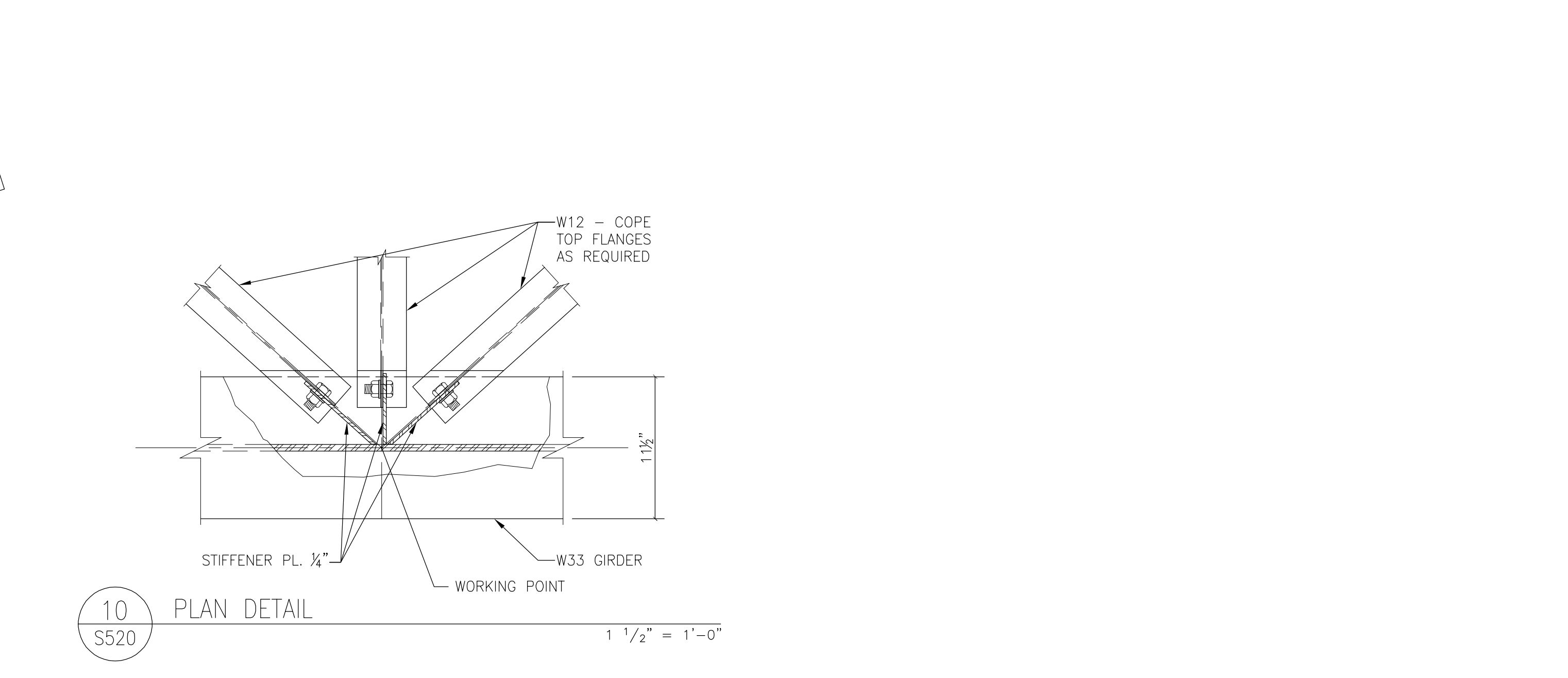
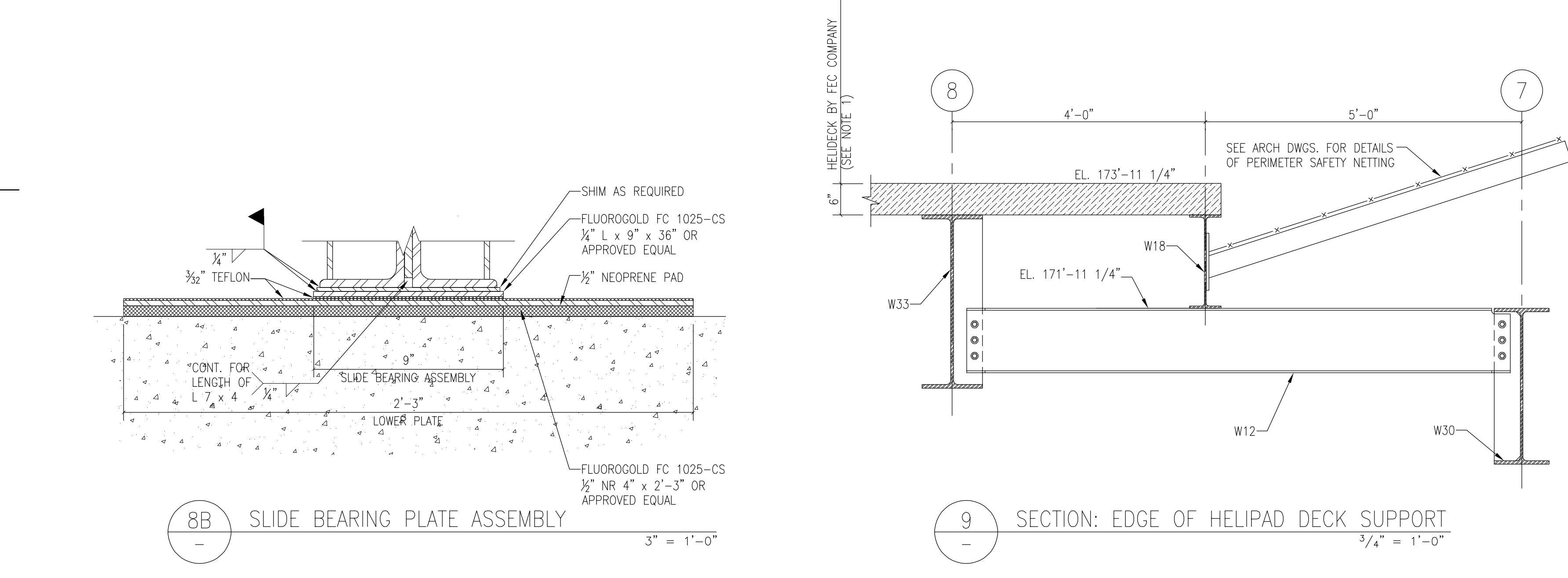
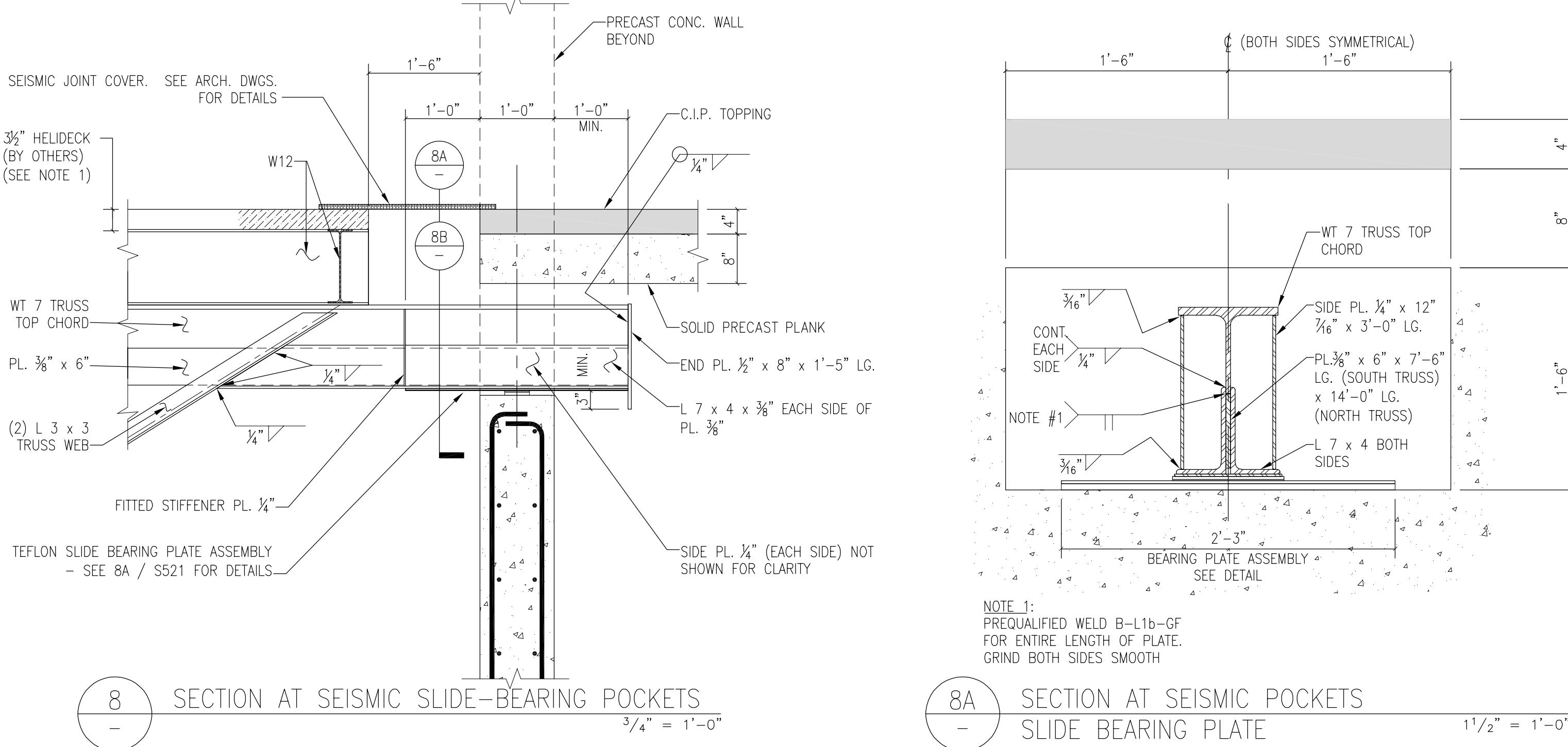
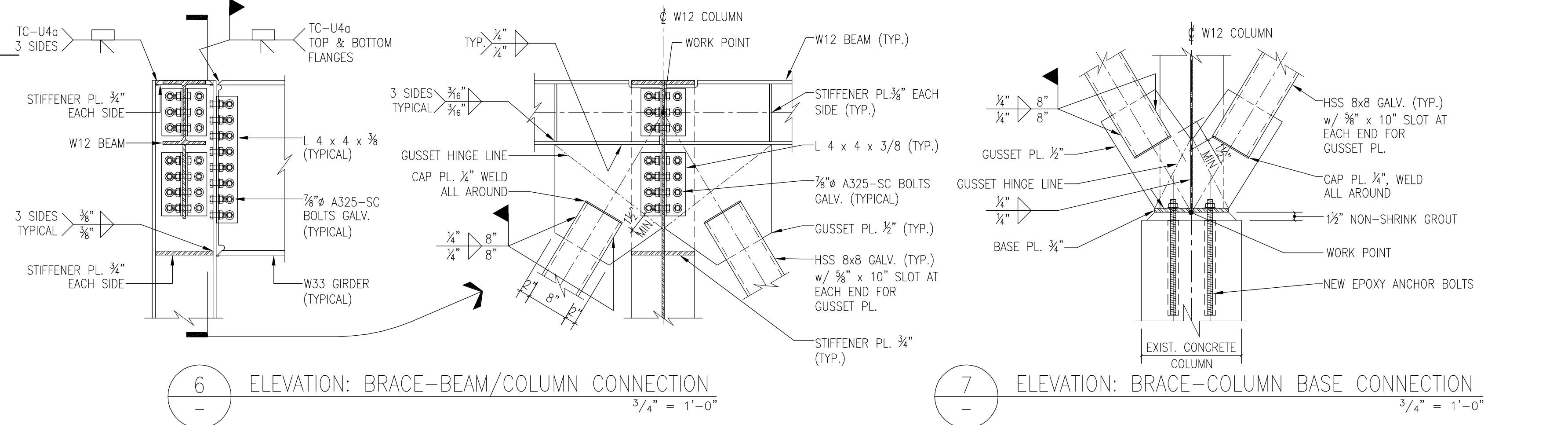

- General Notes:**
1. HELIDEX MANUFACTURED BY FEC COMPANY. STEEL FABRICATOR/DETAILER SHALL COORDINATE FINAL T.O.S. ELEVATIONS WITH HELIDEX MANUFACTURER'S SUGGESTED DETAILS.
  2. 3/16" FILLET WELD x 45° EACH SIDE TYPICAL OF CONNECTION UPPER CHORD - DIAGONAL SIMILAR ON SOUTH TRUSS EAST END.

**SGH**  
**Simpson Gumpertz & Heger Inc.**  
 Consulting Engineers

Boston, MA 41 Bayon Street, Suite 500, Telephone: (781) 907 9000, Facsimile: (781) 907 9009

San Francisco, CA The Landmark at One Market, Suite 600, Telephone: (415) 498 3700, San Francisco, CA 94105, Facsimile: (415) 498 3550

Washington, DC 1885 Pileard Drive, Suite 225, Telephone: (301) 417 0999, Rockville, MD 20850, Facsimile: (301) 417 9825

MARK	ISSUE DATE	DESCRIPTION
BD	08/26/04	BD SET

Issue Log

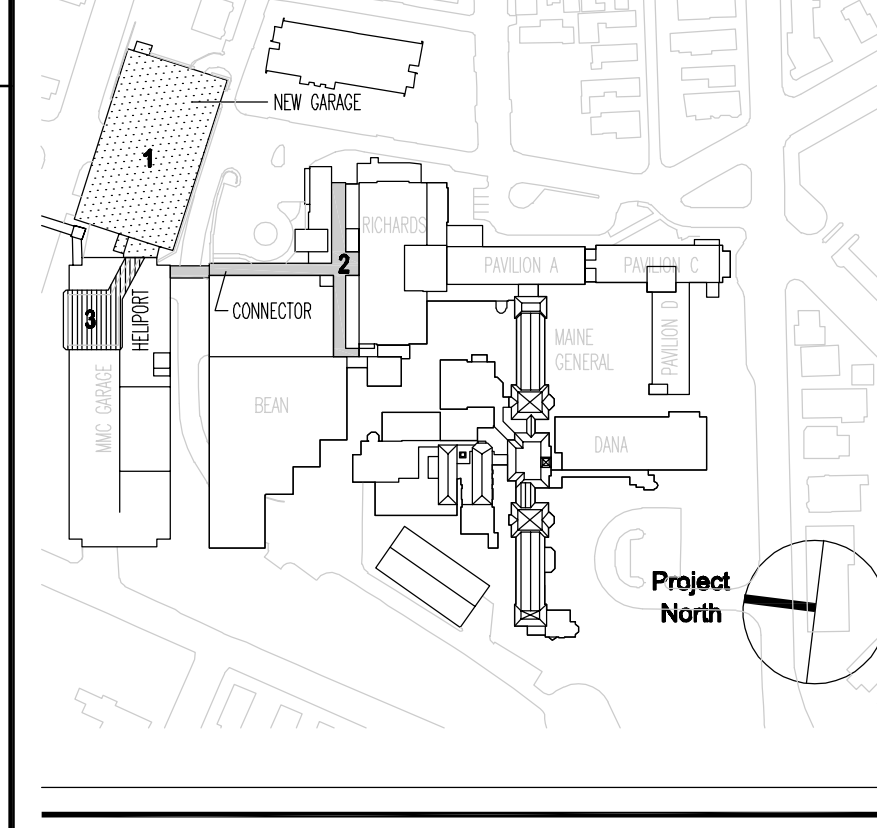

**TRO**  
 ARCHITECTURE  
 PLANNING  
 ENGINEERING  
 INTERIOR DESIGN

The Ritchie Organization  
 80 Bridge Street  
 Newton, MA 02458-1154  
 617-869-9400

**Maine Medical Center**  
 Pkg F - Garage / Vault / Conn / Helipad  
 Portland, ME MMC Project No. 21845

Drawing Title  
**HELIPAD SECTIONS & DETAILS (SHEET 1 OF 2)**

Commission No. 4678 Date Issued  
 Scale AS NOTED Sheet Number  
 Drawn By SWW  
 Approved By JHT/JJZ  
 Discipline S520

Copyright © 2004 The Ritchie Organization

**PKG-F S520**