

PIECE TYPE/SIZE	APPROX. QTY.	WALL OPENING	LINK BELL	SLAB/VE
SCALE	22'	36"	12'-000	MODEL NO. 12'-000
6" (10'000)	248'	36"	12'-000	MODEL NO. 12'-000
6" (10'000)	163'	24"	12'-000	MODEL NO. 12'-000
6" (10'000)	131'	36"	12'-000	MODEL NO. 12'-000
6" (10'000)	22'	36"	12'-000	MODEL NO. 12'-000
6" (10'000)	12'	36"	12'-000	MODEL NO. 12'-000
6" (10'000)	12'	36"	12'-000	MODEL NO. 12'-000
6" (10'000)	12'	36"	12'-000	MODEL NO. 12'-000
6" (10'000)	12'	36"	12'-000	MODEL NO. 12'-000

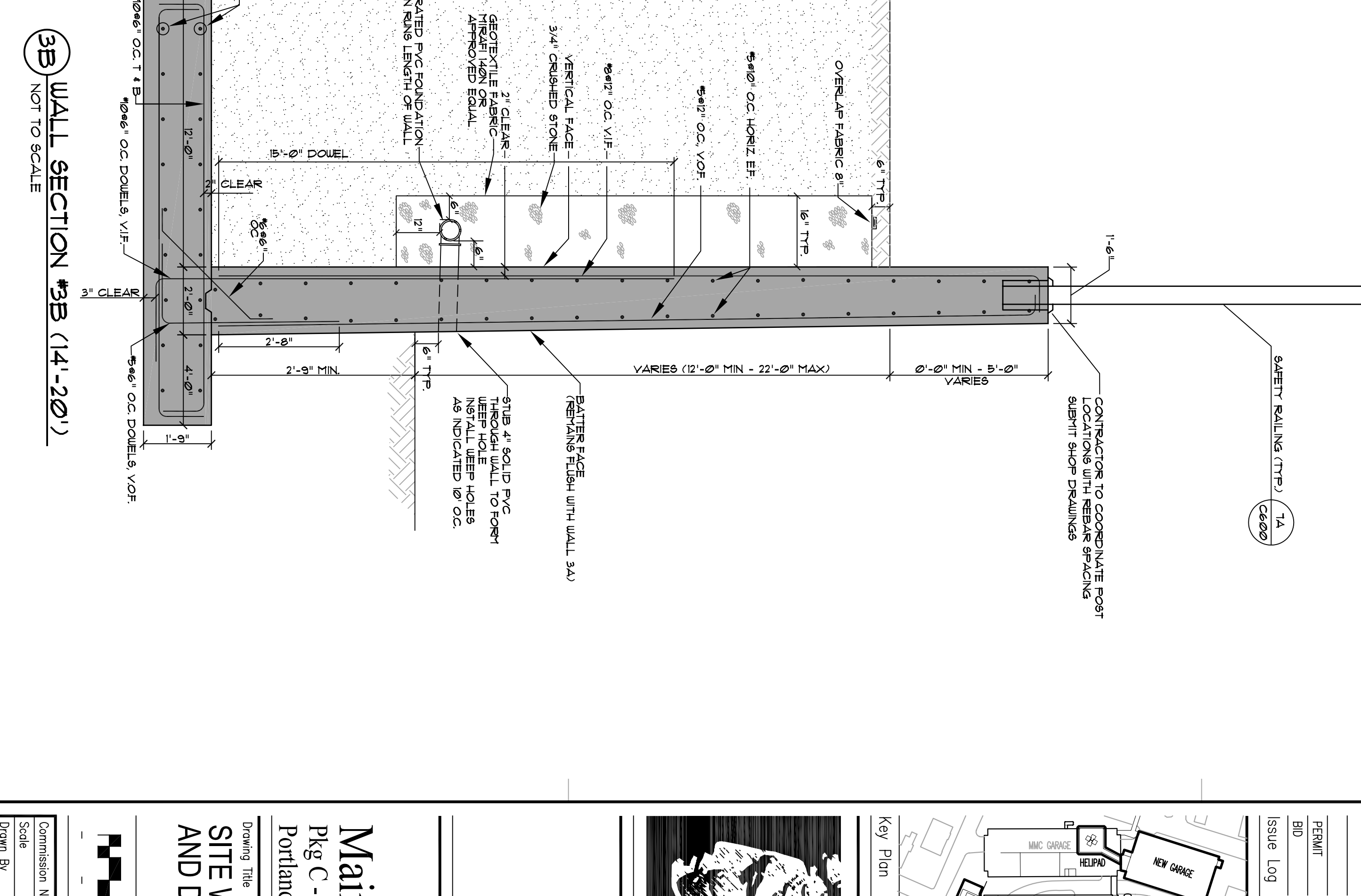

General Notes:
 1. SEE STRUCTURAL DRAWING FOR FOOTING AND WALL CONSTRUCTION DETAILS.
 2. CONCRETE SHALL BE CAST IN PLACE OR PRECAST WITH JOINTS DETAILING TO STRUCTURAL DRAWING.
 3. SHEET SHALL SHOW THE FACE OF THE FOUNDATION RETAINING WALL SHALL BE 1/4" PER FOOT.
 4. WALL SHALL BE CAST ON A ONE-SIDE FORM AND LEFT IN PLACE.
 5. WALL SHALL BE CAST ON A ONE-SIDE FORM AND LEFT IN PLACE.
 6. WALL SHALL BE CAST ON A ONE-SIDE FORM AND LEFT IN PLACE.
 7. WALL SHALL BE CAST ON A ONE-SIDE FORM AND LEFT IN PLACE.
 8. WALL SHALL BE CAST ON A ONE-SIDE FORM AND LEFT IN PLACE.
 9. WALL SHALL BE CAST ON A ONE-SIDE FORM AND LEFT IN PLACE.
 10. WALL SHALL BE CAST ON A ONE-SIDE FORM AND LEFT IN PLACE.

WORK	ISSUE DATE	DESCRIPTION
PERMIT	09/15/24	PERMIT SET
ISSUE	09/17/24	80 SET

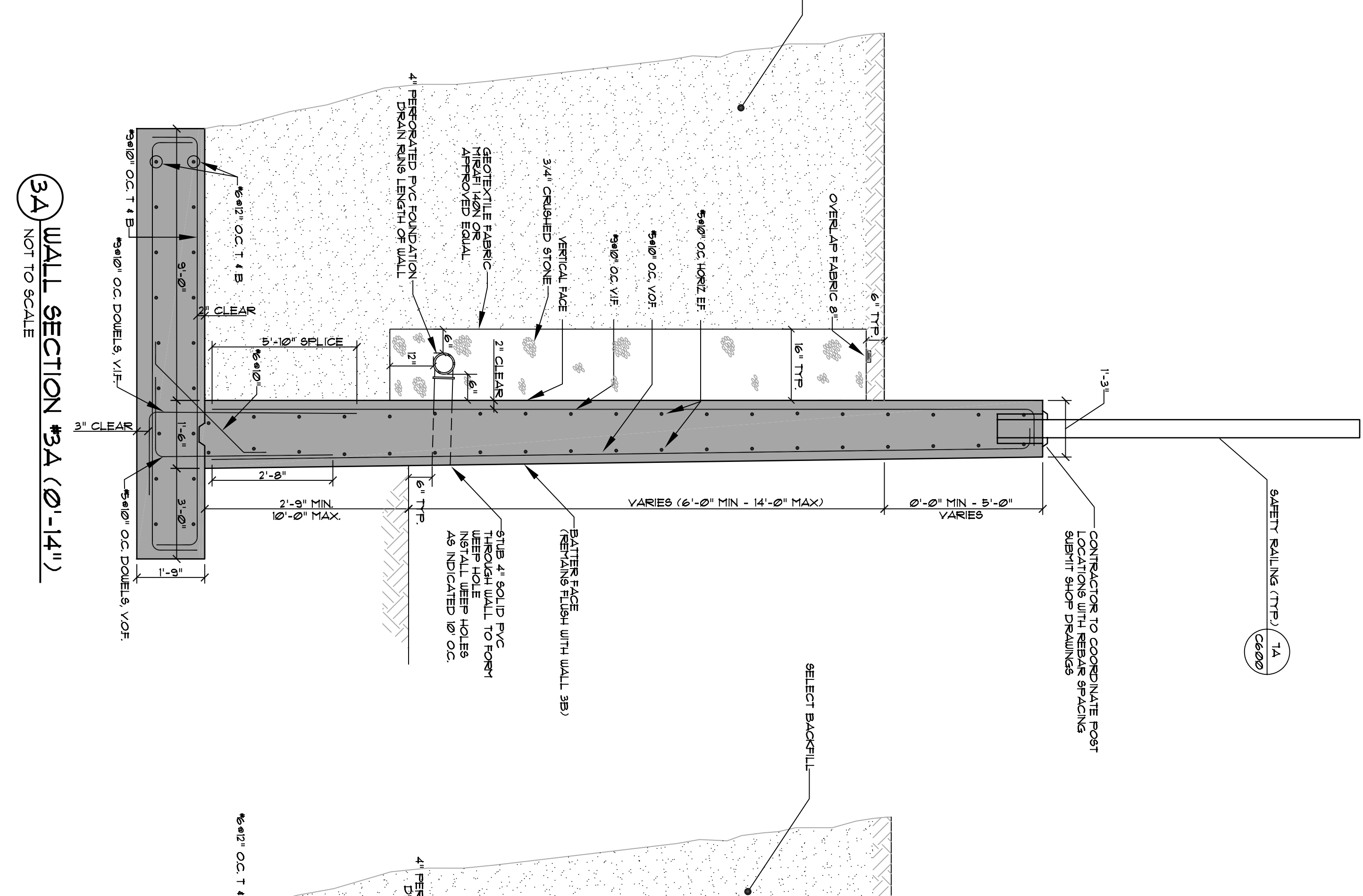
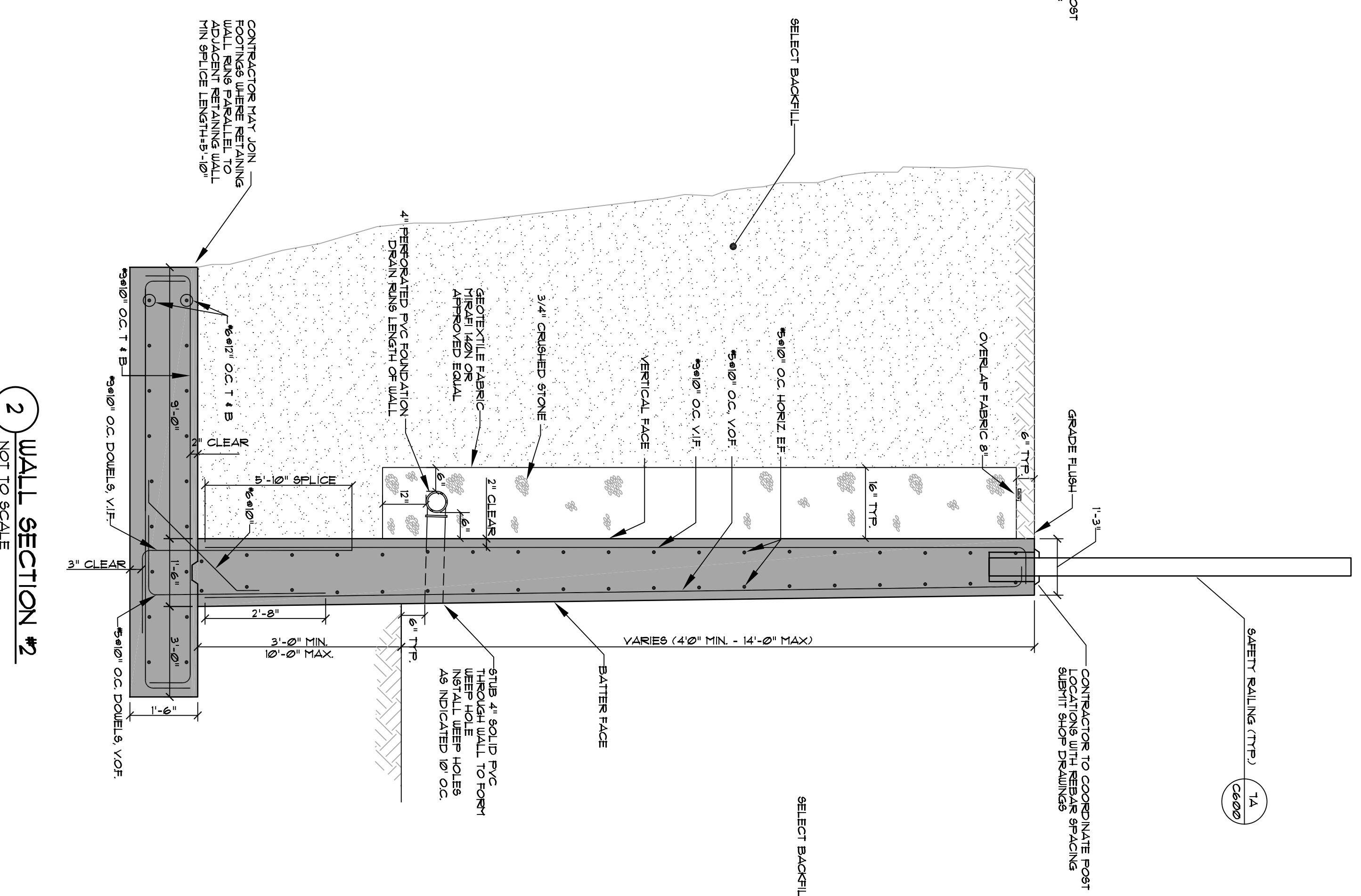
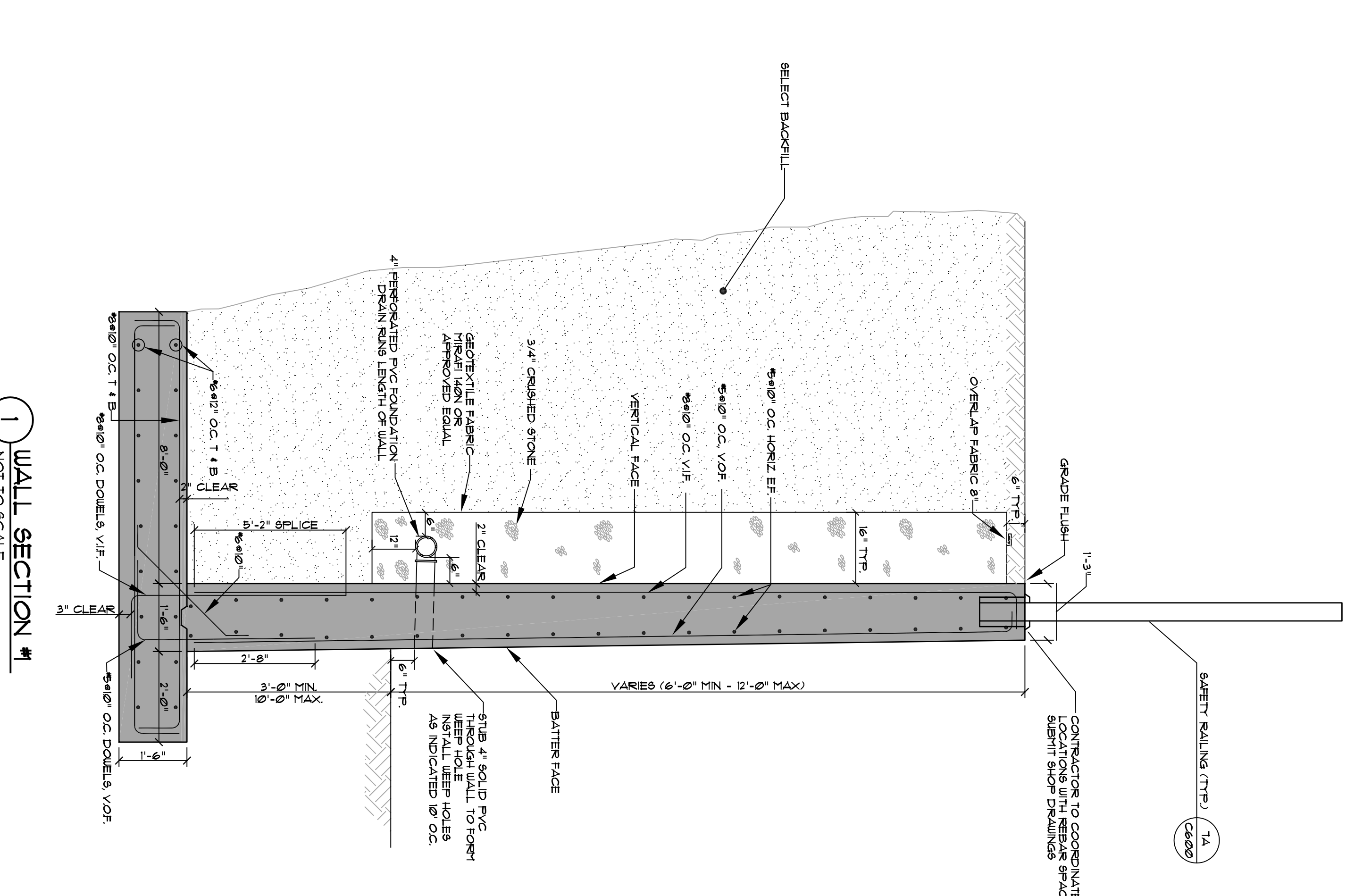
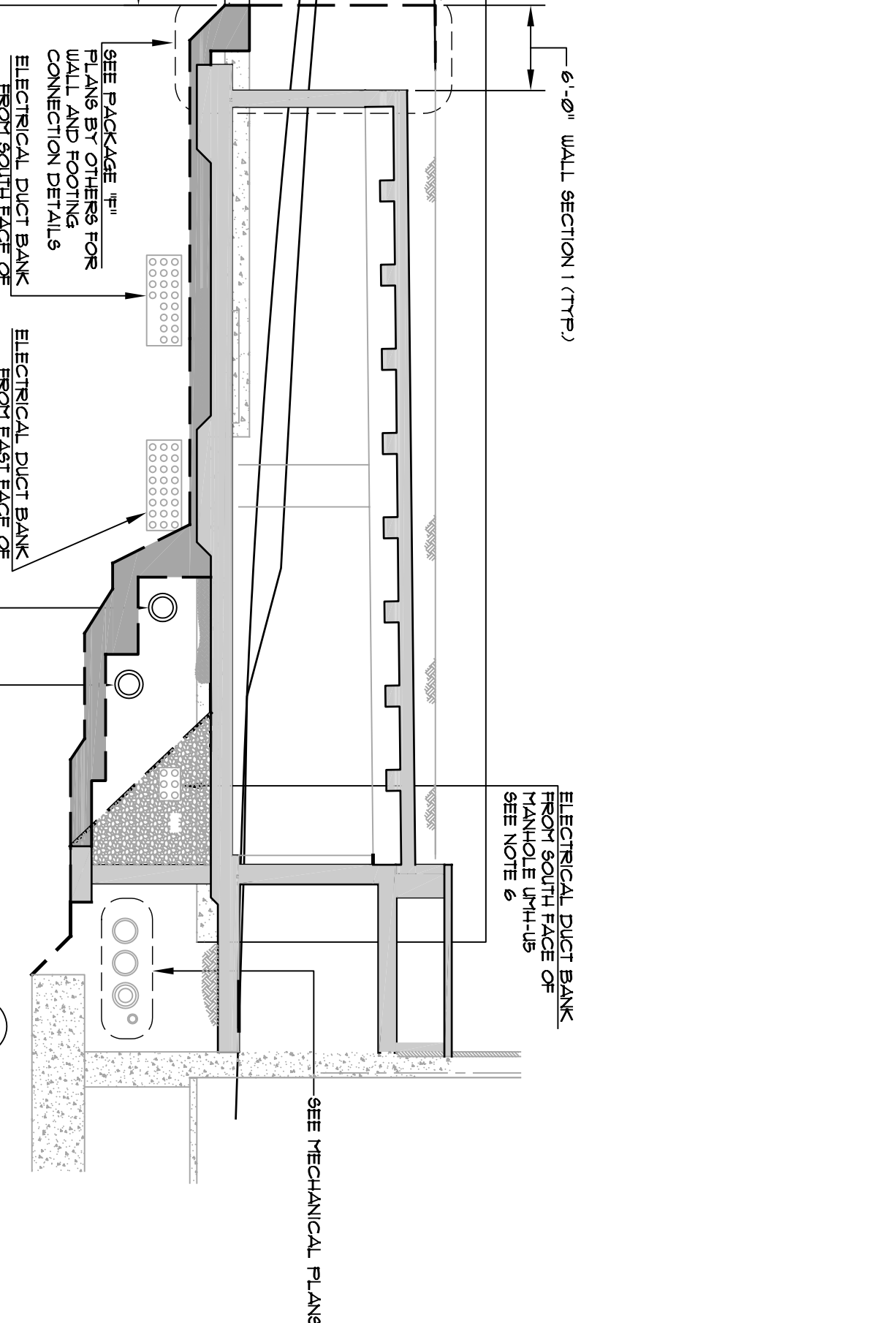
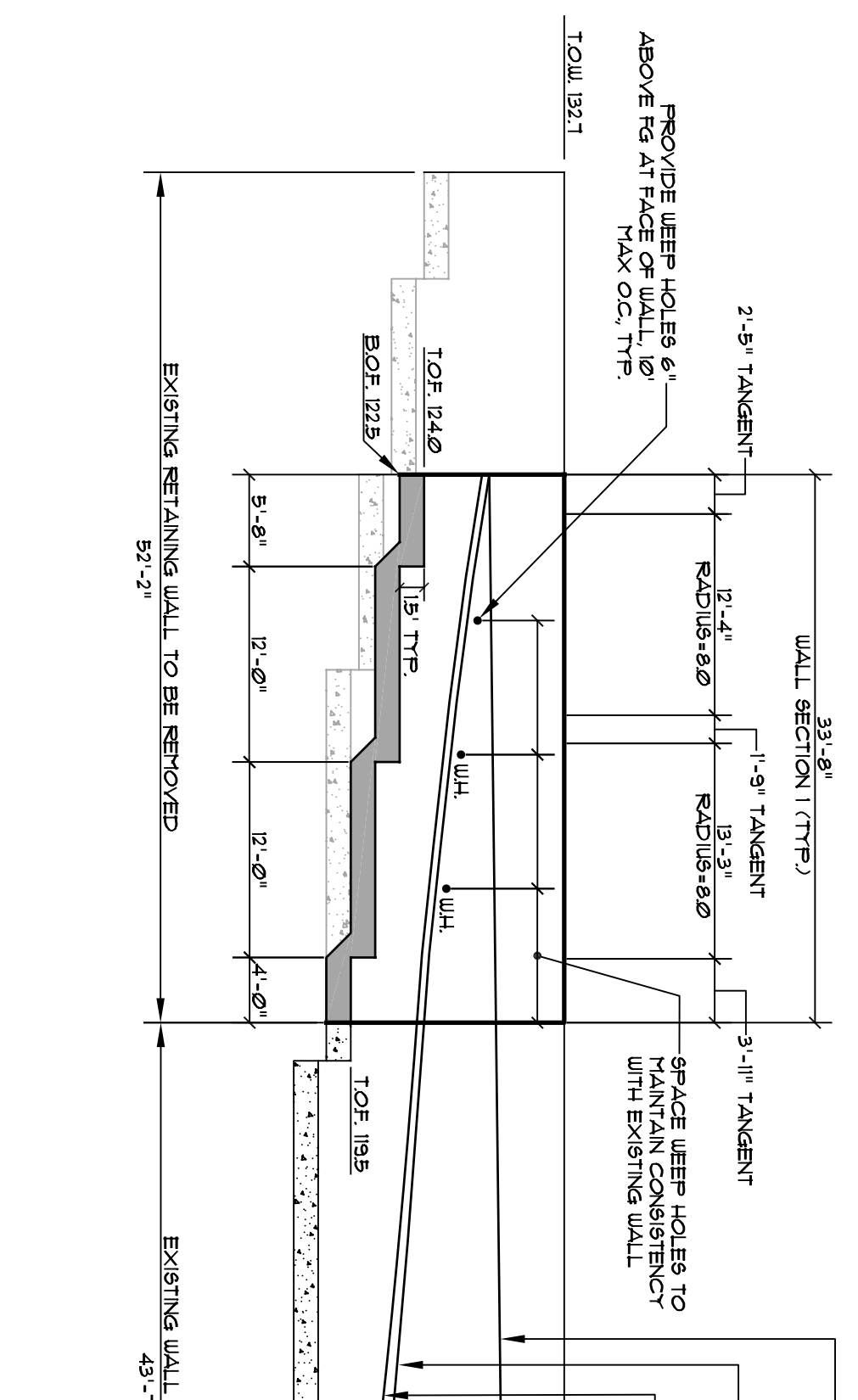
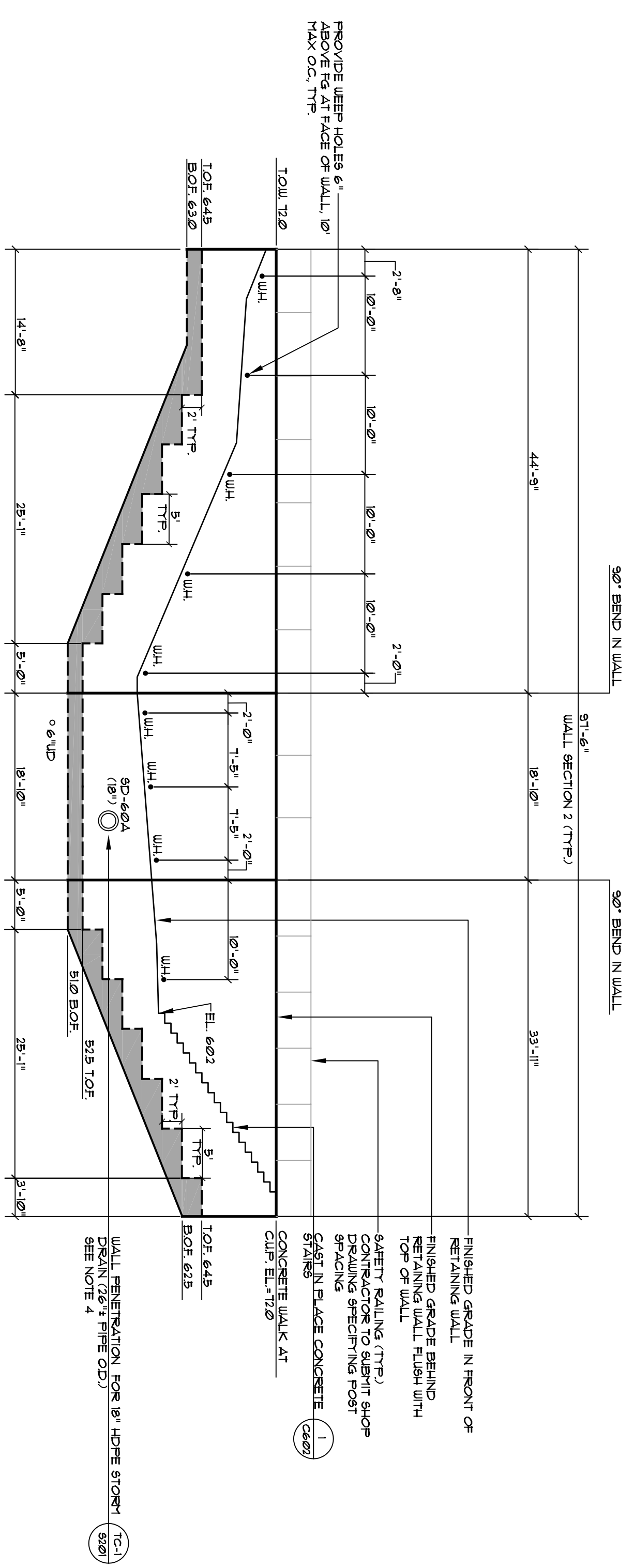

Maine Medical Center
 Pkg C - Site Utilities
 Portland, Maine MMC Project No. 21846

C605
 PK-C
 C605
 Scale: 1/4"=1'-0"