

NOTE
ALL UTILITY LINES AND STRUCTURES
SHOWN IN BOLD SHALL BE REMOVED,
UNLESS OTHERWISE SPECIFIED.

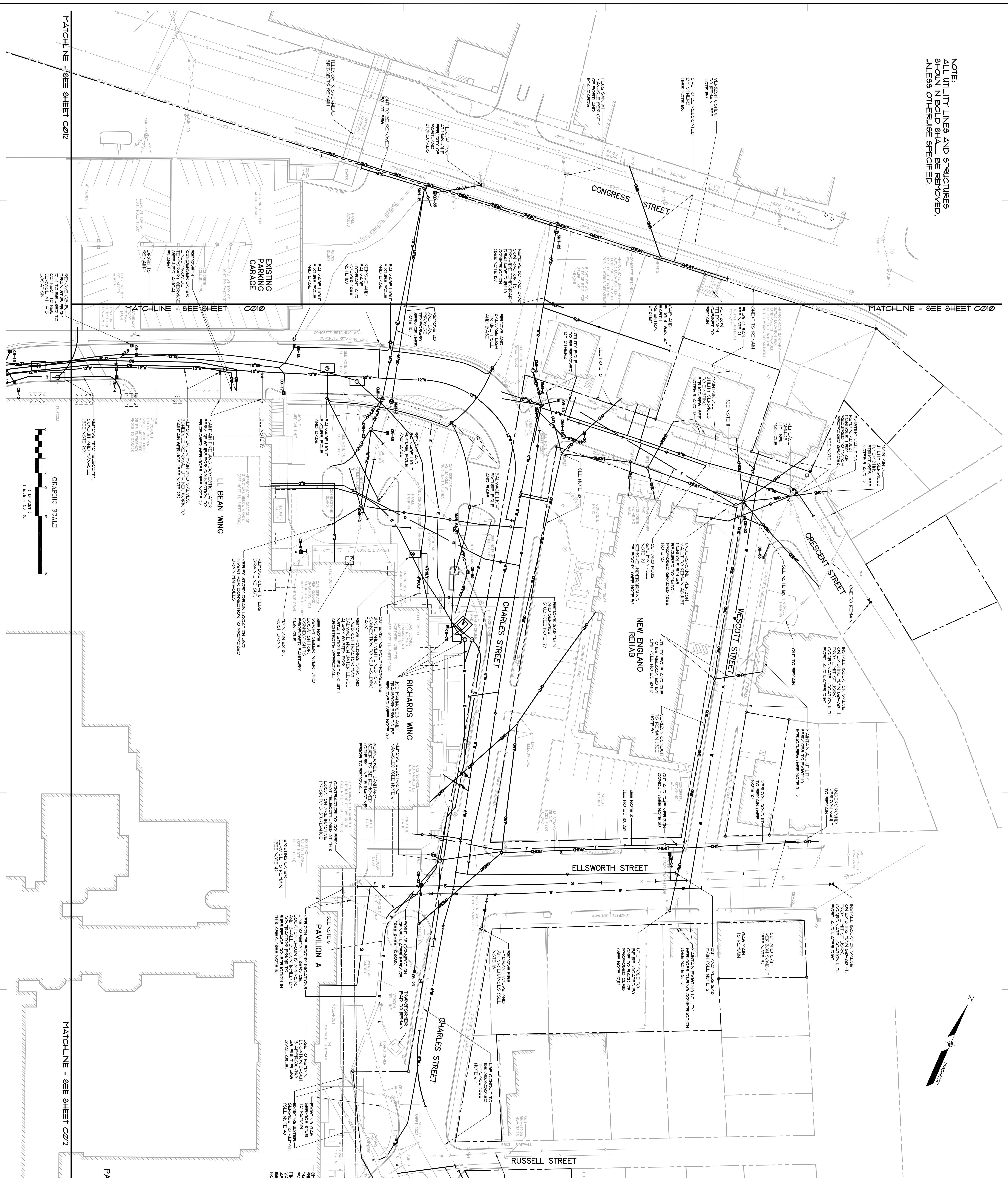

General Notes:

- The contractor is responsible for coordinating all site and utility work with the Maine Department of Transportation (MDOT) and the Maine Department of Environmental Protection (MEDEP).
- The contractor shall be responsible for obtaining all necessary permits from the City of Portland and the State of Maine.
- The contractor shall be responsible for the removal and disposal of all utility materials in accordance with applicable regulations.
- The contractor shall be responsible for the protection of existing utility lines and structures that are not to be removed.
- The contractor shall be responsible for the installation of all new utility lines and structures as required by the project.
- The contractor shall be responsible for the maintenance of all utility lines and structures during the construction period.
- The contractor shall be responsible for the safety of all workers and the public during the construction period.
- The contractor shall be responsible for the environmental protection of the site during the construction period.
- The contractor shall be responsible for the cleanup and restoration of the site after the completion of the project.
- The contractor shall be responsible for the final inspection and certification of the project.

Legend:

- Utility Line to be Removed
- Utility Line to be Relocated
- Utility Structure to be Removed
- Utility Structure to be Relocated
- Proposed Utility Line
- Proposed Utility Structure
- Proposed Utility Pole
- Proposed Utility Manhole
- Proposed Utility Vault
- Proposed Utility Chamber
- Proposed Utility Tunnel
- Proposed Utility Duct
- Proposed Utility Cable
- Proposed Utility Conduit
- Proposed Utility Pipe
- Proposed Utility Valve
- Proposed Utility Meter
- Proposed Utility Transformer
- Proposed Utility Substation
- Proposed Utility Station
- Proposed Utility Control Building
- Proposed Utility Control Room
- Proposed Utility Control Panel
- Proposed Utility Control Console
- Proposed Utility Control Console
- Proposed Utility Control Console

Scale: 1" = 20'

North Arrow: (Symbolic arrow pointing North)

Project Information:

Project Name: **Maine Medical Center**
 Site: **Pkg C - Site Utilities**
 Location: **Portland, Maine**
 Project No.: **MMC Project No. 21846**

TRQ ARCHITECTURE
 ARCHITECTURE
 INTERIOR DESIGN
 80 Bridge Street
 Portland, ME 04101
 Phone: 617-486-9400

Utility Demolition Plan

Sheet No.: **C011**

Scale: **1" = 20'**

Revision: **1**

Author: **TRQ**

Check: **TRQ**

Issue: **1**

Date: **02/17/24**

Project: **MMC Project No. 21846**

Sheet: **C011**

Scale: **1" = 20'**

Revision: **1**

Author: **TRQ**

Check: **TRQ**

Issue: **1**

Date: **02/17/24**

Project: **MMC Project No. 21846**

Sheet: **C011**