

**STAIRWAY 25  
INTERIM LIFE SAFETY PLAN**

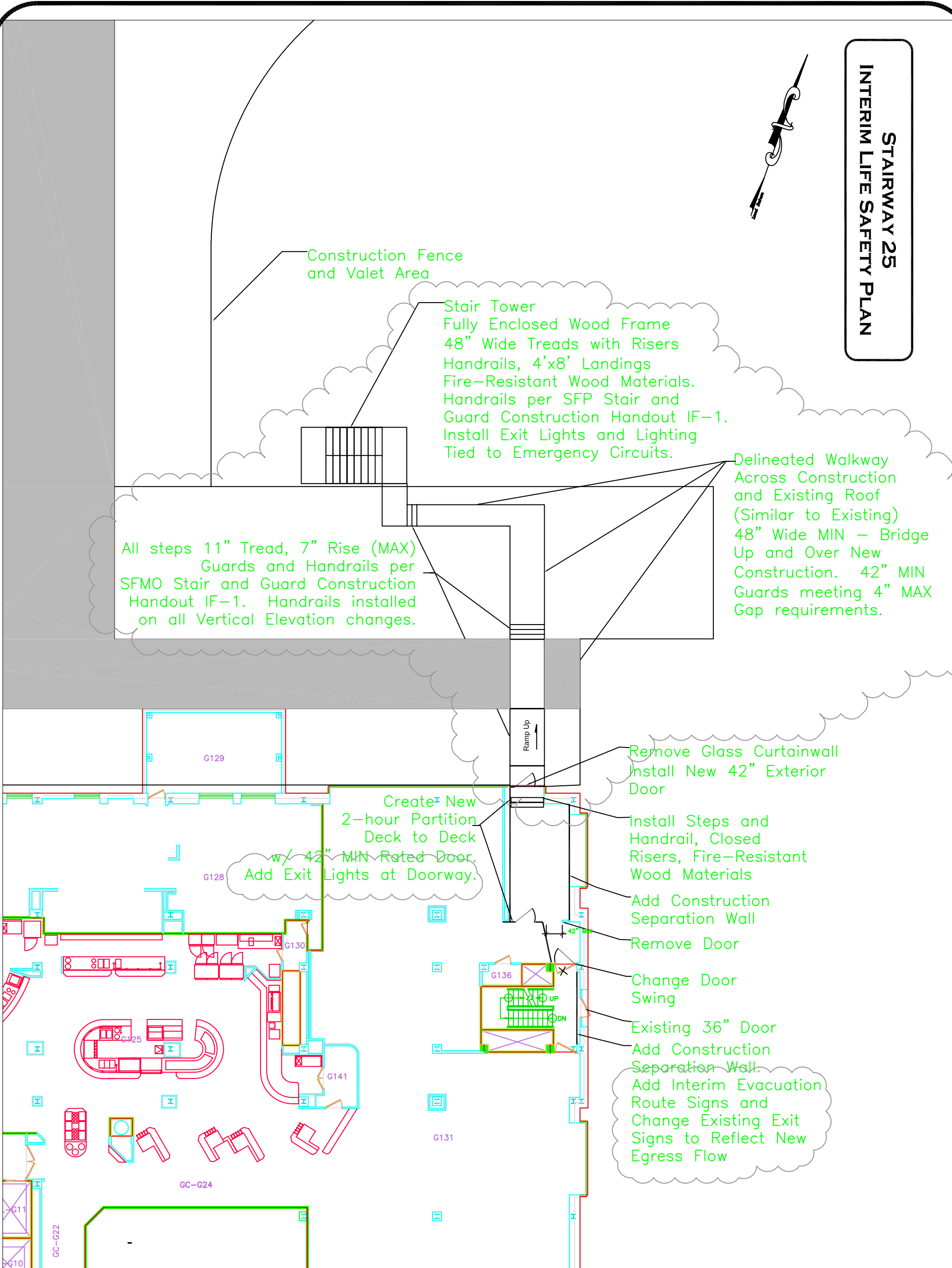
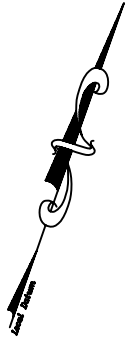

**General Notes**

- Notes:
1. Egress onto rooftop, similar to before.
  2. All wood materials to be fire-resistant with certification stamps.
  3. All Guard and Handrails to be constructed per State Fire Marshal's Handout - IF-1, Guard Construction - IF-1, received from Bob Cadigan on 9-12-2006.
  4. All changes due to inspection comments from Mike Collins, City of Portland, Jay Kelly, Portland FD, and Bob Cadigan, SFMO.

|     |  |         |
|-----|--|---------|
| No. | Revision/Issue                             | Date    |
| 2   | Per City, PFD, and SFMO Inspection 9-12-06 | 9/13/06 |
| 2   | Per MMC & SFMO Review                      | 7/12/08 |



**Maine Medical Center  
WOMEN AND INFANTS  
CENTER PROJECT  
PORTLAND, MAINE**

Drawn By: TWLP  
Date: 30 JUN 2006  
Scale: NTS

**ILSM**

**-1**