

NOTES:  
 1. SEE GENERAL NOTES ON GRIDZ.  
 2. FURNITURE DASHED IN BY OTHERS IS INDICATED FOR INFORMATION ONLY. FURNITURE NOT TO BE INSTALLED IN THIS CASEWORK, FURNITURE, EQUIPMENT AND ANY OTHER NIC ITEM.  
 3. PARTITION TYPE (S) IS TYPICAL UNLESS NOTED OTHERWISE.  
 4. REFER TO DETAILS FOR ADDITIONAL INFORMATION.

**WALL LEGEND**

(S) PARTITION TYPE SEE GRIDZ  
 (S) INDICATES 1-HOUR RATED PARTITION/ WALL  
 (S) INDICATES 2-HOUR RATED PARTITION/ WALL  
 (S) CORNER GUARD-1, S.S., 90 DEGREE  
 (S) CORNER GUARD-2, S.S., END WALL PROTECTOR  
 (S) GUARD RAIL-PATCH TO MATCH EXISTING ADJACENT  
 (S) WALL PROTECTION-UP TO 48" AFF.  
 (S) FIBER REINFORCED PANELS UP TO 48" AFF

**KEYED NOTES:**

(1) COORDINATE ELECTRICAL OUTLETS/DATA WITH FURNITURE LOCATIONS.  
 (2) ADD SLOPED TOP(DUST SHELF) TO EXISTING UPPER CABINETS  
 (3) WALL COVERING, MARKER BOARD/PROJECTION SCREEN  
 (4) PATCH/REPAIR EXISTING GUARD RAIL, MATCH/ALIGN WITH EXISTING ADJACENT.  
 (5) BINDS AND GRIDS STORAGE SYSTEM, OWNER PROVIDED, CONTRACTOR INSTALLED.  
 (6) PROVIDE NITROGEN GAS OUTLET.

**ACCESSORY SCHEDULE**

TAG	DESCRIPTION	QTY
(A)	SOAP DISPENSER	0/C
(B)	PAPER TOWEL DISPENSER	0/C
(C)	SHOWER CURTAIN ROD	0/D
(D)	MIRROR (TOILET ROOMS) 18" X 30"	0/C
(E)	TOILET TISSUE DISPENSER	0/C
(F)	38" GRAB BAR	0/C
(G)	42" GRAB BAR	0/C
(H)	ROBE/COAT HOOK (MOUNTED ON WALL)	0/C
(I)	GEL DISPENSER	0/C
(J)	8 BAY VIEW BOX	0/D
(K)	MIRROR (CHANGING ROOMS) 24" X 60"	0/C
(L)	WALL HUNG TV	0/C
(M)	WALL HUNG COMPUTER	0/C
(N)	SANITARY NAPKIN DISPOSAL UNIT	0/C
(O)	SCALE	0/O
(P)	GLOVE BOX	0/O
(Q)	MOP AND BROOM HOLDER	0/C
(R)	BINS AND GRID STORAGE, W/ PLYWOOD BACKER	0/C
(S)	LOCKERS	0/C
(T)	FOLDING BENCH	0/C
(U)	CONTRACTOR FURNISHED/CONTRACTOR INSTALLED	
(V)	OWNER FURNISHED/OWNER INSTALLED	
(W)	CONTRACTOR SHALL PROVIDE BLOCKING IN WALL	

ISSUED FOR CONSTRUCTION  
 9-12-08

SMRI  
 SURGICAL SERVICES  
 PORTLAND, MAINE

144 Fore Street, P.O. Box 618  
 Portland, Maine 04104  
 Tel: (207) 752-5846  
 Fax: (207) 752-5850  
 www.smri.com

ARCHITECTURE  
 ENGINEERING  
 PLANNING  
 INTERIOR DESIGN  
 COMMISSIONING

PROJECT MANAGER: CHRIS DAVID PIERCE  
 JOB CHAIRMAN: CHRIS DAVID PIERCE  
 A/E OF RECORD: CHRIS DAVID PIERCE  
 SHEET CAD FILE: AE101-08098  
 PROJECT No.: 08098

PARTIAL FLOOR PLAN  
 SHEET TITLE: PARTIAL FLOOR PLAN  
 SCALE: 1/4" = 1'-0"  
 DATE: 9-12-08

MAINE MEDICAL CENTER - LL BEAN WING 2ND FLOOR  
 PORTLAND, MAINE

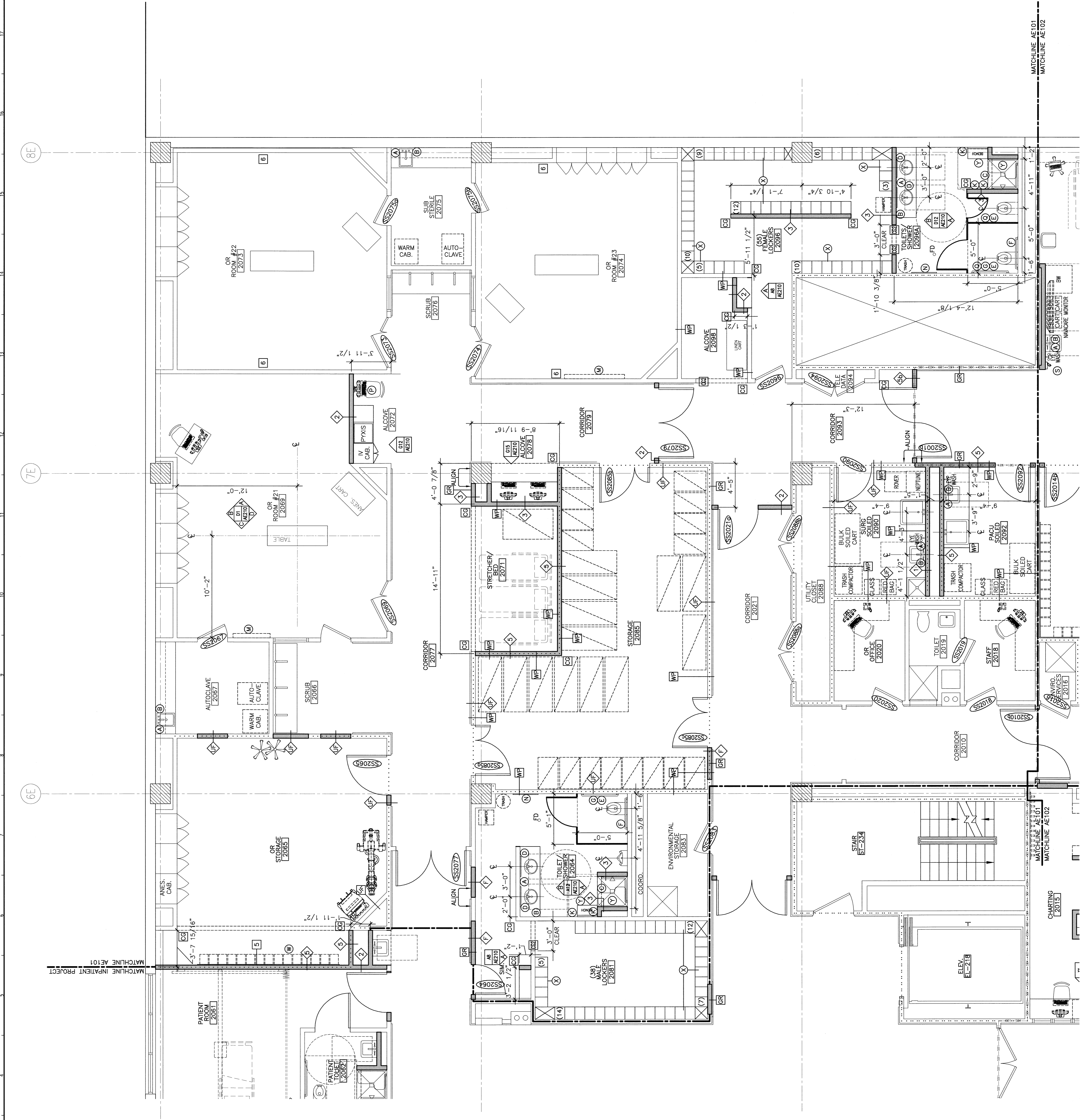

1/4" = 1'-0"  
 A1 PARTIAL FLOOR PLAN

PROJECT No.: 08098  
 SHEET No.: AE101