

**GENERAL DEMOLITION NOTES:**

- CONTACT ARCHITECT THROUGH RFI WITH QUESTIONS OF UNIDENTIFIED OBJECTS THAT WILL BE REQUIRED TO BE REMOVED.
- COORDINATE EXTENT OF DEMOLITION WITH LOCATIONS OF FINISHES NOTED AS EXISTING TO REMAIN.
- ANY WALL, PARTITION OR SURFACE DISTURBED BECAUSE OF NEW WORK OR DEMOLITION SHALL BE PATCHED AND FINISHED CONTIGUOUSLY TO THE NEAREST CORNER UNLESS NOTED OTHERWISE. FINISHES SHALL MATCH EXISTING FINISHES, CONTINUITY AND FIRE RATINGS UNLESS NOTED OTHERWISE.
- PROTECT ALL FINISHES, MATERIALS AND EQUIPMENT NOTED AS EXISTING TO REMAIN. CONTRACTOR SHALL BE RESPONSIBLE TO REPLACE ALL FINISHES, MATERIALS AND EQUIPMENT DAMAGED DURING CONSTRUCTION.
- CLEARLY IDENTIFY & TAG MECHANICAL PLUMBING/ELECTRICAL FEATURES OR EQUIPMENT THAT ARE STILL IN USE PRIOR TO DEMOLITION TO AVOID ACCIDENTAL REMOVAL.
- SEE MEP DRAWINGS FOR THE SCOPE OF DEMOLITION IN THOSE DISCIPLINES.
- FOR EXTENTS OF CEILING GRID REMOVALS AND ADJUSTMENTS REFER TO RELECTED CEILING PLANS.
- DIMENSIONS INDICATED ARE EXISTING CONDITION DIMENSIONS TO BE VERIFIED IN FIELD.

**DEMOLITION KEY NOTES:**

- REMOVE PARTITION COMPLETE.
- REMOVE EXISTING CASEWORK/LOCKERS COMPLETE.
- REMOVE DOOR, FRAME & HARDWARE COMPLETE AND CO-ORDINATE WITH OWNER THOSE ITEMS TO BE SALVAGED PRIOR TO REMOVAL.
- REMOVE PLUMBING FIXTURE, CAP FLUSH WITH EXISTING WALL FINISHES. REMOVE PLUMBING AND ELECTRICAL ITEMS TO BE SALVAGED PRIOR TO REMOVAL.
- REMOVE EXISTING FLOORING SYSTEM COMPLETE. PREPARE FOR NEW FLOORING SYSTEM.
- REMOVE PORTION OF PARTITION (INTERIOR OR EXTERIOR) FOR FINISHES TO REMAIN. REFERENCE DOOR SCHEDULE OR WINDOW ELEVATION.
- REMOVE EXISTING FIXTURE, REFERENCE MECHANICAL/ELECTRICAL.
- EXISTING CEILING SYSTEM TO BE REMOVED & REPLACED TO ALLOW MECHANICAL WORK TO BE PERFORMED.
- REMOVE EXISTING WALL FINISHES. REMOVE ALL EXISTING OTHER MATERIALS AND CLEAN AND PREPARE THE EXPOSED CMU WALL.
- REMOVE WOOD RUB RAILS, SALVAGE FOR REUSE.
- REMOVE FINISH FLOOR MATERIAL (IF ANY) & BASE. PREPARE SUBSTRATE FOR NEW FINISHES AS REQUIRED BY SCHEDULE & SPECS.
- REMOVE CEILING ASSEMBLY COMPLETE. COORDINATE EXTENTS OF REMOVAL WITH PARTITION LOCATIONS AND EXISTING FINISHES TO REMAIN.
- REMOVE CEILING MOUNTED CURTAIN TRACK & CURTAIN TRACKS WIRES ETC.
- REMOVE EXISTING WINDOWS COMPLETE. PREPARE FOR GWB INFILL.
- REMOVE EXISTING CEILING LIGHTS, DIFFUSERS & ANY OTHER EQUIPMENT. COORDINATE WITH OWNER THOSE ITEMS TO BE SALVAGED.

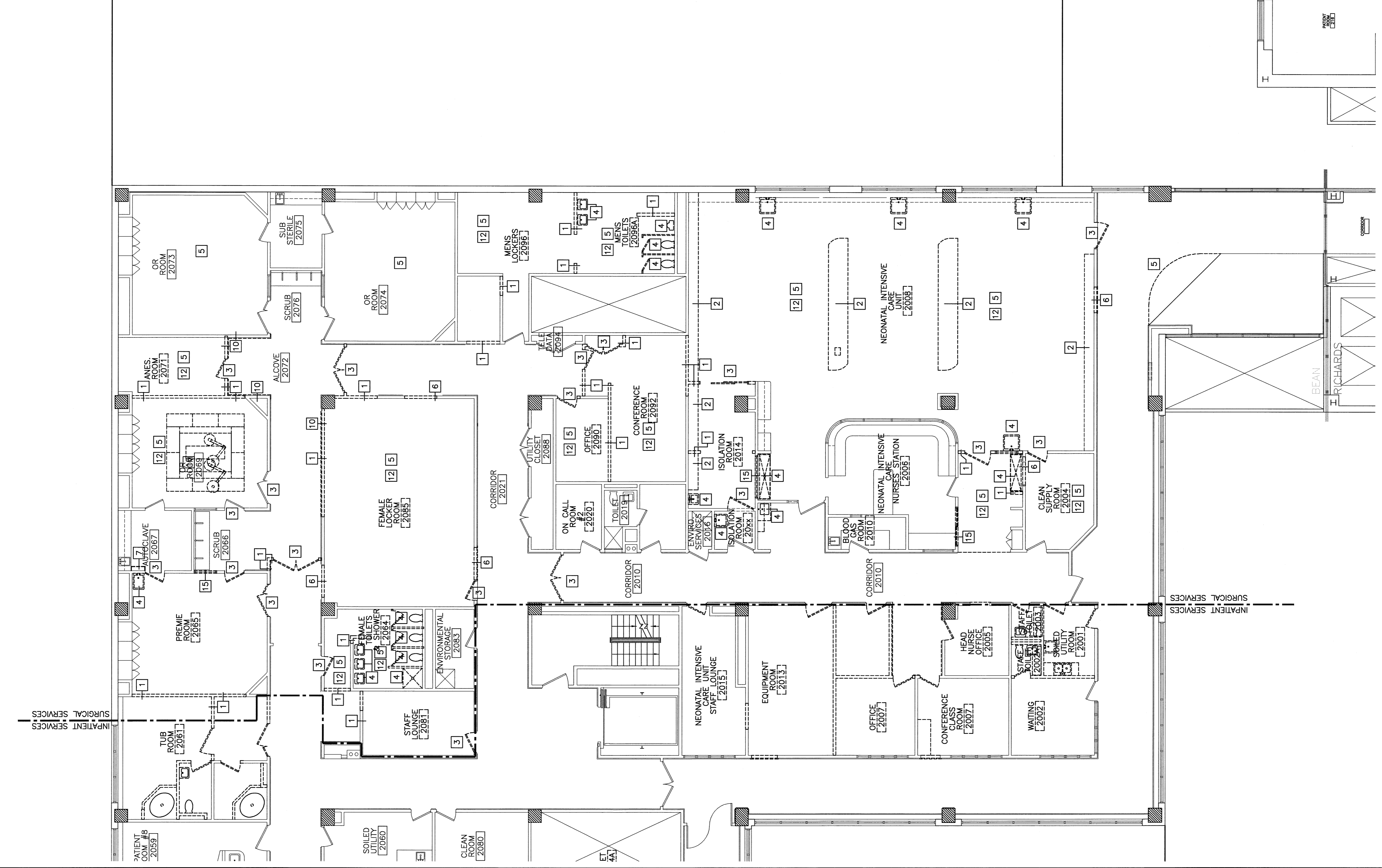

REV.	ISSUED FOR CONSTRUCTION	DATE
0		9-12-08

**ISSUED FOR CONSTRUCTION**  
9-12-08

CURRENT ISSUE STATUS:

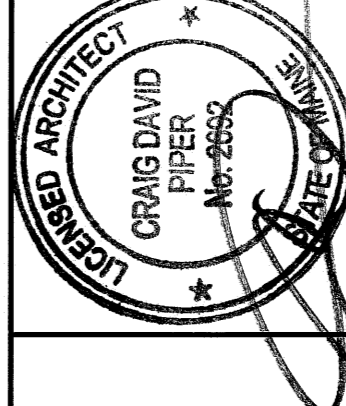

144 Fore Street, P.O. Box 618  
Portland, Maine 04104  
Tel: (207) 773-3646  
Fax: (207) 772-8070  
www.smrpi.com

**SMRPI**  
ARCHITECTURE  
ENGINEERING  
PLANNING  
INTERIOR DESIGN  
COMMISSIONING

**MAINE MEDICAL CENTER - LL BEAN WING 2ND FLOOR**  
SURGICAL SERVICES  
PORTLAND, MAINE

**DEMOLITION PLAN**  
SHEET TITLE  
SCALE: 1/8" = 1'-0"  
DATE: 9-12-08  
PROJECT MANAGER: CDP GRAPHIC SCALE: 0' 1'

DR: CAP/IR/MAW  
NMR  
DATE OF RECORD: CDP  
SHEET No.: AD101  
SHEET CAD FILE: AD101-08098  
PROJECT No.: 08098

**A9 DEMOLITION PLAN**

1/8" = 1'-0"

**A1 \***