

**NOTE:**

- SEE SHEET E-001 FOR LEGEND AND GENERAL NOTES.
- ALL DEVICES AND EQUIPMENT ASSOCIATED WITH THE EXISTING INFANT ABDUCTION SYSTEM SHALL BE REMOVED COMPLETE. ALL EXISTING WIRING, RACEWAY, DEVICES, AND CONDUIT SHALL BE REMOVED FROM ALL WALLS AND FLOOR LOCATIONS WITH MMC STAFF PRIOR TO REMOVAL.
- ALL CORRIDOR LIGHTING FIXTURES INDICATED SHALL BE REMOVED AND REPLACED. ALL EXISTING LIGHTING BRANCH CIRCUITING AND CIRCUITING MAINTAINED FOR CONNECTION TO NEW FIXTURES AS INDICATED ON E101.

**KEYED NOTE:**

- REMOVE ALL LIGHTING, POWER, AND SYSTEMS DEVICES WITHIN THE SPACE IMPACTED BY ARCHITECTURAL DEMOLITION. ALL DEVICES IN WALLS TO BE REMOVED SHALL BE REMOVED WITH THE WALL. ALL REMOVED LIGHT FIXTURES SHALL BE REUSED OR DISPOSED OF AS DIRECTED BY OWNER.
- EXISTING 1"x4", 2-LAMP LENSED TROFFER TO BE REMOVED AND REINSTALLED AS INDICATED ON LIGHTING PLANS OR DISPOSED OF AS DIRECTED BY OWNER.
- EXISTING 2"x4", 3-LAMP PARABOLIC FIXTURE TO BE REMOVED AND REINSTALLED AS INDICATED ON LIGHTING PLANS OR DISPOSED OF AS DIRECTED BY OWNER.
- EXIT SIGNAGE TO BE REMOVED AND REINSTALLED AS INDICATED ON LIGHTING PLANS.
- EXISTING CORRIDOR LIGHT SWITCH TO BE REMOVED AND REINSTALLED AS INDICATED ON LIGHTING PLANS.
- EXISTING PUBLIC ADDRESS SYSTEM SPEAKER TO BE REMOVED AND REINSTALLED BY OWNER AS INDICATED ON SYSTEMS PLANS.
- EXISTING FIRE ALARM SYSTEM DEVICE TO BE REMOVED AND REINSTALLED AS INDICATED ON SYSTEMS PLANS.
- EXISTING NURSE CALL SYSTEM DEVICE TO BE REMOVED AND REINSTALLED BY OWNER AS INDICATED ON SYSTEMS PLANS.

REV.	ISSUED FOR CONSTRUCTION DESCRIPTION	DATE
0		9-12-08

**ISSUED FOR CONSTRUCTION**  
9-12-08

CURRENT ISSUE STATUS:



144 Four Street PO Box 618  
Portland, Maine 04104  
Tel: (207) 772-3846  
Fax: (207) 772-0070  
www.smrti.com

**SMRTI**  
ARCHITECTURE  
ENGINEERING  
PLANNING  
INTERIOR DESIGN  
COMMISSIONING

**MAINE MEDICAL CENTER - RICHARDS WING 2ND FLOOR**  
INPATIENT SERVICES  
PORTLAND, MAINE

**ELECTICAL DEMOLITION PLAN**

SHEET TITLE:	DATE:	9-12-08
SCALE:	GRAPHIC SCALE:	0'
PROJECT MANAGER:	CDP:	TR
DESIGNER:	TR:	
DATE OF RECORD:	REV:	
PROJECT NO.:	SMRTI CAD FILE:	E101-08103
	SHEET NO.:	ED101

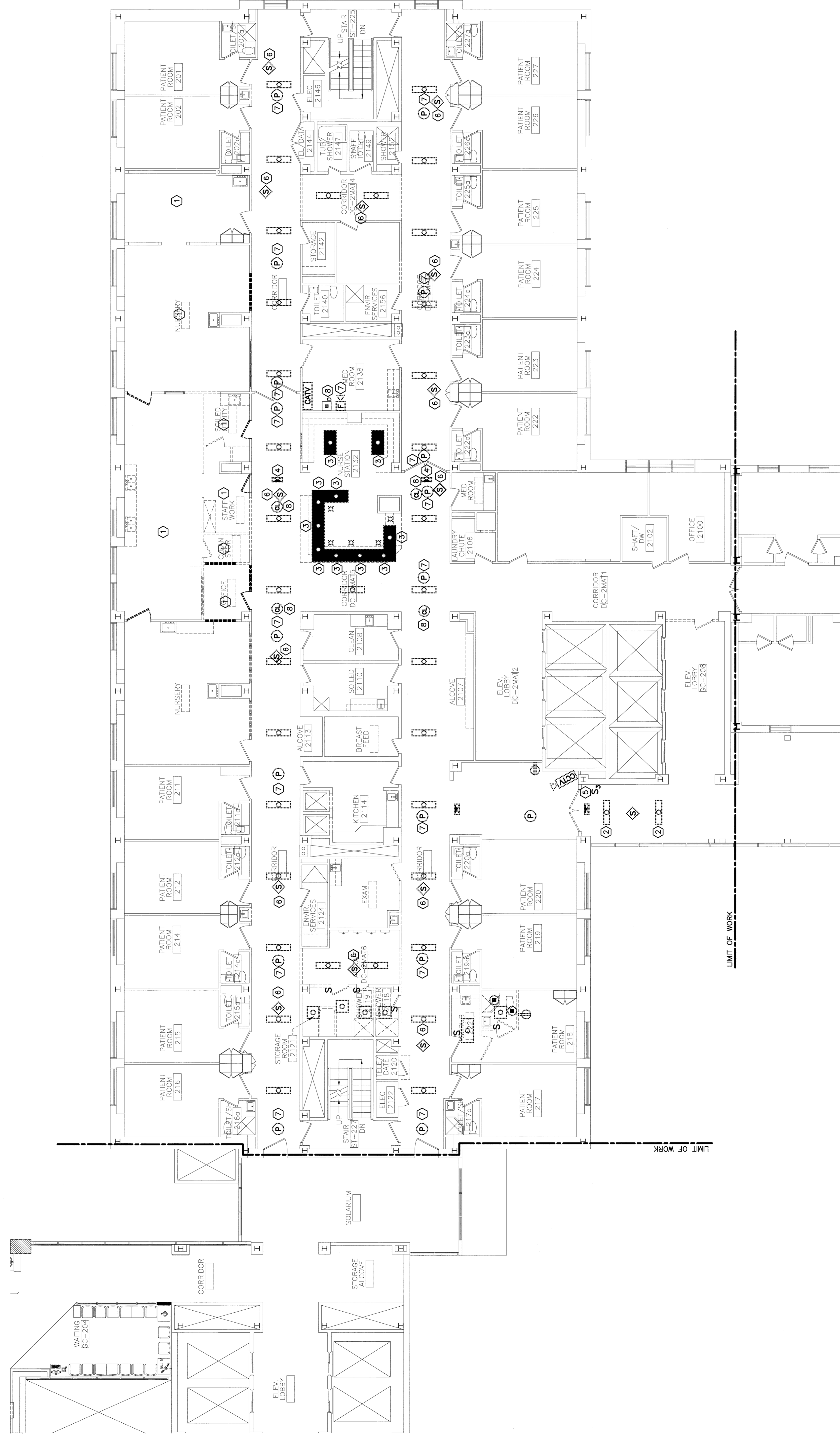

A1 DEMOLITION PLAN

1/8"=1'-0"

08103