

CLIENT

Maine Medical Center
MaineHealth

22 Bramhall Street
Portland ME 04102

CONSULTANTS

CIVIL/LANDSCAPE ARCHITECT
Sebago Technics
75 John Roberts Road, Suite 1A,
South Portland, ME 04106

STRUCTURAL/ENR/BUILDING ENVELOPE CONSULTANT
Simpson Gumpertz & Heger Inc.
41 Stuyvesant Street, 1, Suite 500,
Waltham MA 02453

MEPP ENGINEER/ENGINEER CODE
AKF Group LLC
99 Bedford Street, 2nd Floor, Boston, MA 02111

CONSTRUCTION MANAGER
Turner Construction
2 Seaport Lane, Suite 200, Boston MA 02210

ELEVATOR CONSULTANT
VDA (Van Deusen & Associates)
101 Summer Street, 4th Floor, Boston MA
02110

COST ESTIMATOR
D. G. Jones International
3 Baldwin Green Common, Suite 202, Woburn MA 01801

PROJECT TITLE

**Visitor Garage
Expansion**
22 Bramhall Street
Portland ME 04102

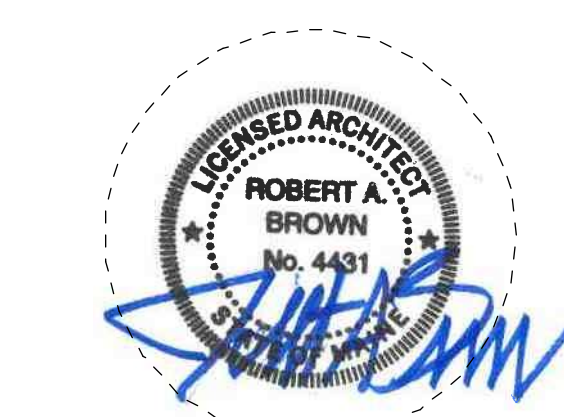

KEY PLANS

PROJECT KEY PLAN

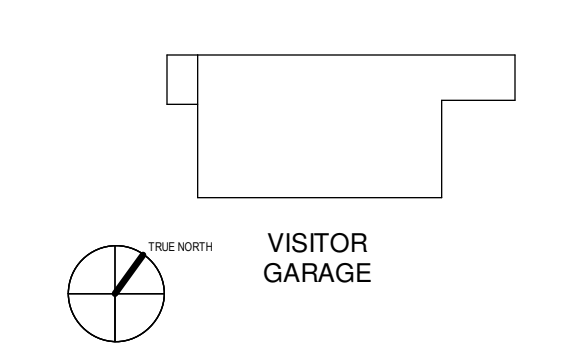

OVERALL KEY PLAN

- 1 - NOT USED
- 2 - CONGRESS STREET
- 3 - VISITOR GARAGE
- 4 - EAST TOWER
- 5 - CENTRAL UTILITY PLANT
- 6 - BEAN BUILDING
- 7 - RICHARDS BUILDING
- 8 - MAINE GENERAL BUILDING

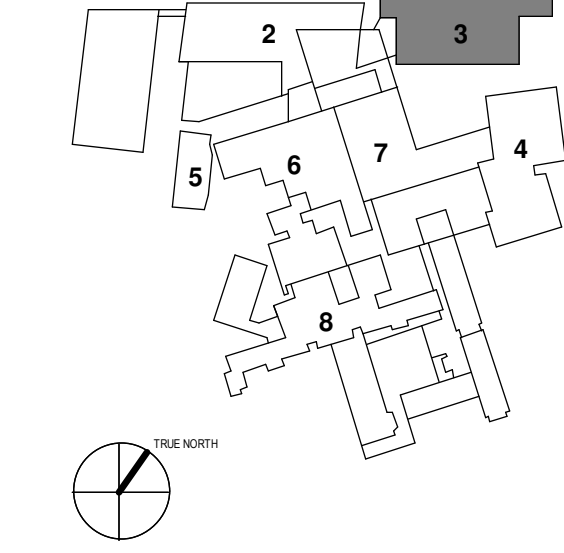

CONSTRUCTION DOCUMENT SET
SEPTEMBER 29, 2017

NO	ISSUE	DATE
PERMIT SET		03.29.16
PERMIT SET		03.09.16
Job Number	152182.000	
Drawn	TEAM	
Checked	DS/RIS	
Approved	JK	

TITLE

**ARCHITECTURAL
SITE PLAN**

SHEET NUMBER

A01-01

Copyright 2017 @ Perkins + Will

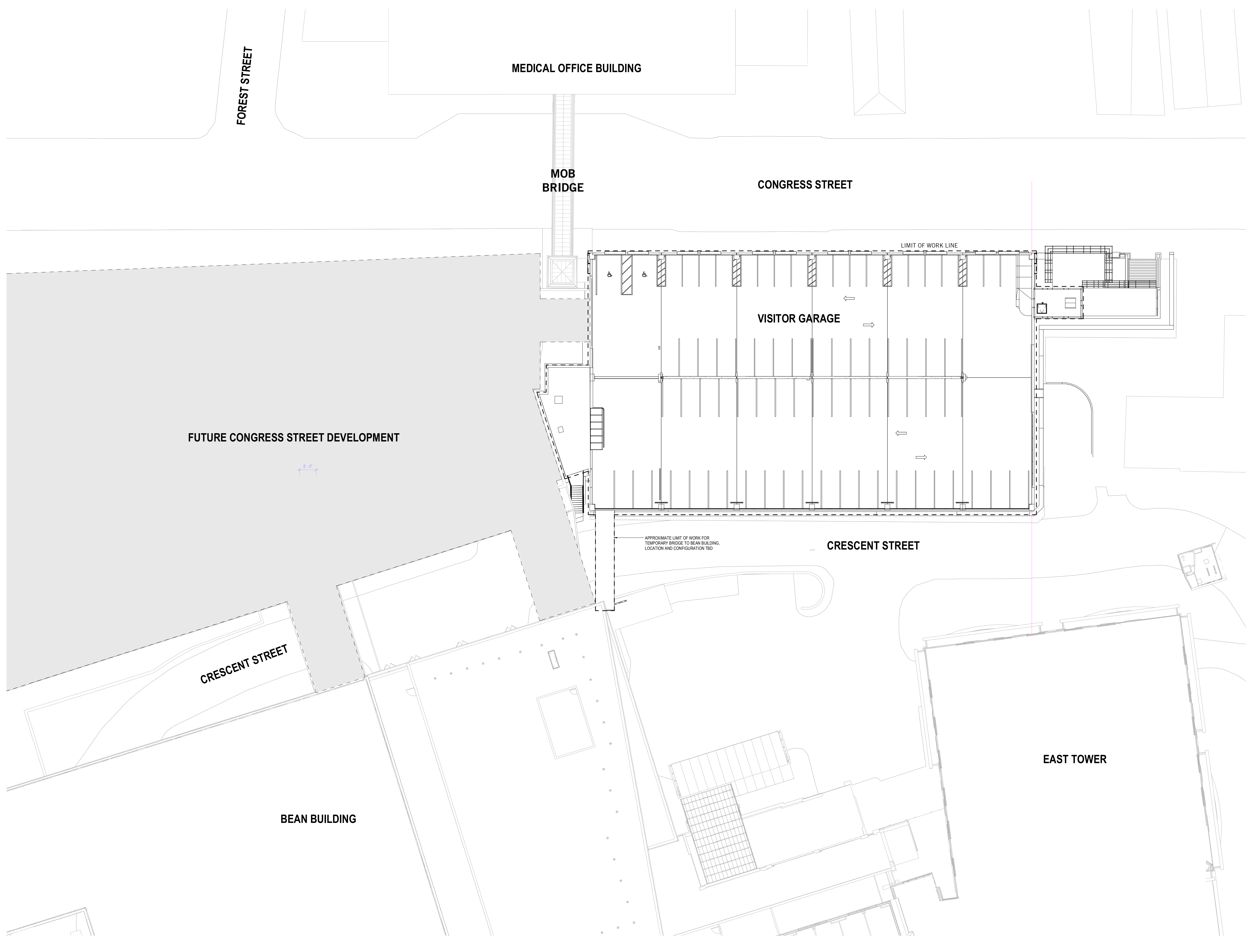

1 SITE PLAN
1/16" = 1'-0"

3/29/2018 3:19:46 PM
C:\temp\152182\MCC\Visitor Parking Garage Expansion\2017_Targi.dwg