

9 CABLE PATHWAY - SINGLE LINE DIAGRAM  
SCALE: NONE

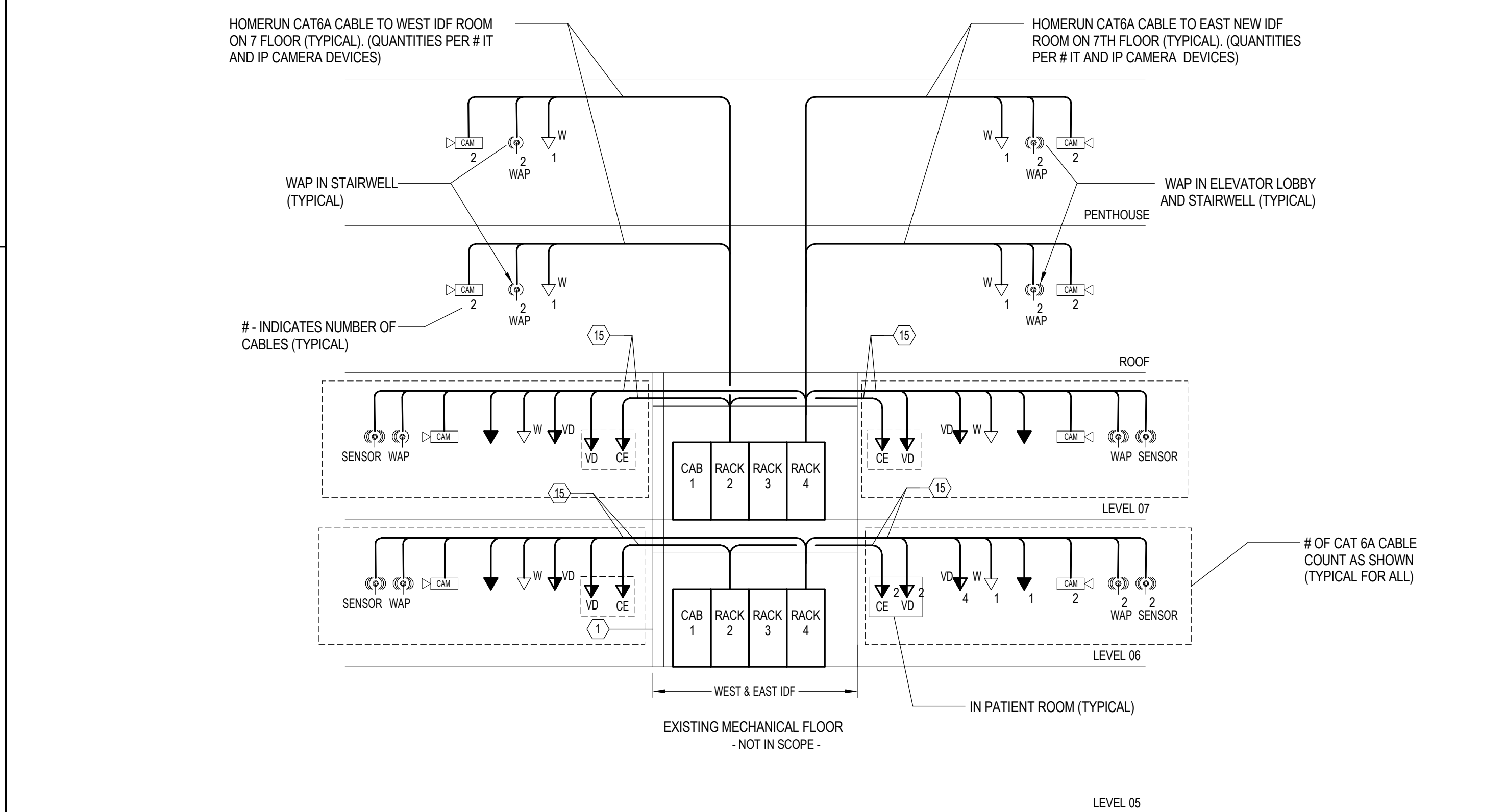

8 TYPICAL HORIZONTAL CABLING - SINGLE LINE DIAGRAM  
SCALE: NONE

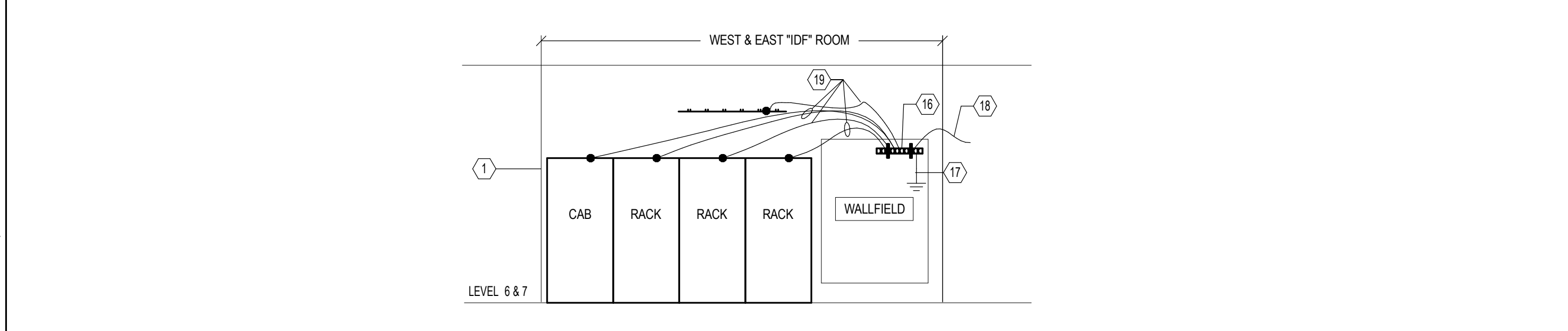

7 TYPICAL "IDF" GROUNDING AND BONDING - SINGLE LINE DIAGRAM  
SCALE: NONE

- DRAWING NOTES:**
- REFERENCE COMM. PLANS FOR EXACT OUTLET LOCATION AND QUANTITIES.
  - REFERENCE COMM. SPECS FOR FIBER AND COPPER BACKBONE TERMINATION.
  - HORIZONTAL CABLE SHALL BE TERMINATED IN IDF PATCH PANEL AND WIRED TO T-568A.
  - TELECOM (IDF) ROOM(S) AS SHOWN, INCLUDING CABLE HARDWARE AND DETAIL.
  - EXISTING MDF, IDF(S) & PATHWAY(S) TO BE COORDINATED IN THIS BUILDING.
  - COMM. HARDWARE & CABLING ARE NEW, UNLESS OTHERWISE NOTED EXISTING.

- KEY NOTES:**
- (1) WEST TELECOM ROOM (IDF)
  - (2) EAST TELECOM ROOM (IDF)
  - (3) 2-POST EIA 19" RACK (TYPICAL)
  - (4) 18" WIDE OVERHEAD LADDER RACK WITH COMPLETE MOUNTING KIT
  - (5) 4" 3M FIRE BARRIER PASS-THROUGH DEVICE (TYPICAL), QUANTITIES AS REQUIRED
  - (6) 18" WIDE VERTICAL LADDER RACK WITH COMPLETE MOUNTING KIT
  - (7) PROVIDE (4) NEW 4" FLOOR CORES & SLEEVES AND USE FIRESTOPPING SYSTEM.
  - (8) EXTEND (4) 4" CONDUITS FROM EXISTING SLEEVES ABOVE NEW IDF
  - (9) (1) - NOT TO EXCEEDS MORE THAN (2) 90 DEGREE TURN  
(2) - NOT TO EXCEEDS 100-FOOT DISTANCE RUN.
  - (10) PULL BOX AS REQUIRED BY E.C.
  - (11) A - (T.B.D.) BY MMC SINGLE-MODE (ARMORED TYPE) OS2 FIBER RISER CABLE  
B - (T.B.D.) BY MMC CAT5E COPPER RISER CABLE  
C - (T.B.D.) SINGLE-MODE (ARMORED TYPE) OS2 FIBER THE CABLE  
D - 100 PAIR CAT5E COPPER THE CABLE FOR PAGING SYSTEM  
E - (2) CAT5E PLENUM RATED CABLE FOR NURSE CALL PANEL
  - (12) TERMINATE BACKBONE CABLES TO EXISTING FIBER PANEL IN RACK2  
USE SPARE ADAPTER SLOTS (OR INSTALL NEW AS REQUIRED MATCHING EXISTING)
  - (13) NEW BACKBONE CABLING PASSING THROUGH IN EXISTING IDF ROOM
  - (14) EXISTING OVERHEAD LADDER RACK.
  - (15) CAT 6A HORIZONTAL CABLING (TYPICAL)
  - (16) TELECOM GROUNDING BUSBAR (TGB) BY E.C.
  - (17) BONDING CONDUCTOR TO BUILDING STEEL (TYPICAL), SIZING BY E.C.
  - (18) BONDING CONDUCTOR FOR TELECOM BONDING BACKBONE (TBB) BY E.C.
  - (19) EQUIPMENT BONDING CONDUCTOR, IT CONTRACTOR TO INSTALL TELECOM EQUIPMENT (E.G., LADDER RACK, RACKS, CABINETS, J-BOX & CONDUITS)

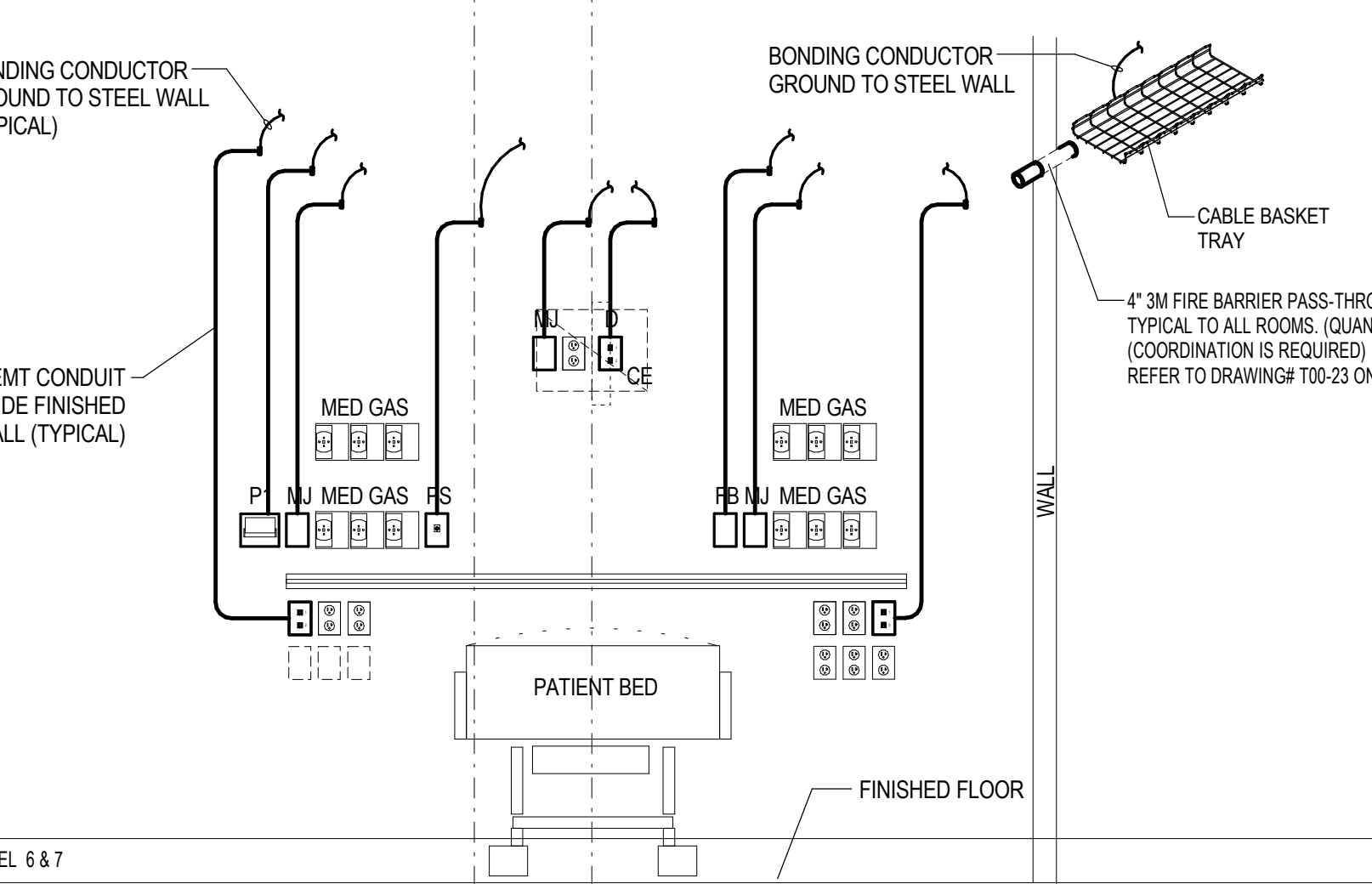

6 TYPICAL NURSE CALL GROUNDING AND BONDING DIAGRAM  
SCALE: NONE

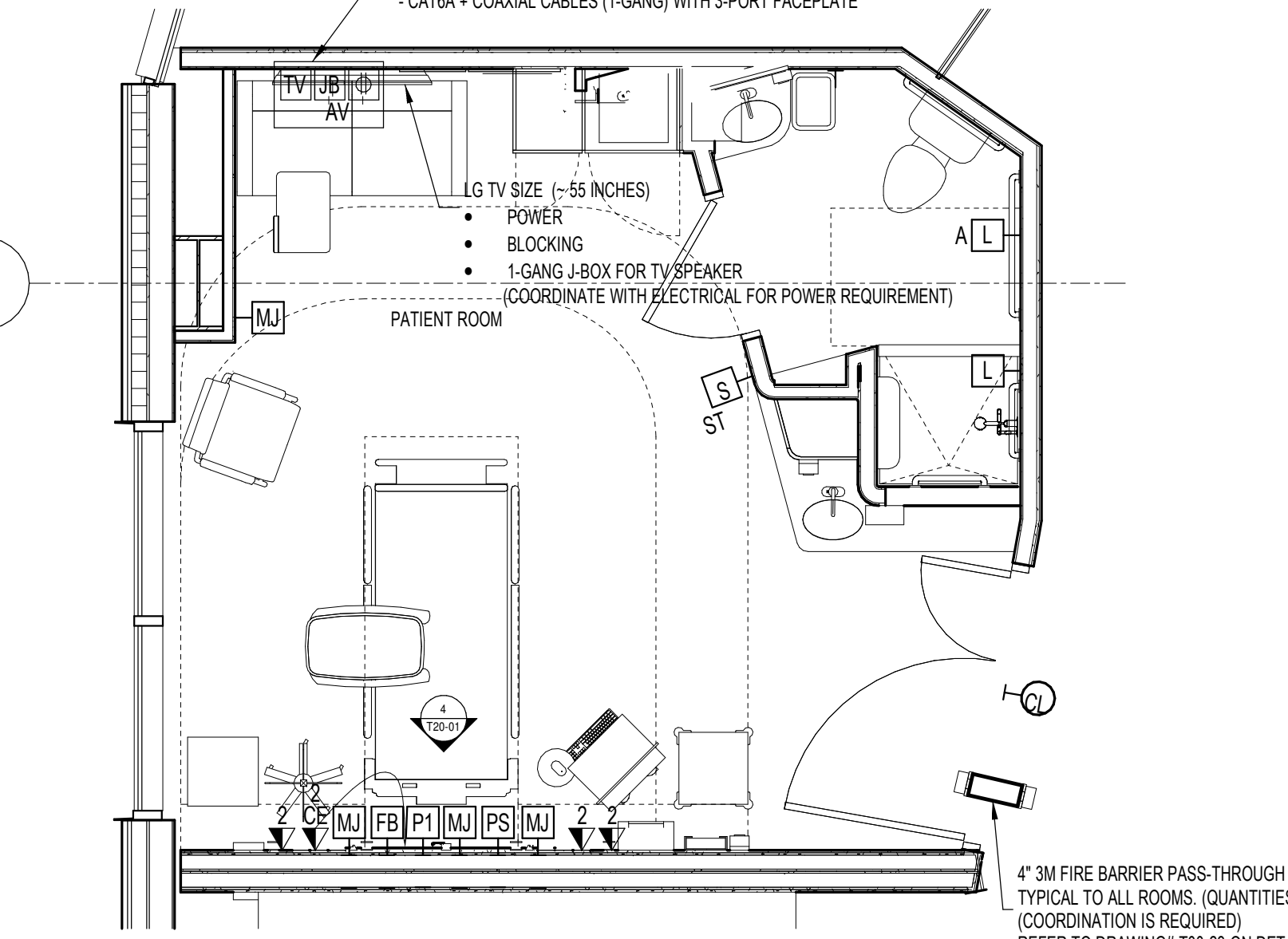

5 TYPICAL PATIENT ROOM DEVICE LOCATION (TOP) VIEW  
SCALE: NONE

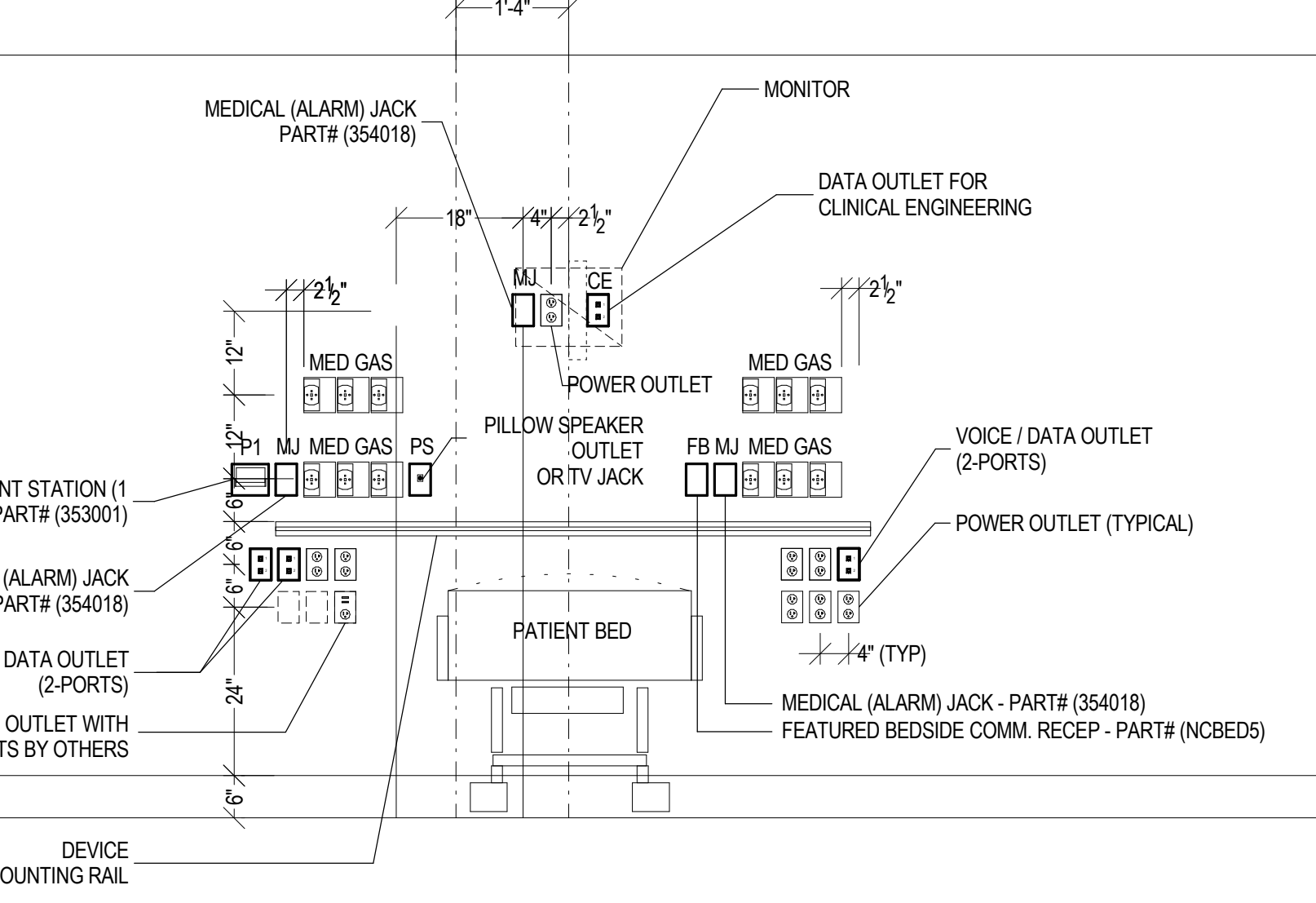

4 TYPICAL PATIENT ROOM HEADWALL (FRONT) ELEVATION  
SCALE: NONE

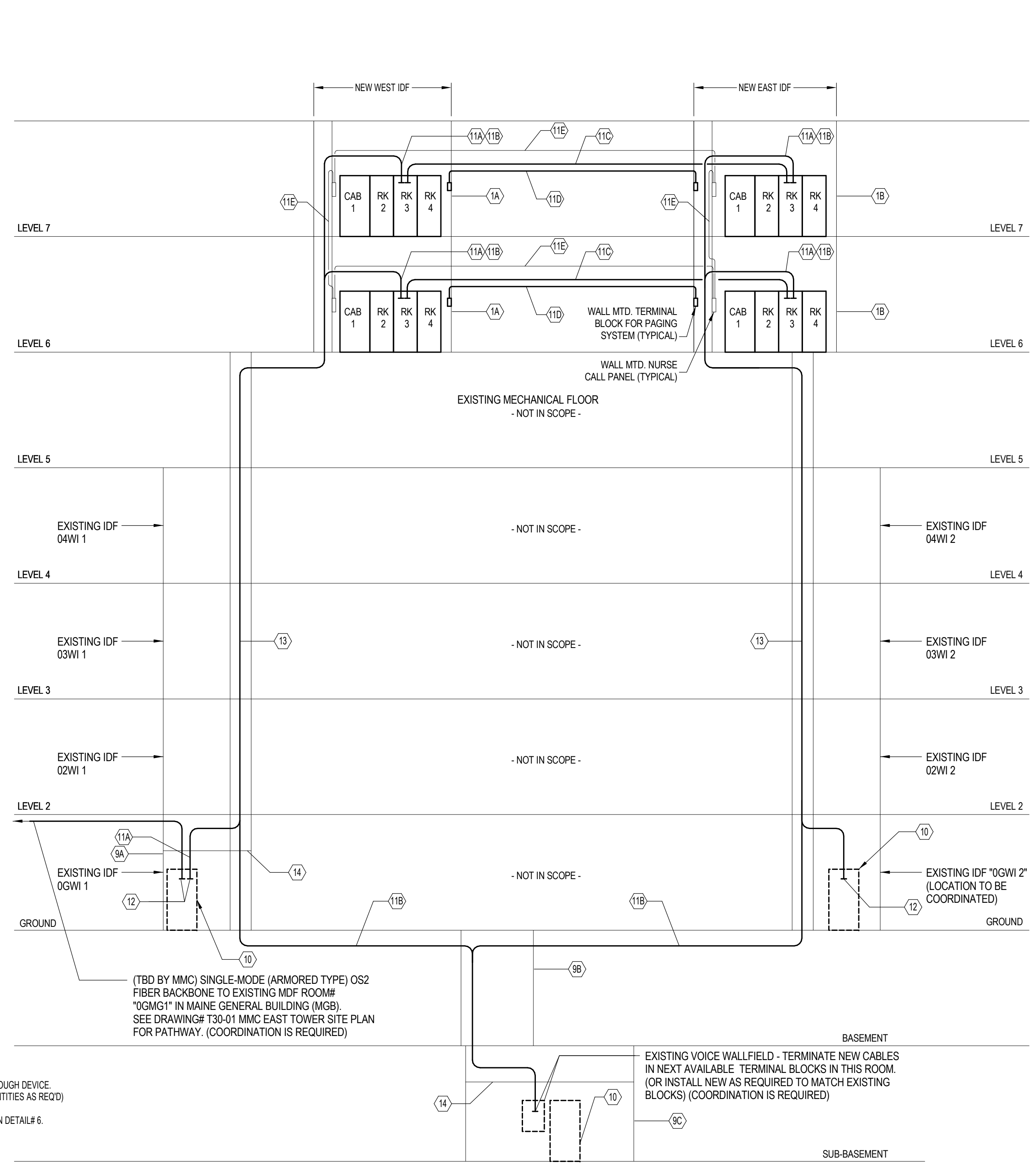

3 BACKBONE RISER CABLE - SINGLE LINE DIAGRAM  
SCALE: NONE

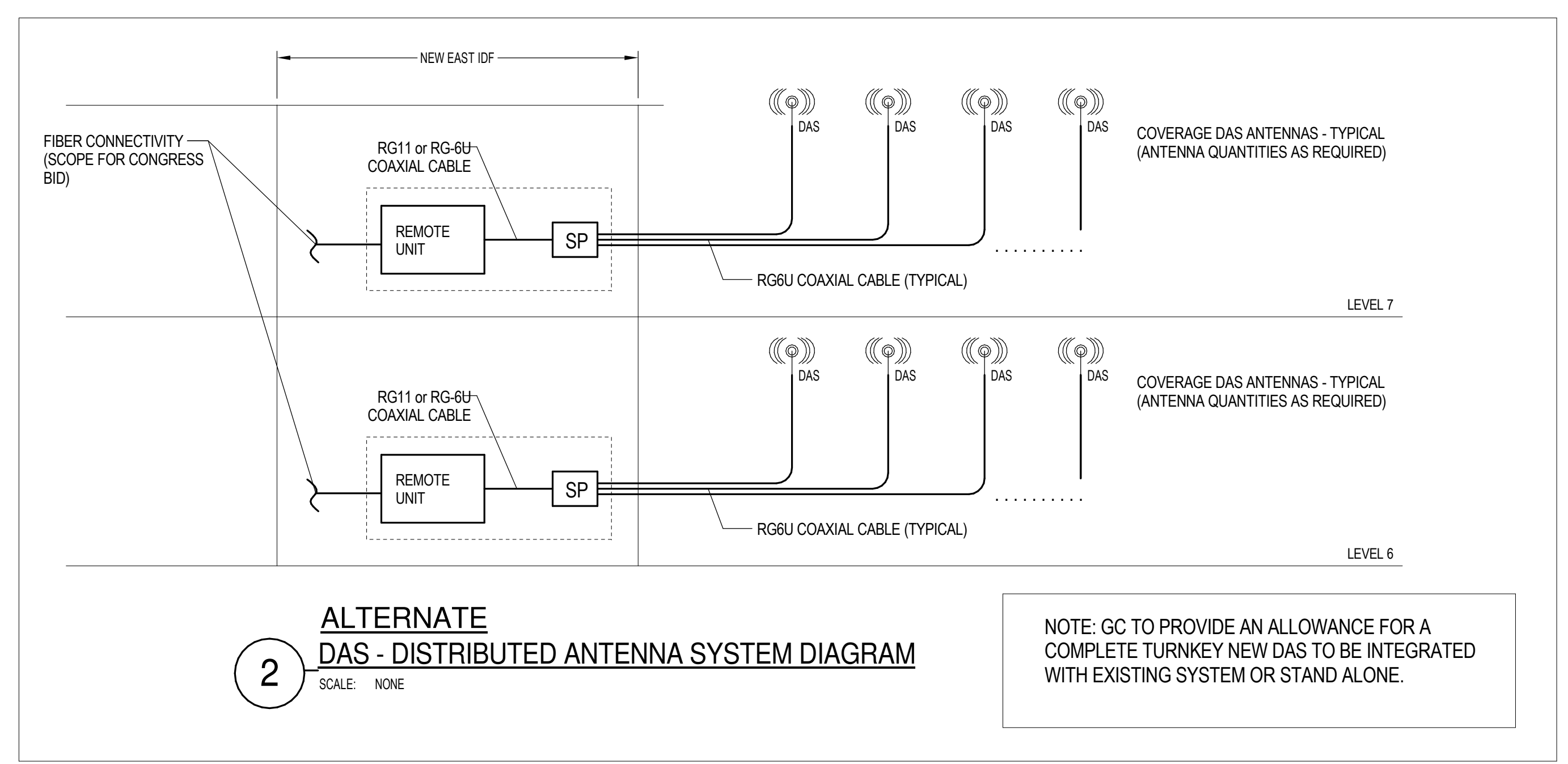

2 ALTERNATE DAS - DISTRIBUTED ANTENNA SYSTEM DIAGRAM  
SCALE: NONE

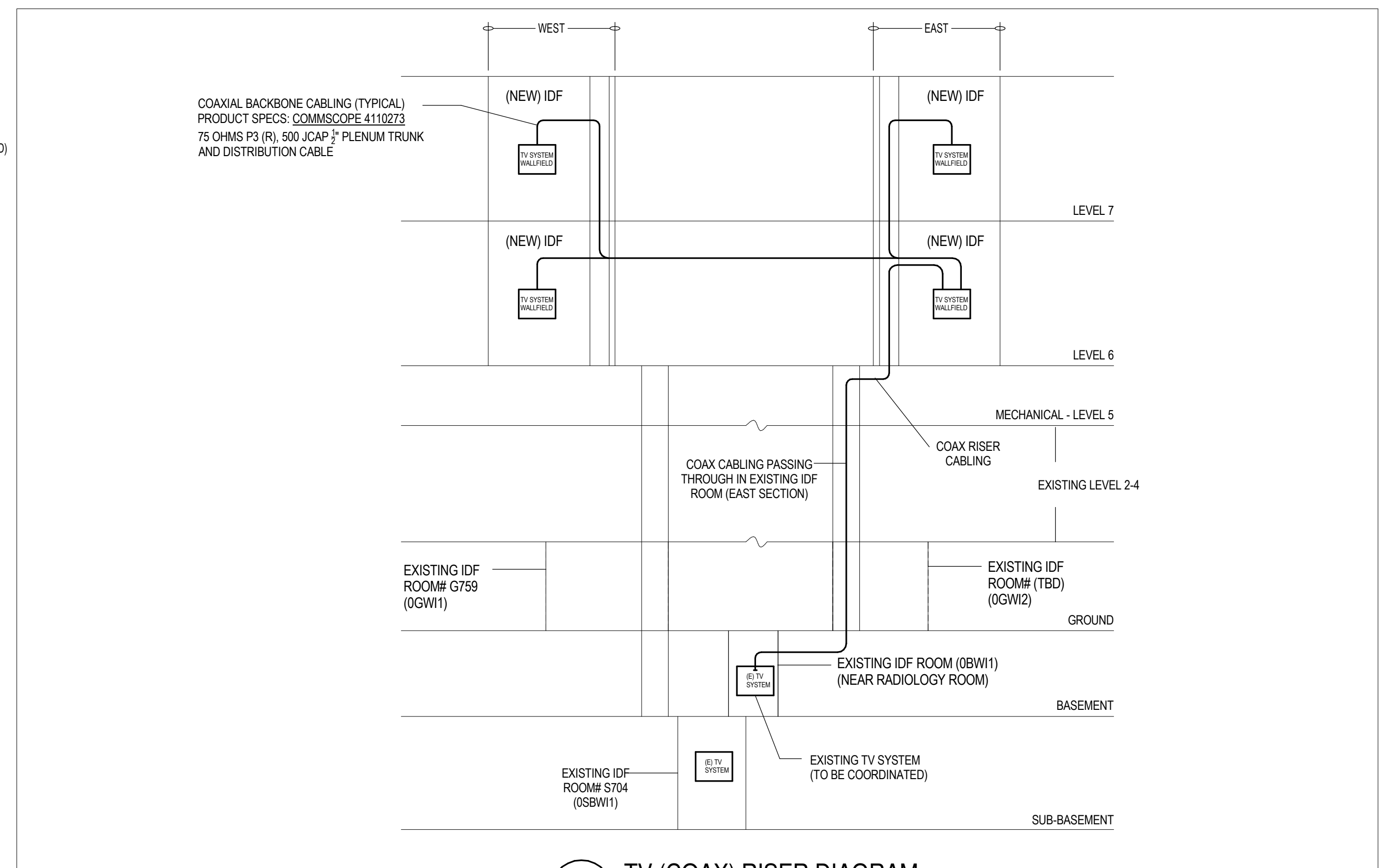

1 TV (COAX) RISER DIAGRAM  
SCALE: NONE

- CIVIL/LANDSCAPE ARCHITECT**  
Sebago Technics  
75 John Roberts Road, Suite  
1A, South Portland, ME 04106
- STRUCTURAL ENG./BUILDING ENVELOPE CONSULTANT**  
Stinson Gumpertz & Hager Inc.  
41 Sevon Street, Building 1, Suite 501,  
Waltham, MA 02453
- MERFP ENGINEER CODE**  
AKF Group LLC  
99 Bedford Street, 2nd Floor, Boston MA 02111
- CONSTRUCTION MANAGER**  
Turner Construction  
2 Seaport Lane, Suite 200, Boston, MA 02210
- ELEVATOR CONSULTANT**  
VDA (Van Deusen & Associates)  
101 Summer Street, 4th Floor, Boston MA  
02110
- COST ESTIMATOR**  
D. G. Jones International  
3 Baldwin Green Common, Suite 202, Woburn, MA 01801

**East Tower 6 & 7 Addition**  
22 Bramhall Street  
Portland, ME 04102

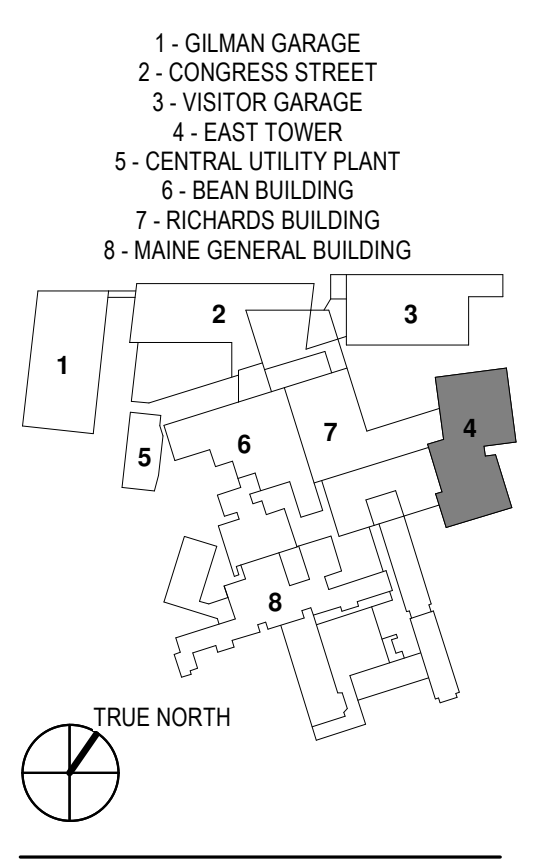
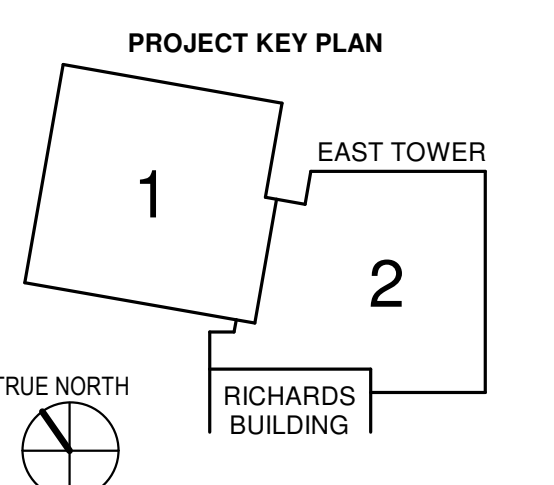
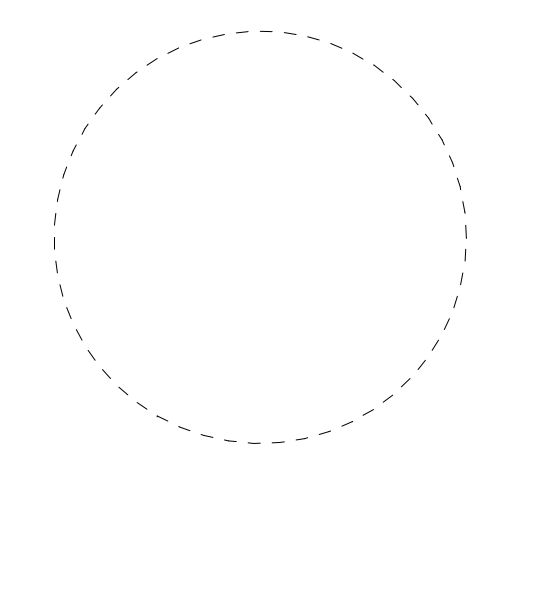

1	ADDENDUM NO. 1	03/22/18
NO	ISSUE	DATE
Drawn	EL	
Checked	BN	
Approved	BN	