

CONSULTANTS

CIVIL/LANDSCAPE ARCHITECT  
**Sebago Technics**  
75 John Roberts Road, Suite  
1A, South Portland, ME 04106

STRUCTURAL/ENR/BUILDING ENVELOPE CONSULTANT  
**Simpson Gumpertz & Heger Inc.**  
41 Seay Street, Building 1, Suite 501,  
Waltham, MA 02453

MEP/ELECTRICAL ENGINEER CODE  
**AKF Group LLC**  
99 Bedford Street, 2nd Floor, Boston MA 02111

CONSTRUCTION MANAGER  
**Turner Construction**  
2 Seaport Lane, Suite 200, Boston, MA 02210

ELEVATOR CONSULTANT  
**VDA (Van Deusen & Associates)**  
101 Summer Street, 4th Floor, Boston MA  
02110

COST ESTIMATOR  
**D. G. Jones International**  
3 Baldwin Green Common, Suite 202, Woburn, MA 01801

PROJECT TITLE

**East Tower 6 & 7  
Addition**  
22 Bramhall Street  
Portland, ME 04102

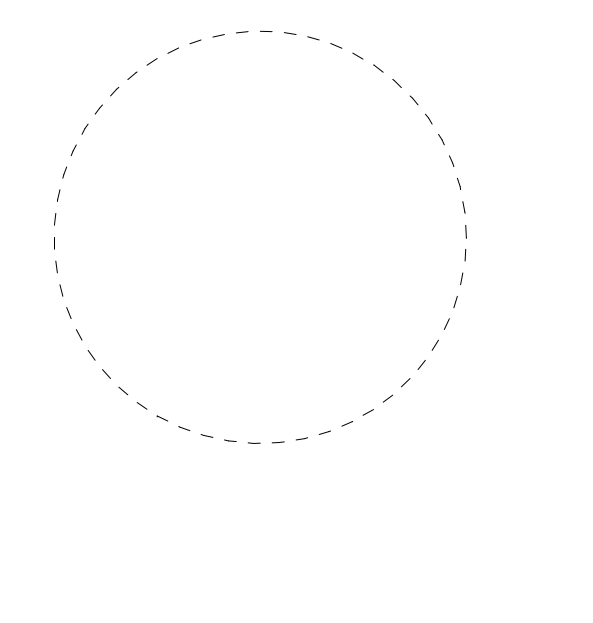

KEY PLANS

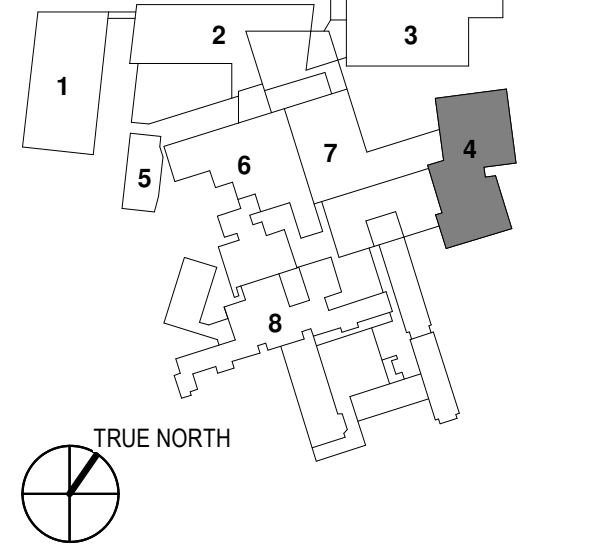
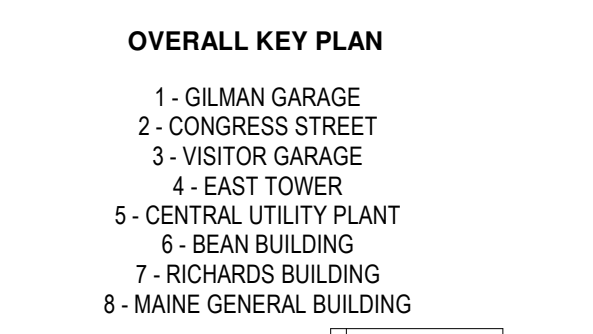
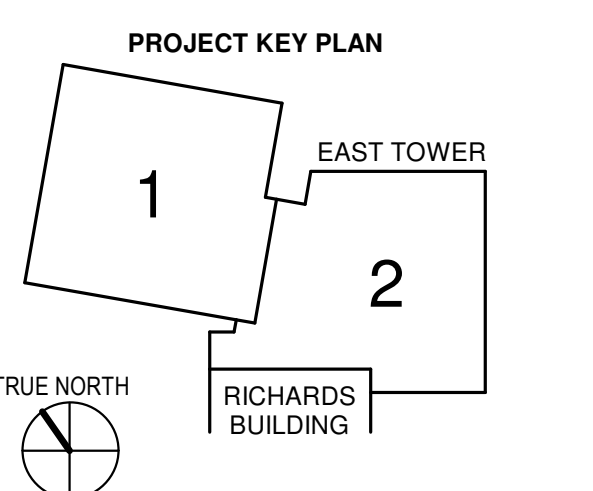

CONSTRUCTION DOCUMENTS  
JANUARY 28, 2018

NO.	ISSUE	DATE
Job Number	B150312-000	
Drawn	EL	
Checked	BN	
Approved	BN	

TITLE  
**COMMUNICATIONS  
DETAILS**

SHEET NUMBER

**T00-23**

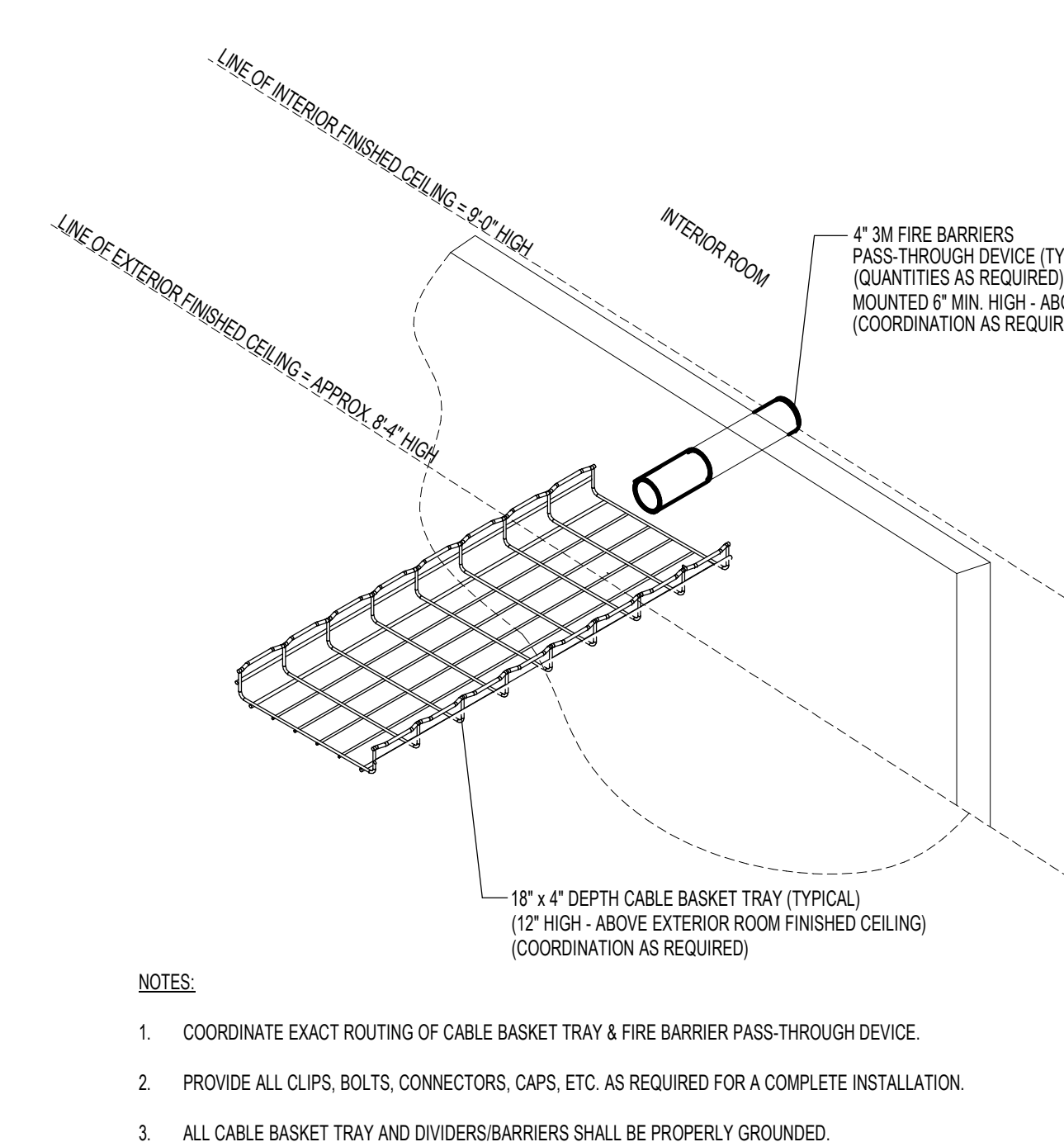

- NOTES:
- COORDINATE EXACT ROUTING OF CABLE BASKET TRAY & FIRE BARRIER PASS-THROUGH DEVICE.
  - PROVIDE ALL CLIPS, BOLTS, CONNECTORS, CAPS, ETC. AS REQUIRED FOR A COMPLETE INSTALLATION.
  - ALL CABLE BASKET TRAY AND DIVIDERS/BARRIERS SHALL BE PROPERLY GROUNDED.

(TYPICAL FOR ALL ROOMS AND PATIENT ROOMS)  
**6 FIRE BARRIER TO BASKET TRAY**  
SCALE: NONE

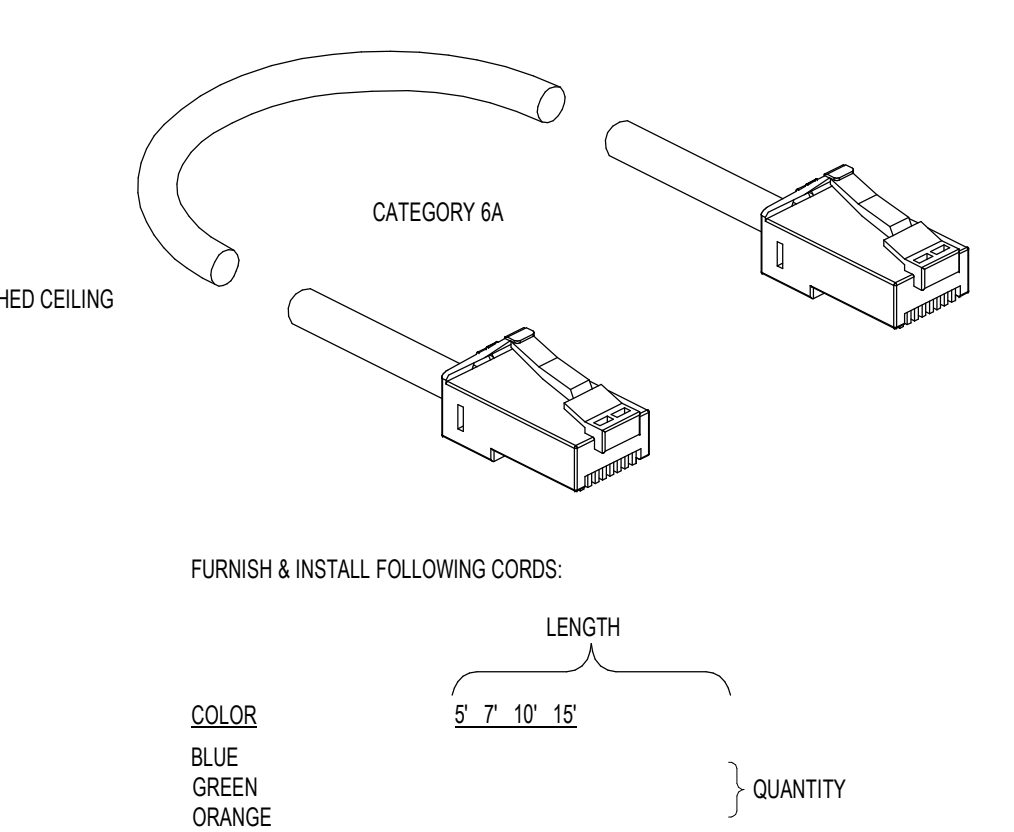

- NOTES:
- CONTRACTOR SHALL CONFIRM ALL FINAL QUANTITIES, COLOR AND LENGTH WITH CLIENT PRIOR TO PURCHASING ANY PATCHING.
  - ALL CORDS SHALL BE CATEGORY 6A CORDS, WITH SNAGLESS PLUGS.
  - PROVIDE 7 PATCH CORDS AT STATION, OFFICE AND PRINTER. LENGTH AS REQUIRED INSIDE TELECOM ROOM. QTY AS REQUIRED.

**3 PATCH CORD LABELING & QUANTITY**  
SCALE: NONE

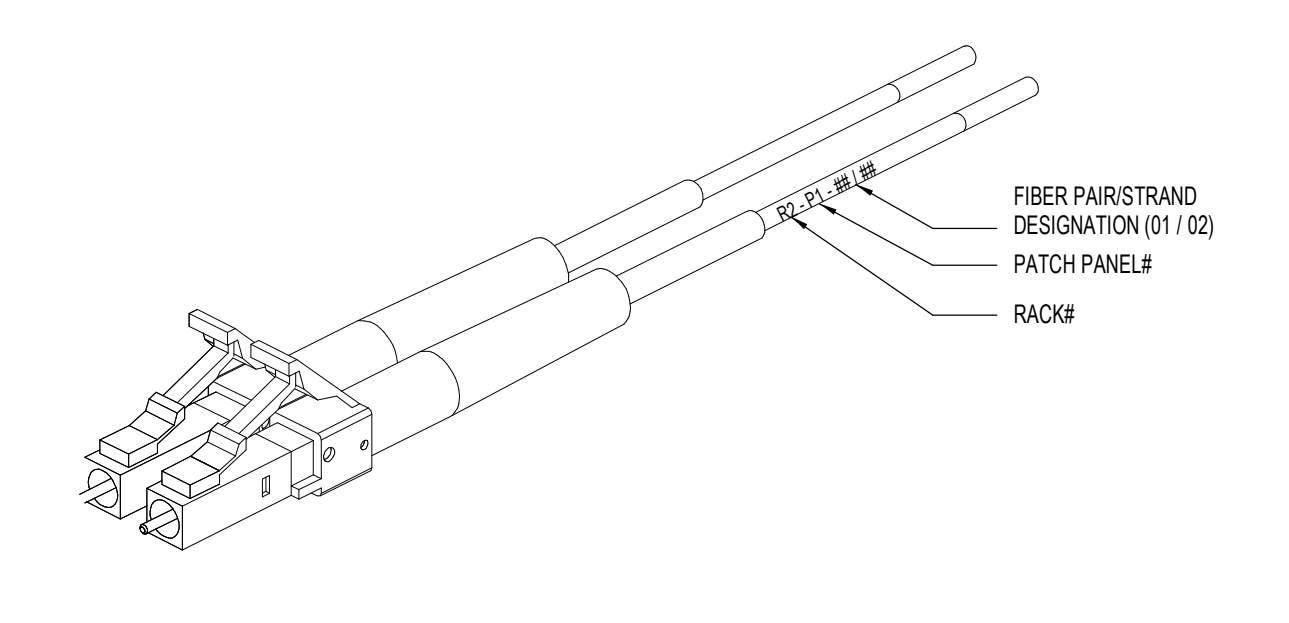

- NOTES:
- PROVIDE COMPUTER GENERATED LABEL 6 INCHES FROM TERMINATION AT BOTH ENDS. HANDWRITTEN LABELS SHALL BE CONSIDERED UNACCEPTABLE.
  - JACKS AND OTHER TERMINATION DEVICES SHALL BE INSTALLED INCLUSIVE OF ALL HARDWARE INCLUDING, BUT NOT LIMITED TO DUST CAPS, SCREWS, ETC.

**5 FIBER CABLE LABELING DETAIL**  
SCALE: NONE

GROUNDING & BONDING CONDUCTOR SIZING	
CONDUCTOR LENGTH	SIZE (INCH)
UP TO 50 FEET	#6 AWG SOLID OR STRANDED (0.16 INCH)
50 TO 100 FEET	#4 AWG STRANDED (0.20 INCH)
100 TO 150 FEET	#2 AWG STRANDED (0.26 INCH)
150 TO 200 FEET	#10 AWG STRANDED (0.482 INCH)
GREATER THAN 200 FEET	#30 AWG STRANDED (0.580 INCH)

- GROUNDING & BONDING NOTES:
- ALL RACKS, CABINETS, LADDER RACK & CONDUITS SHALL BE PROPERLY BONDED TO THE TELECOMMUNICATIONS GROUNDING BUSBAR REFER TO THE GROUNDING & BONDING CONDUCTOR SIZING SCHEDULE.
  - SEE T00-01 FOR GROUNDING & BONDING GENERAL NOTES.
  - PROVIDE BONDING JUMPER FOR ALL LADDER RACK SECTION CROSS AND CORNERS.

**2 GROUND CONDUCTOR SIZING SCHEDULE**  
SCALE: NONE

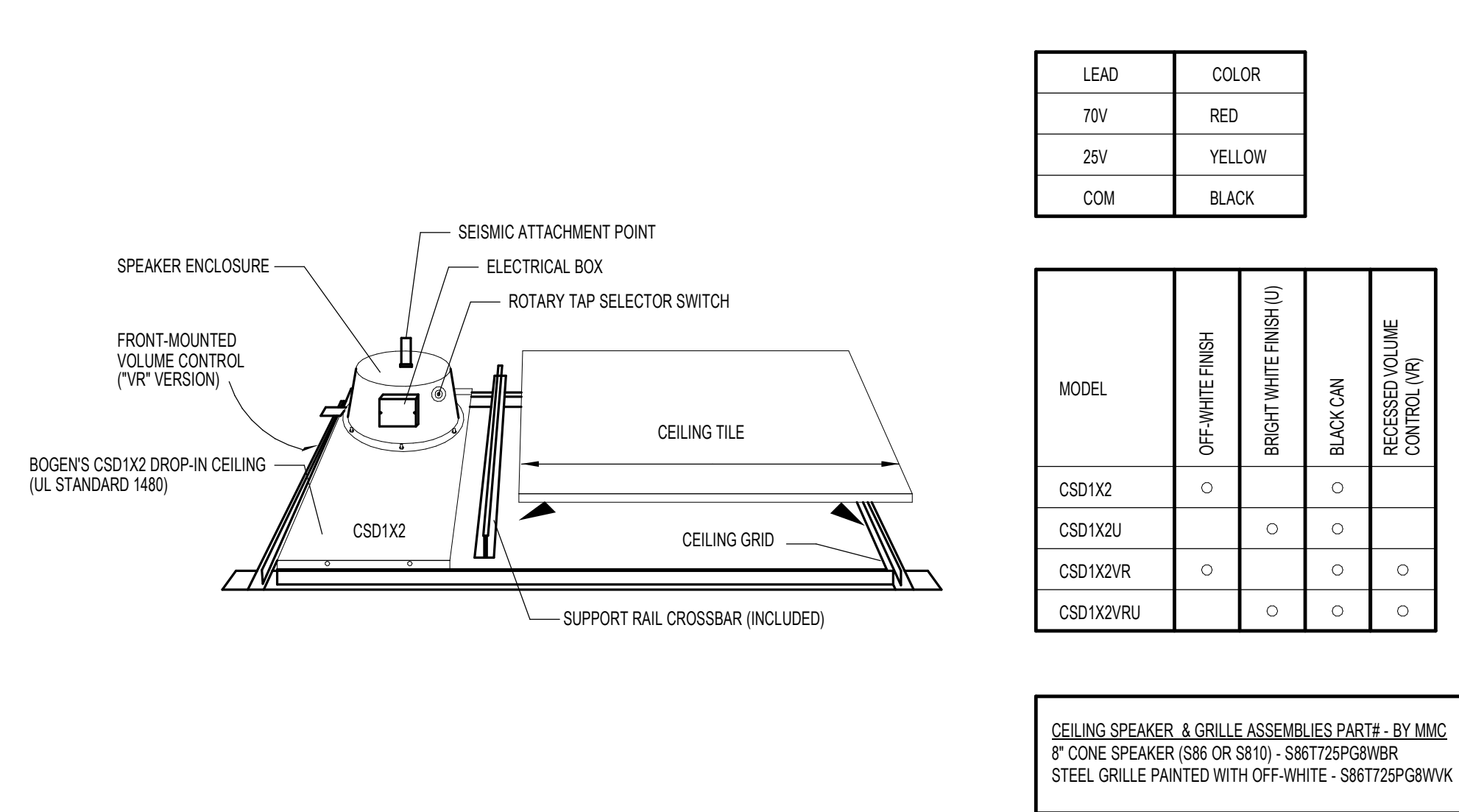

**8 DROP-IN CEILING SPEAKER - CSD1X2 & VARIATIONS WITH BACK CAN**  
SCALE: NONE

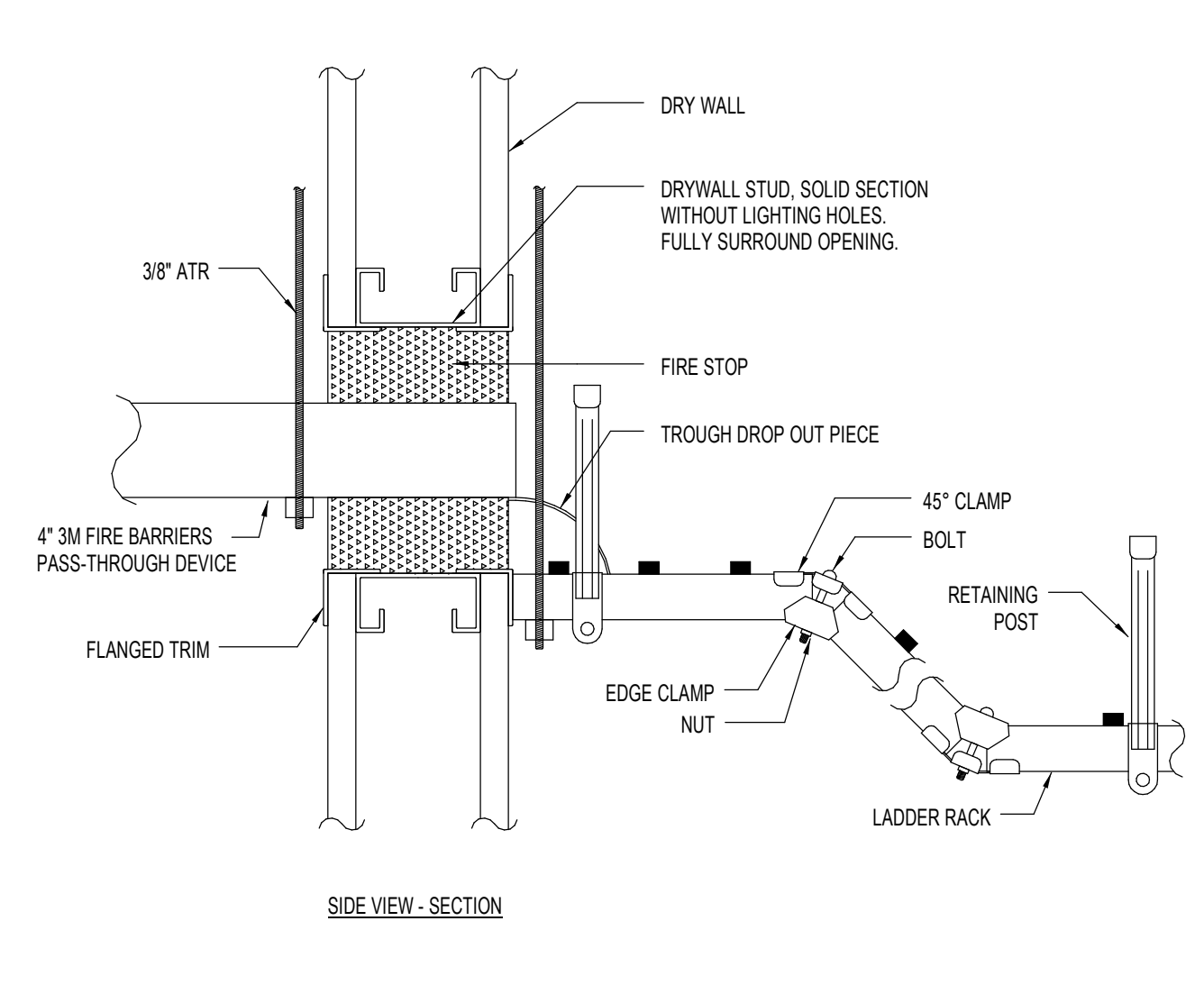

**7 PASS-THROUGH TO LADDER RACK DETAIL**  
SCALE: NONE

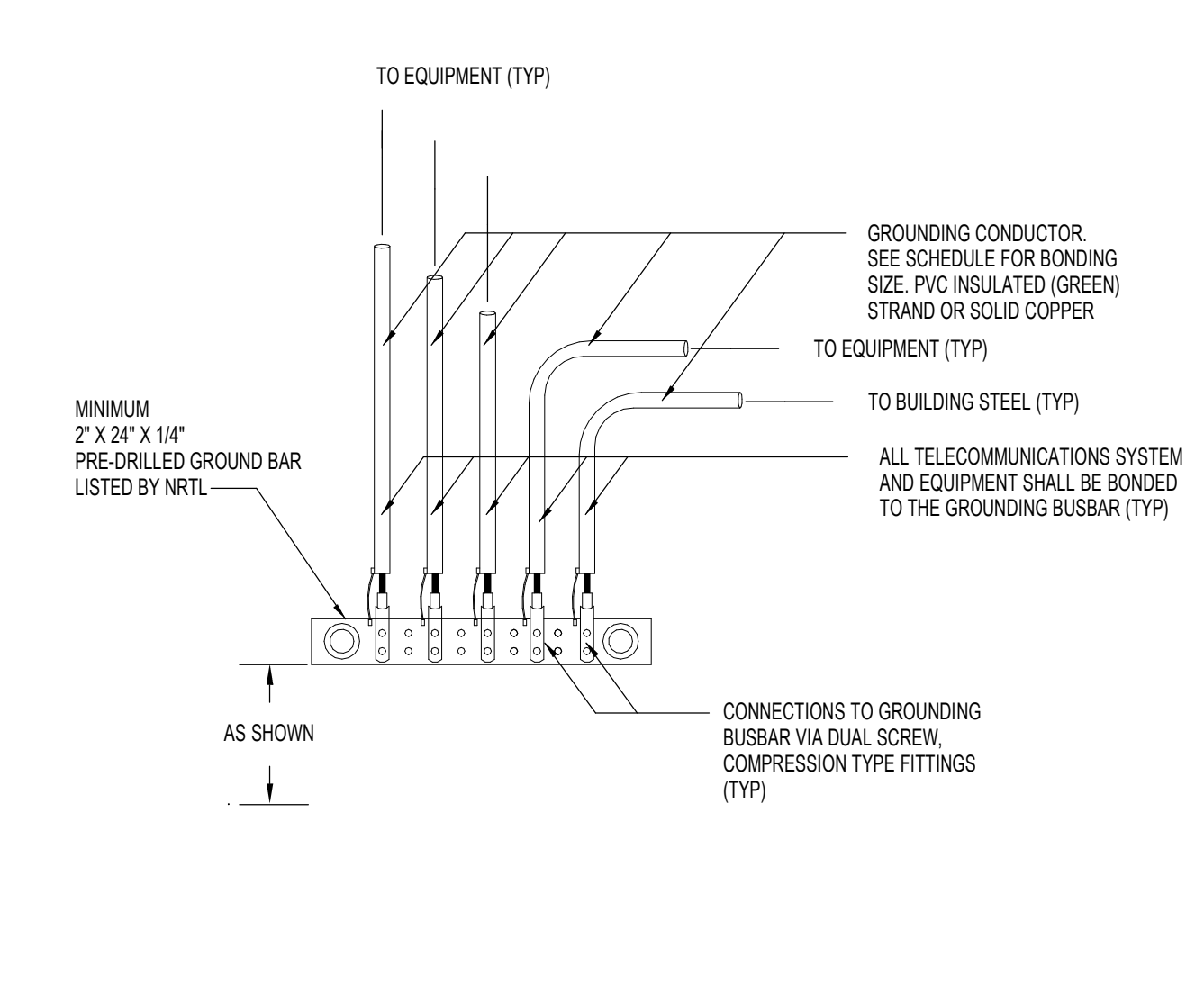

**4 GROUNDING BUSBAR DETAIL**  
SCALE: NONE

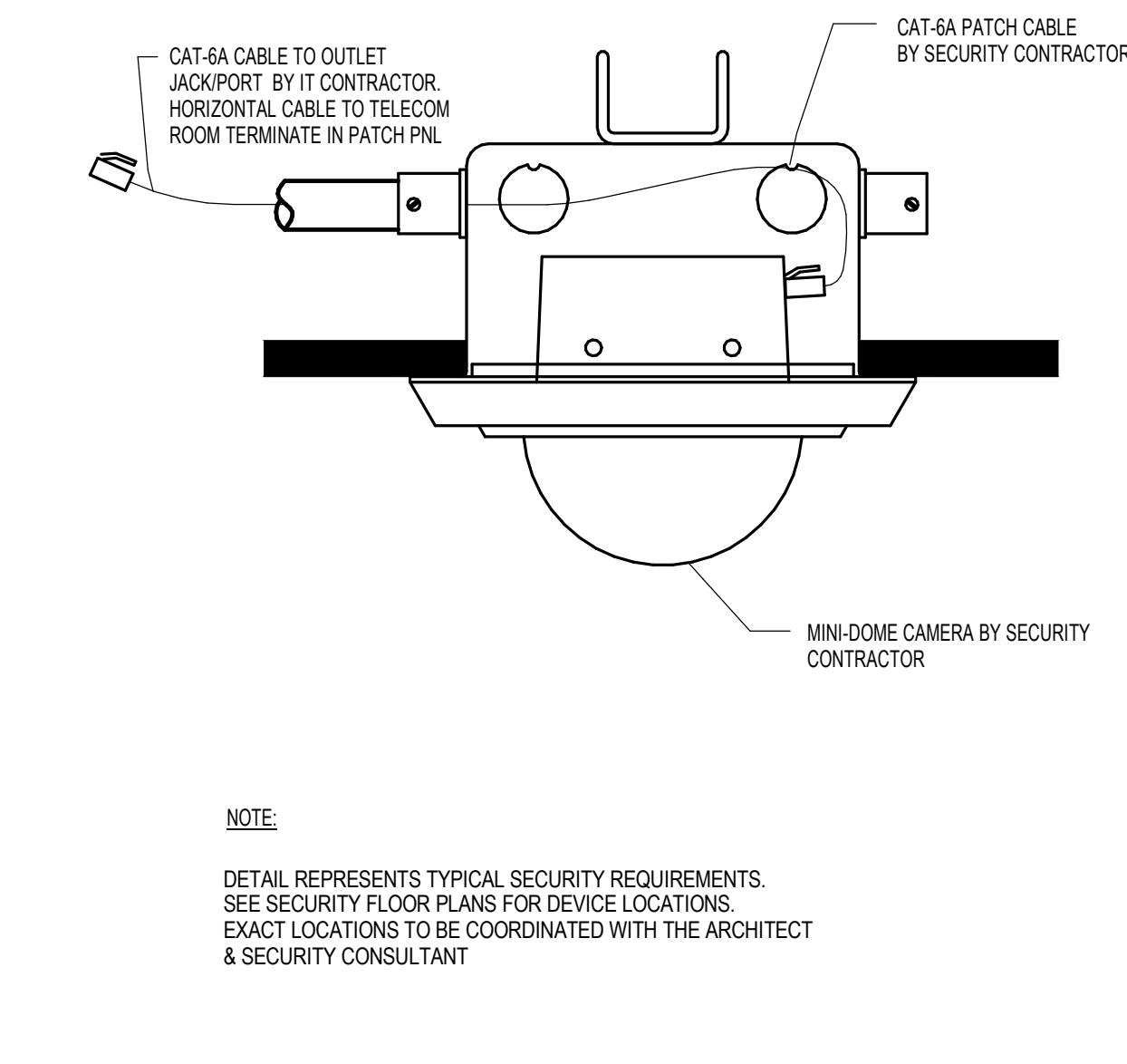

**1 IP CAMERA CABLING DETAIL**  
SCALE: N.T.S.