

CONSULTANTS

CIVIL/LANDSCAPE ARCHITECT
 Sebago Technics
 75 John Roberts Road, Suite 1A, South Portland, ME 04106

STRUCTURAL/ENR/BUILDING ENVELOPE CONSULTANT
 Singleton Gumpertz & Hepler Inc.
 41 Seaver Street, Building 1, Suite 570, Waltham, MA 02453

MERFP ENGINEER/ CODE
 AKF Group LLC
 99 Bedford Street, 2nd Floor, Boston MA 02111

CONSTRUCTION MANAGER
 Turner Construction
 2 Seaport Lane, Suite 200, Boston, MA 02210

ELEVATOR CONSULTANT
 VDA (Van Deusen & Associates)
 101 Summer Street, 4th Floor, Boston MA 02110

COST ESTIMATOR
 D. G. Jones International
 3 Baldwin Green Common, Suite 202, Woburn, MA 01801

PROJECT TITLE

East Tower 6 & 7 Addition
 22 Bramhall Street
 Portland, ME 04102

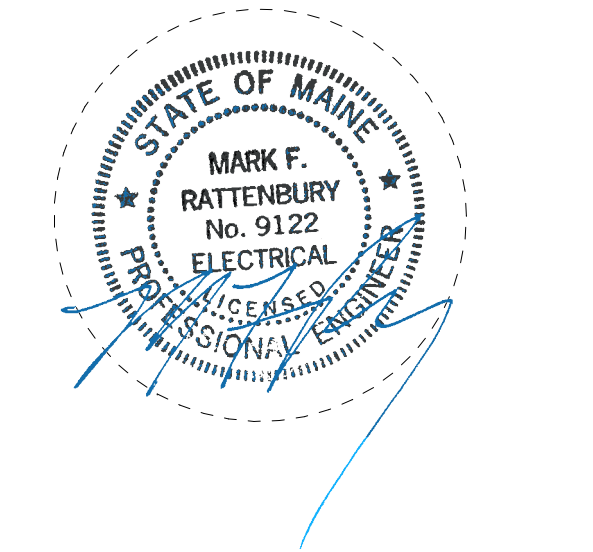

KEY PLANS

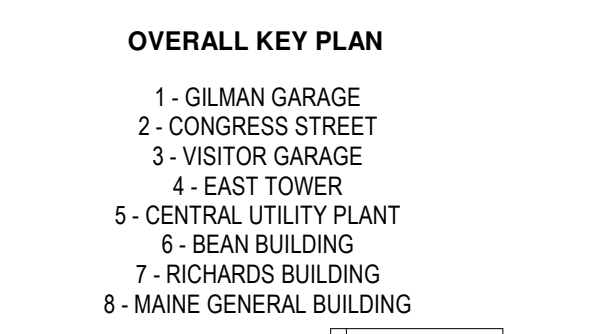
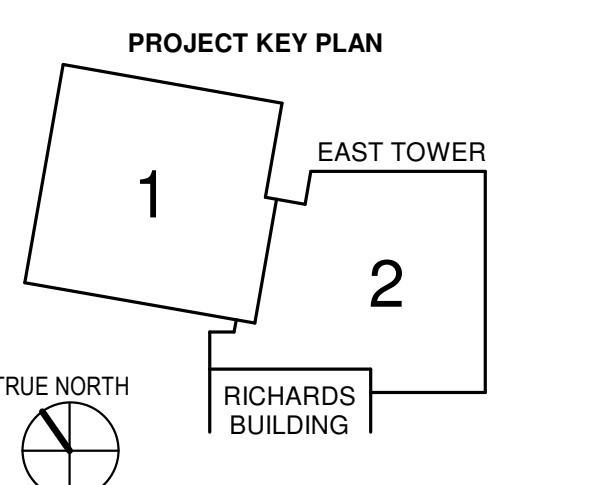

CONSTRUCTION DOCUMENTS
 JANUARY 28, 2018

ADDENDUM NO. 1	03/22/18
NO	ISSUE DATE
Job Number	B150312-000
Drawn	MAS
Checked	MFR
Approved	MFR

TITLE
ELECTRICAL POWER RISER DIAGRAM

SHEET NUMBER
E20-01

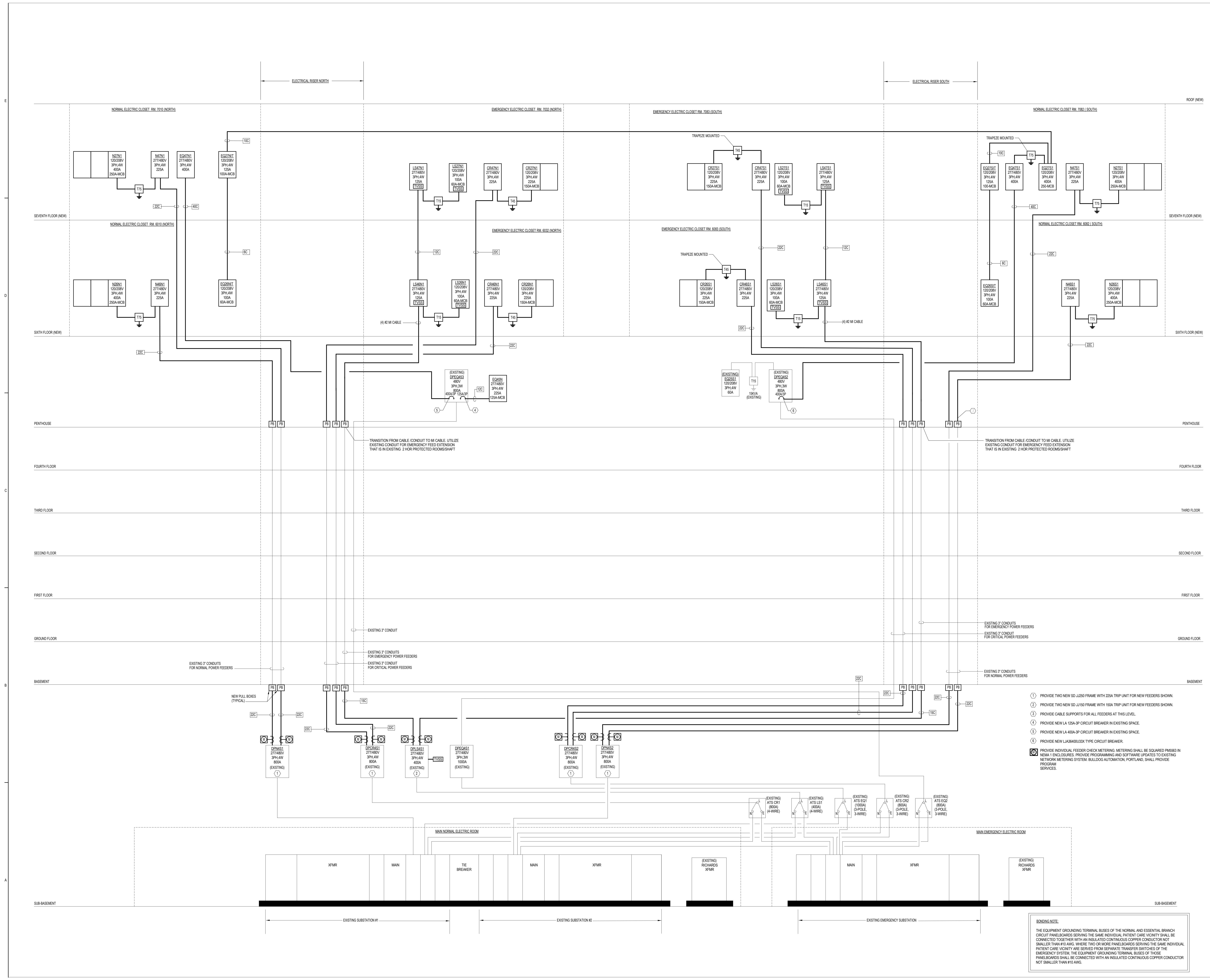

BONDING NOTE
 THE EQUIPMENT GROUNDING TERMINAL BUSSES OF THE NORMAL AND ESSENTIAL BRANCH CIRCUIT PANELBOARDS SERVING THE SAME INDIVIDUAL PATIENT CARE VICINITY SHALL BE CONNECTED TOGETHER WITH AN INSULATED CONTINUOUS COPPER CONDUCTOR NOT SMALLER THAN #10 AWG. WHERE TWO OR MORE PANELBOARDS SERVING THE SAME INDIVIDUAL PATIENT CARE VICINITY ARE SERVED FROM SEPARATE TRANSFER SWITCHES OF THE EMERGENCY SYSTEM, THE EQUIPMENT GROUNDING TERMINAL BUSSES OF THOSE PANELBOARDS SHALL BE CONNECTED WITH AN INSULATED CONTINUOUS COPPER CONDUCTOR NOT SMALLER THAN #10 AWG.