

**CONSULTANTS**

**CIVIL/LANDSCAPE ARCHITECT**  
 Sebago Technics  
 75 John Roberts Road, Suite  
 1A, South Portland, ME 04106

**STRUCTURAL/MEP BUILDING ENVELOPE CONSULTANT**  
 Simpson Gumpertz & Heger Inc.  
 41 Saxon Street, Building 1, Suite 570,  
 Waltham, MA 02453

**MEP/ELECTRICAL ENGINEER CODE**  
 AKF Group LLC  
 99 Bedford Street, 2nd Floor, Boston, MA 02111

**CONSTRUCTION MANAGER**  
 Turner Construction  
 2 Seaport Lane, Suite 200, Boston, MA 02210

**ELEVATOR CONSULTANT**  
 VDA (Van Deusen & Associates)  
 101 Summer Street, 4th Floor, Boston, MA  
 02110

**COST ESTIMATOR**  
 D. G. Jones International  
 3 Baldwin Green Common, Suite 202, Woburn, MA 01801

**PROJECT TITLE**

**East Tower 6 & 7  
 Addition**  
 22 Bramhall Street  
 Portland, ME 04102

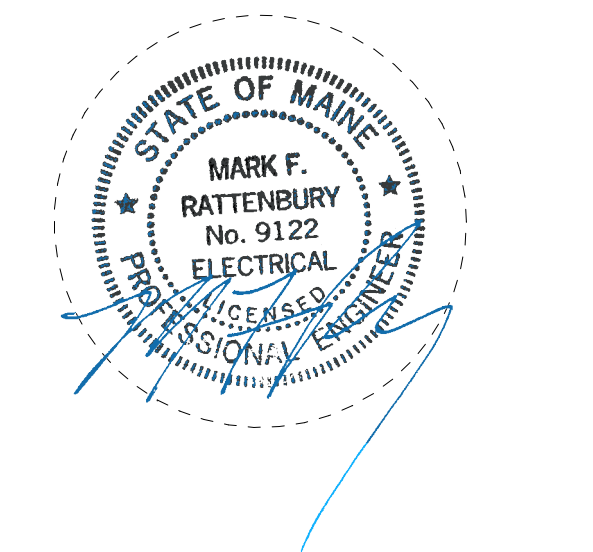

**KEY PLANS**

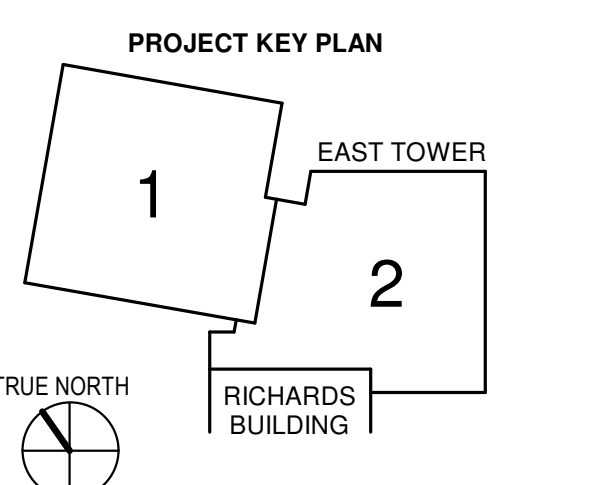

**OVERALL KEY PLAN**

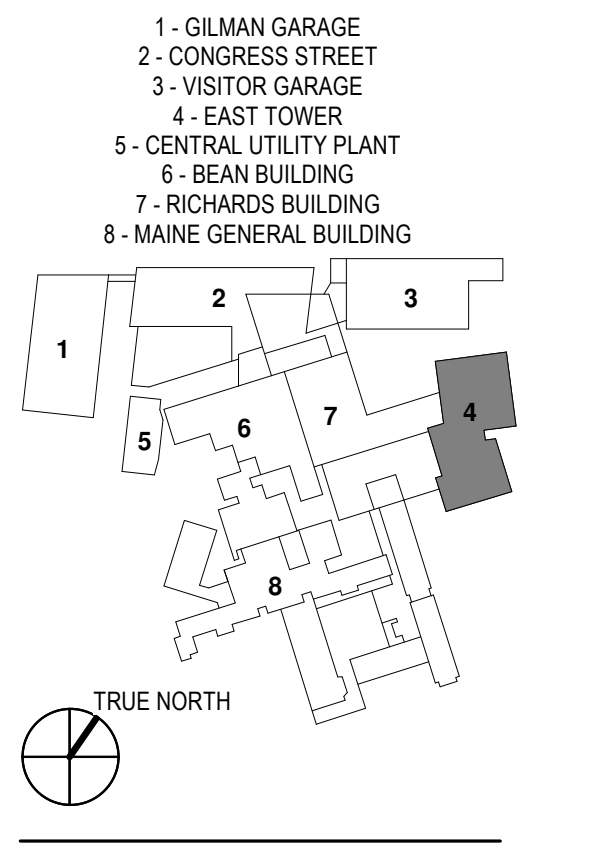

**CONSTRUCTION DOCUMENTS**  
 JANUARY 28, 2018

NO.	ISSUE	DATE
Job Number	B150312-000	
Drawn	MAGS	
Checked	MFR	
Approved	MFR	

**ELECTRICAL PART PLANS**

SHEET NUMBER

**E14-01**

Copyright 2017 © Perkins+Will

- DRAWING NOTES:**
- REFER TO DRAWING E00-01 FOR ELECTRICAL SYMBOLS, NOTES AND ABBREVIATIONS.
  - REFER TO DRAWING E00-01 FOR POWER RISER DIAGRAM.
  - REFER TO DRAWINGS E00-11 FOR ELECTRICAL SCHEDULES.
  - ALL 120V AND 208V POWER DEVICES SHALL BE CIRCUITED TO 120/208V PANELBOARDS AS INDICATED ON THE FLOOR PLANS.
  - REFER TO T-SERIES FOR ALL IDF ROOM CONDUITS, GROUNDING, DEVICE LOCATIONS AND ELEVATIONS.
  - NUMERAL ADJACENT TO THE DEVICES DENOTES CIRCUIT NUMBER. MINIMUM BRANCH CIRCUIT WIRING TO BE 2#12, 1#12 GROUND INSTALLED CONCEALED. REFER TO ELECTRICAL SPECIFICATIONS FOR WIRING METHODS.

- KEY NOTES:**
- TELECOM GROUNDING BUS-BAR TO BUILDING STEEL.
  - NURSE CALL PRIMARY PANEL AND ASSOCIATED POWER (REFER TO DRAWING T14-01 FOR ADDITIONAL INFORMATION).
  - NURSE CALL BOOSTER PANEL AND ASSOCIATED POWER (REFER TO DRAWING T14-01 FOR ADDITIONAL INFORMATION).
  - SECURITY PANEL AND ASSOCIATED POWER (REFER TO DRAWING T14-01 FOR ADDITIONAL INFORMATION).
  - 120/208V: 3W (3PH & G) FOR APC 3KVA UPS (REFER TO DRAWING T14-01 FOR ADDITIONAL INFORMATION).
  - NEMA 1-14-30R TWIST LOCK RECEPTACLE FOR CONNECTION TO PDU FOR APC 3KVA UPS. L14-30R (30A-2P), 30A-125/250V 3P 4W - 3P10 & 1P10G - 127C
  - PA PANEL AND ASSOCIATED POWER (REFER TO DRAWING T14-01 FOR ADDITIONAL INFORMATION).
  - UPS POWER COMPLEX RECEPTACLE (REFER TO DRAWING T14-01 FOR ADDITIONAL INFORMATION).

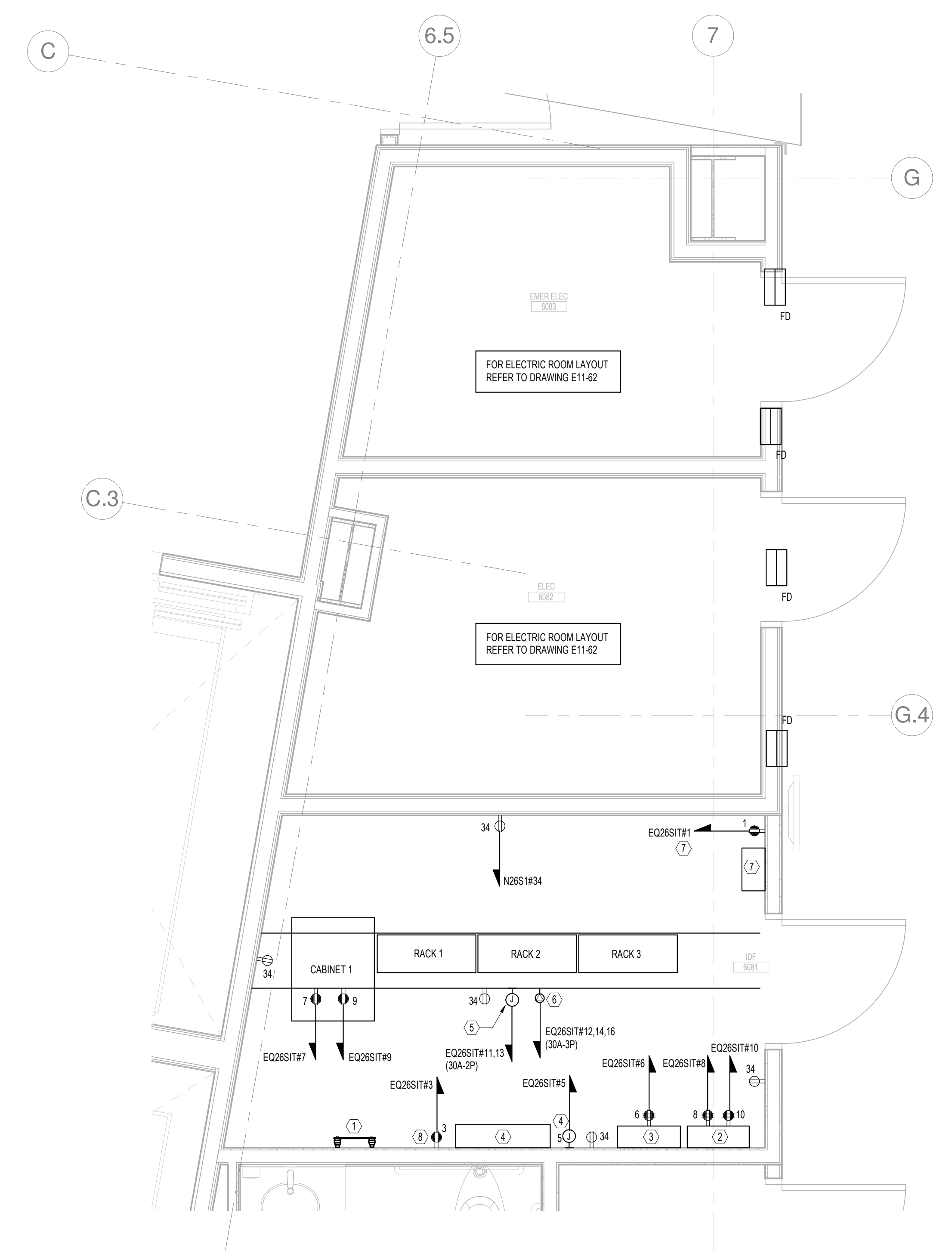

**4 LEVEL 6 ELECTRIC AND IDF ROOMS SECTOR 2**  
 SCALE: 1/2" = 1'-0"

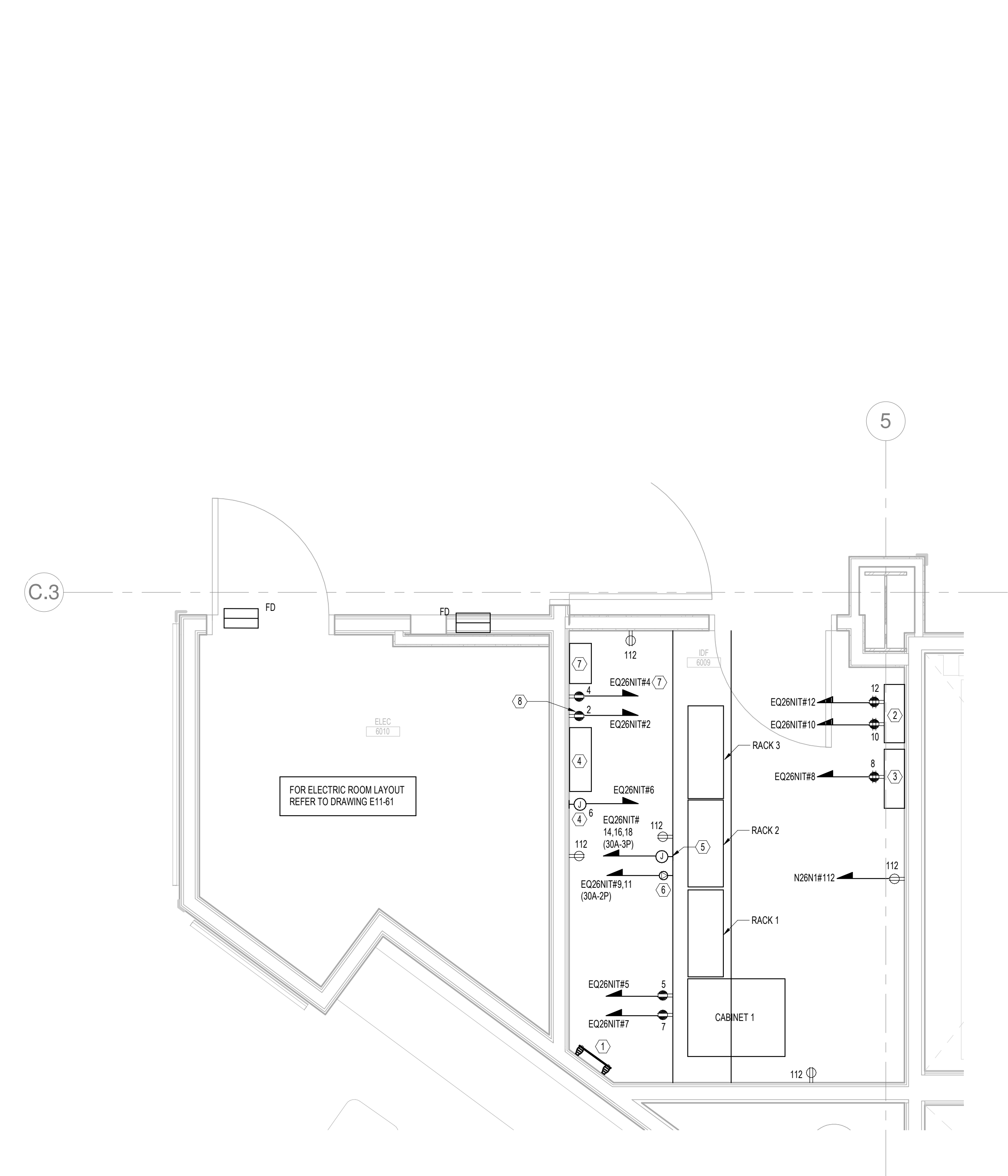

**5 LEVEL 6 ELECTRIC AND IDF ROOMS SECTOR 1**  
 SCALE: 1/2" = 1'-0"

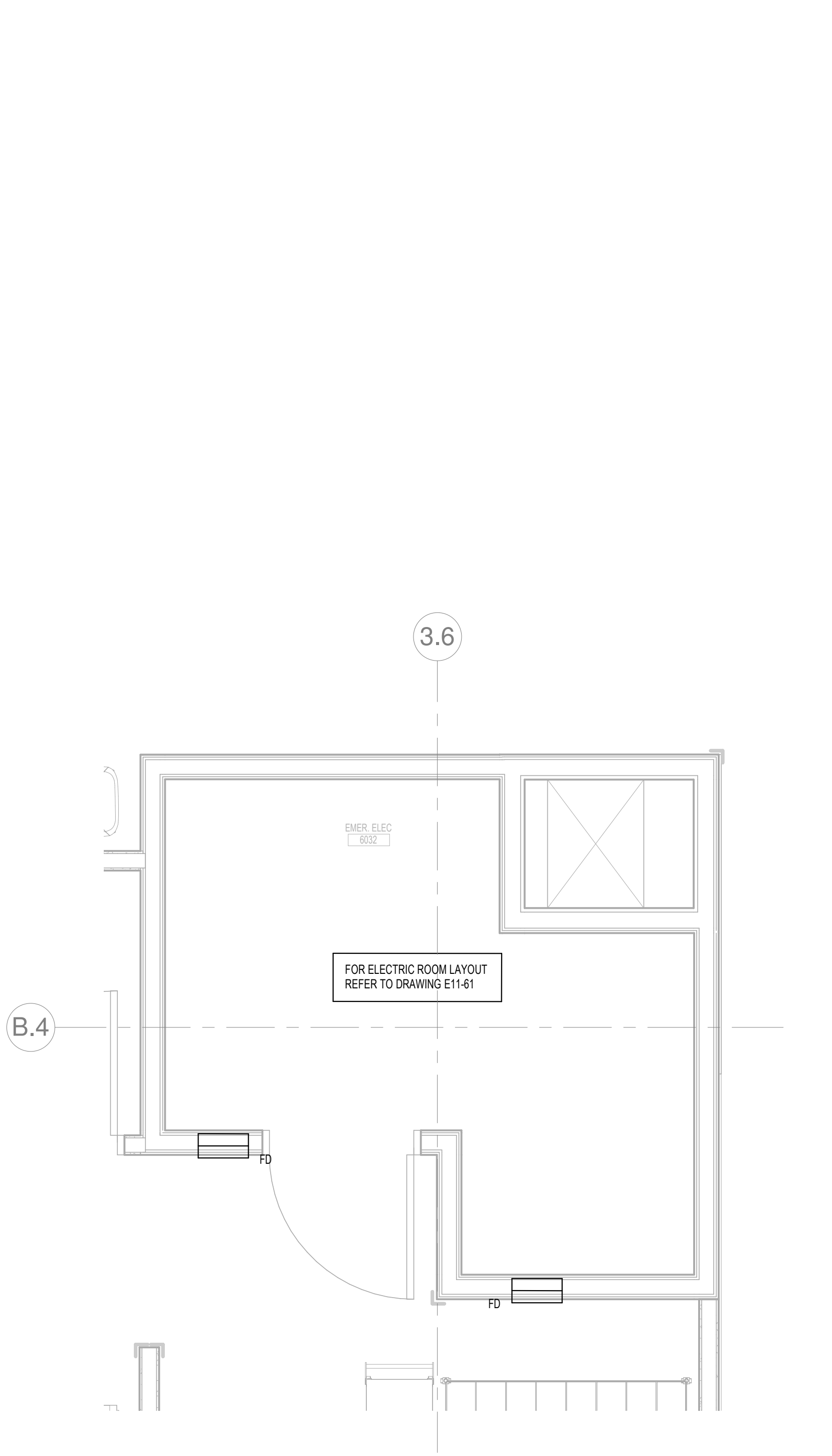

**6 LEVEL 6 EMERGENCY ELECTRIC ROOM SECTOR 1**  
 SCALE: 1/2" = 1'-0"

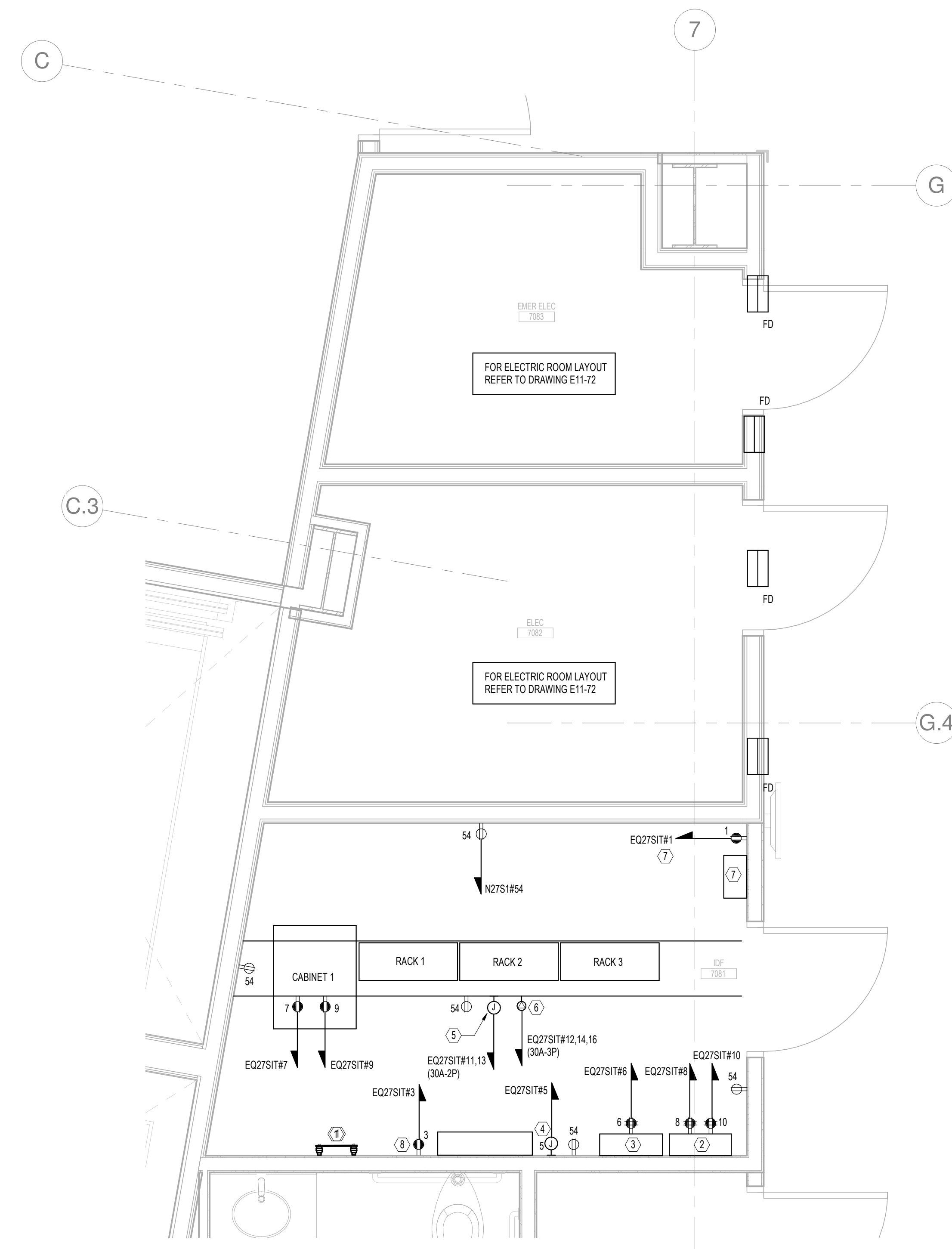

**1 LEVEL 7 ELECTRIC AND IDF ROOMS SECTOR 2**  
 SCALE: 1/2" = 1'-0"

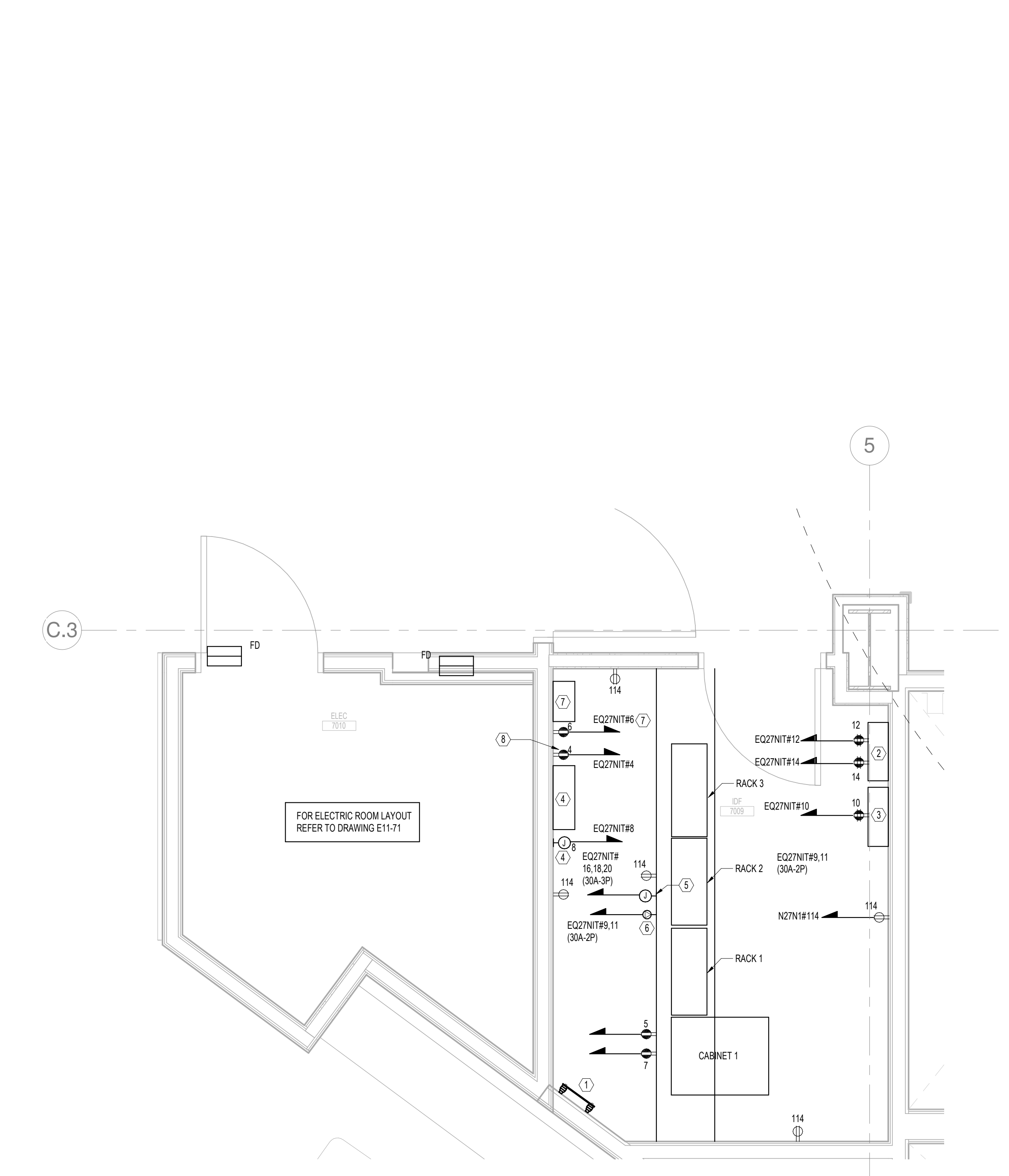

**2 LEVEL 7 ELECTRIC AND IDF ROOMS SECTOR 1**  
 SCALE: 1/2" = 1'-0"

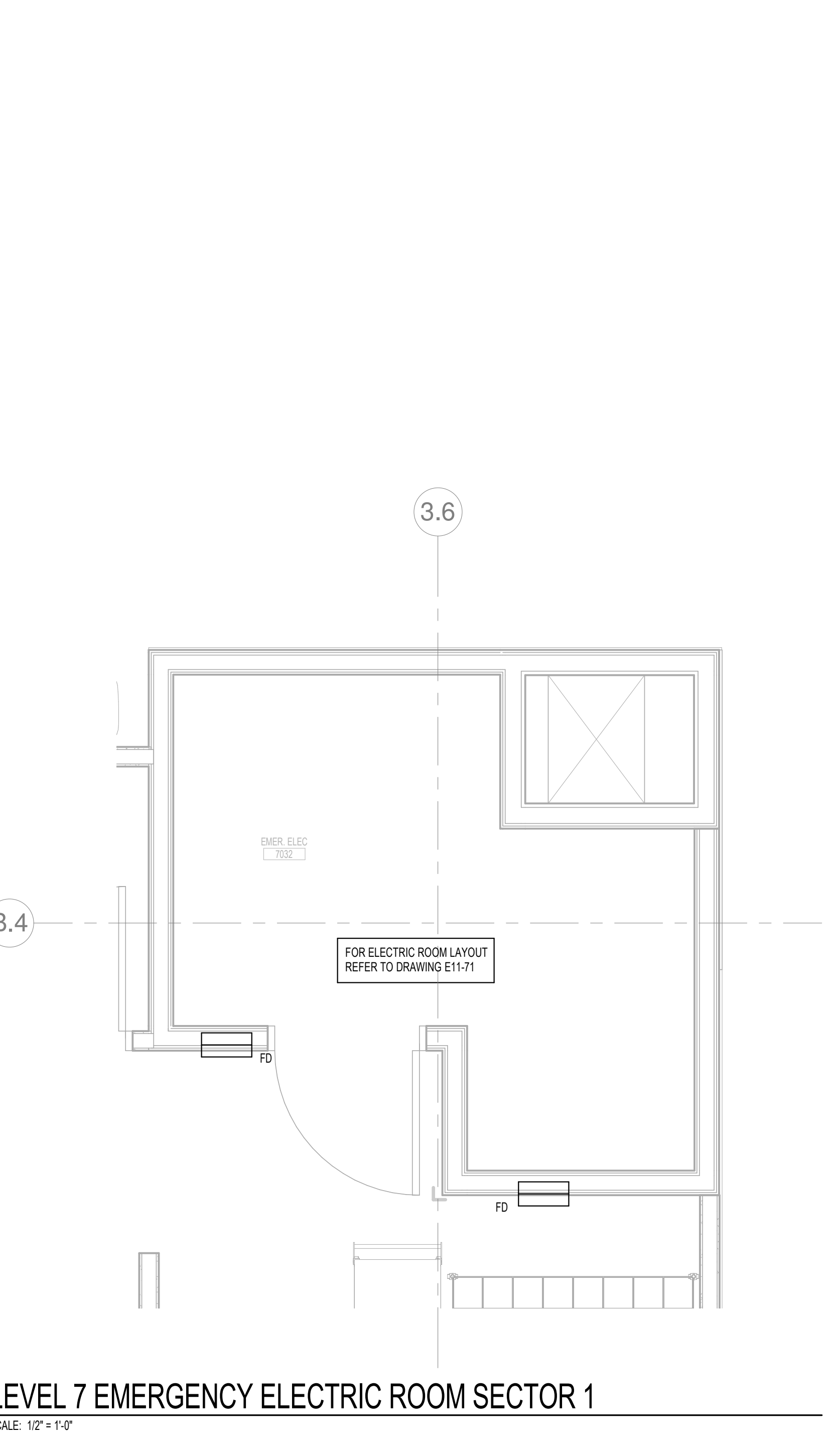

**3 LEVEL 7 EMERGENCY ELECTRIC ROOM SECTOR 1**  
 SCALE: 1/2" = 1'-0"