

**CONSULTANTS**

- CIVIL/LANDSCAPE ARCHITECT**  
 Sebago Technics  
 75 John Roberts Road, Suite  
 1A, South Portland, ME 04106
- STRUCTURAL/ENR/BUILDING ENVELOPE CONSULTANT**  
 Skidmore, Gumpertz & Hager Inc.  
 41 Seaver Street, Building 1, Suite 501,  
 Waltham, MA 02453
- MERFP ENGINEER/ CODE**  
 AKF Group LLC  
 99 Bedford Street, 2nd Floor, Boston, MA 02111
- CONSTRUCTION MANAGER**  
 Turner Construction  
 2 Seaport Lane, Suite 200, Boston, MA 02210
- ELEVATOR CONSULTANT**  
 VDA (Van Deusen & Associates)  
 101 Summer Street, 4th Floor, Boston MA  
 02110
- COIT ESTIMATOR**  
 D. G. Jones International  
 3 Baldwin Green Common, Suite 202, Woburn, MA 01801

**PROJECT TITLE**

**East Tower 6 & 7  
 Addition**  
 22 Bramhall Street  
 Portland, ME 04102

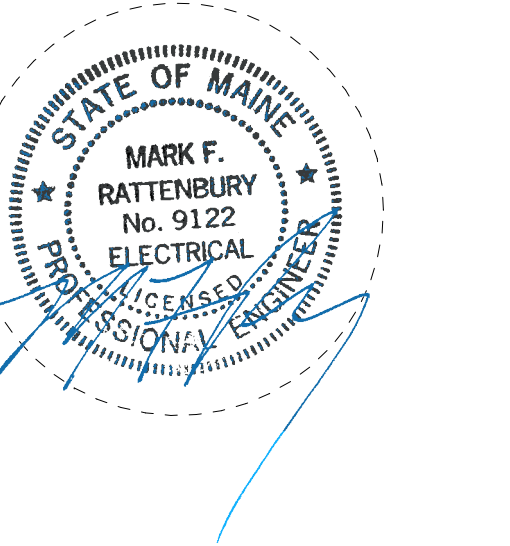

**KEY PLANS**

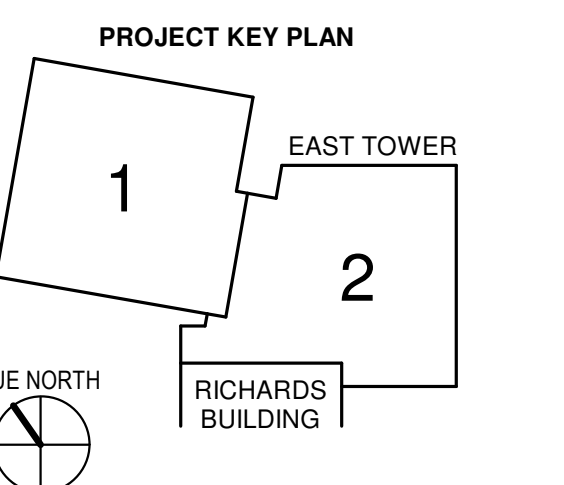

**OVERALL KEY PLAN**

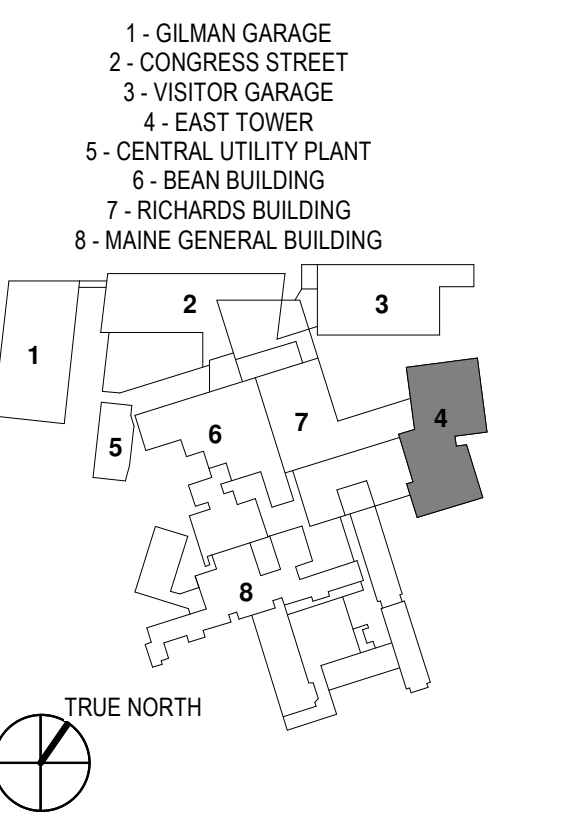

**CONSTRUCTION DOCUMENTS**  
 JANUARY 28, 2018

NO	ISSUE	DATE
1	ADDENDUM NO. 1	03/22/18

Job Number: B150312-000  
 Drawn: MMS  
 Checked: MFR  
 Approved: MFR

**ELECTRICAL  
 DETAILS**

**SHEET NUMBER**

**E00-21**

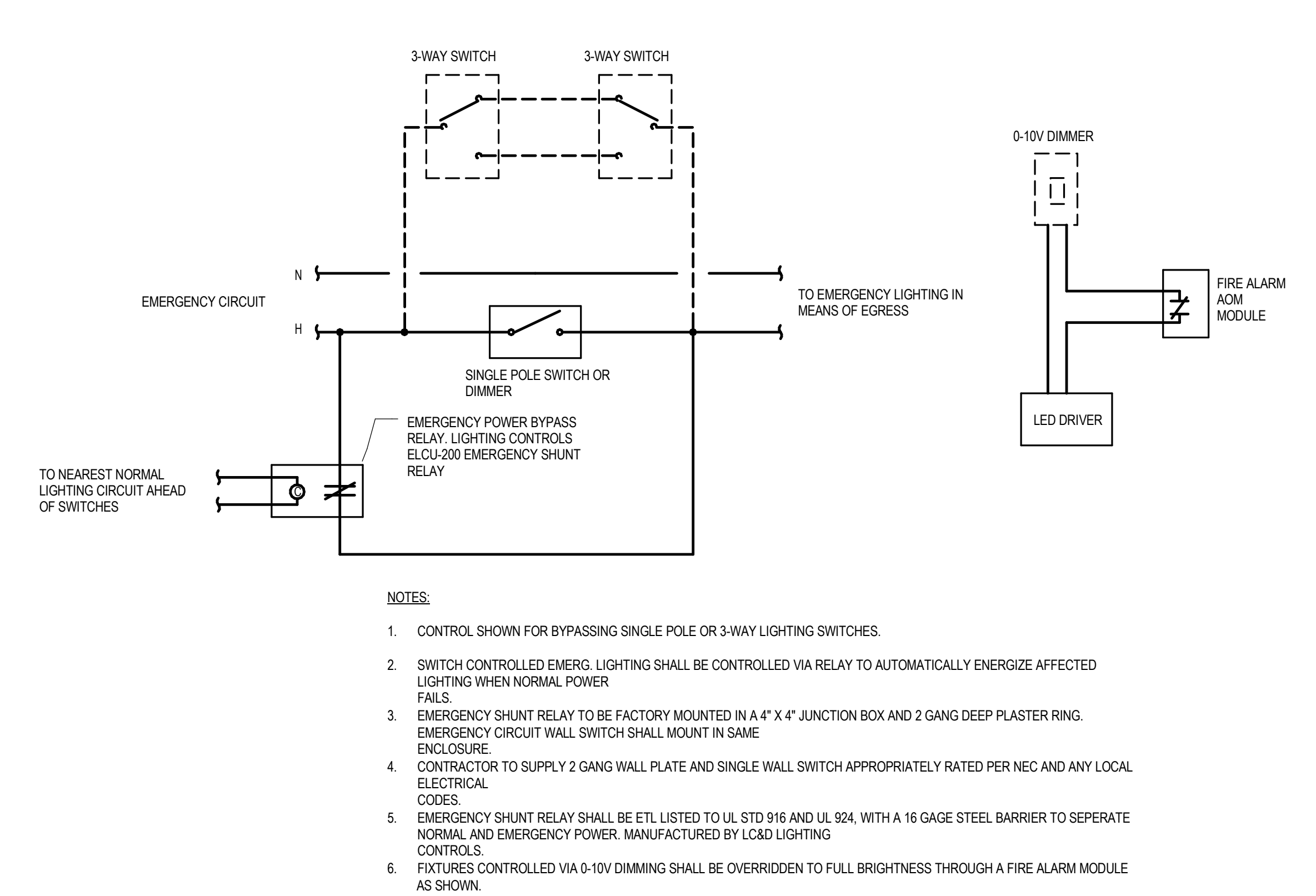

- NOTES:**
- CONTROL SHOWN FOR BYPASSING SINGLE POLE OR 3-WAY LIGHTING SWITCHES.
  - SWITCH CONTROLLED EMERG. LIGHTING SHALL BE CONTROLLED VIA RELAY TO AUTOMATICALLY ENERGIZE AFFECTED LIGHTING UPON NORMAL POWER FAILS.
  - EMERGENCY SHUNT RELAY TO BE FACTORY MOUNTED IN A 4" X 4" JUNCTION BOX AND 2 GANG DEEP PLASTER RING. EMERGENCY CIRCUIT WALL SWITCH SHALL MOUNT IN SAME ENCLOSURE.
  - CONTRACTOR TO SUPPLY 2 GANG WALL PLATE AND SINGLE WALL SWITCH APPROPRIATELY RATED PER NEC AND ANY LOCAL ELECTRICAL CODES.
  - EMERGENCY SHUNT RELAY SHALL BE ETL LISTED TO UL STD 916 AND UL 924, WITH A 16 GAGE STEEL BARRIER TO SEPERATE NORMAL AND EMERGENCY POWER. MANUFACTURED BY LCOAD LIGHTING CONTROLS.
  - FIXTURES CONTROLLED VIA 0-10V DIMMING SHALL BE OVERRIDDEN TO FULL BRIGHTNESS THROUGH A FIRE ALARM MODULE AS SHOWN.

**3 TYPICAL EMERGENCY LIGHTING BYPASS AND FIRE ALARM OVERRIDE CONTROL DETAIL**  
 SCALE: NTS

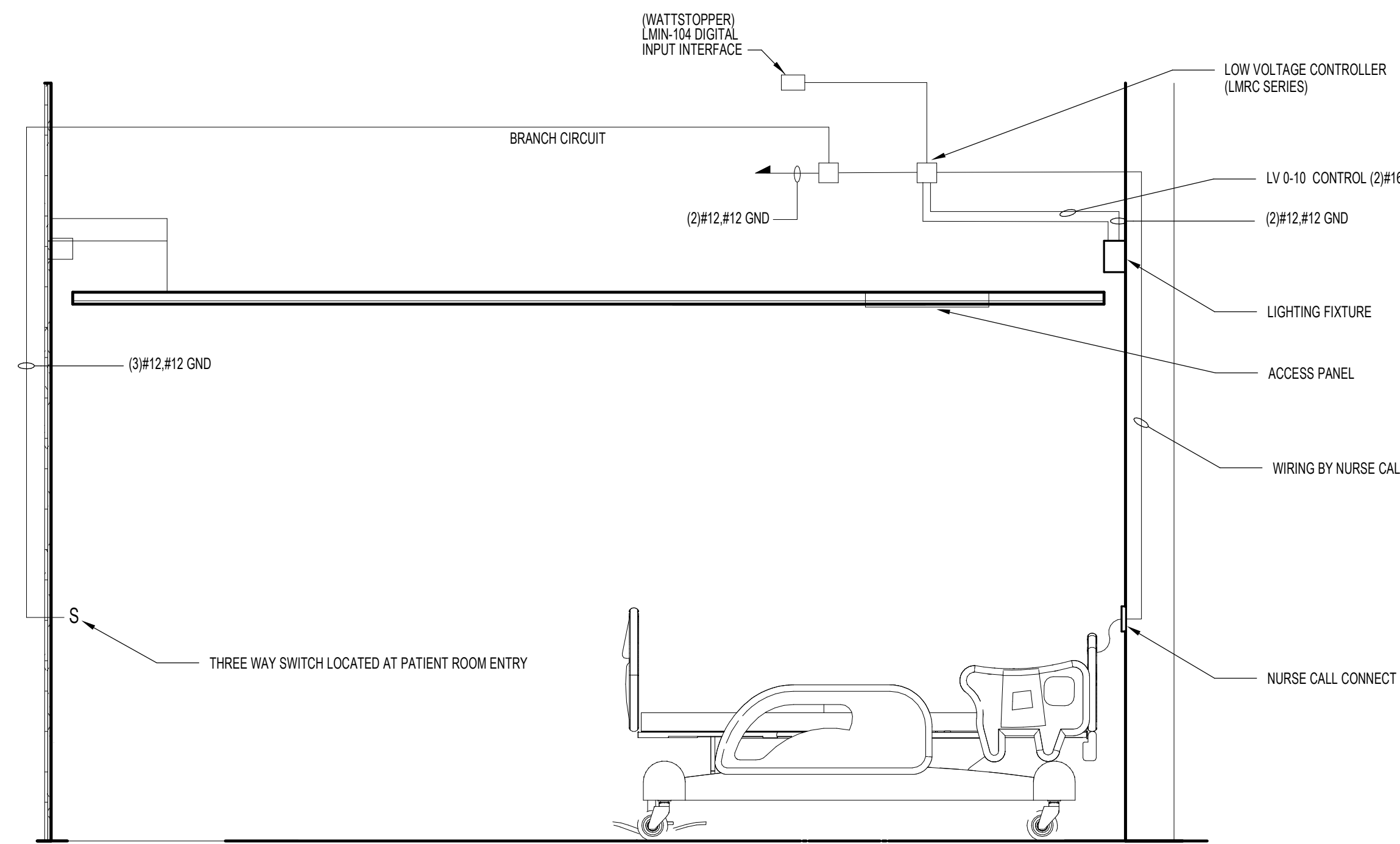

**2 PATIENT BED LIGHTING CONTROL WIRING DETAIL**  
 SCALE: NTS

NOTE:  
 LOW VOLTAGE CONTROLLER SHALL BE LVC-2000-XXX BY CURBELL MEDICAL.

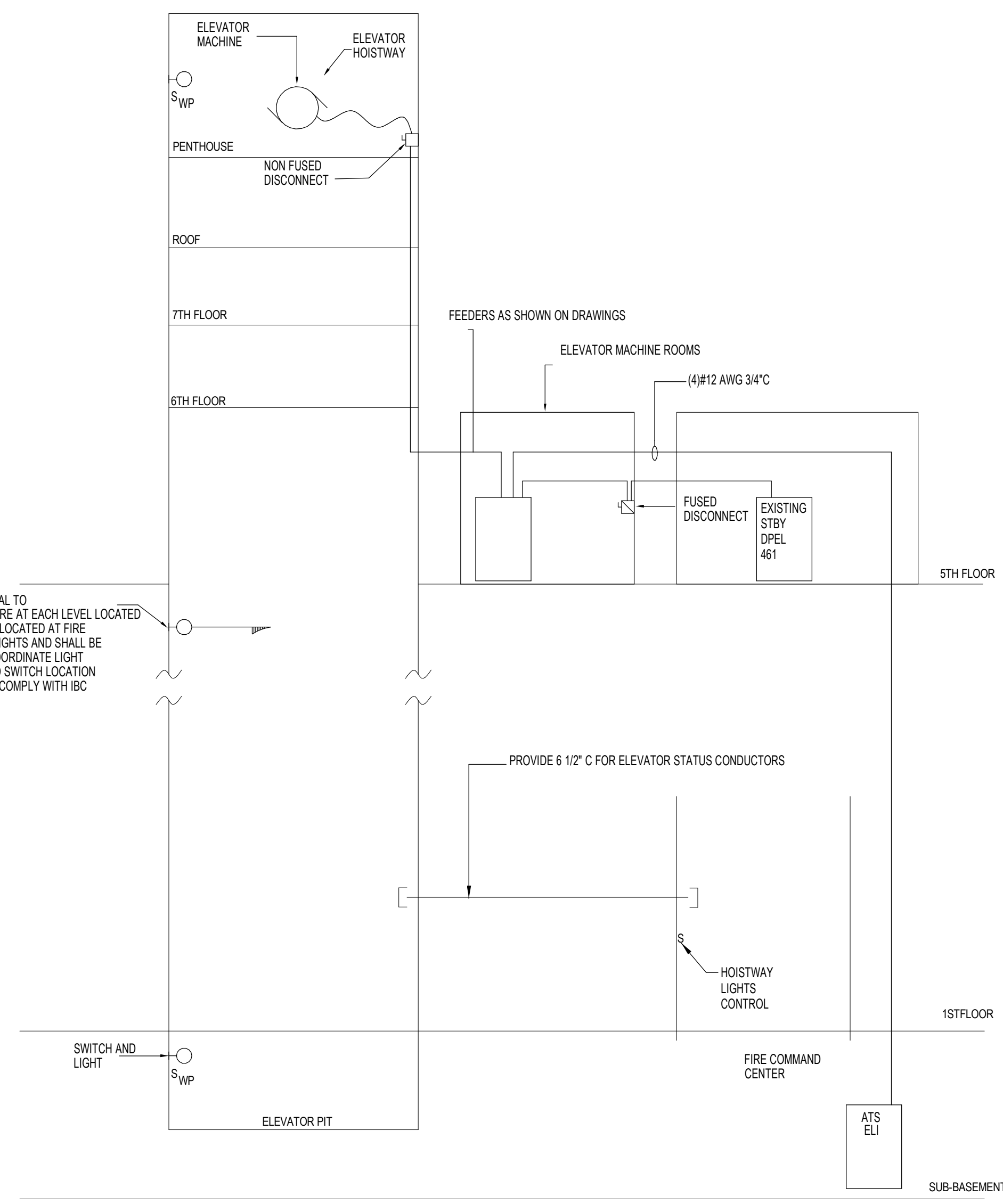

**1 GEN ELEVATOR WIRING DETAIL**  
 SCALE: NTS

- NOTES:**
- FOR ALL ELEVATORS PROVIDE CONDUCTORS SHOWN BETWEEN AUTOMATIC TRANSFER SWITCH AND ELEVATOR CONTROLLER.
  - REFER TO ARCHITECTURAL PLANS FOR EXACT LOCATION OF ELEVATOR MACHINE CONTROL ROOMS.

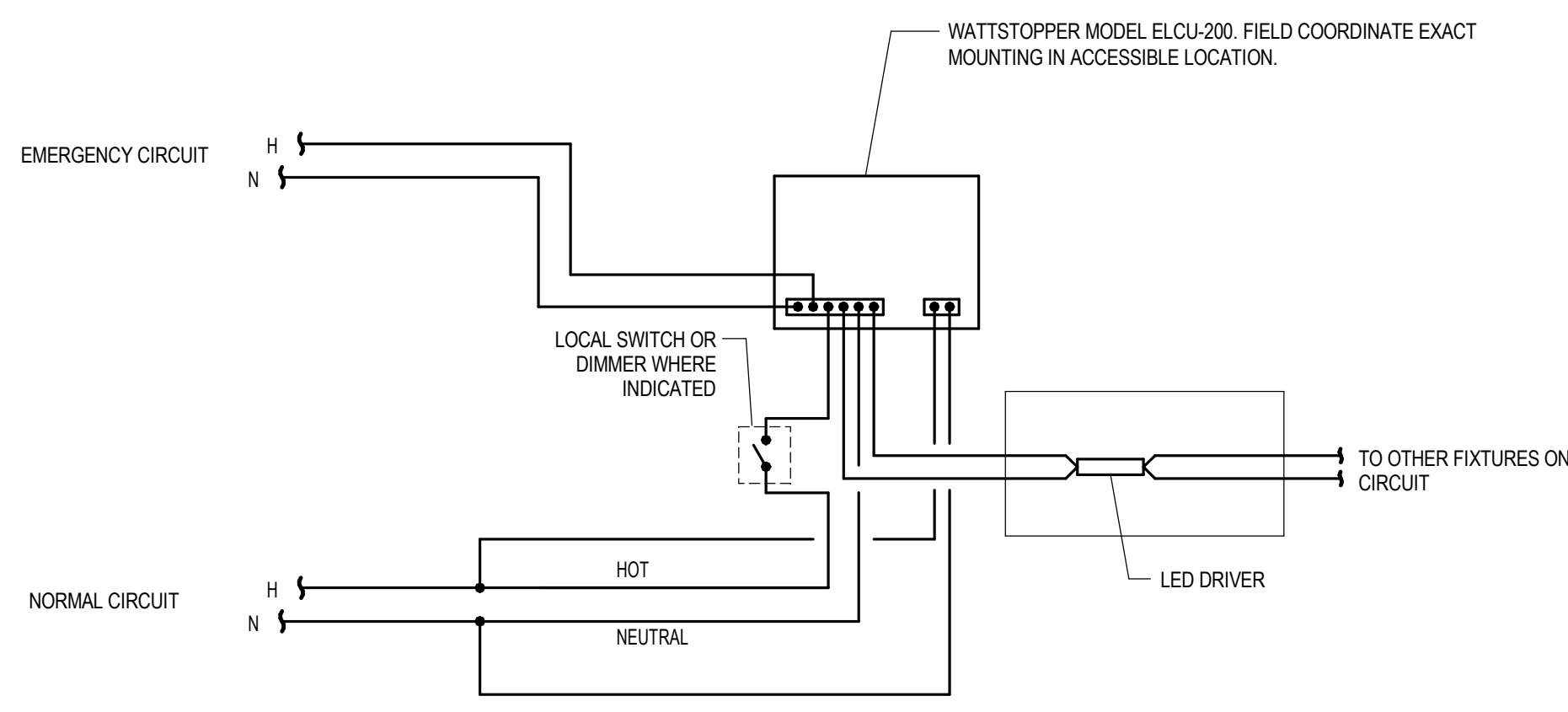

- NOTES:**
- CONTROL SHOWN FOR BYPASSING SINGLE POLE OR 3-WAY LIGHTING SWITCHES.
  - EMERGENCY LIGHTING SHALL BE CONTROLLED VIA AUTOMATIC LOAD CONTROL RELAY TO AUTOMATICALLY ENERGIZE AFFECTED LIGHTING UPON NORMAL POWER FAILS.
  - AUTOMATIC LOAD CONTROL RELAY (ALCR) TO BE FACTORY MOUNTED IN A 4" X 4" JUNCTION BOX AND 2 GANG DEEP PLASTER RING. MOUNT ALOR IN SEPARATE ENCLOSURE ADJACENT TO SWITCH SERVICE AREA.
  - EMERGENCY LIGHTING CONTROL RELAY SHALL BE ETL LISTED TO UL STD 916 AND UL 924, WITH A 16 GAGE STEEL BARRIER TO SEPERATE NORMAL AND EMERGENCY POWER.

**4 TYPICAL EMERGENCY LIGHTING AUTOMATIC LOAD CONTROL DETAIL**  
 SCALE: NTS

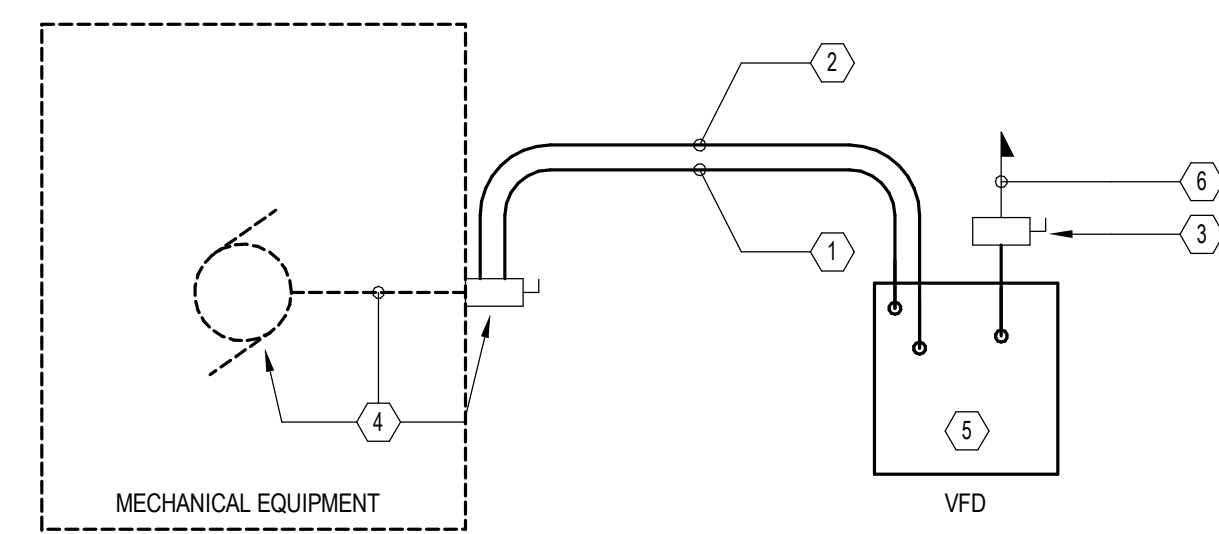

- DETAIL NOTES:**
- IN ADDITION TO POWER WIRING E.C. TO PROVIDE 3/4" C WITH CONTROL WIRING BETWEEN MOTOR DISCONNECT AND VFD TO SIGNAL DISCONNECT SWITCH OPEN STATUS TO VFD.
  - ELECTRICAL WIRING BETWEEN VFD AND MOTOR DISCONNECT TO BE PROVIDED BY E.C. REFER TO ELECTRICAL SCHEDULES DRAWINGS FOR ADDITIONAL INFORMATION.
  - COORDINATE WITH VFD MANUFACTURER FOR VFD DISCONNECT SWITCH. PROVIDE EXTERNAL DISCONNECT SWITCH IF VFD DOES NOT HAVE SERVICE DISCONNECT.
  - MECHANICAL UNIT DISCONNECT SWITCH, INTERNAL MOTOR AND WIRING BETWEEN UNIT DISCONNECT AND MOTOR IS PROVIDED BY MECHANICAL EQUIPMENT MANUFACTURER. PROVIDE DISCONNECT SWITCH WITH CONTACT HARDWARE TO SIGNAL OPEN POSITION.
  - VFD IS WIRED BY E.C. AND FURNISHED BY HVAC CONTRACTOR. COORDINATE WITH HVAC CONTRACTOR FOR EXACT VFD INFORMATION PRIOR TO PURCHASE.
  - REFER TO ELECTRICAL SCHEDULES FOR WIRING INFORMATION.

**5 TYPICAL MECHANICAL EQUIPMENT WITH VFD WIRING DETAIL**  
 SCALE: NTS

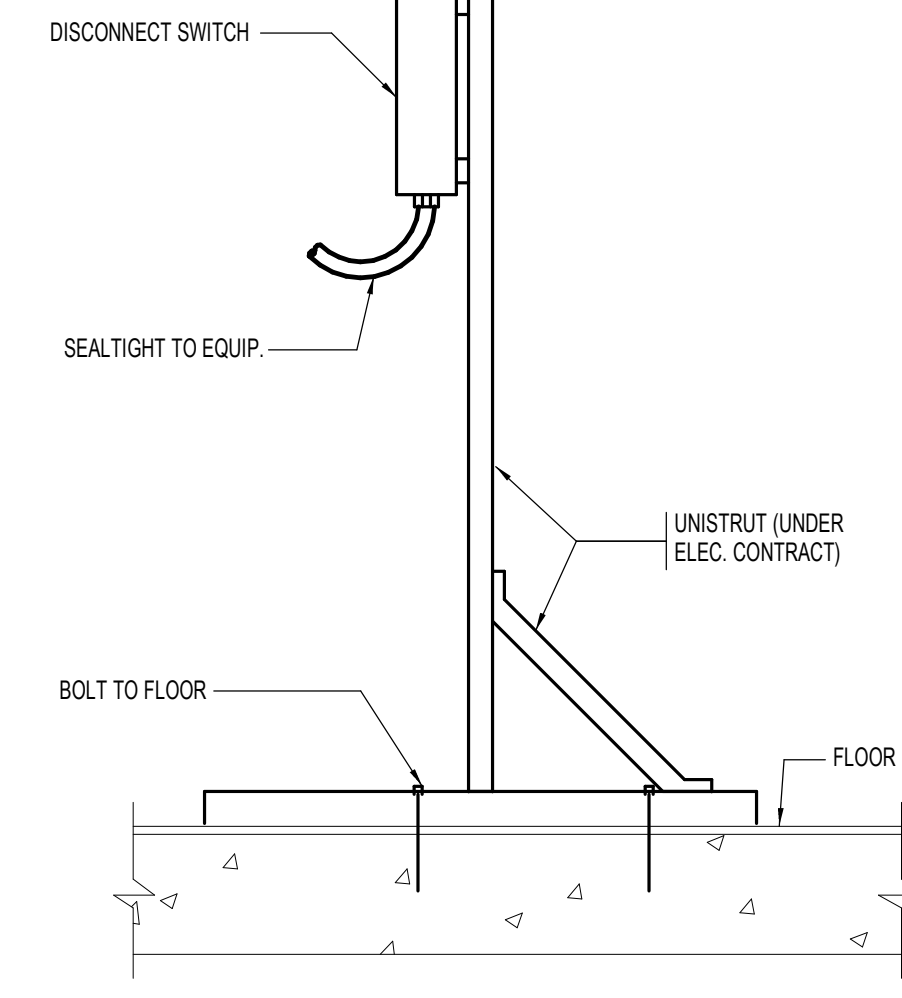

**6 TYPICAL METHOD OF MOUNTING FLOOR MOUNTED DISCONNECT SWITCHES**  
 SCALE: NTS

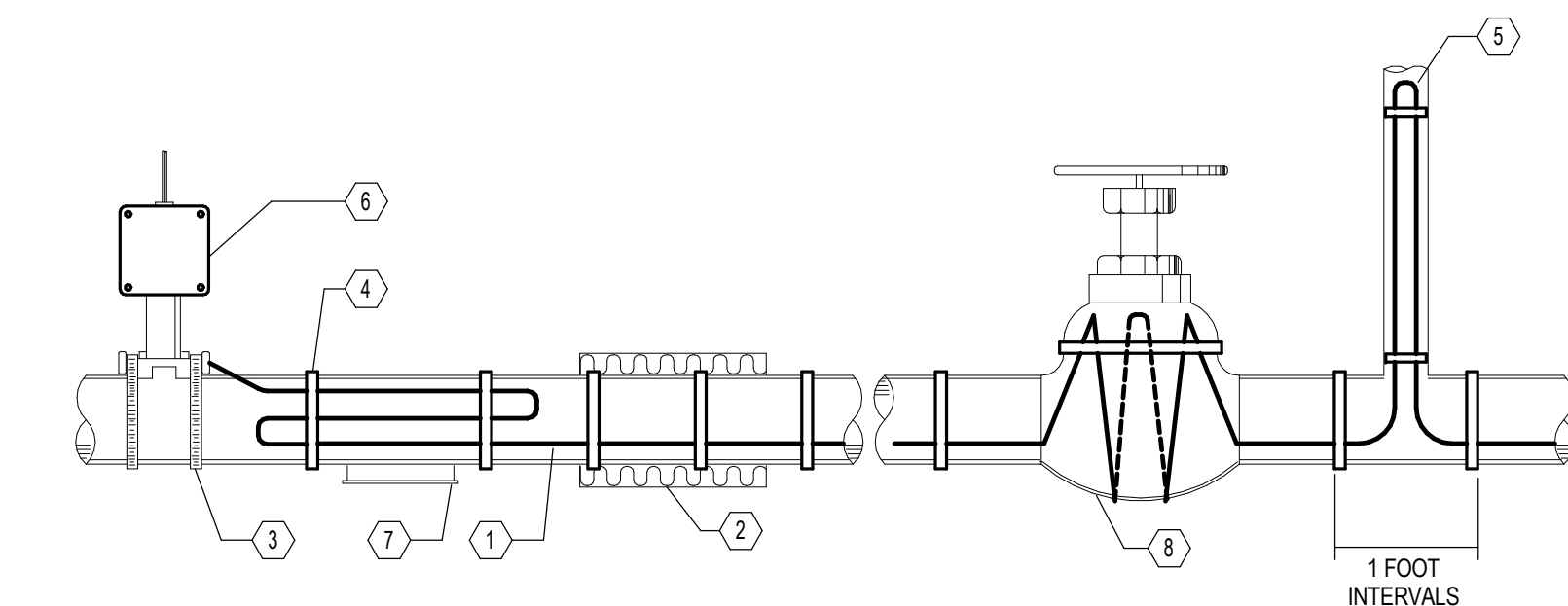

- KEY NOTES:**
- HEATING CABLE.
  - INSULATION.
  - STAINLESS STEEL CLAMPS.
  - FIBERGLASS TAPE.
  - HEATING CABLE LOOP.
  - POWER CONNECTION KIT WITH CABLE POWER SEAL KIT.
  - PIPE SUPPORT.
  - VALVE.
- NOTE:**
- HEATING CABLE POWER CONNECTIONS AND END SEALS ARE REQUIRED FOR EACH HEATER.

**7 HEAT TRACING DETAIL**  
 SCALE: NTS

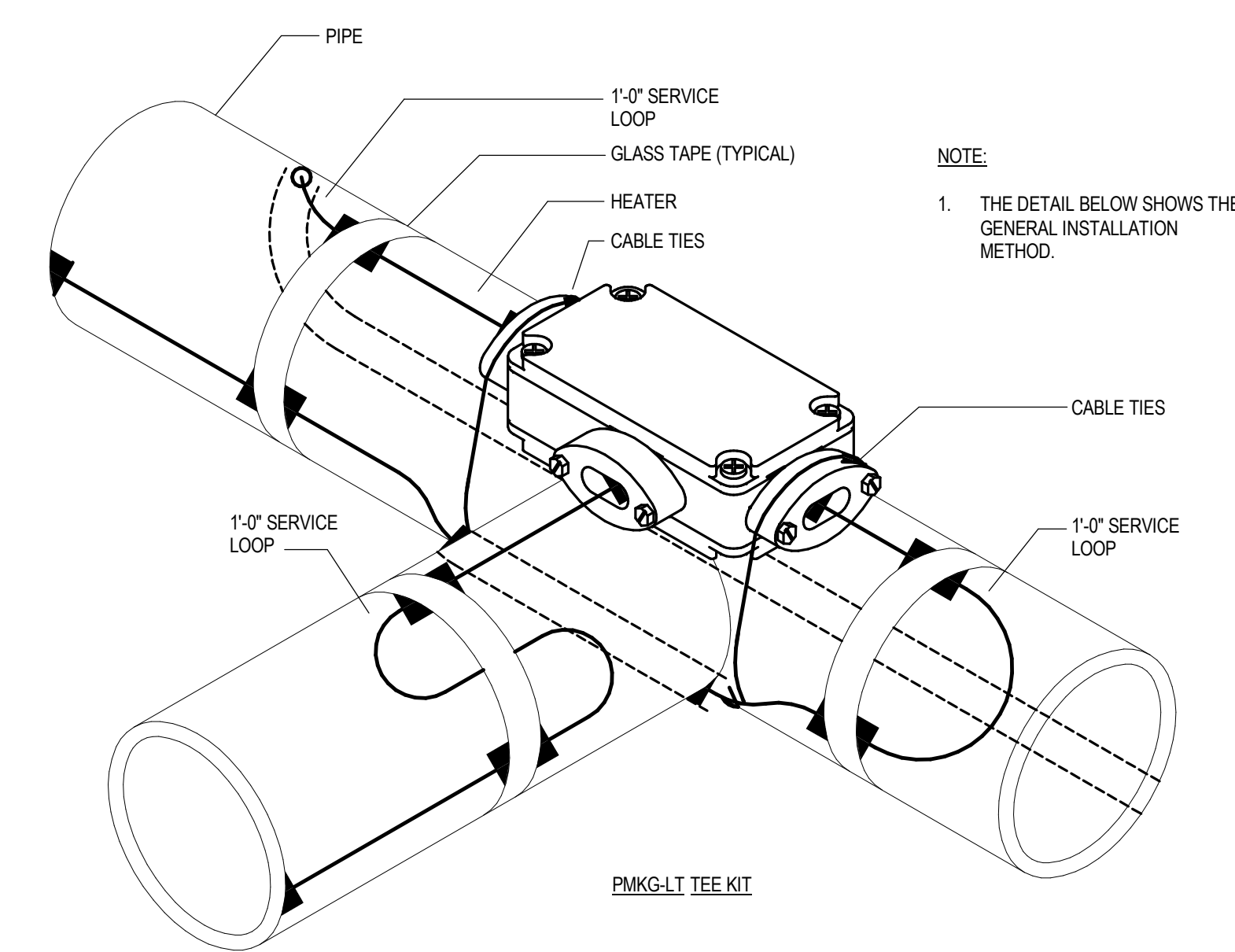

**8 POWER CONNECTION**  
 SCALE: NTS

**NOTE:**

- THE DETAIL BELOW SHOWS THE GENERAL INSTALLATION METHOD.