

CONSULTANTS

- CIVIL/LANDSCAPE ARCHITECT  
**Sebago Technics**  
75 John Roberts Road, Suite  
1A, South Portland, ME 04106
- STRUCTURAL/ENR/BUILDING ENVELOPE CONSULTANT  
**Simpson Gumpertz & Heger Inc.**  
41 Seyon Street, Building 1, Suite 501,  
Waltham, MA 02453
- MEP/ELECTRICAL ENGINEER  
**AKF Group LLC**  
99 Bedford Street, 2nd Floor, Boston MA 02111
- CONSTRUCTION MANAGER  
**Turner Construction**  
2 Seaport Lane, Suite 200, Boston, MA 02210
- ELEVATOR CONSULTANT  
**VDA (Van Deusen & Associates)**  
101 Summer Street, 4th Floor, Boston MA  
02110
- COST ESTIMATOR  
**D. G. Jones International**  
3 Baldwin Green Common, Suite 202, Woburn, MA 01801

PROJECT TITLE

**East Tower 6 & 7  
Addition**  
22 Bramhall Street  
Portland, ME 04102

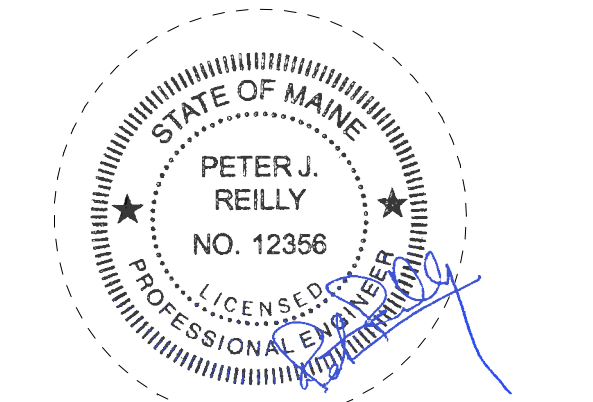

KEY PLANS

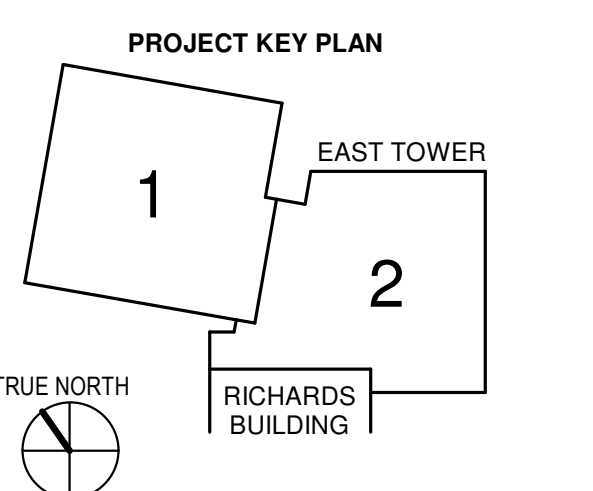

- OVERALL KEY PLAN
- GILMAN GARAGE
  - CONGRESS STREET
  - VISITOR GARAGE
  - EAST TOWER
  - CENTRAL UTILITY PLANT
  - BEAN BUILDING
  - RICHARDS BUILDING
  - MAINE GENERAL BUILDING

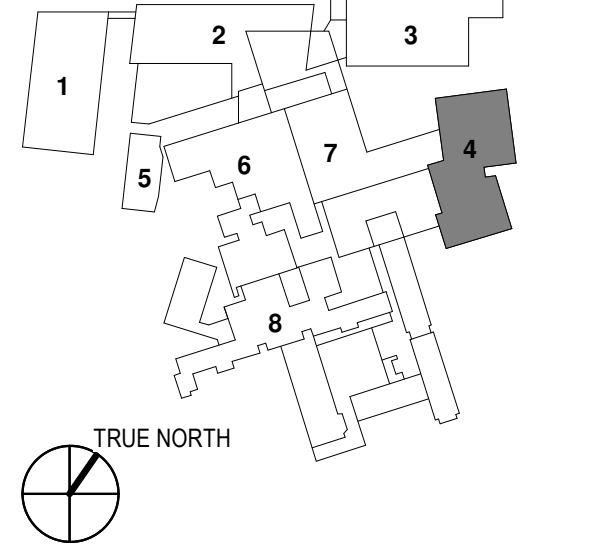

CONSTRUCTION DOCUMENTS  
JANUARY 28, 2018

NO.	ISSUE	DATE
Job Number	B150312-000	
Drawn	DGC	
Checked	PLR	
Approved	PLR	

TITLE  
**FIRE PROTECTION  
RISER DIAGRAM**

SHEET NUMBER

**F20-01**

