

- 1- GILMAN GARAGE
2- CONGRESS STREET APPROACH GARAGE
3- VISITOR GARAGE
4- EAST TOWER
5- CENTRAL UTILITY PLANT
6- BEAN BUILDING
7- RICHARDS BUILDING
8- MAINE GENERAL BUILDING

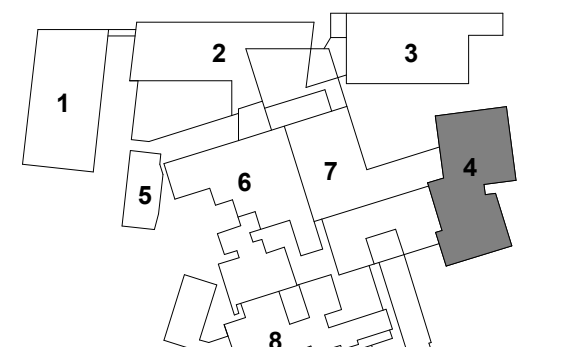

Revision table with columns: NO, ISSUE, DATE. Includes entries for Drawn, Checked, and Approved.

TITLE
STRUCTURAL TESTS AND INSPECTIONS

SHEET NUMBER
S00-02

Copyright © 2016 Perkins+Will

STRUCTURAL STEEL-IBC 2015 SECTION 1705.2. Table with columns: ITEM, AGENCY, INSPECTION FREQUENCY, SCOPE. Includes rows for FABRICATOR CERTIFICATION, MATERIAL CERTIFICATION, BOLTING, WELDING, BASE-PLATE GROUING AND ANCHOR RODS, STRUCTURAL FRAMING, DETAILS AND ASSEMBLIES, METAL DECK, FIELD-INSTALLED SHEAR CONNECTORS.

CAST-IN-PLACE CONCRETE-IBC 2015 SECTION 1705.3. Table with columns: ITEM, AGENCY, INSPECTION FREQUENCY, SCOPE. Includes rows for FORMWORK GEOMETRY, MIX DESIGN, MATERIAL CERTIFICATION, REINFORCEMENT INSTALLATION, WELDING OF REINFORCING, BATCHING PLANT, ANCHOR RODS, CONCRETE PLACEMENT, SAMPLING AND TESTING OF CONCRETE, CURING AND PROTECTION, IN SITU CONCRETE STRENGTH, LABORATORY EVALUATION OF CONCRETE STRENGTH, ADHESIVE DOWELS, EXPANSION ANCHORS.

POST-INSTALLED ADHESIVE ANCHORS-ACI 318 CHAPTER 17. Table with columns: ITEM, AGENCY, INSPECTION FREQUENCY, SCOPE. Includes rows for INSTALLER QUALIFICATIONS, ANCHOR INSTALLATION, ADHESIVE ANCHOR PROOF TESTING.

STATEMENT OF SPECIAL INSPECTIONS. Location: Portland, ME. Owner: Maine Medical Center. Design Professional: John H. Thomsen IV, P.E. Includes project description and inspection schedule.

SCHEDULE OF INSPECTION AND TESTING AGENCIES. Table with columns: SPECIAL INSPECTION AGENCIES, FIRM, ADDRESS, TELEPHONE #. Lists agencies like Simpson Gumpertz & Heger, Inc. and American Concrete Institute.

STATEMENT OF CONTRACTOR'S RESPONSIBILITY. Text detailing contractor obligations for construction and fabrication of main and/or secondary steel.

QUALIFICATIONS OF INSPECTORS AND TESTING TECHNICIANS. Table listing qualifications for various roles like Engineer, Welding Inspector, etc.

COLD-FORMED STEEL FRAMING-IBC 2015 SECTION 1705.11.2. Table with columns: ITEM, AGENCY, INSPECTION FREQUENCY, SCOPE. Includes rows for FABRICATOR'S QUALITY CONTROL PROCEDURES, MEMBER SIZES, MATERIAL THICKNESS, MATERIAL PROPERTIES, MECHANICAL CONNECTIONS, WELDING, FRAMING DETAILS AND TRUSSES.

REFERENCES. Table with columns: CODE/STANDARD, TITLE. Lists standards like ACI 308-10, ACI 318-15, ASTM A568-14, etc.

Vertical text on the left margin: 3/20/2016 9:16:16 AM I:\BOS\Projects\2015\200603\MAIN\22\Drawings\Working_Sets\Rev\LOCAL\USERS\JHE\REVIEWS\2015\MHC-EAST TOWER-0071-STRUCT-REVIEWS.rvt