

- 1 - GILMAN GARAGE
- 2 - CONGRESS STREET
- 3 - VISITOR GARAGE
- 4 - EAST TOWER
- 5 - CENTRAL UTILITY PLANT
- 6 - BEAN BUILDING
- 7 - RICHARDS BUILDING
- 8 - MAINE GENERAL BUILDING

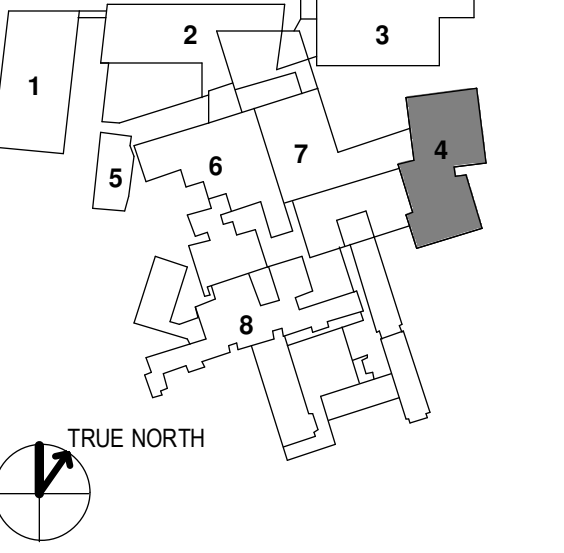

NO	ISSUE	DATE
1	ADDENDUM NO. 1	3/22/18

Job Number: 152181.000
Drawn: TEAM
Checked: JK
Approved: JK

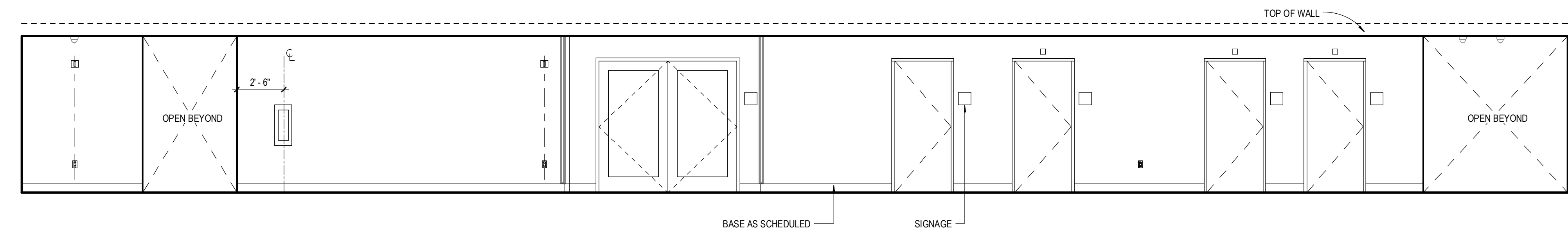

8 WEST CORRIDOR - WEST INTERIOR ELEVATION 1B SECTOR 2
1/4" = 1'-0"

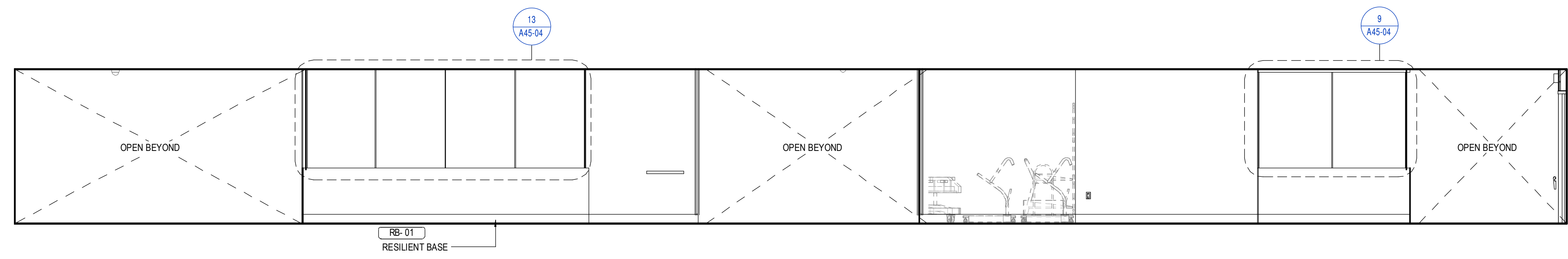

7 WEST CORRIDOR - EAST INTERIOR ELEVATION 1A SECTOR 2
1/4" = 1'-0"

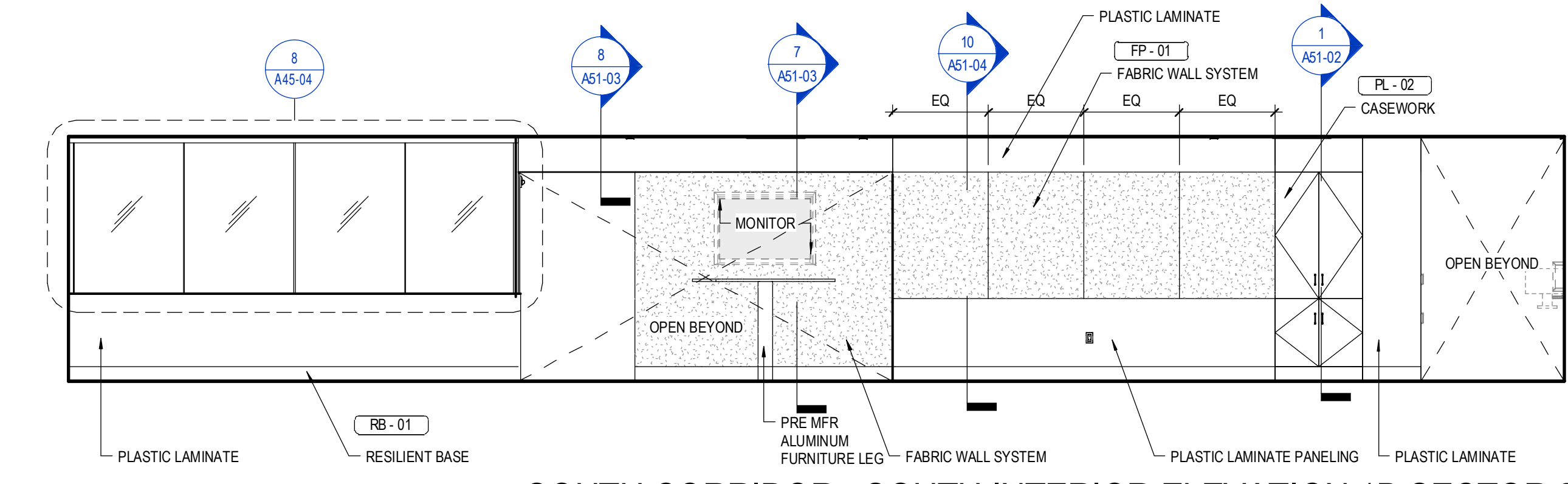

6 SOUTH CORRIDOR - SOUTH INTERIOR ELEVATION 1B SECTOR 2
1/4" = 1'-0"

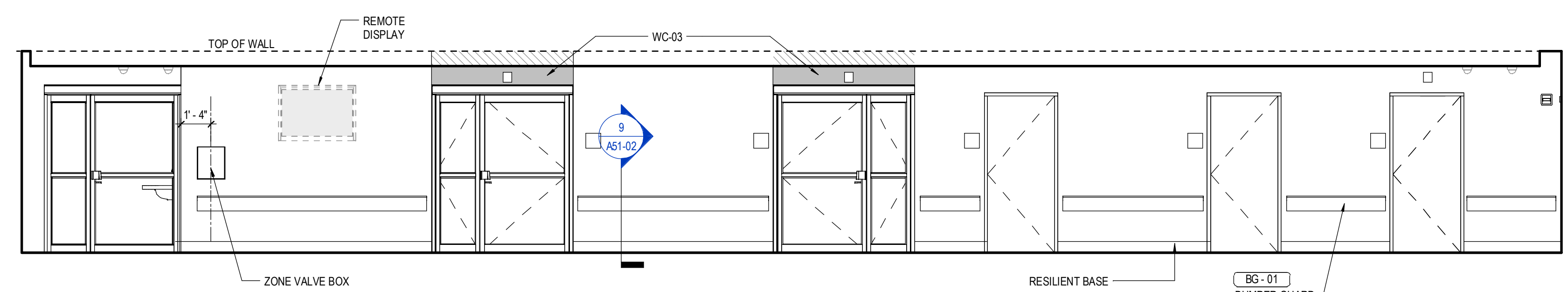

5 SOUTH CORRIDOR - NORTH INTERIOR ELEVATION 1A SECTOR 2
1/4" = 1'-0"

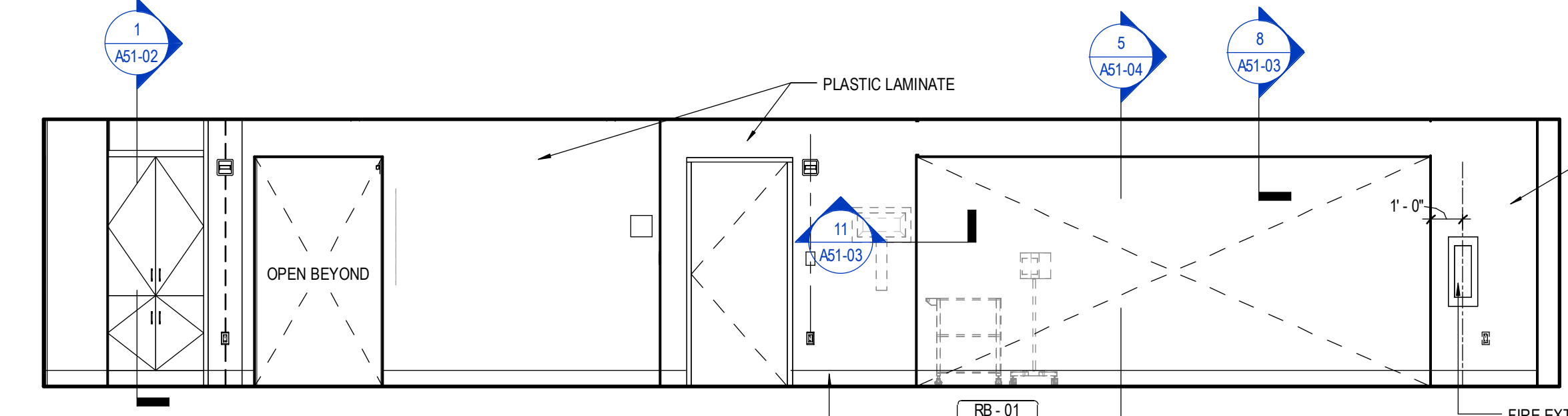

4 EAST CORRIDOR - WEST INTERIOR ELEVATION 1B SECTOR 2
1/4" = 1'-0"

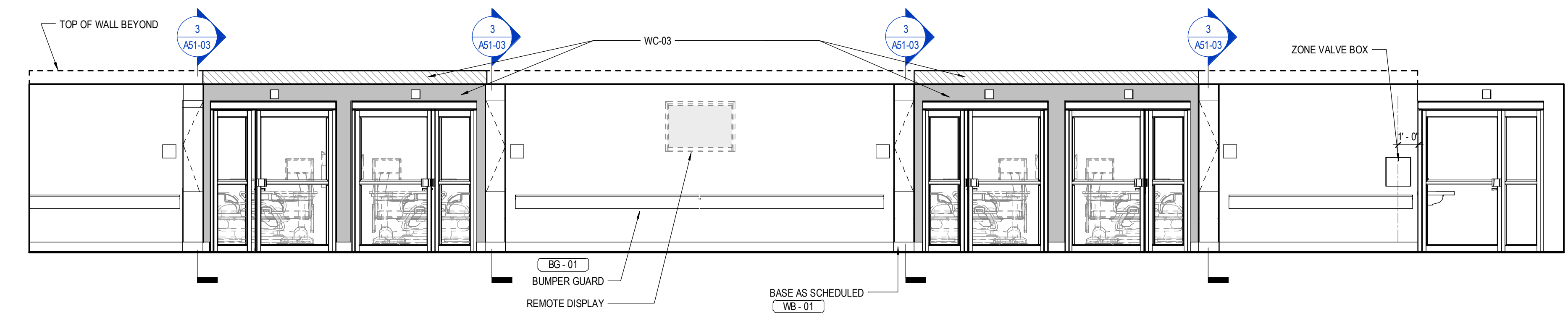

3 EAST CORRIDOR - EAST INTERIOR ELEVATION 1B SECTOR 2
1/4" = 1'-0"

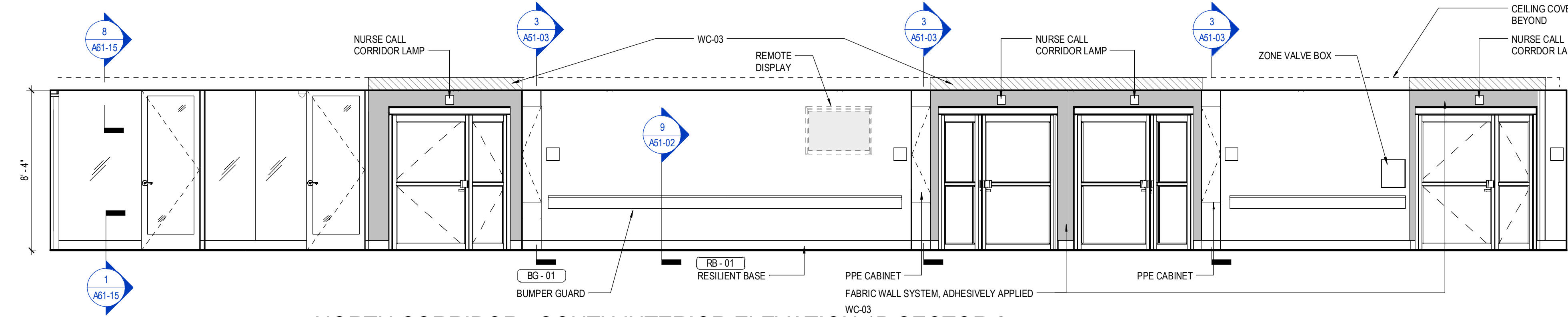

2 NORTH CORRIDOR - SOUTH INTERIOR ELEVATION 1B SECTOR 2
1/4" = 1'-0"

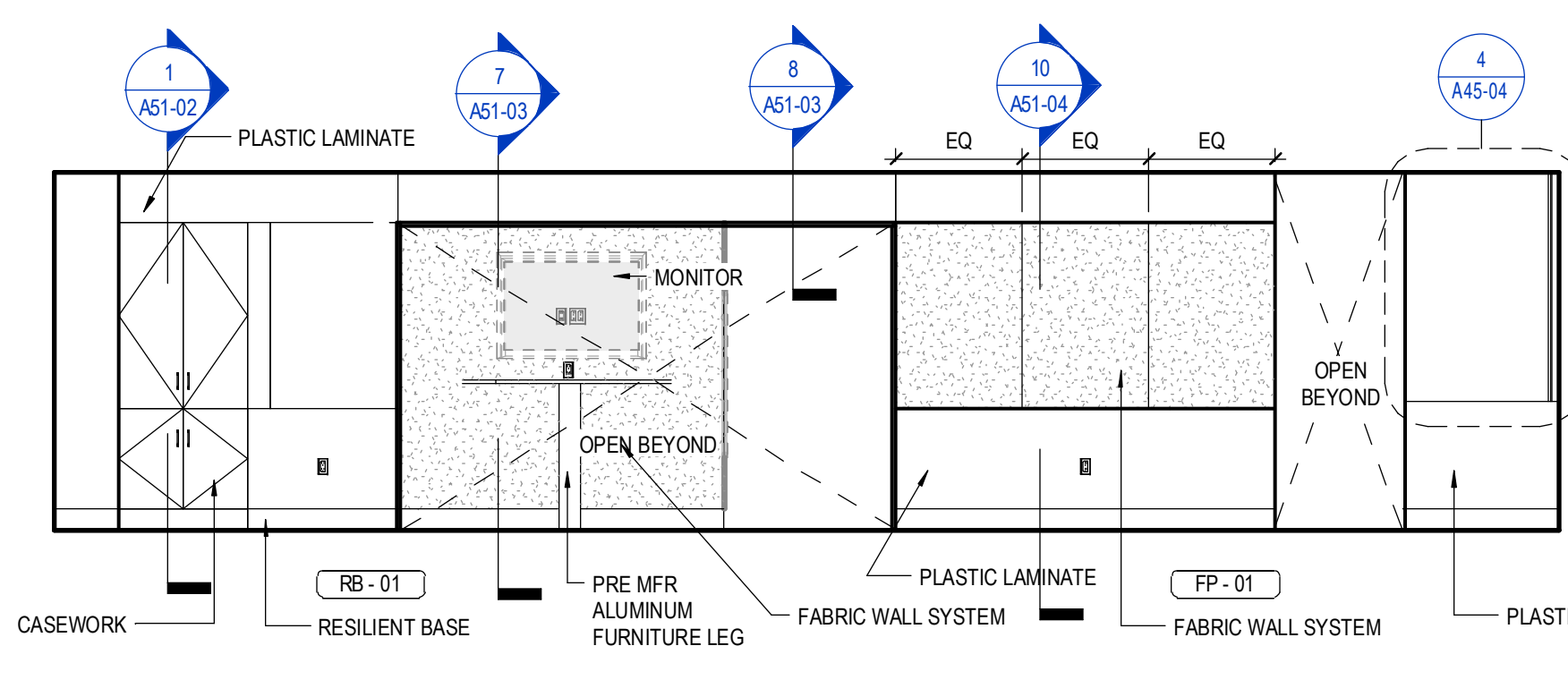

1 NORTH CORRIDOR - NORTH INTERIOR ELEVATION 1A SECTOR 2
1/4" = 1'-0"

3/20/2018 5:27:04 PM
152181.MDC East Tower 6 & 7 (02) - 06sheet.rvt