

NOTES

1. PROVIDE LUMINOUS EGRESS PATH MARKINGS AT STAIRTOWERS, ALL FLOORS

PERKINS + WILL

225 Franklin Street, Suite 1100
Boston, MA 02110
617.478.0300
617.478.0301
www.perkinswill.com

CLIENT

Maine Medical Center
MaineHealth

22 Bramhall Street
Portland ME 04102

CONSULTANTS

CVL / LANDSCAPE ARCHITECT
Sebago Technics
75 John Roberts Road, Suite
1A, South Portland ME 04106

STRUCTURAL ENGR. BUILDING ENVELOPE CONSULTANT
Stinson Gumpertz & Hagen Inc.
41 Seven Street, Building 1, Suite 500,
Waltham MA 02453

MERFP ENGINEER CODE
AKF Group LLC
99 Bedford Street, 2nd Floor, Boston MA 02111

CONSTRUCTION MANAGER
Turner Construction
2 Seaport Lane, Suite 200, Boston MA 02210

ELEVATOR CONSULTANT
VDA (Van Dusen & Associates)
101 Summer Street, 4th Floor, Boston MA
02110

COST ESTIMATOR
D. G. Jones International
3 Baldwin Green Common, Suite 202, Woburn MA 01801

PROJECT TITLE

**East Tower 6 & 7
Addition**
22 Bramhall Street
Portland ME 04102

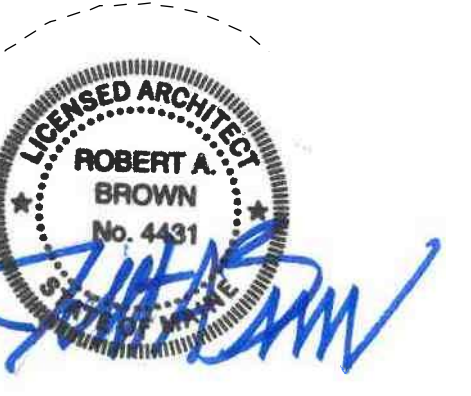

KEY PLANS

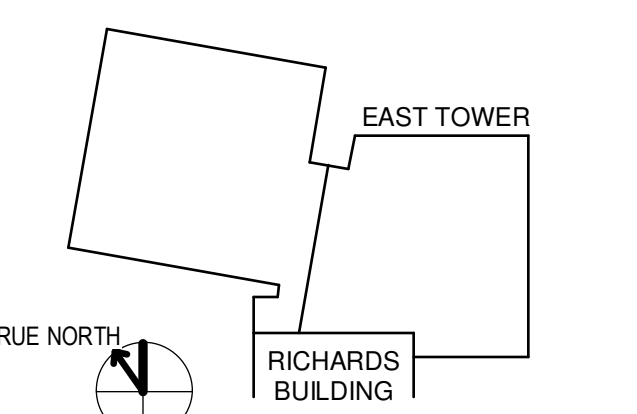

- OVERALL KEY PLAN**
- 1 - GILMAN GARAGE
 - 2 - CONGRESS STREET
 - 3 - VISITOR GARAGE
 - 4 - EAST TOWER
 - 5 - CENTRAL UTILITY PLANT
 - 6 - BEAN BUILDING
 - 7 - RICHARDS BUILDING
 - 8 - MAINE GENERAL BUILDING

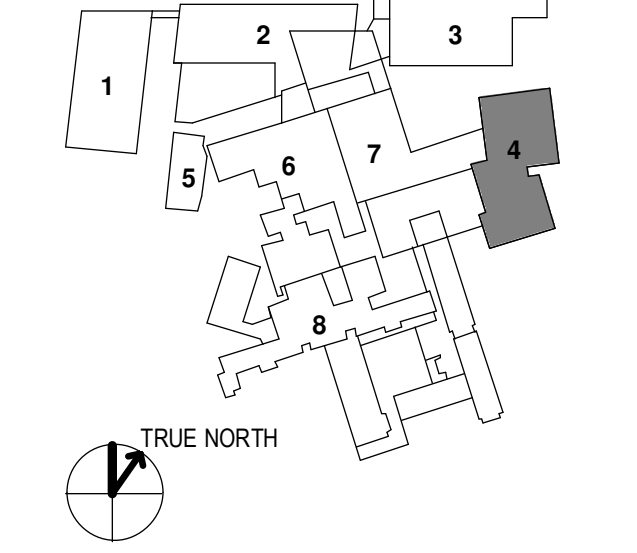

CONSTRUCTION DOCUMENTS
JANUARY 26, 2018

NO	ISSUE	DATE
1	ADDENDUM NO. 1	3/22/18

Job Number: 152181.000
Drawn: TEAM
Checked: JK
Approved: JK

TITLE
STAIRS - PLANS & SECTIONS

SHEET NUMBER
A41-01

Copyright 2017 © Perkins + Will

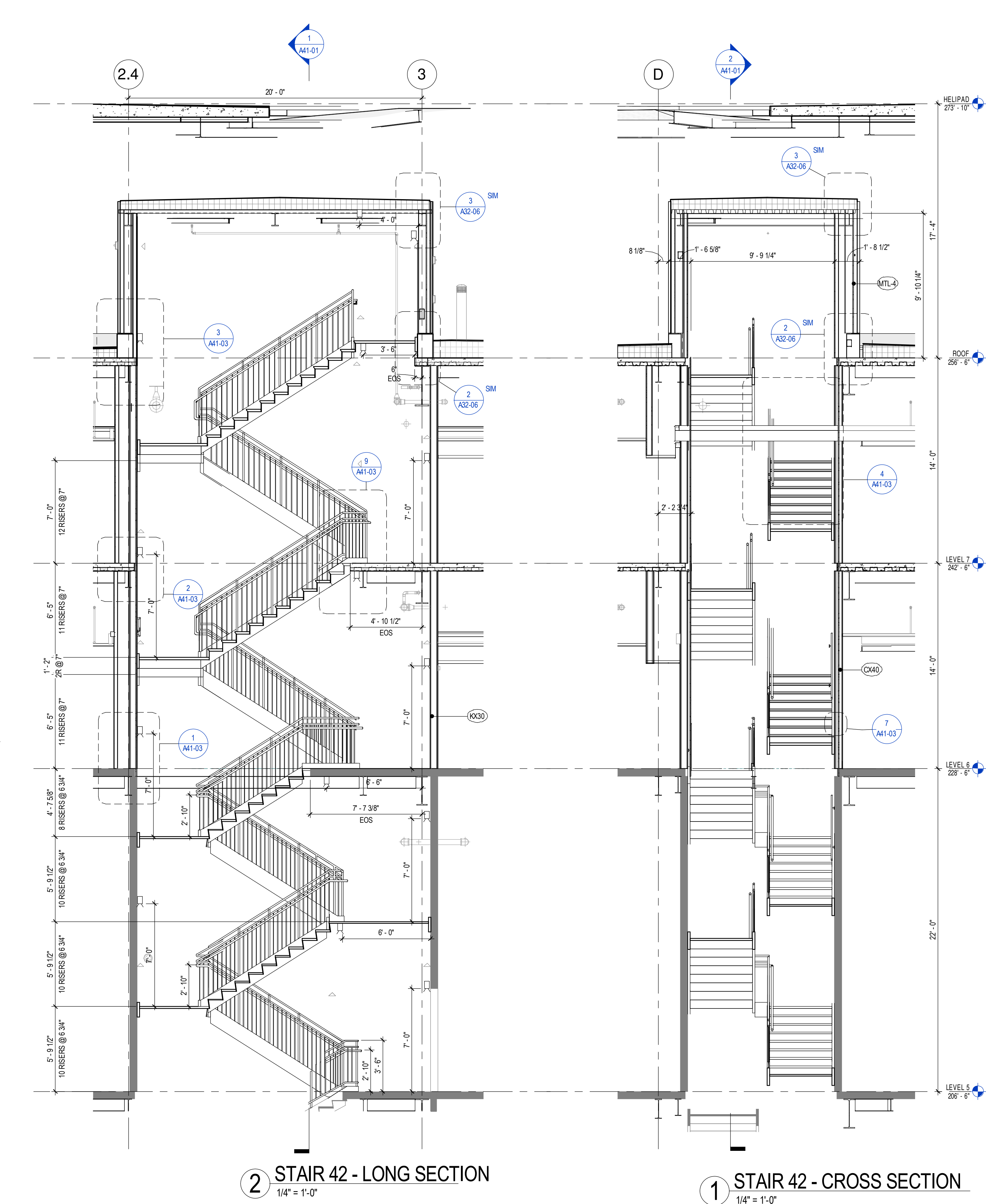
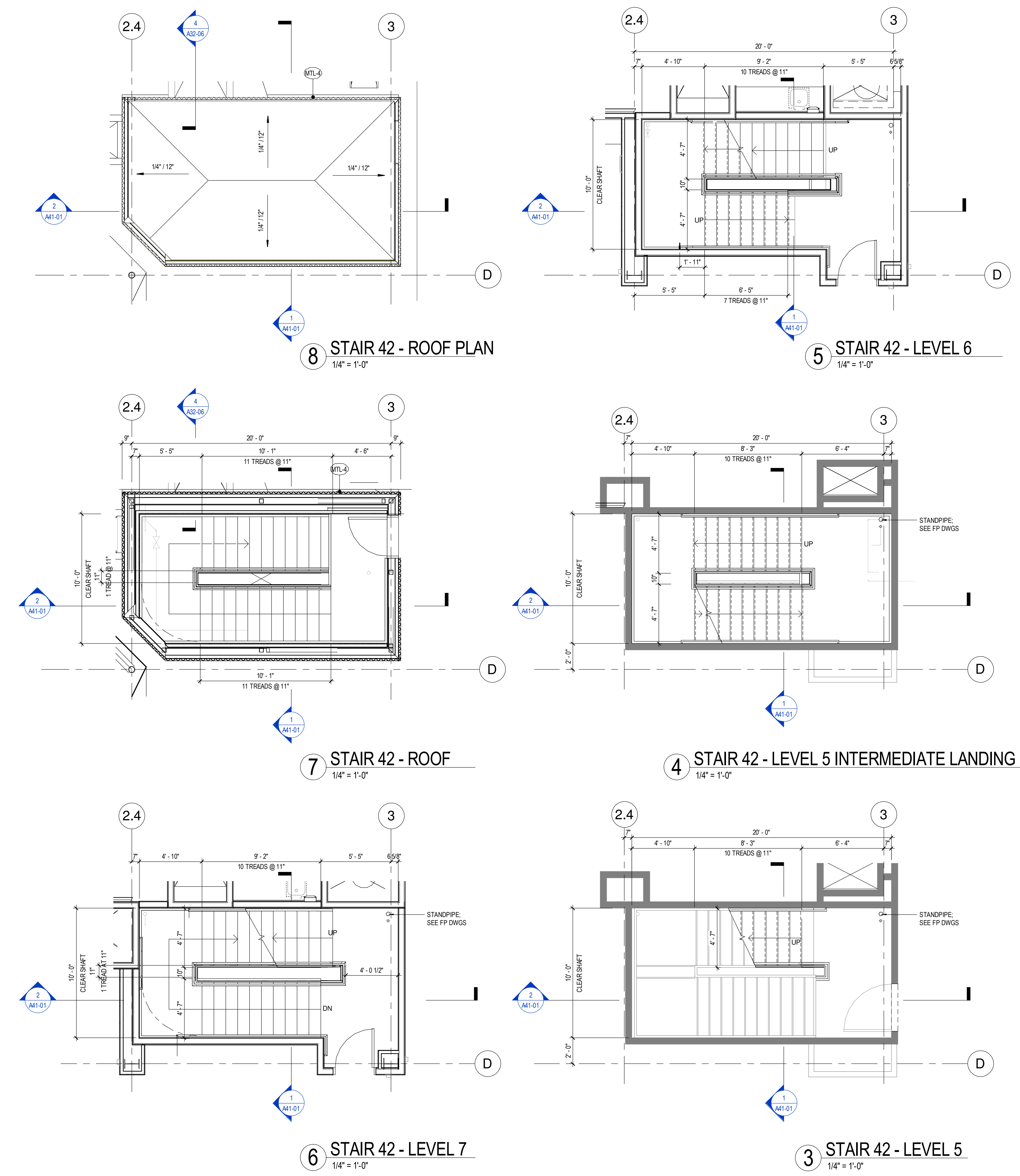

3/20/2018 11:23:11 PM
152181.MDC-East Tower 6 & 7.rvt - J.dalmeida.rvt