

- 1 - GILMAN GARAGE
- 2 - CONGRESS STREET
- 3 - VISITOR GARAGE
- 4 - EAST TOWER
- 5 - CENTRAL UTILITY PLANT
- 6 - BEAN BUILDING
- 7 - RICHARDS BUILDING
- 8 - MAINE GENERAL BUILDING

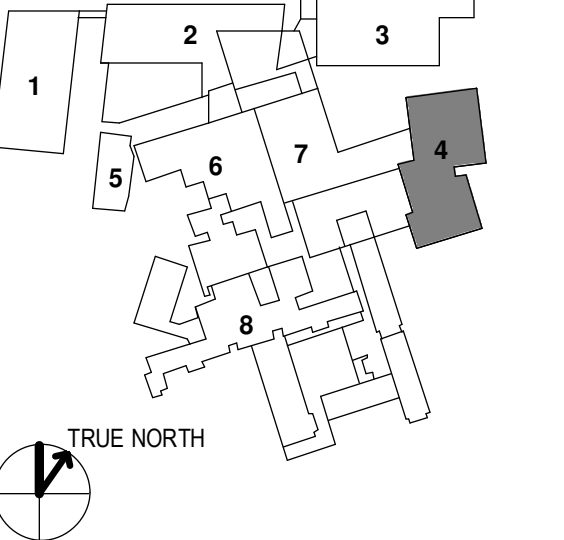

NO	ISSUE	DATE
1	ADDENDUM NO. 1	3/22/18

Job Number 152181.000
Drawn TEAM
Checked JK
Approved JK

KEYNOTES

- 06 40 00 COLD-FORMED METAL FRAMING
- 06 40 00.M FIBERGLASS THERMAL CLIP
- 06 10 53.A PRESSURE-TREATED WOOD BLOCKING
- 07 21 00.H MINERAL WOOL ED INS
- 07 21 00.N VAPOR RETARDERS
- 07 27 13.A1 NON-FORMABLE MEMBRANE AIR BARRIER
- 07 42 13.23 METAL COMPOSITE MATERIAL WALL PANELS
- 07 92 00 JOINT SEALANTS
- 08 44 13.A ALUM CURTAIN WALL
- 08 44 13.05 SLUICONE FLASHING SHEET
- 09 29 00 GYPSUM BOARD

4 CURTAIN WALL AND METAL PNL @ GRID F-7 LEVELS 06 & 07
1 1/2" = 1'-0"

5 CURTAIN WALL @ GRID G-6.5 LEVELS 06 & 07
1 1/2" = 1'-0"

1 CW CORNER/ EXISTING BRICK - GRID F -7.2 LEVEL 5
1 1/2" = 1'-0"

6 CURTAIN WALL AND METAL PNL @ C-5 LEVELS 06 & 07
1 1/2" = 1'-0"

3 CW / METAL PANEL - EXISTING WALL LEVEL 5
1 1/2" = 1'-0"

2 CW CORNER - GRID 6.5 LEVEL 05
1 1/2" = 1'-0"

