

CONSULTANTS

- CVL LANDSCAPE ARCHITECT  
**Sebago Technics**  
 75 John Roberts Road, Suite  
 1A, South Portland ME 04106
- STRUCTURAL ENGR. BUILDING ENVELOPE CONSULTANT  
**Stimpson Gumpertz & Hagen Inc.**  
 41 Seven Street, Building 1, Suite 500,  
 Waltham MA 02453
- MERFP ENGINEER CODE  
**AKF Group LLC**  
 99 Bedford Street, 2nd Floor, Boston MA 02111
- CONSTRUCTION MANAGER  
**Turner Construction**  
 2 Seaport Lane, Suite 200, Boston MA 02210
- ELEVATOR CONSULTANT  
**VDA (Van Dusen & Associates)**  
 101 Summer Street, 4th Floor, Boston MA  
 02110
- COST ESTIMATOR  
**D. G. Jones International**  
 3 Baldwin Green Common, Suite 202, Woburn MA 01801

PROJECT TITLE

**East Tower 6 & 7  
 Addition**  
 22 Bramhall Street  
 Portland ME 04102



KEY PLANS

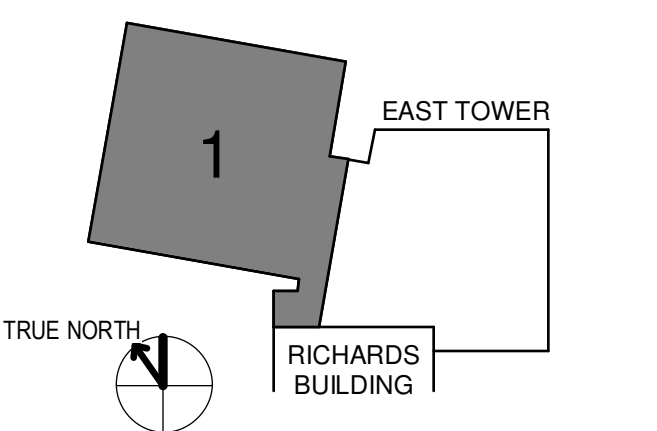

OVERALL KEY PLAN

- 1 - GILMAN GARAGE
- 2 - CONGRESS STREET
- 3 - VISITOR GARAGE
- 4 - EAST TOWER
- 5 - CENTRAL UTILITY PLANT
- 6 - BEAN BUILDING
- 7 - RICHARDS BUILDING
- 8 - MAINE GENERAL BUILDING

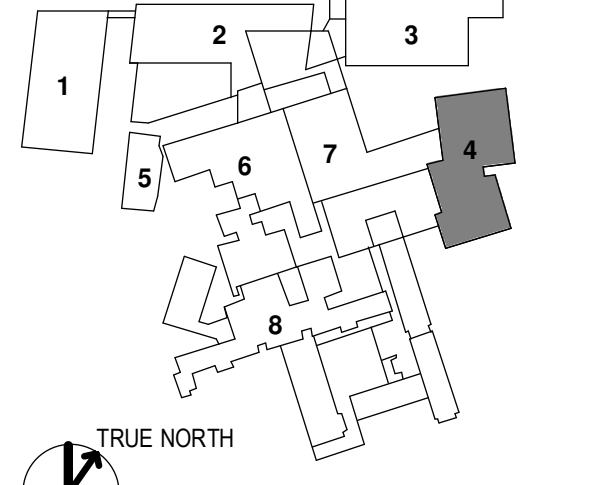

CONSTRUCTION DOCUMENTS  
 JANUARY 26, 2018

NO	ISSUE	DATE
1	ADDENDUM NO. 1	3/22/18

Job Number: 152181.000  
 Drawn: TEAM  
 Checked: JK  
 Approved: JK

TITLE  
**LEVEL 7 FINISH  
 PLAN - SECTOR 1**

SHEET NUMBER

**A13-71**

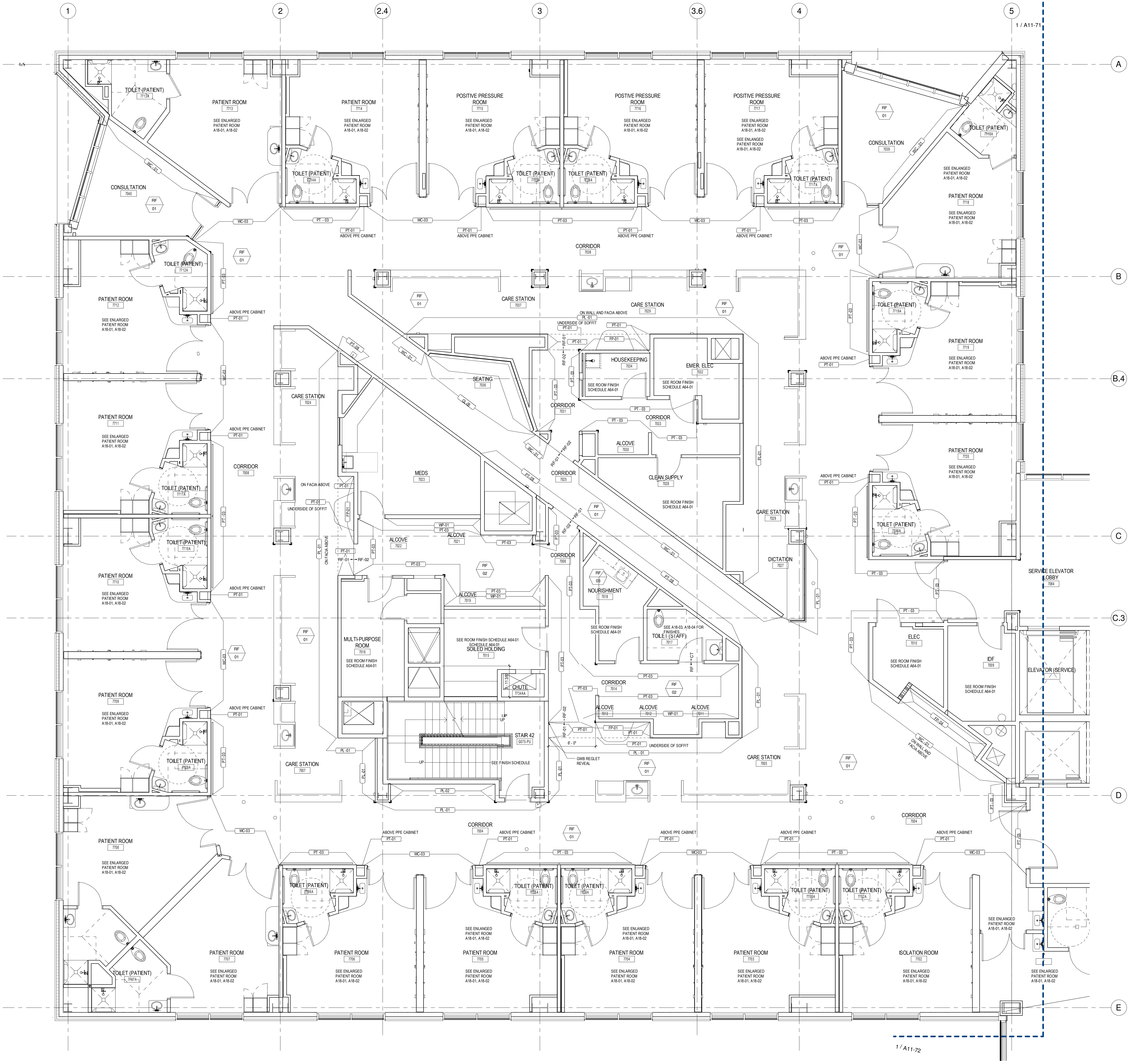

FINISH PLAN LEGEND

- RF 01 FLOOR FINISH
- FINISH COLOR
- XXX PAINT ACCENT WALL FINISH
- CPT 2 - CPT 1 FLOOR FINISH TRANSITION
- FLOOR FINISH MATERIAL PATTERN DIRECTION

FINISH GENERAL NOTES

1. ALL WALLS TO BE PAINTED PT-02 U.O.N
2. ALL CEILINGS TO BE PAINTED PT-01 U.O.N
3. SEE ROOM FINISH SCHEDULE FOR WALL BASE TYPE A64.01 AND OTHER ACCESSORIES.
4. SEE SHEET A64.01 FOR INTERIOR FINISHES LEGEND FOR PRODUCTS DESCRIPTIONS AND COLORS
5. SEE SHEET A64-01 FOR FLOORING TRANSITION DETAILS
6. REFER TO REFLECTED CEILING PLANS FOR CEILINGS AND SOFFITS INDICATIONS