

CONSULTANTS

- CIVIL/LANDSCAPE ARCHITECT
Sebago Technics
 75 John Roberts Road, Suite
 1A, South Portland ME 04106
- STRUCTURAL/ENR/BUILDING ENVELOPE CONSULTANT
Stinson Gumpertz & Hager Inc.
 41 Seyon Street, Building 1, Suite 500,
 Waltham MA 02453
- MEP/ELECTRICAL ENGINEER
AKF Group LLC
 99 Bedford Street, 2nd Floor, Boston MA 02111
- CONSTRUCTION MANAGER
Turner Construction
 2 Seaport Lane, Suite 200, Boston MA 02210
- ELEVATOR CONSULTANT
VDA (Van Dusen & Associates)
 101 Summer Street, 4th Floor, Boston MA
 02110
- COST ESTIMATOR
D. G. Jones International
 3 Baldwin Green Common, Suite 202, Woburn MA 01801

PROJECT TITLE

**East Tower 6 & 7
Addition**
22 Bramhall Street
Portland ME 04102

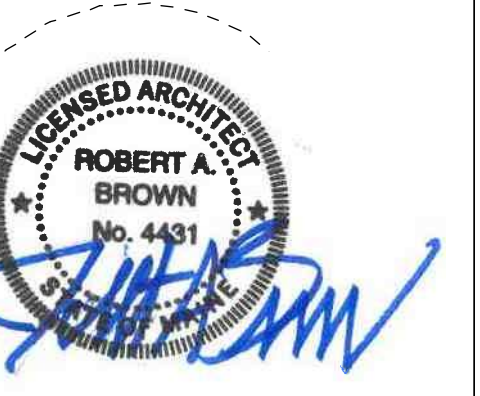

KEY PLANS

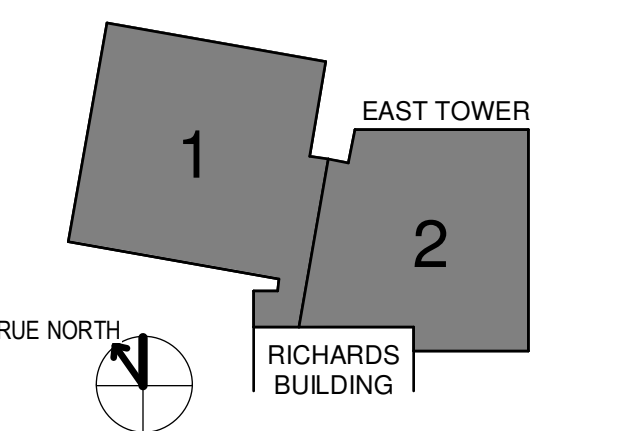

OVERALL KEY PLAN

- 1 - GILMAN GARAGE
- 2 - CONGRESS STREET
- 3 - VISITOR GARAGE
- 4 - EAST TOWER
- 5 - CENTRAL UTILITY PLANT
- 6 - BEAN BUILDING
- 7 - RICHARDS BUILDING
- 8 - MAINE GENERAL BUILDING

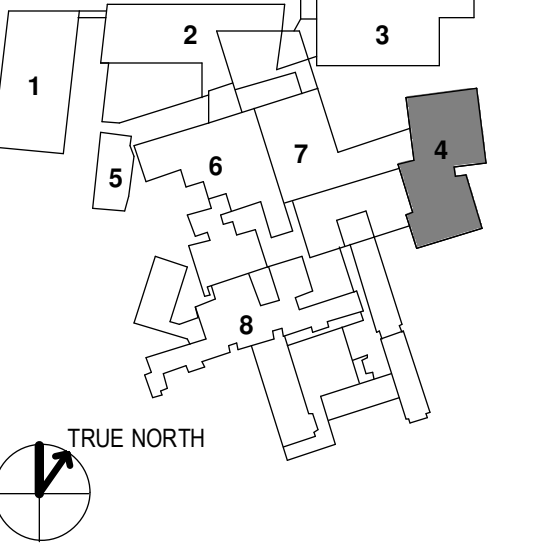

CONSTRUCTION DOCUMENTS
JANUARY 26, 2018

NO	ISSUE	DATE
Job Number	152181.000	
Drawn	TEAM	
Checked		
Approved		

TITLE
**OVERALL
REFLECTED
CEILING PLANS**

SHEET NUMBER

A12-01



2 LEVEL 7
1/16" = 1'-0"



1 LEVEL 6
1/16" = 1'-0"