

CONSULTANTS

- CVL LANDSCAPE ARCHITECT  
 Sebago Technics  
 75 John Roberts Road, Suite  
 1A, South Portland ME 04106
- STRUCTURAL ENG. BUILDING ENVELOPE CONSULTANT  
 Simpson Gumpertz & Heger Inc.  
 41 Sevon Street, Building 1, Suite 500,  
 Waltham MA 02453
- MERFP ENGINEER CODE  
 AKF Group LLC  
 99 Bedford Street, 2nd Floor, Boston MA 02111
- CONSTRUCTION MANAGER  
 Turner Construction  
 2 Seaport Lane, Suite 200, Boston MA 02210
- ELEVATOR CONSULTANT  
 VDA (Van Dusen & Associates)  
 101 Summer Street, 4th Floor, Boston MA  
 02110
- COAT ESTIMATOR  
 D. G. Jones International  
 3 Baldwin Green Common Suite 202, Woburn MA 01801

PROJECT TITLE

**East Tower 6 & 7  
 Addition**  
 22 Bramhall Street  
 Portland ME 04102

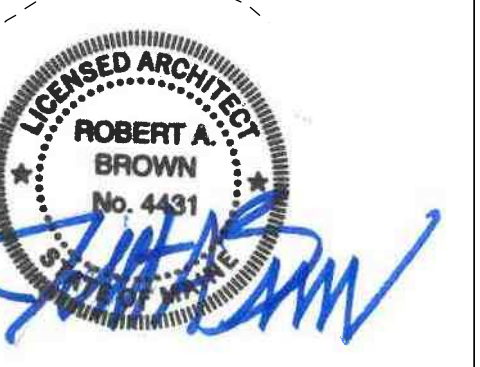

KEY PLANS

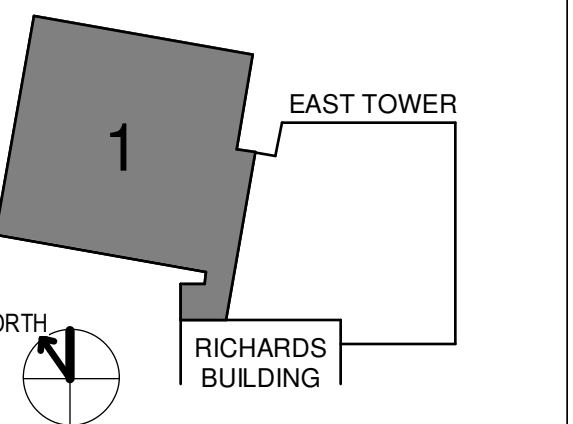

OVERALL KEY PLAN

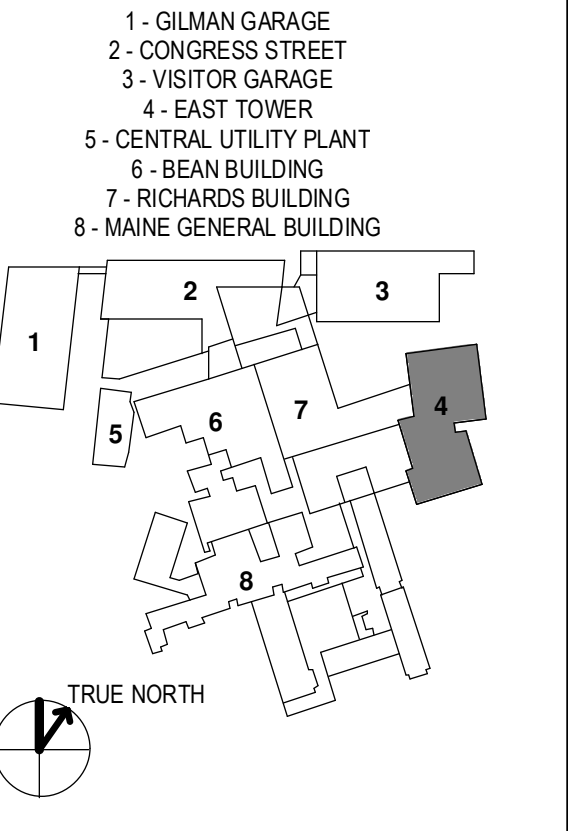

CONSTRUCTION DOCUMENTS  
 JANUARY 26, 2018

NO	ISSUE	DATE
2	ADDENDUM NO. 2	3/28/18
1	ADDENDUM NO. 1	3/22/18
NO	ISSUE	DATE

Job Number: 152181.000  
 Drawn: TEAM  
 Checked: JK  
 Approved: JK

TITLE  
**LEVEL 7 - SECTOR 1**

SHEET NUMBER

**A11-71**

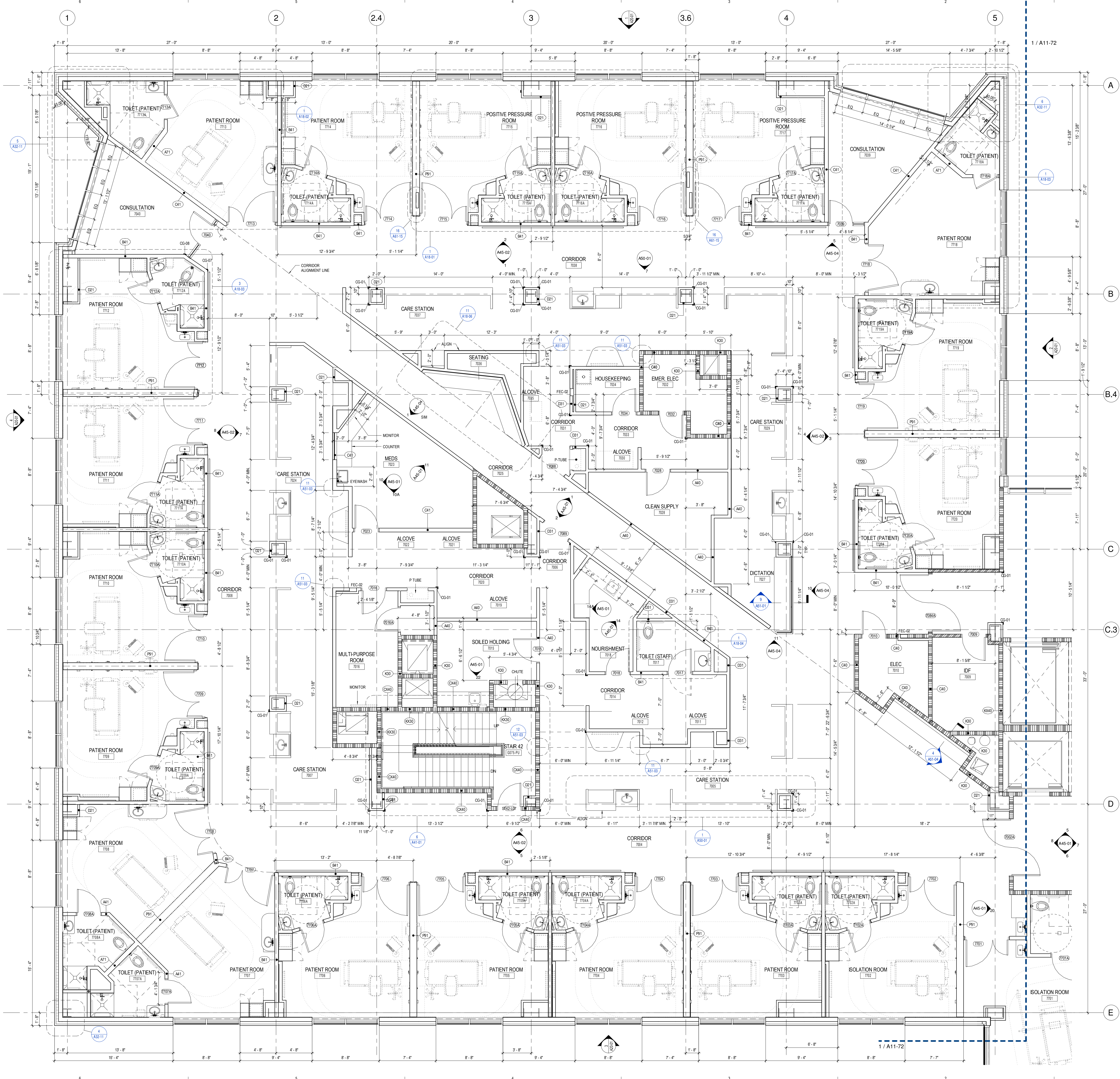

**NOTES**

- WHERE AN INTERIOR PARTITION IS NOT DESIGNATED, ASSUME TYPE A41.
- REFER TO A00-02 FOR TYPICAL MOUNTING HEIGHTS.
- EDGE OF DOOR FRAME FROM INSIDE CORNER TO BE 4" TYP. UNO

**LEGEND**

FEC RECESSED FIRE EXTINGUISHER CABINET  
 A41 PARTITION TYPE; SEE A61-01  
 301A DOOR TYPE; SEE A62-01