

CONSULTANTS

- CVL LANDSCAPE ARCHITECT
Sebago Technics
 75 John Roberts Road, Suite
 1A, South Portland ME 04106
- STRUCTURAL ENG. BUILDING ENVELOPE CONSULTANT
Stinson Gumpertz & Hager Inc.
 41 Seven Street, Building 1, Suite 500,
 Waltham MA 02453
- MERP ENGINEER CODE
AKF Group LLC
 99 Bedford Street, 2nd Floor, Boston MA 02111
- CONSTRUCTION MANAGER
Turner Construction
 2 Seaport Lane, Suite 200, Boston MA 02210
- ELEVATOR CONSULTANT
VDA (Van Dusen & Associates)
 101 Summer Street, 4th Floor, Boston MA
 02110
- COST ESTIMATOR
D. G. Jones International
 3 Baldwin Green Common, Suite 202, Woburn MA 01801

PROJECT TITLE

**East Tower 6 & 7
 Addition**
 22 Bramhall Street
 Portland ME 04102

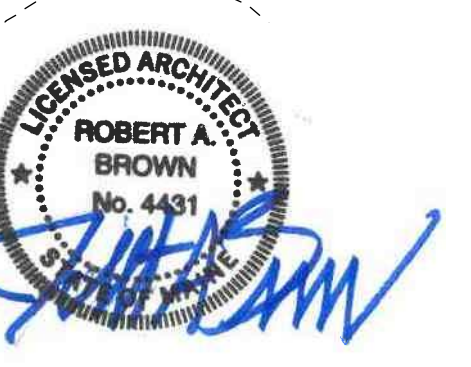

KEY PLANS

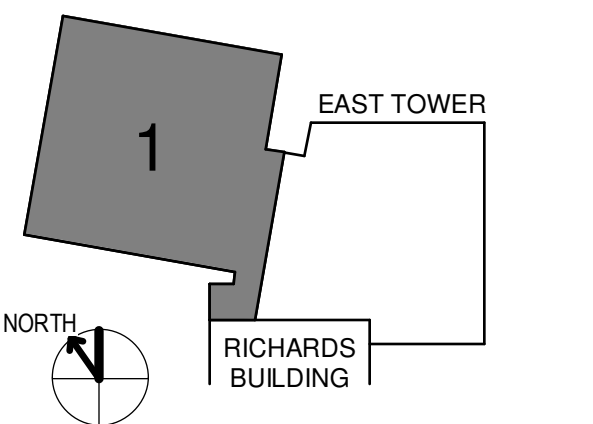

OVERALL KEY PLAN

- 1 - GILMAN GARAGE
- 2 - CONGRESS STREET
- 3 - VISITOR GARAGE
- 4 - EAST TOWER
- 5 - CENTRAL UTILITY PLANT
- 6 - BEAN BUILDING
- 7 - RICHARDS BUILDING
- 8 - MAINE GENERAL BUILDING

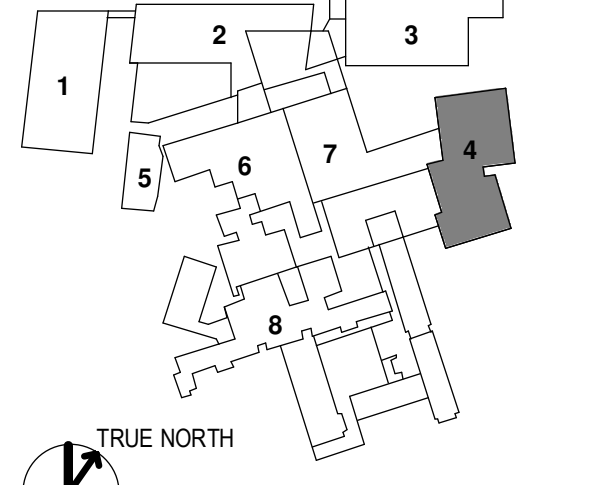

CONSTRUCTION DOCUMENTS
 JANUARY 26, 2018

NO	ISSUE	DATE
2	ADDENDUM NO. 2	3/28/18
1	ADDENDUM NO. 1	3/22/18
NO	ISSUE	DATE

Job Number: 152181.000
 Drawn: TEAM
 Checked: JK
 Approved: JK

TITLE
LEVEL 6 - SECTOR 1

SHEET NUMBER

A11-61

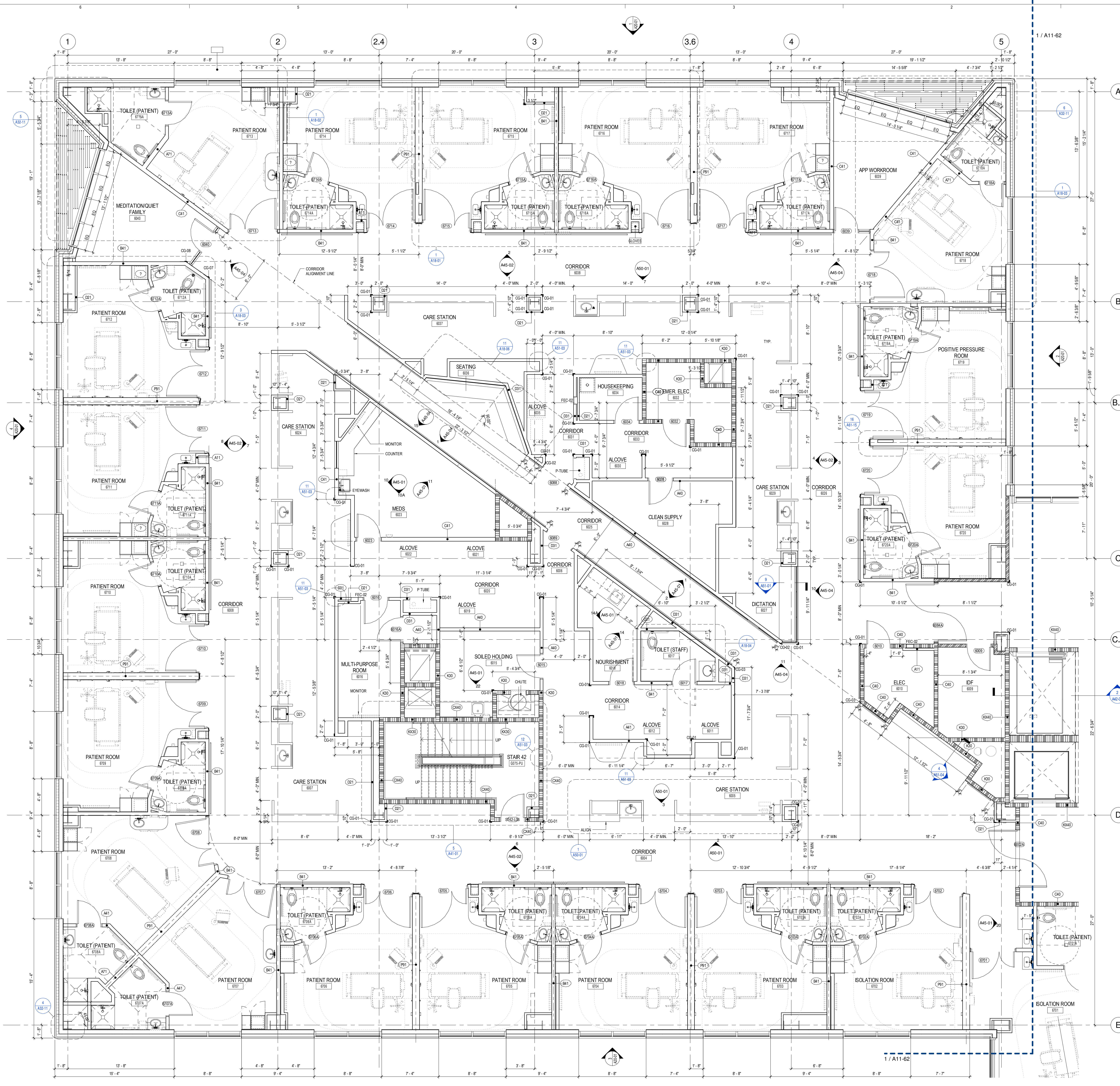

NOTES

1. WHERE AN INTERIOR PARTITION IS NOT DESIGNATED, ASSUME TYPE A41.
2. REFER TO A00-02 FOR TYPICAL MOUNTING HEIGHTS.
3. EDGE OF DOOR FRAME FROM INSIDE CORNER TO BE 4" TYP. UNO

LEGEND

FEC RECESSED FIRE EXTINGUISHER CABINET
 A41 PARTITION TYPE; SEE A61-01
 811A DOOR TYPE; SEE A62-01