

- 1 - GILMAN GARAGE
- 2 - CONGRESS STREET
- 3 - VISITOR GARAGE
- 4 - EAST TOWER
- 5 - CENTRAL UTILITY PLANT
- 6 - BEAN BUILDING
- 7 - RICHARDS BUILDING
- 8 - MAINE GENERAL BUILDING

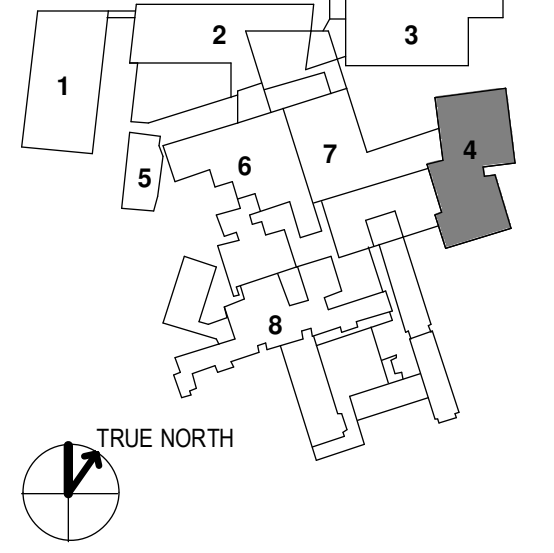

NO.	ISSUE	DATE

Job Number 152181.000
Drawn TEAM
Checked JK
Approved JK

TITLE
**DEMOLITION
ELEVATIONS**

SHEET NUMBER
A06-01



- NOTES**
1. REMOVE METAL PANEL SYSTEM, FASCIA & CURVED ALUM TUBE INCLUDING TUBE BRACKETS, METAL STUD FRAMING, SHEATHING, MEMBRANES, FLASHING & LOUVERS TO REMAIN
 2. REMOVE BRICK CLADDING & PRECAST BANDING, METAL STUD FRAMING & SHEATHING, MEMBRANES & FLASHINGS TO REMAIN
 3. REMOVE PARAPETS, ROOFING, INSULATION, PROTECTION BOARD, FALL PROTECTION, ETC. STRIP DOWN TO CONCRETE DECK ROOF SLAB TYP.
 4. BRICK CLADDING AND FRAMING TO REMAIN, SECURE EXISTING - PATCH, REPAIR & REPLACE DAMAGED BRICK.