

**APPLICABLE CODES & STANDARDS**

The State of Maine requires municipalities with more than 4,000 residents to adopt and enforce the Maine Uniform Building and Energy Code (MUBEC). The next edition of the MUBEC became effective on January 23, 2018. The following codes and standards are applicable to the project.

- International Building Code (IBC), 2015 Edition with ME Amendments
- International Existing Building Code (IEBC), 2015 Edition with ME Amendments
- International Energy Conservation Code (IECC), 2009 Edition with ME Amendments
- American Society of Heating, Refrigerating and Air-Conditioning Engineers (ASHRAE) Standard 62.1, Standard for Ventilation and Indoor Air Quality, 2013 edition

In addition to the codes identified above, the State Fire Marshal's Office promulgates the Rules of the State Fire Marshal, which adopt numerous NFPA codes and standards, including the following:

- NFPA 1, Uniform Fire Code, 2006 Edition with ME Amendments
- NFPA 13, Standard for Installation of Sprinkler Systems, 2016 Edition

The Plumbers' Examining Board promulgates the Maine Plumbing Code, which includes the following:

- International Association of Plumbing and Mechanical Officials (IAPMO), 2015 Uniform Plumbing Code (UPC), with ME amendments

The Electricians' Examining Board adopts and amends the following electrical code:

- NFPA 70, National Electrical Code, 2017 Edition

The following federal regulation also applies to the project (as referenced by the Maine Human Rights Commission - 5 M.R.S. §4594-G):

- Americans with Disabilities Act (ADA), 2010 Standards for Accessible Design

The Joint Commission also requires compliance with the following:

- NFPA 101, Life Safety Code, 2012 Edition
- NFPA 99, Health Care Facilities Code, 2012 Edition

The following design standards will also be used for the project:

- Facilities Guidelines Institute (FGI), Guidelines for Design and Construction of Hospitals and Outpatient Facilities, 2014 Edition
- ASHRAE Standard 170, Ventilation of Healthcare Facilities, 2013 edition

OCCUPANT LOAD HELIPAD			
USE	FLOOR AREA	FLOOR AREA PER OCCUPANT (SF / OCC)	OCCUPANT LOAD
HELIPAD	6873 SF	500	14
	6873 SF		14

EXIT CAPACITY HELIPAD				
EXIT	STAIR WIDTH	STAIR EXIT ALLOWANCE (IN / PERSON)	STAIR CAPACITY (PERSONS)	EXIT CAPACITY (PERSONS)
HELIPAD STAIR 1	58"	0.2	290	290
HELIPAD STAIR 2	58"	0.2	290	290
HELIPAD STAIR 3	58"	0.2	290	290
				870

NOTE: AFTER TRAVELLING FROM THE HELIPAD LEVEL TO THE ROOF, OCCUPANTS HAVE ACCESS TO THE BUILDING EXIT STAIRS WHICH HAVE A TOTAL EXIT CAPACITY OF 340 PEOPLE. SEE G01-80.

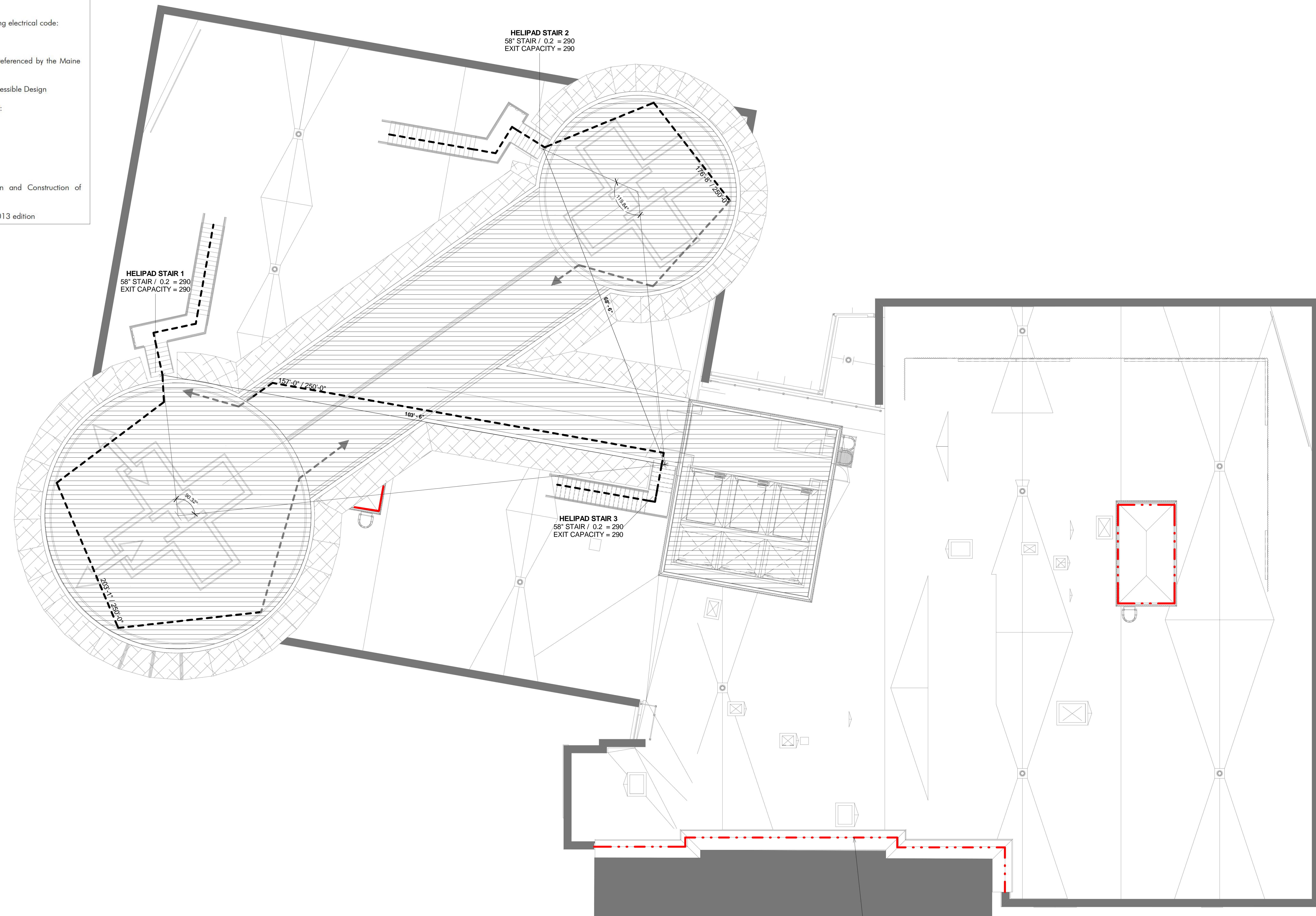

WALL RATING LEGEND	
LINE TYPE	DESIGNATION
---	UNRATED SMOKE PARTITION
---	1-HR RATED SMOKE BARRIER
---	1-HR RATED FIRE BARRIER
---	2-HR RATED FIRE BARRIER

LEGEND		
LINE TYPE / SYMBOL	COMPONENT TYPE	DESIGNATION
---	EXIT ACCESS TRAVEL DISTANCE	ACTUAL / ALLOWED
---	COMMON PATH OF TRAVEL	
---	DEAD END CORRIDOR	
---	SECONDARY EGRESS PATH	
---	REFUGE AREA	AREA (SF)
---	ACCESSIBLE UNITS	NA

HELIPAD  
SCALE: 1/8" = 1'-0"

CONSULTANTS

CIVIL/LANDSCAPE ARCHITECT  
Sebago Technics  
75 John Roberts Road, Suite  
1A, South Portland ME 04106

STRUCTURAL/ENR/BUILDING ENVELOPE CONSULTANT  
Simpson Gumpertz & Heger Inc.  
41 Sycam Street, Building 1, Suite 500,  
Waltham MA 02453

MEPP/ENGINEER/ME CODE  
AKF Group LLC  
99 Bedford Street, 2nd Floor, Boston MA 02111

CONSTRUCTION MANAGER  
Turner Construction  
2 Support Lane, Suite 200, Boston MA 02210

ELEVATOR CONSULTANT  
VDA (Van Dusen & Associates)  
101 Summer Street, 4th Floor, Boston MA  
02110

COST ESTIMATOR  
D. G. Jones International  
3 Babbitt Green Common Suite 202, Woburn MA 01801

PROJECT TITLE

**East Tower 6 & 7  
Addition**  
22 Bramhall Street  
Portland ME 04102

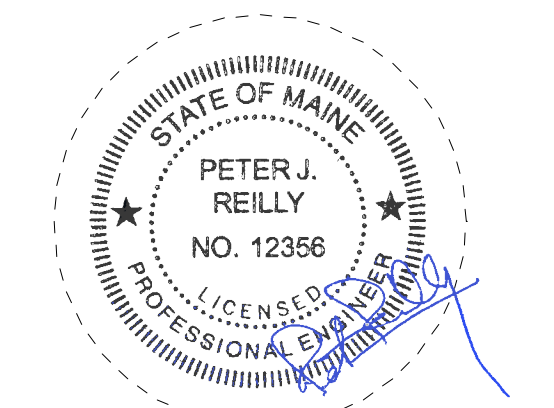

KEY PLANS

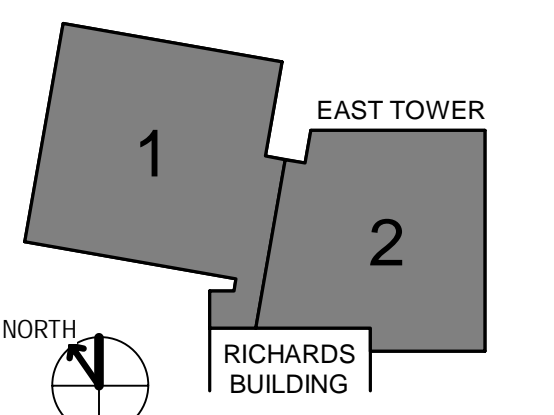

OVERALL KEY PLAN

1. GILMAN GARAGE
2. CONGRESS STREET
3. VISITOR GARAGE
4. EAST TOWER
5. CENTRAL UTILITY PLANT
6. REAR BUILDING
7. RICHARDS BUILDING
8. MAINE GENERAL BUILDING

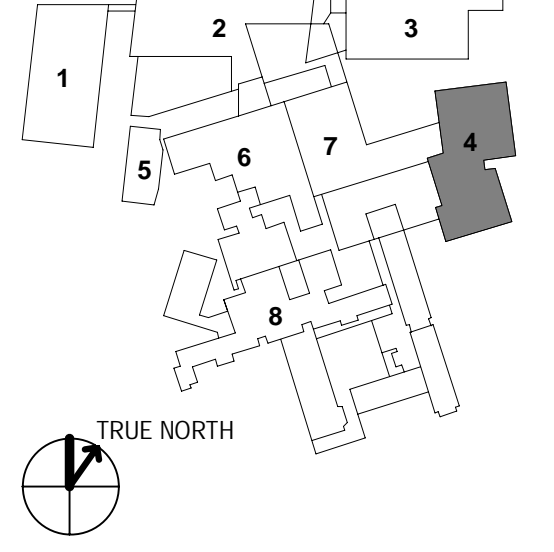

CONSTRUCTION DOCUMENTS  
JANUARY 26, 2018

NO	ISSUE	DATE
2	ADDENDUM NO. 2	03/29/18
1	ADDENDUM NO. 1	03/22/18

Job Number: B150312-000  
Drawn: MMS  
Checked: CMA  
Approved: CMA

TITLE  
**CODE COMPLIANCE  
PLAN - HELIPAD**

SHEET NUMBER

**G01-90**