

APPLICABLE CODES & STANDARDS

The State of Maine requires municipalities with more than 4,000 residents to adopt and enforce the Maine Uniform Building and Energy Code (MUBEC). The next edition of the MUBEC became effective on January 23, 2018. The following codes and standards are applicable to the project:

- International Building Code (IBC), 2015 Edition with ME Amendments
- International Existing Building Code (IEBC), 2015 Edition with ME Amendments
- International Energy Conservation Code (IECC), 2009 Edition with ME Amendments
- American Society of Heating, Refrigerating and Air-Conditioning Engineers (ASHRAE) Standard 62.1, Standard for Ventilation and Indoor Air Quality, 2013 edition

In addition to the codes identified above, the State Fire Marshal's Office promulgates the Rules of the State Fire Marshal, which adopt numerous NFPA codes and standards, including the following:

- NFPA 1, Uniform Fire Code, 2006 Edition with ME Amendments
- NFPA 13, Standard for Installation of Sprinkler Systems, 2016 Edition

The Plumbers' Examining Board promulgates the Maine Plumbing Code, which includes the following:

- International Association of Plumbing and Mechanical Officials (IAPMO), 2015 Uniform Plumbing Code (UPC), with ME amendments

The Electricians' Examining Board adopts and amends the following electrical code:

- NFPA 70, National Electrical Code, 2017 Edition

The following federal regulation also applies to the project (as referenced by the Maine Human Rights Commission - 5 M.R.S. §4594-G):

- Americans with Disabilities Act (ADA), 2010 Standards for Accessible Design

The Joint Commission also requires compliance with the following:

- NFPA 101, Life Safety Code, 2012 Edition
- NFPA 99, Health Care Facilities Code, 2012 Edition

The following design standards will also be used for the project:

- Facilities Guidelines Institute (FGI), Guidelines for Design and Construction of Hospitals and Outpatient Facilities, 2014 Edition
- ASHRAE Standard 170, Ventilation of Healthcare Facilities, 2013 edition

| EXIT | STAIR WIDTH | STAIR EXIT ALLOWANCE (IN / PERSON) | EXIT CAPACITY ROOF | | | | |
|---------|-------------|------------------------------------|--------------------------|------------|-----------------------------------|-------------------------|-------------------------|
| | | | STAIR CAPACITY (PERSONS) | DOOR WIDTH | DOOR EXIT ALLOWANCE (IN / PERSON) | DOOR CAPACITY (PERSONS) | EXIT CAPACITY (PERSONS) |
| STAIR 1 | 51' | 0.3 | 170 | 34' | 0.2 | 170 | 170 |
| STAIR 2 | 51' | 0.3 | 170 | 34' | 0.2 | 170 | 170 |
| | | | | | | | 340 |

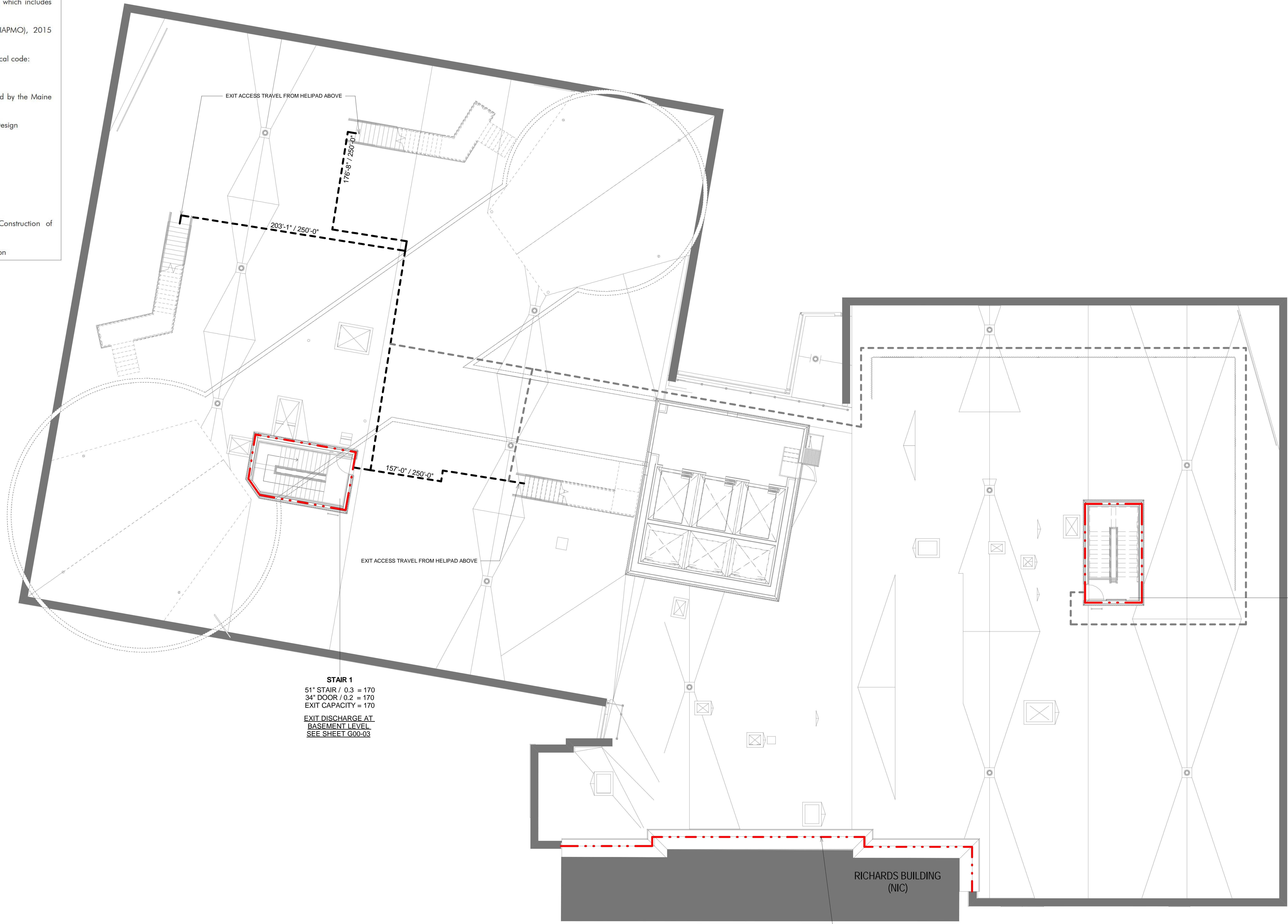

STAIR 1
51' STAIR / 0.3 = 170
34' DOOR / 0.2 = 170
EXIT CAPACITY = 170
EXIT DISCHARGE AT BASEMENT LEVEL
SEE SHEET G00-03

STAIR 2
51' STAIR / 0.3 = 170
34' DOOR / 0.2 = 170
EXIT CAPACITY = 170
EXIT DISCHARGE AT GROUND FLOOR
SEE SHEET G00-03

2-HOUR RATED EXTERIOR WALL IN ACCORDANCE WITH MODIFIED TYPE IA CONSTRUCTION (I.E. TYPE IB CONSTRUCTION).

WALL RATING LEGEND

| LINE TYPE | DESIGNATION |
|-----------|--------------------------|
| --- | UNRATED SMOKE PARTITION |
| --- | 1-HR RATED SMOKE BARRIER |
| --- | 1-HR RATED FIRE BARRIER |
| --- | 2-HR RATED FIRE BARRIER |

ROOF
SCALE: 1/8" = 1'-0"

LEGEND

| LINE TYPE / SYMBOL | COMPONENT TYPE | DESIGNATION |
|--------------------|-----------------------------|------------------|
| --- | EXIT ACCESS TRAVEL DISTANCE | ACTUAL / ALLOWED |
| --- | COMMON PATH OF TRAVEL | |
| --- | DEAD END CORRIDOR | AREA (SF) |
| --- | SECONDARY EGRESS PATH | |
| --- | REFUGE AREA | NA |
| --- | ACCESSIBLE UNITS | |

22 Bramhall Street
Portland ME 04102

- CONSULTANTS
- CIVIL/LANDSCAPE ARCHITECT
Sebago Technics
75 John Roberts Road, Suite 1A, South Portland ME 04106
 - STRUCTURAL/ENR/BUILDING ENVELOPE CONSULTANT
Simpson Gumpertz & Heger Inc.
41 Sycam Street, Building 1, Suite 500, Waltham MA 02453
 - MEPP ENGINEERING CODE
AKF Group LLC
99 Bedford Street, 2nd Floor, Boston MA 02111
 - CONSTRUCTION MANAGER
Turner Construction
2 Sappart Lane, Suite 200, Boston MA 02210
 - ELEVATOR CONSULTANT
VDA (Van Dusen & Associates)
101 Summer Street, 4th Floor, Boston MA 02110
 - COST ESTIMATOR
D. G. Jones International
3 Babbain Green Common, Suite 202, Woburn MA 01801

PROJECT TITLE
East Tower 6 & 7 Addition
22 Bramhall Street
Portland ME 04102

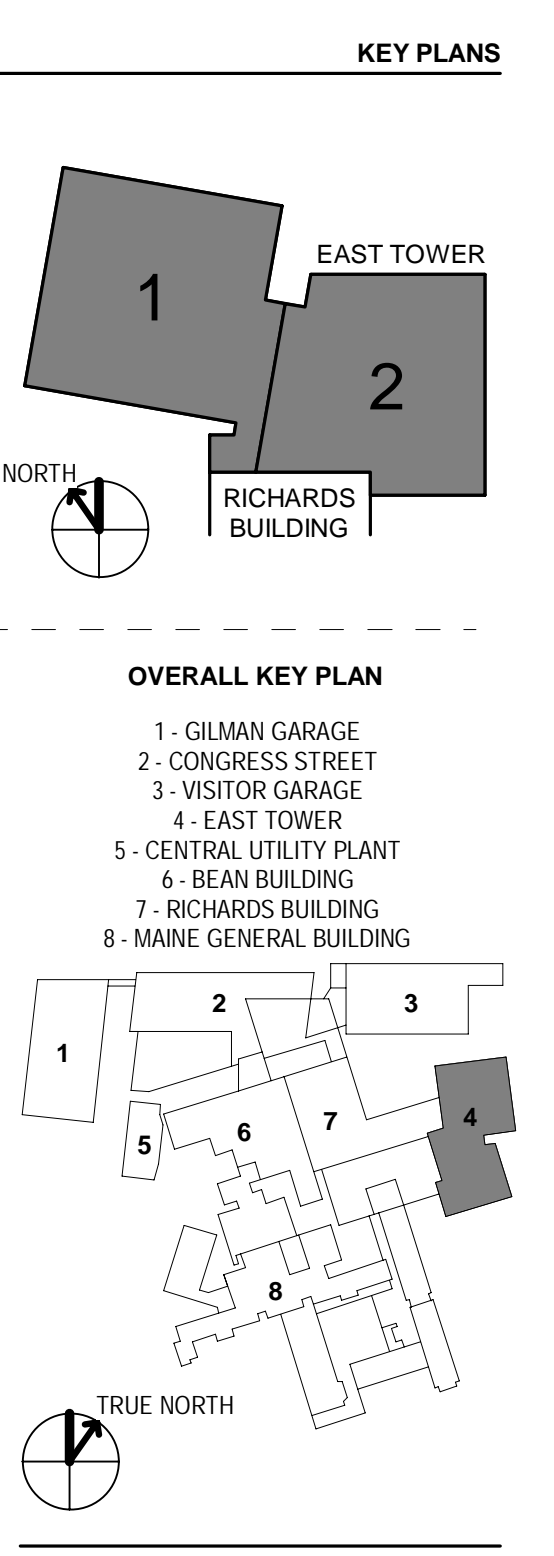
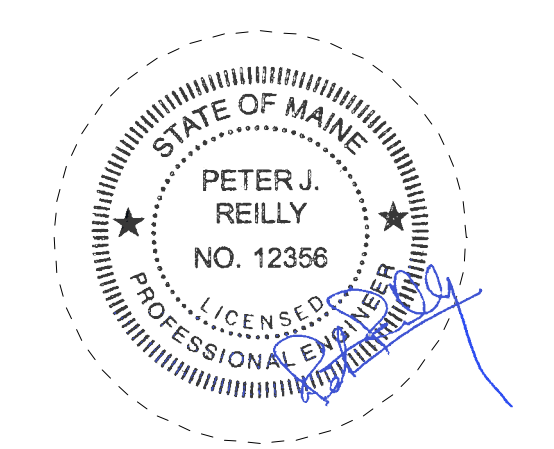

CONSTRUCTION DOCUMENTS
JANUARY 26, 2018

| NO | ISSUE | DATE |
|----|----------------|----------|
| 2 | ADDENDUM NO. 2 | 03/22/18 |
| 1 | ADDENDUM NO. 1 | 03/22/18 |

Job Number: B150312-000
Drawn: MMS
Checked: CMA
Approved: CMA

CODE COMPLIANCE PLAN - ROOF

SHEET NUMBER
G01-80