

Key Value	Keynote Text
03 30 00	CAST-IN PLACE CONCRETE
03 30 00 D	CONC SLAB
05 12 00 A	STL BEAM
05 12 00 A2	STL ANGLE
05 12 00 A3	STL FL
05 12 00 A4	STL BENT PL
05 12 00 A5	STL TUBE
05 12 00 A7	STL CHANNEL
05 31 00 B	ROOF DECK
05 40 00	COLD-FORMED METAL FRAMING
05 40 00 A	CFMF
05 40 00 D	VERTICAL DEFLECTION CLIP
05 40 00 M	FIBERGLASS THERMAL CLIP
05 50 00 D	METAL LADDER
05 50 00 R2	STL TUBE
05 50 00 R3	STL ANGLE
05 50 00 R6	ALUM PLATE
05 51 13 A1	STAR FRAMING
05 51 19 A	METAL GRATE TREAD
05 51 19 B	TREADPLATE RISER
05 51 19 C	GALV CHANNEL STRINGER
05 52 13	PIPE AND TUBE RAILINGS
05 52 13 F	GALV FENCING
05 52 13 F1	GALV FENCING FRAME
06 10 53 A	PRESSURE-TREATED WOOD BLOCKING
06 16 00 A1	FIRE-RETARDANT TREATED PL WOOD
06 16 00 B3	GLASS-MAT GYPSUM WALL SHEATHING
07 21 00 A	POLYSTYROBE INSUL
07 21 00 E	MINERAL WOOL BATT
07 21 00 H	MINERAL WOOL BD INS
07 21 00 M	CLOSED-CELL SPRAY POLYURETHANE FOAM
07 27 00 N	VAPOR RETARDERS
07 27 13 A1	NON-PERMEABLE MEMBRANE AIR BARRIER
07 27 13 B1	COUNTERFLASHING STRIP
07 42 13 13	FORMED METAL WALL PANELS
07 42 13 13 A	CAP FLASHING
07 42 13 13 B	EXTRUDED TRIM
07 42 13 13 C	HEAD FLASHING
07 42 13 13 D	FLASHING TAPE
07 42 13 13 E	SILL FLASHING
07 42 13 19 A	INSULATED METAL WALL PANELS
07 42 13 19 A	SILICONE SEALANT
07 42 13 23	METAL COMPOSITE MATERIAL WALL PANELS
07 53 23	ETHYLENE-PROPYLENE-DIENE-MONOMER (EPDM) ROOFING
07 53 23 B1	EPDM MEMBRANE FLASHING
07 53 23 C	GLASS MAT SUBSTRATE BD
07 53 23 D	VAPOR BARRIER
07 53 23 F	GLASS MAT COVER BD
07 53 23 H	MTL TERMINATION BAR
07 53 23 J	PIPE BOOTS
07 53 23 J.1	SST BOOT CLAMP
07 62 00	SHEET METAL FLASHING AND TRIM
07 62 00 B1	SST FLASHING
07 62 00 B2	ALUM FLASHING
07 62 00 B3	HIGH-TEMPERATURE UNDERLAYMENT
07 62 00 C	COUNTERFLASHING AND REGLET
07 62 00 J	FORMED MTL GUTTER
07 71 00 B	COPIING
07 72 00	INSULATED ROOF CURB
07 81 00	APPLIED FIREPROOFING
07 81 00 A	SPRAYED FIRE RESISTIVE MATERIAL
07 84 43	JOINT FIRESTOPPING
07 82 00	JOINT SEALANTS
07 96 00	EXPANSION CONTROL
08 11 13	HOLLOW METAL DOORS AND FRAMES
08 11 13 B1	EXTERIOR HD DOOR
08 11 13 B2	EXTERIOR HM FRAME
08 44 13	GLAZED ALUMINUM CURTAIN WALLS
08 44 13 A	ALUM CURTAIN WALL
08 44 13 B7	ALUM STCOL TRIM
08 44 13 B8	SST RAIL
08 44 13 C1	CURTAIN WALL BACK PAN
08 44 13 C3	FIXED ALUM LOUVER
08 44 13 G5	SILICONE FLASHING SHEET
08 44 13 H	CURTAIN WALL ANCHOR
08 44 13 J1	ALUM CAP FLASHING
08 71 00 B	DOOR THRESHOLD
08 71 00 C	THRESHOLD PLATE
09 22 16	NON-STRUCTURAL METAL FRAMING
09 22 16 F	FURRING SYSTEM
09 29 00	GYPSUM BOARD
09 29 00 C1	GLASS-MAT WATER-RESISTANT BACKING BD
09 30 13	CERAMIC TILING
09 91 13	ACOUSTICAL PANEL CEILINGS
09 95 13 F	RESILIENT TRANSITION STRIP
09 95 16	RESILIENT SHEET FLOORING
09 91 13 A	CONCRETE SEALER
10 77 36	WINDSOCK
11 24 29	FACILITY FALL PROTECTION
12 24 13 B	MANUALLY OPERATED ROLLER SHADE

CONSULTANTS

CIVIL / LANDSCAPE ARCHITECT
 Sebago Technics
 75 John Roberts Road, Suite
 1A, South Portland ME 04106

STRUCTURAL ENG: BUILDING ENVELOPE CONSULTANT
 Singleton Gumpertz & Heger Inc.
 41 Sevon Street, Building 1, Suite 501,
 Waltham MA 02453

MERFP ENGINEER CODE
 AKF Group LLC
 99 Bedford Street, 2nd Floor, Boston MA 02111

CONSTRUCTION MANAGER
 Turner Construction
 2 Seaport Lane, Suite 200, Boston MA 02210

ELEVATOR CONSULTANT
 VDA (Van Deusen & Associates)
 101 Summer Street, 4th Floor, Boston MA
 02110

COST ESTIMATOR
 D. G. Jones International
 3 Baitain Green Common, Suite 202, Woburn MA 01801

PROJECT TITLE
East Tower 6 & 7 Addition
 22 Bramhall Street
 Portland ME 04102

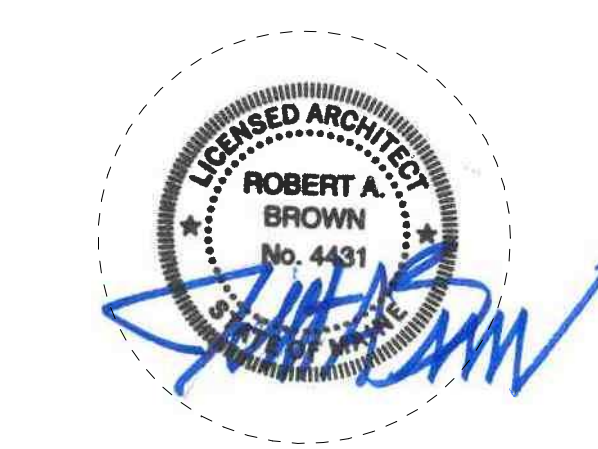

KEY PLANS

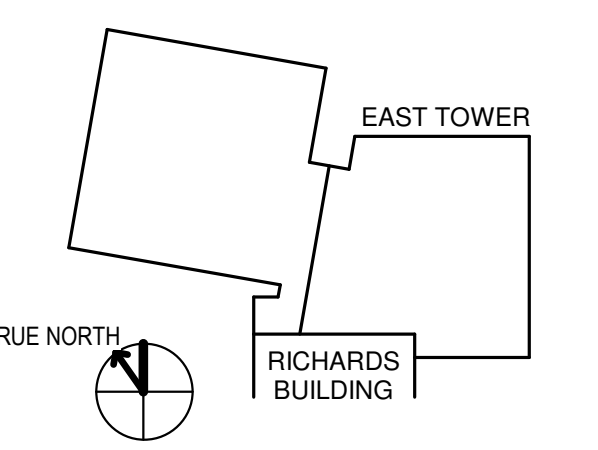

- OVERALL KEY PLAN**
- 1 - GILMAN GARAGE
 - 2 - CONGRESS STREET
 - 3 - VISITOR GARAGE
 - 4 - EAST TOWER
 - 5 - CENTRAL UTILITY PLANT
 - 6 - BEAN BUILDING
 - 7 - RICHARDS BUILDING
 - 8 - MAINE GENERAL BUILDING

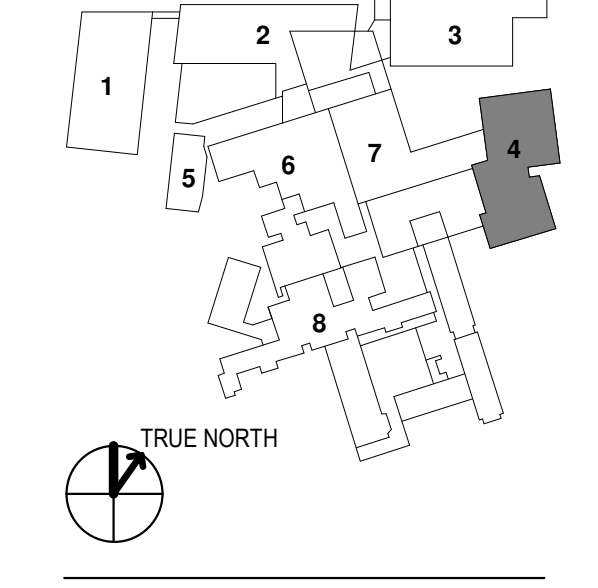

CONSTRUCTION DOCUMENTS
 JANUARY 26, 2018

NO	ISSUE	DATE
Job Number	152181.000	
Drawn	TEAM	
Checked		
Approved	JK	

TITLE
MASTER KEYNOTE LIST

SHEET NUMBER
G00-02