

TEMPORARY
MORGUE
LOCATION

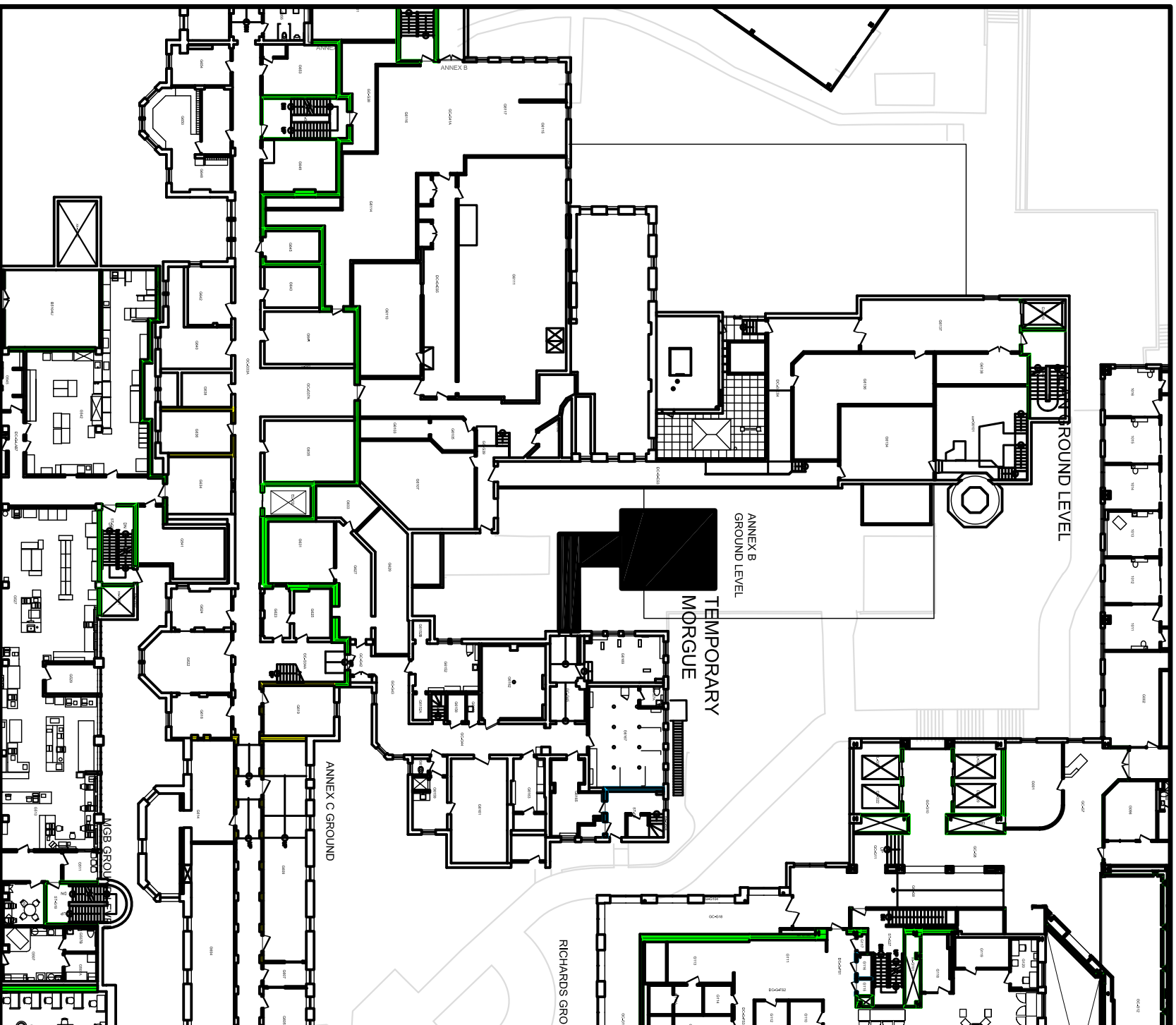

ROUND LEVEL

ANNEX B
GROUND LEVEL

TEMPORARY
MORGUE

ANNEX C GROUND

RICHARDS GROU

MSB GROU



Maine Medical Center
MaineHealth

Facilities Development
22 Bramhall Street
Portland, ME 04102
(207) 662-2013
Fax (207) 662-6195

Morgue Renovation
Annex B Courtyard
Bramhall Campus

No	Revision	Date

Date	Project #	PROJECT #

Title
Plot Plan

Sheet
A1.1